



# FOR LEASE

1750 North Redwood Road  
Saratoga Springs, UT 84045

## REDWOOD SQUARE

Prime location right on Redwood Road in the heart of fast growing Saratoga Springs. Ideally located close to residential communities that are surrounded by destination tenants such as Walmart, Costco, Home Depot, and Smith's, just to name a few. A 36,479 mixed use commercial development featuring leasing spaces for offices, retail, and hospitality from as little as 1,500 sq ft and up to 10,000 sq ft as fits your specific needs.

### PROPERTY DETAILS

- Available - 1,526 Sq Ft to 10,595 Sq Ft
- Drive Thru \$50 PSF
- Inline \$37 PSF
- End Cap \$42 PSF
- \$6.50 PSF NNN
- Ample Parking for Retail and Professional
  - 175 Stalls
- High Density Residential Trade Area

**CENTURY 21**  
**COMMERCIAL**  
Everest

CONTACT US:

**RUBY REECE**  
rubyreecerealtor@gmail.com | 801-550-2215

**KURT MATZ**  
kurtjmatz@gmail.com | 801-381-8822



# PROPERTY EXTERIOR

1750 N Redwood Road, Saratoga Springs, UT 84045



**CENTURY 21**  
**COMMERCIAL®**  
Everest

CONTACT US:

**RUBY REECE**

[rubyreecerealtor@gmail.com](mailto:rubyreecerealtor@gmail.com) | 801-550-2215

**KURT MATZ**

[kurtjmatz@gmail.com](mailto:kurtjmatz@gmail.com) | 801-381-8822



# SITE PLANS

1750 N Redwood Road, Saratoga Springs, UT 84045

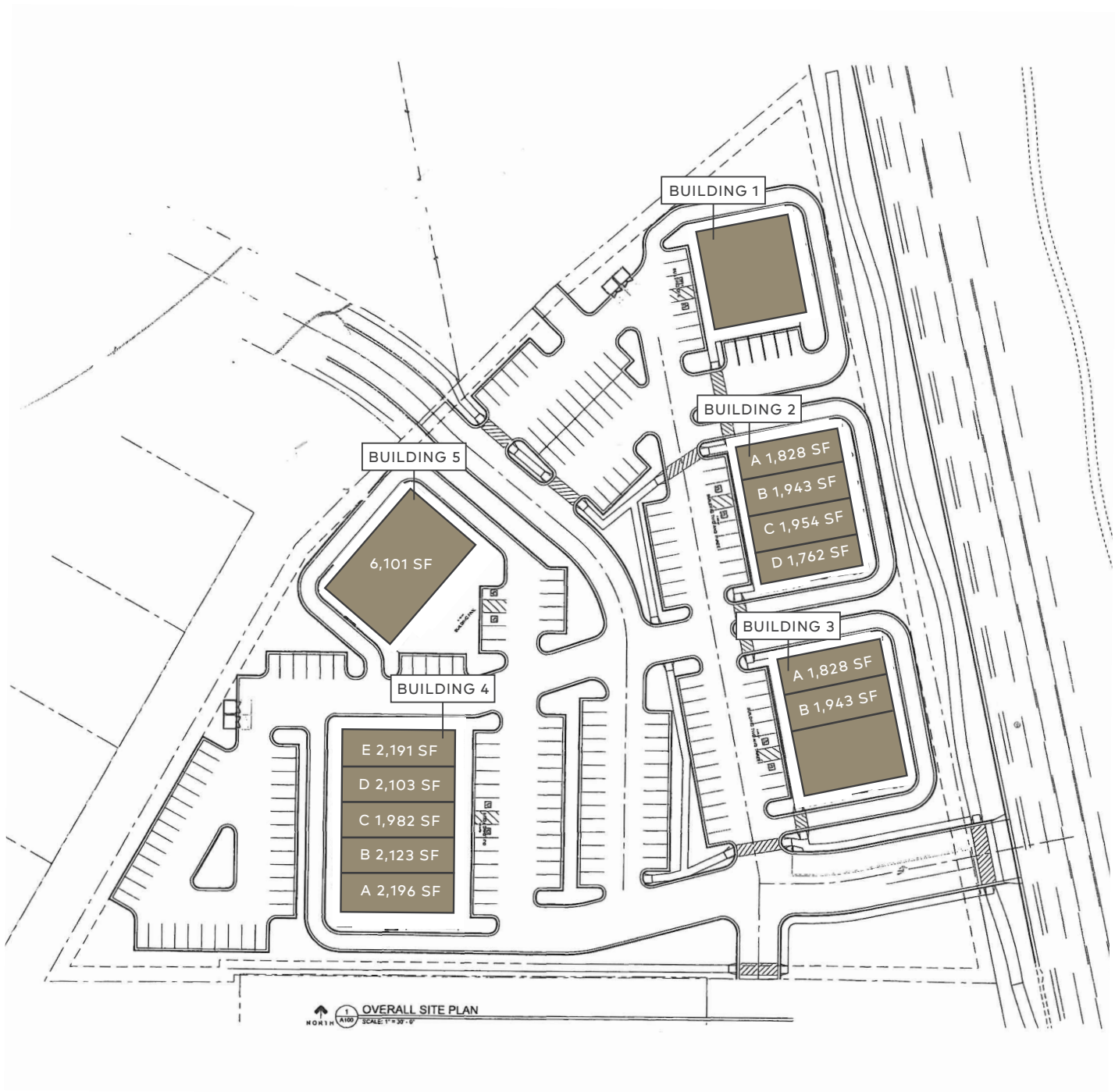

**CENTURY 21**  
**COMMERCIAL®**  
Everest

**CONTACT US:**

**RUBY REECE**

[rubyreecerealtor@gmail.com](mailto:rubyreecerealtor@gmail.com) | 801-550-2215

**KURT MATZ**

[kurtjmatz@gmail.com](mailto:kurtjmatz@gmail.com) | 801-381-8822

# DEMOGRAPHICS

1750 N Redwood Road, Saratoga Springs, UT 84045

## POPULATION

(1.0 MI)

19,579

(3.0 MI)

72,135

(5.0 MI)

167,781

## HOUSEHOLDS

(1.0 MI)

5,792

(3.0 MI)

19,716

(5.0 MI)

45,620

## AVERAGE INCOME

(1.0 MI)

\$145,439

(3.0 MI)

\$149,943

(5.0 MI)

\$151,307

DEMOGRAPHICS DATA FROM COSTAR



**CENTURY 21**  
**COMMERCIAL®**  
Everest

CONTACT US:

**RUBY REECE**

[rubyreecerealtor@gmail.com](mailto:rubyreecerealtor@gmail.com) | 801-550-2215

**KURT MATZ**

[kurtjmatz@gmail.com](mailto:kurtjmatz@gmail.com) | 801-381-8822