

 1800 JFK Blvd., Suite 300 Philadelphia, PA 19103

Smart Officing at the Heart of Philly's Business District



Prestigious Flex Office Suites

YourOffice-Philadelphia is distinctively recognized as a prime office building in the heart of downtown Center City. Featuring a dramatic atrium with numerous shops and restaurants nearby. Do your business in the epicenter of the city's thriving business, cultural, and entertainment district!

The best location also provides the best flexible

agreements so you can select the ideal mix of space and services to suit your business. Find the right mix for your business today with multiple options to support future growth. Our goal is to provide you a supportive environment with offices that offer maximum productivity. At YourOffice, we are **committed to your success!**

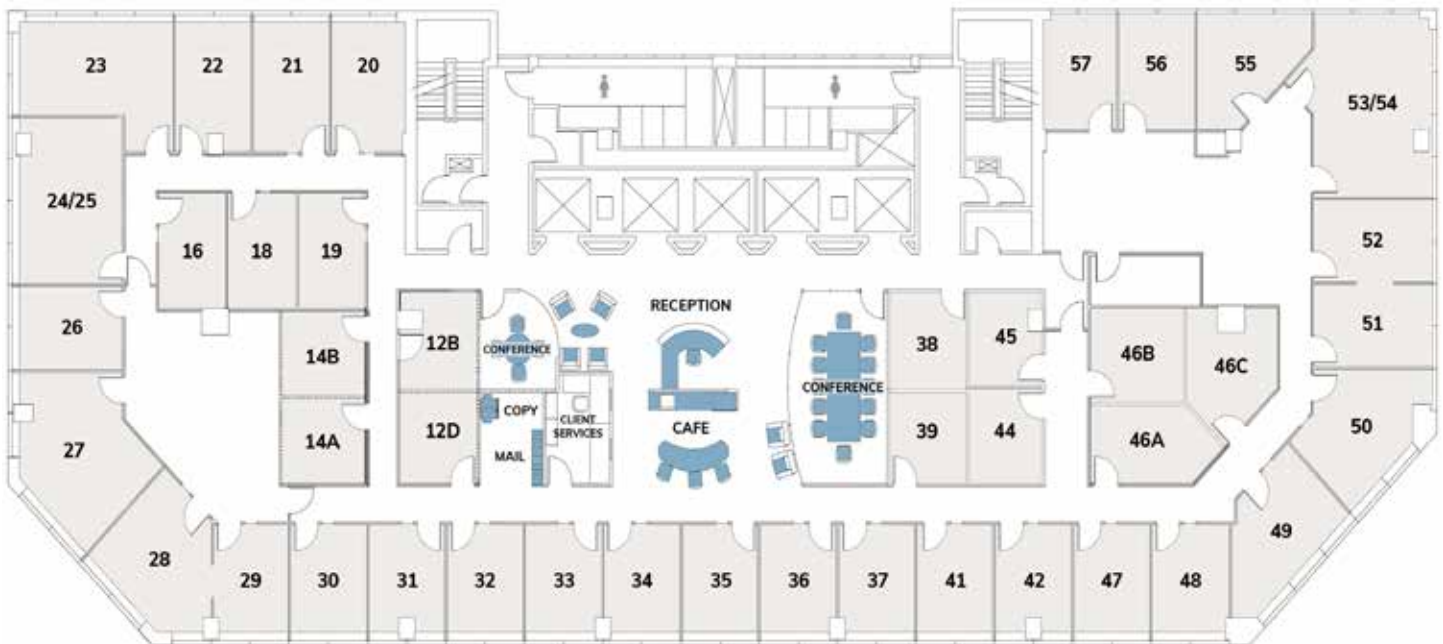

📍 1800 JFK Blvd., Suite 300 Philadelphia, PA 19103

Benefits You'll Love

- ✓ **Prestigious Address**
Prestigious business address in a Class A location.
- ✓ **Admin Support**
Professionally staffed reception and lounge.
- ✓ **Cafe & Lounge**
Stocked variety of tea and coffee.
- ✓ **Flexibility**
Grow and contract as your business needs change.
- ✓ **Hi-Speed Internet**
Stay connected and secure with premium internet.
- ✓ **Mail Handling**
Secure handling of mail and packages.
- ✓ **Pro Community**
Stoke your creativity with a like-minded professional community.
- ✓ **On-Site Parking**
Convenient parking options on site on Orange Ave.
- ✓ **Restaurants**
Enjoy surrounding food options with a client or a colleague.





Better Work Life Happens Here

YourOffice-Philadelphia is ideally situated at the 18th Street entrance to Suburban Station. This 20-story tower spans more than a quarter of a million square feet in the heart of the downtown business district. Recognized as one of the most distinctive office structures in Center City, 1800 JFK Boulevard features a dramatic atrium with numerous shops and restaurants nearby. In Center City, you're at the epicenter of the city's thriving business, cultural, and entertainment district close to City Hall, Amtrak's 30th Street Station, Suburban Station, Rittenhouse Square, and Logan Circle.

YourOffice JFK-Philly
267-238-3800
sales.philly@youroffice.com

Visit us for more info [youroffice.com](https://www.youroffice.com)