

THE WAY WE WORK TODAY

EL SEGUNDO

OPEN



LPCWEST
LINCOLN PROPERTY COMPANY

300 - 390 N PACIFIC COAST HIGHWAY

OPEN El Segundo reinvents the office, creating a sunlit campus where interior workspaces merge seamlessly with outdoor spaces designed for community, collaboration and creativity.



A 335,000 square foot campus located in a flourishing center of design, technology and media, **OPEN** El Segundo offers tenants access to lively local restaurants and cafes, biking to El Porto beach and Metro connection to Los Angeles, LAX and West LA.





Three, 3-story office buildings with large floorplates;
two single-story retail buildings



Five casual restaurants and cafes



Landscaped central courtyard anchored by
Two Guns provides outdoor seating areas for
meetings and socializing, equipped
with Wifi and speakers



Bicycle storage/shop



Ample surface and subterranean parking
with direct building access



Tenant amenity center



Conference room facility

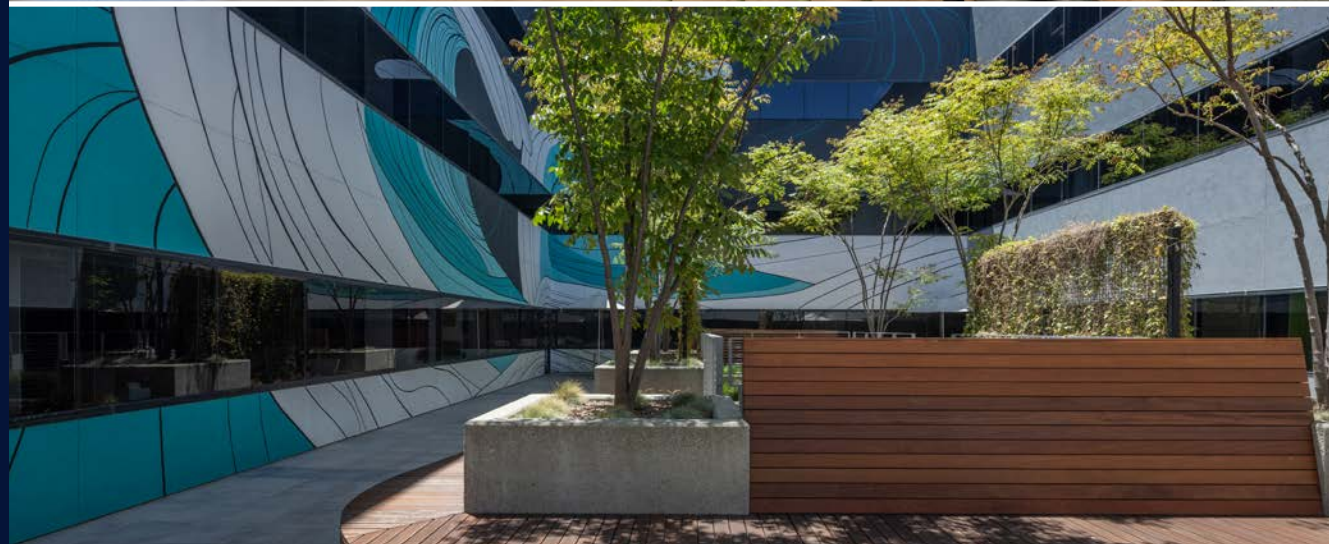

APPROXIMATELY 26,000 SF
OF CONTIGUOUS SPACE AVAILABLE



New

Spec Suites

ranging from

1,800 SF - 7,300 SF

ON-SITE AMENITIES

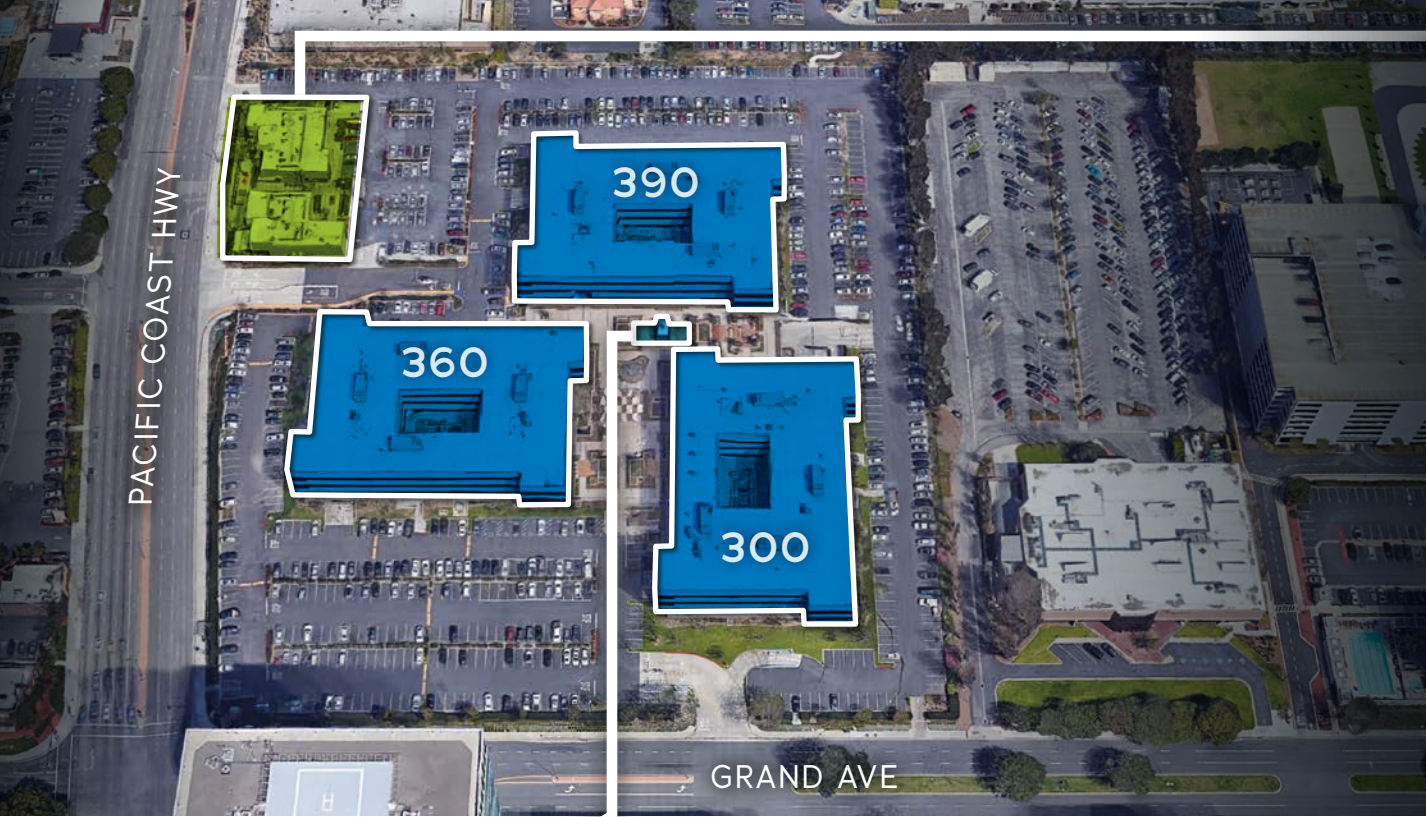

EL SEGUNDO

OPEN

Procuring broker shall only be entitled to a commission, calculated in accordance with the rates approved by our principal only if such procuring broker executes a brokerage agreement acceptable to us and our principal and the conditions as set forth in the brokerage agreement are fully and unconditionally satisfied. Although all information furnished regarding property for sale, rental, or financing is from sources deemed reliable, such information has not been verified and no express representation is made nor is any to be implied as to the accuracy thereof and it is submitted subject to errors, omissions, change of price, rental or other conditions, prior sale, lease or financing, or withdrawal without notice and to any special conditions imposed by our principal.

LOCATION

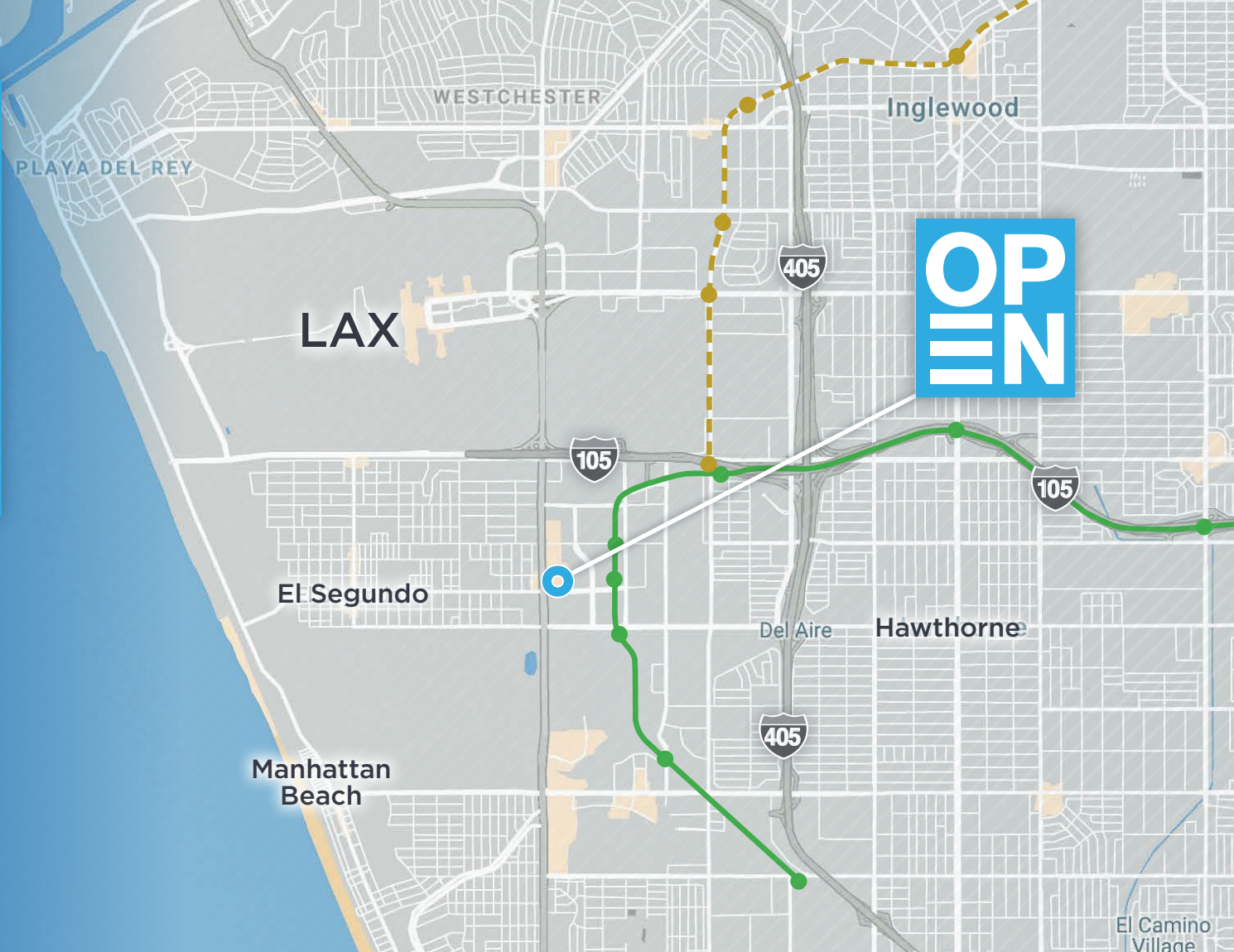

BILL BLOODGOOD
Executive Managing Director
Newmark Knight Frank
310.491.2039 | bill.bloodgood@ngkf.com
CA RE License #01152045

ALY CHELF
Associate
Newmark Knight Frank
310.491.2071 | aly.chelf@ngkf.com
CA RE License #01966499

KENT S. HANDLEMAN
Senior Vice President
LPC West
213.362.9080 | khandleman@lpc.com
CA RE License #01240201

SAM HERRERA
Associate
LPC West
213.542.8242 | sherrera@lpc.com
CA RE License #02039769

DOUGLAS J. BROWN
Vice President
LPC West
213.542.8247 | dbrown@lpc.com
CA RE License #01913265

