



INDUSTRIAL PROPERTY // FOR SALE / LEASE

14,000 SF WAREHOUSE BUILDING ON 1.4 ACRES WITH 3 BAY DOORS

19430 MOUNT ELLIOTT ST
DETROIT, MI 48234

PRICE REDUCED!



- 11,500 SF warehouse
- 2,500 SF office w/ AC
- M4 industrial zoning
- 12'-20' ceiling height
- 2 docks and one (1) overhead door
- 3-phase power
- Fully fenced property with ample parking
- Close proximity to major transportation routes



P.A. COMMERCIAL
Corporate & Investment Real Estate



26555 Evergreen Road, Suite 1500
Southfield, MI 48076
248.358.0100
pacommercial.com

We obtained the information above from sources we believe to be reliable. However, we have not verified its accuracy and make no guarantee, warranty or representation about it. It is submitted subject to the possibility of errors, omissions, change of price, rental or other conditions, prior sale, lease or financing, or withdrawal without notice. We include projections, opinions, assumptions or estimates for example only, and they may not represent current, past or future performance of the property. You and your tax and legal advisors should conduct your own investigation of the property and transaction.

19430 MOUNT ELLIOTT ST, DETROIT, MI 48234 // FOR SALE / LEASE

EXECUTIVE SUMMARY

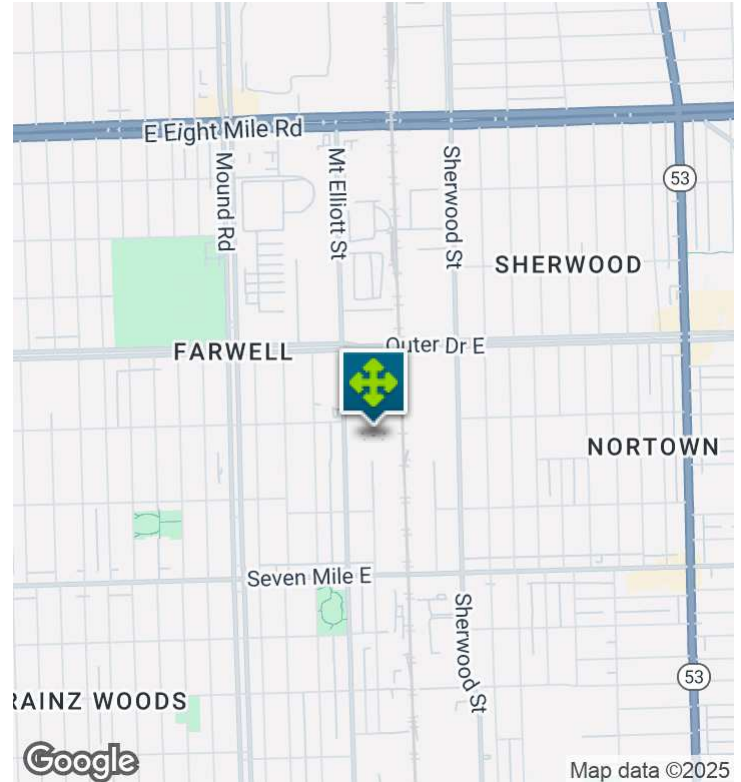

Sale Price	\$1,395,000
Lease Rate	\$9.86 SF/YR (NNN)

OFFERING SUMMARY

Building Size:	14,000 SF
Available SF:	14,000 SF
Lot Size:	1.4 Acres
Price / SF:	\$99.64
Year Built:	1950
Renovated:	2011
Zoning:	M4 Industrial
Market:	Detroit
Submarket:	Detroit E of Woodward

PROPERTY OVERVIEW

Impressive 14,000 SF industrial building in the heart of the Mount Elliott Development District available for sale & lease. Easy access on 1.4 acres with 2 truck docks and 1 grade-level overhead door. Hi-lo forklift available. Ample parking with at least 30 spaces in front. Lots of room for parking and outside storage in back. Fully fenced property. Zoned M4 Industrial. LED lighting. Ceiling height 12-20 feet. Three-phase power. The building has a current tenant who can vacate within a few months.

The owner does not want to disturb current tenant employees or customer base. DO NOT approach the business or its employees. Please contact broker.

LOCATION OVERVIEW

Located on Detroit's east side near Mound Road and 7 Mile inside Mount Elliott Development District. Adjacent to railways, FCA Warren Stamping Plant, Warren Truck Plant, and quick access to M-53/Van Dyke Expressway and 8 Mile Road.



P.A. COMMERCIAL
Corporate & Investment Real Estate

We obtained the information above from sources we believe to be reliable. However, we have not verified its accuracy and make no guarantee, warranty or representation about it. It is submitted subject to the possibility of errors, omissions, change of price, rental or other conditions, prior sale, lease or financing, or withdrawal without notice. We include projections, opinions, assumptions or estimates for example only, and they may not represent current, past or future performance of the property. You and your tax and legal advisors should conduct your own investigation of the property and transaction.

Kevin Bull SENIOR ASSOCIATE

D: 248.358.5361 | **C:** 248.895.9972

kevin@pacommercial.com

19430 MOUNT ELLIOTT ST, DETROIT, MI 48234 // FOR SALE / LEASE

INDUSTRIAL DETAILS

Property Type:	Warehouse/Distribution
Building Size:	14,000 SF
Space Available:	14,000 SF
Shop SF:	11,500 SF
Office SF:	2,500 SF
Occupancy:	Tenant can vacate within a few months
Zoning:	M4 Industrial
Lot Size:	1.4 Acres
Parking Spaces:	30
Fenced Yard:	Yes
Trailer Parking:	Yes
Year Built / Renovated:	1950 / 2011
Construction Type:	Masonry Brick/Block
Clear Height:	12 - 20'
Overhead Doors:	One (1)
Truckwells/Docks:	Two (2)
Cranes:	No
Column Spacing:	Clear Span
Power:	3-Phase
Buss Duct:	No
Air Conditioning:	Office Only
Heat Type:	N/A
Lighting:	LED
Sprinklers:	No



P.A. COMMERCIAL
Corporate & Investment Real Estate

We obtained the information above from sources we believe to be reliable. However, we have not verified its accuracy and make no guarantee, warranty or representation about it. It is submitted subject to the possibility of errors, omissions, change of price, rental or other conditions, prior sale, lease or financing, or withdrawal without notice. We include projections, opinions, assumptions or estimates for example only, and they may not represent current, past or future performance of the property. You and your tax and legal advisors should conduct your own investigation of the property and transaction.

Kevin Bull SENIOR ASSOCIATE

D: 248.358.5361 | **C:** 248.895.9972

kevin@pacommercial.com

19430 MOUNT ELLIOTT ST, DETROIT, MI 48234 // FOR SALE / LEASE

FLOOR PLANS

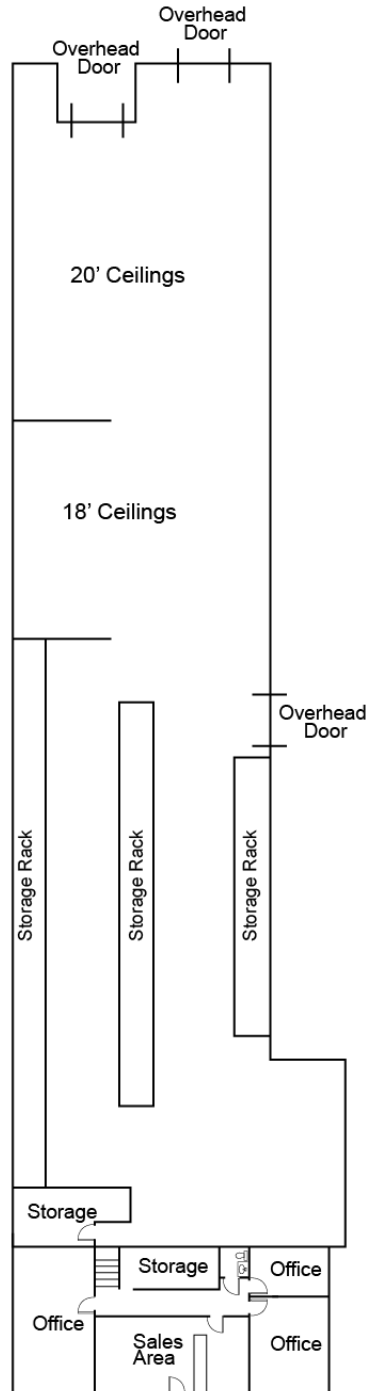

P.A. COMMERCIAL
Corporate & Investment Real Estate

We obtained the information above from sources we believe to be reliable. However, we have not verified its accuracy and make no guarantee, warranty or representation about it. It is submitted subject to the possibility of errors, omissions, change of price, rental or other conditions, prior sale, lease or financing, or withdrawal without notice. We include projections, opinions, assumptions or estimates for example only, and they may not represent current, past or future performance of the property. You and your tax and legal advisors should conduct your own investigation of the property and transaction.

Kevin Bull SENIOR ASSOCIATE
D: 248.358.5361 | C: 248.895.9972
kevin@pacommercial.com

19430 MOUNT ELLIOTT ST, DETROIT, MI 48234 // FOR SALE / LEASE

ADDITIONAL PHOTOS



P.A. COMMERCIAL
Corporate & Investment Real Estate

We obtained the information above from sources we believe to be reliable. However, we have not verified its accuracy and make no guarantee, warranty or representation about it. It is submitted subject to the possibility of errors, omissions, change of price, rental or other conditions, prior sale, lease or financing, or withdrawal without notice. We include projections, opinions, assumptions or estimates for example only, and they may not represent current, past or future performance of the property. You and your tax and legal advisors should conduct your own investigation of the property and transaction.

Kevin Bull SENIOR ASSOCIATE
D: 248.358.5361 | C: 248.895.9972
kevin@pacommercial.com

19430 MOUNT ELLIOTT ST, DETROIT, MI 48234 // FOR SALE / LEASE

RETAILER MAP



19430 MOUNT ELLIOTT ST, DETROIT, MI 48234 // FOR SALE / LEASE

LOCATION MAP

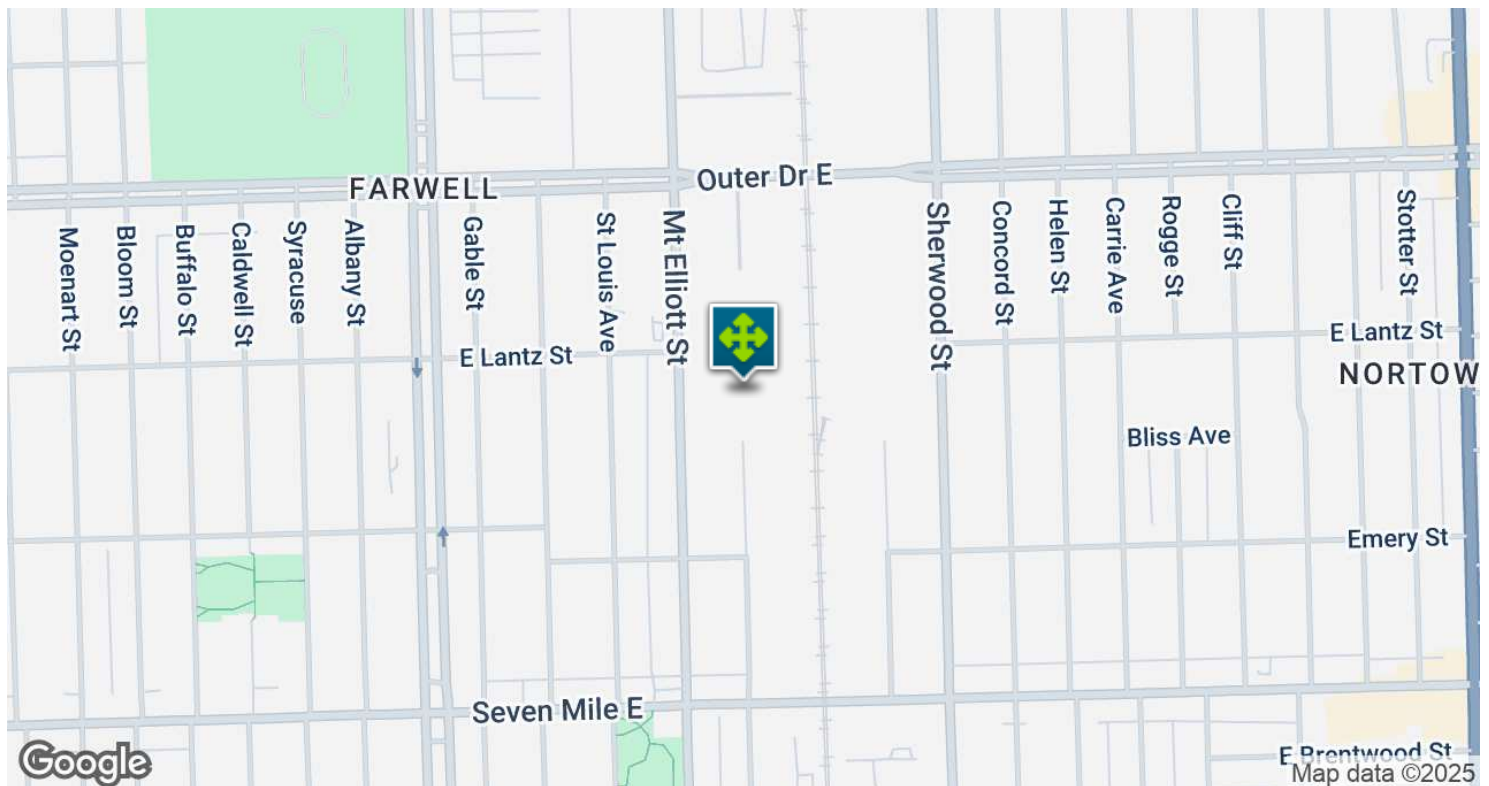
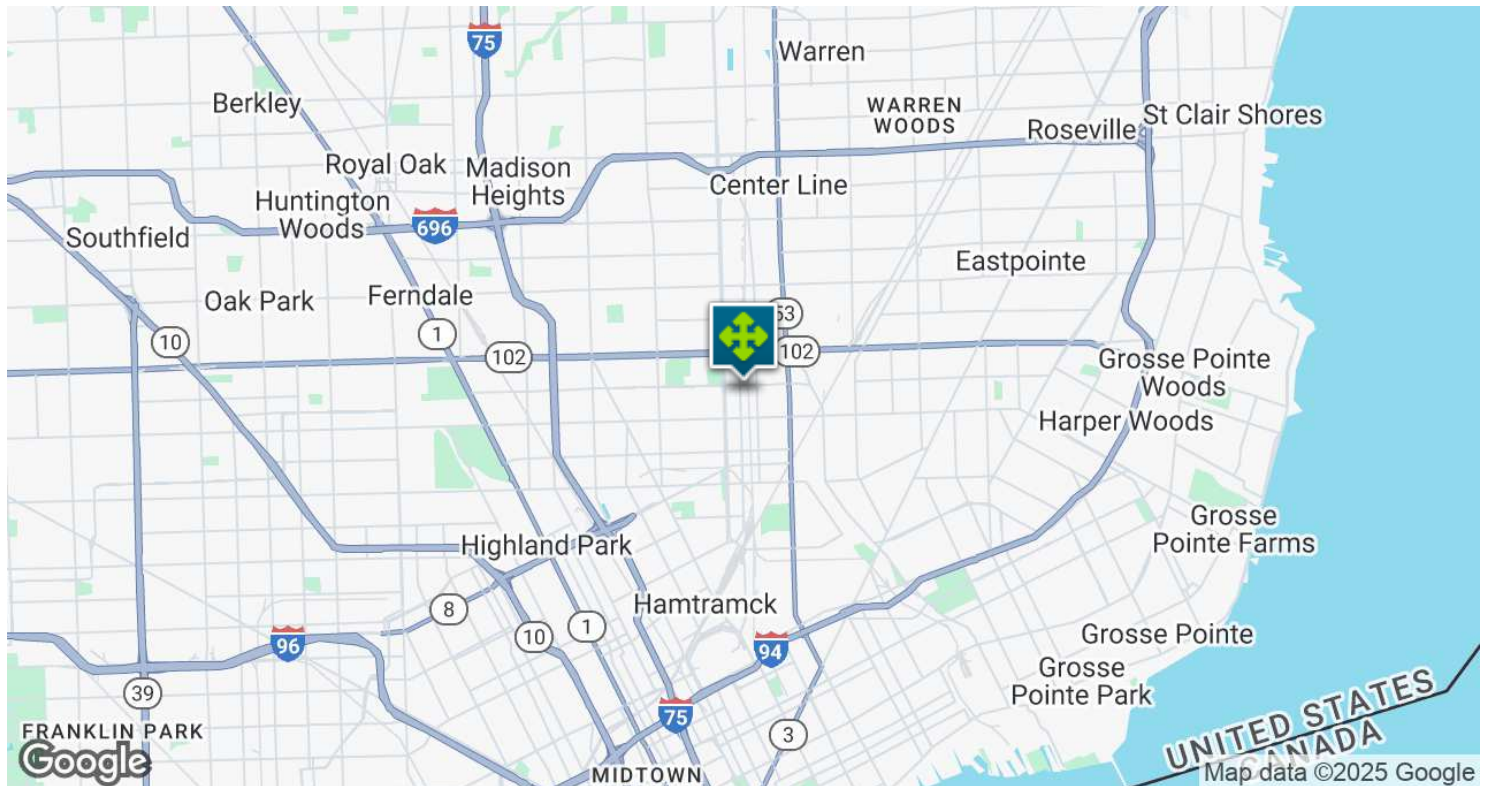

19430 MOUNT ELLIOTT ST, DETROIT, MI 48234 // FOR SALE / LEASE

DEMOGRAPHICS MAP & REPORT

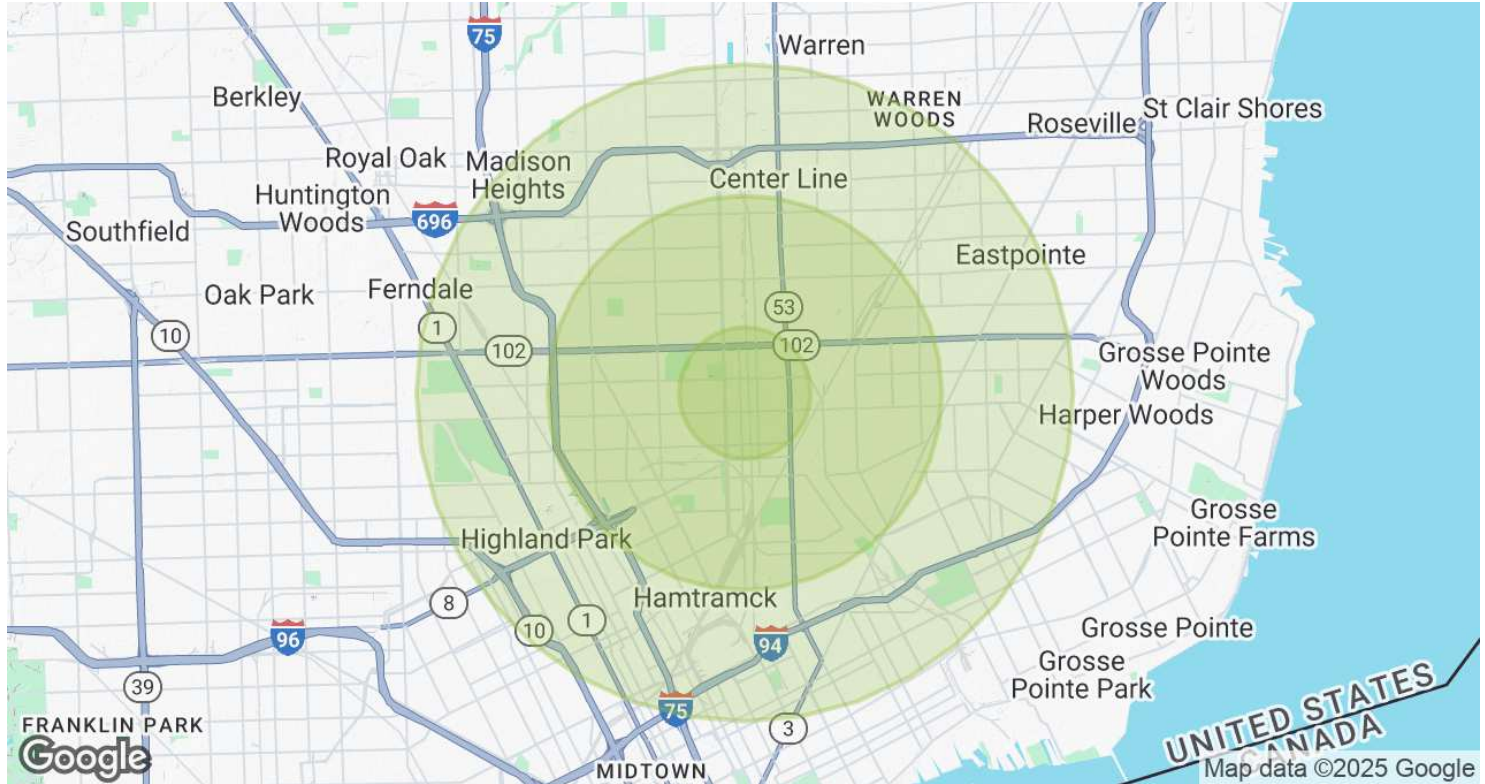

POPULATION	1 MILE	3 MILES	5 MILES
Total Population	12,759	132,330	323,314
Average Age	38	37	38
Average Age (Male)	36	36	37
Average Age (Female)	39	37	39

HOUSEHOLDS & INCOME	1 MILE	3 MILES	5 MILES
Total Households	4,907	47,626	126,374
# of Persons per HH	2.6	2.8	2.6
Average HH Income	\$50,365	\$52,800	\$60,587
Average House Value	\$90,870	\$106,386	\$136,567

Demographics data derived from AlphaMap

19430 MOUNT ELLIOTT ST, DETROIT, MI 48234 // FOR SALE / LEASE

CONTACT US

PRICE REDUCED!

FOR MORE INFORMATION, PLEASE CONTACT:



Kevin Bull

SENIOR ASSOCIATE

D: 248.358.5361

C: 248.895.9972

kevin@pacommercial.com

P.A. Commercial

26555 Evergreen Road, Suite 1500

Southfield, MI 48076

P: 248.358.0100

F: 248.358.5300

pacommercial.com

Follow Us!



P.A. COMMERCIAL
Corporate & Investment Real Estate

We obtained the information above from sources we believe to be reliable. However, we have not verified its accuracy and make no guarantee, warranty or representation about it. It is submitted subject to the possibility of errors, omissions, change of price, rental or other conditions, prior sale, lease or financing, or withdrawal without notice. We include projections, opinions, assumptions or estimates for example only, and they may not represent current, past or future performance of the property. You and your tax and legal advisors should conduct your own investigation of the property and transaction.