



TRANSWESTERN

REAL ESTATE  
SERVICES

# SAINT PAUL INDUSTRIAL PROPERTIES #35

2833 FAIRVIEW AVE N | ROSEVILLE, MN 55113

# PROPERTY SPECIFICATIONS



**Building Size:** 9,800 SF

**Availability:** 9,800 SF Office/Lab Space

**Loading:** 1 Dock | 1 Drive-In (7' x 10')

**Clear Height:** 14'

**Lease Rates:** \$9.25 PSF Office  
\$4.75 PSF Warehouse

**Taxes:** \$2.66 PSF (2022)

**Operating Expenses:** \$1.84 PSF (2022)

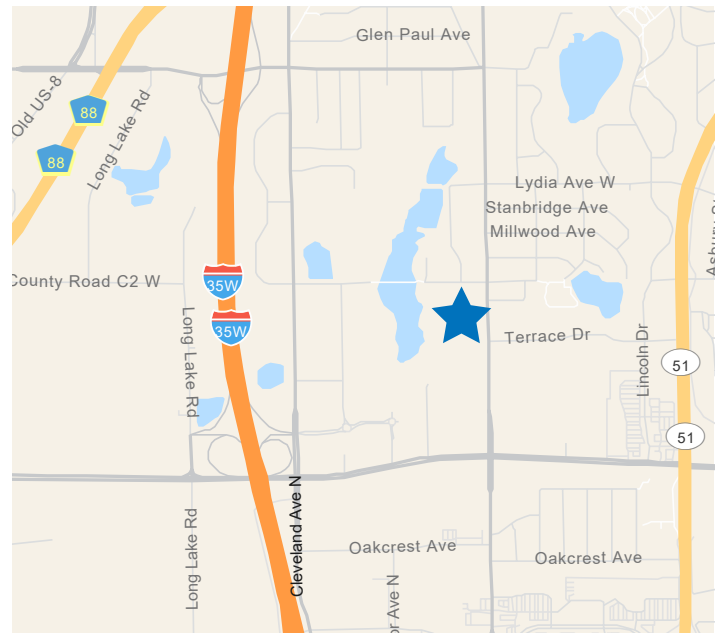





**TRANSWESTERN**

REAL ESTATE  
SERVICES

# THINKING BEYOND THE OBVIOUS

---

**ALEX BARON**

612.359.1658

[alex.baron@transwestern.com](mailto:alex.baron@transwestern.com)

**JOHN THOMPSON, SIOR**

612.359.1645

[john.thompson@transwestern.com](mailto:john.thompson@transwestern.com)