

OFFICE/FLEX/WAREHOUSE SUBLEASE | AMENITY RICH LOCATION

# 411 WAVERLEY OAKS ROAD

Waltham, Massachusetts



TERM THROUGH SEPTEMBER 30, 2026

**2,000 - 6,000 SF Available**

# 411 WAVERLEY OAKS ROAD

Waltham, Massachusetts

## PROPERTY SPECIFICATIONS

<b>BUILDING SIZE:</b>	207,600 SF
<b>AVAILABLE SPACE:</b>	First Floor: 2,000 - 6,000 SF
<b>PARKING:</b>	1.17/1,000 SF
<b>CLEAR HEIGHT:</b>	14'
<b>LOADING:</b>	One (1) Tailboard Loading Dock
<b>FURNITURE:</b>	Negotiable
<b>TERM:</b>	Through 9/30/2026
<b>WAVERLEY OAKS PARK AMENITIES:</b>	Athletic Club, Walking Trails, Cafe, Mighty Squirrel Brewery, Shuttle to Alewife Station, Food Trucks



**FLOOR PLANS**

FLOOR 1 | 2,000 - 6,000 SF

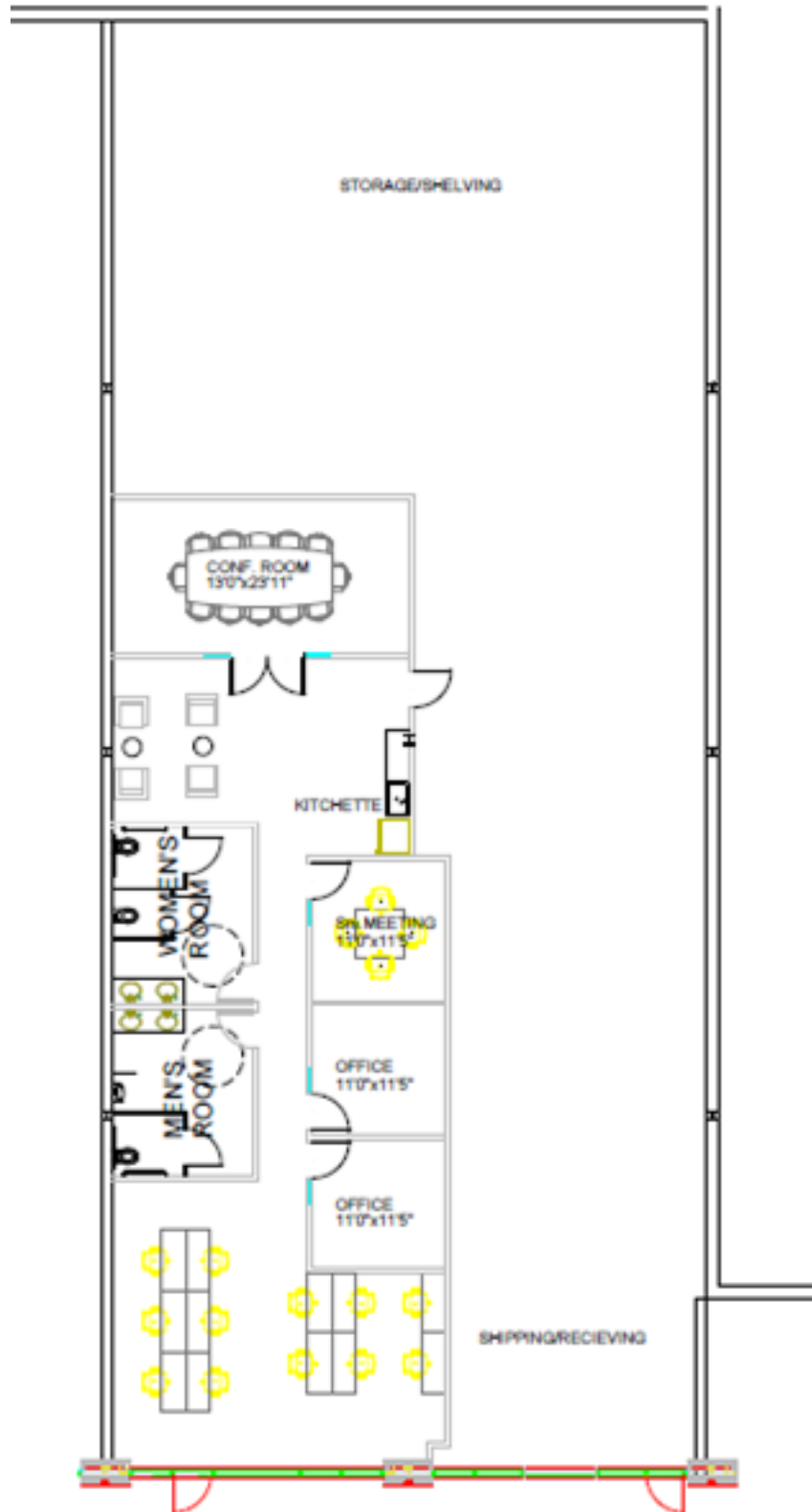

OFFICE/FLEX/WAREHOUSE

# 411 WAVERLEY OAKS ROAD

Waltham, Massachusetts



## CONTACT US TO ARRANGE A TOUR

**PATRICK GRADY**

781.820.9881

[pgrady@hunnemanre.com](mailto:pgrady@hunnemanre.com)

**STEVE JAMES**

617.775.9720

[sjames@hunnemanre.com](mailto:sjames@hunnemanre.com)

**JIM BOUDROT**

617.957.1407

[jboudrot@hunnemanre.com](mailto:jboudrot@hunnemanre.com)

**HENRY BIRMINGHAM**

508.903.7627

[hbirmingham@hunnemanre.com](mailto:hbirmingham@hunnemanre.com)



303 Congress Street, Boston, MA 02210 617.457.3400 [www.hunnemanre.com](http://www.hunnemanre.com)

@2023 Hunneman. All rights reserved. All information has been obtained from sources believed reliable but no warranty or representation is verified for accuracy or completeness. Caution and independent investigation of property and information should be verified. Reliance on this information is at your own risk.