



● HIGHLIGHTS

- **Cameron Court Office Park**
- **MEDICAL & OFFICE USE**
- Campus setting with 4 office buildings surrounding an interior courtyard
- Ample, free surface parking
- Professionally managed
- Elevator service and common area restrooms
- Immediate 10 freeway access
- Easy connect to 57, 60, 210 & 605 freeways
- Located in West Covina's Civic Center near the Superior Court House, Police Station, Library & Plaza Mall

OFFICE USE RATE	\$2.10 PSF/FSG
MEDICAL USE RATE	\$2.35 PSF/FSG

AVAILABILITY

495 SF - 14,836 SF

● PROPERTY DETAILS

Campus Building Size	±118,433 SF
Year Renovated	1992
Parking	3.3:1,000
Elevator	Yes



For more information please contact:

CHRISTOPHER LARIMORE
Founding Principal
D • 626.240.2788
E • clarimore@lee-associates.com
LICENSE ID #01314464

VINCENT MOLITOR
Founding Principal
D • 626.240.2787
E • vmolitor@lee-associates.com
LICENSE ID #01295360

LEE & ASSOCIATES - PASADENA, INC.
1055 E. Colorado Blvd., Suite 330
Pasadena, CA 91106
Corporate ID 02059558
lee-pasadena.com

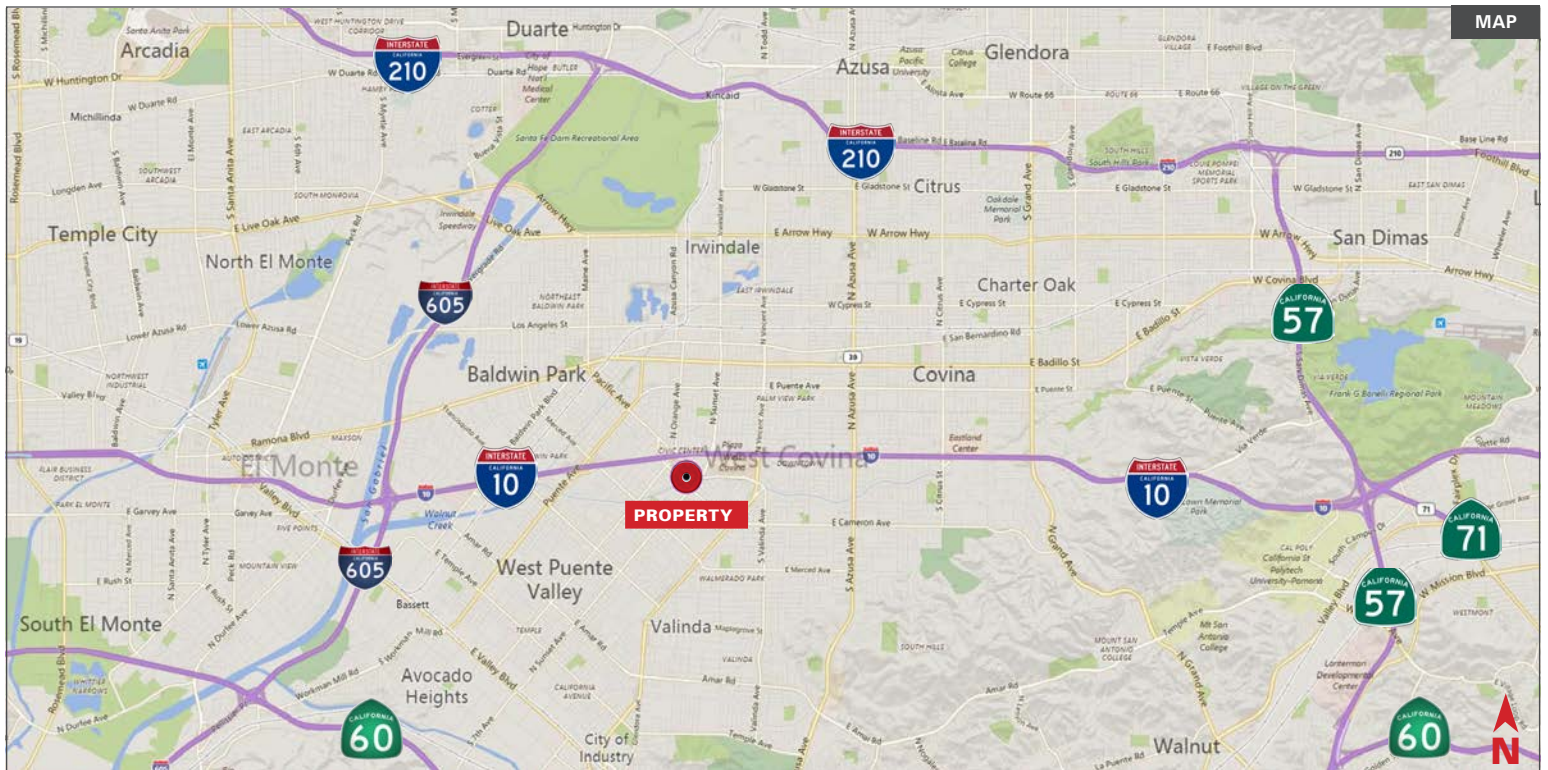

For more information please contact:

CHRISTOPHER LARIMORE
Founding Principal
D • 626.240.2788
E • clarimore@lee-associates.com
LICENSE ID #01314464

VINCENT MOLITOR
Founding Principal
D • 626.240.2787
E • vmolitor@lee-associates.com
LICENSE ID #01295360

LEE & ASSOCIATES - PASADENA, INC.
1055 E. Colorado Blvd., Suite 330
Pasadena, CA 91106
Corporate ID 02059558
lee-pasadena.com

SITE PLAN

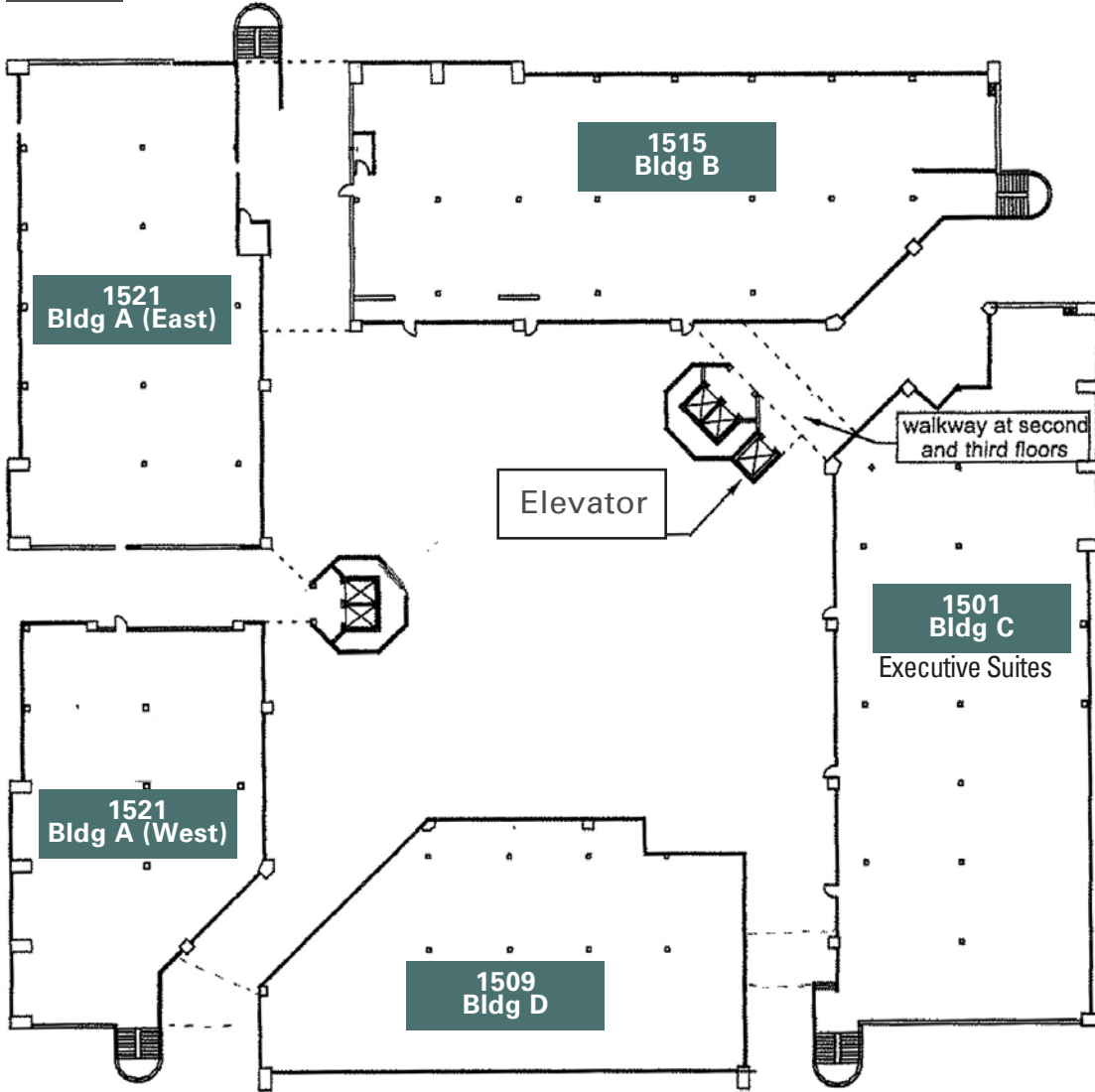

1501 CAMERON - BLDG C

SUITE	SQ. FT.
300	10,610

1509 CAMERON - BLDG D

SUITE	SQ. FT.
220	1,037
240	690

1515 CAMERON - BLDG B

SUITE	SQ. FT.
210	3,546
225	3,663
270	725

1521 CAMERON - BLDG A

SUITE	SQ. FT.
200	7,623
210	1,909
300	14,836



For more information please contact:

CHRISTOPHER LARIMORE

Founding Principal
 D • 626.240.2788
 E • clarimore@lee-associates.com
 LICENSE ID #01314464

VINCENT MOLITOR

Founding Principal
 D • 626.240.2787
 E • vmolitor@lee-associates.com
 LICENSE ID #01295360

LEE & ASSOCIATES - PASADENA, INC.
 1055 E. Colorado Blvd., Suite 330
 Pasadena, CA 91106
 Corporate ID 02059558
 lee-pasadena.com