

4288 W HOLT BLVD, MONTCLAIR, CA | \pm 1,300 SF - 13,600 SF

FOR
LEASE

COMING SOON: AVAILABLE SEPTEMBER 1, 2024



**BRAND NEW
RETAIL STOREFRONT
ON CORNER
THOROUGHFARE**

THE YAMZON TEAM

JORGE YAMZON

Remax Commercial
Senior Vice President / Director
Direct: 626-786-5869
Email: Jorgeyamzon@remax.net
CA DRE LICENSE #01359483

DEREK ING

Remax Commercial
Senior Sales Associate
Direct: 626-272-0948
Email: Dereking.remaxcre@gmail.com
CA DRE LICENSE #02041751

JESSE SANCHEZ

Remax Commercial
Senior Sales Associate
Direct: 909-235-2776
Email: Jessesanchezremaxcre@gmail.com
CA DRE LICENSE #02092550

SPACE INFORMATION

- Leasable Space: \pm 1,300 - 13,600 SF
- Lot Size: \pm 59,242 SF
- Corner Streets: Holt Ave & Amherst
- Traffic Count: 24,916 VPD
- Zoning: Commercial Retail
- APN: 1009-514-06

PROPERTY HIGHLIGHTS

- Brand New Development
- Great Exposure and Visibility on Main Thoroughfare
- High Traffic Count
- Close Proximity to CA 10 & 60
- Ample Parking



THIS INFORMATION HAS BEEN SECURED FROM SOURCES WE BELIEVE TO BE RELIABLE, BUT WE MAKE NO REPRESENTATIONS OR GUARANTEES, EXPRESSED OR IMPLIED, AS TO THE ACCURACY OF THE INFORMATION. REFERENCES TO SQUARE FOOTAGE OR AGE ARE APPROXIMATE. BUYER MUST VERIFY THE INFORMATION AND BEARS ALL RISK FOR ANY INACCURACIES.

SITE PLAN

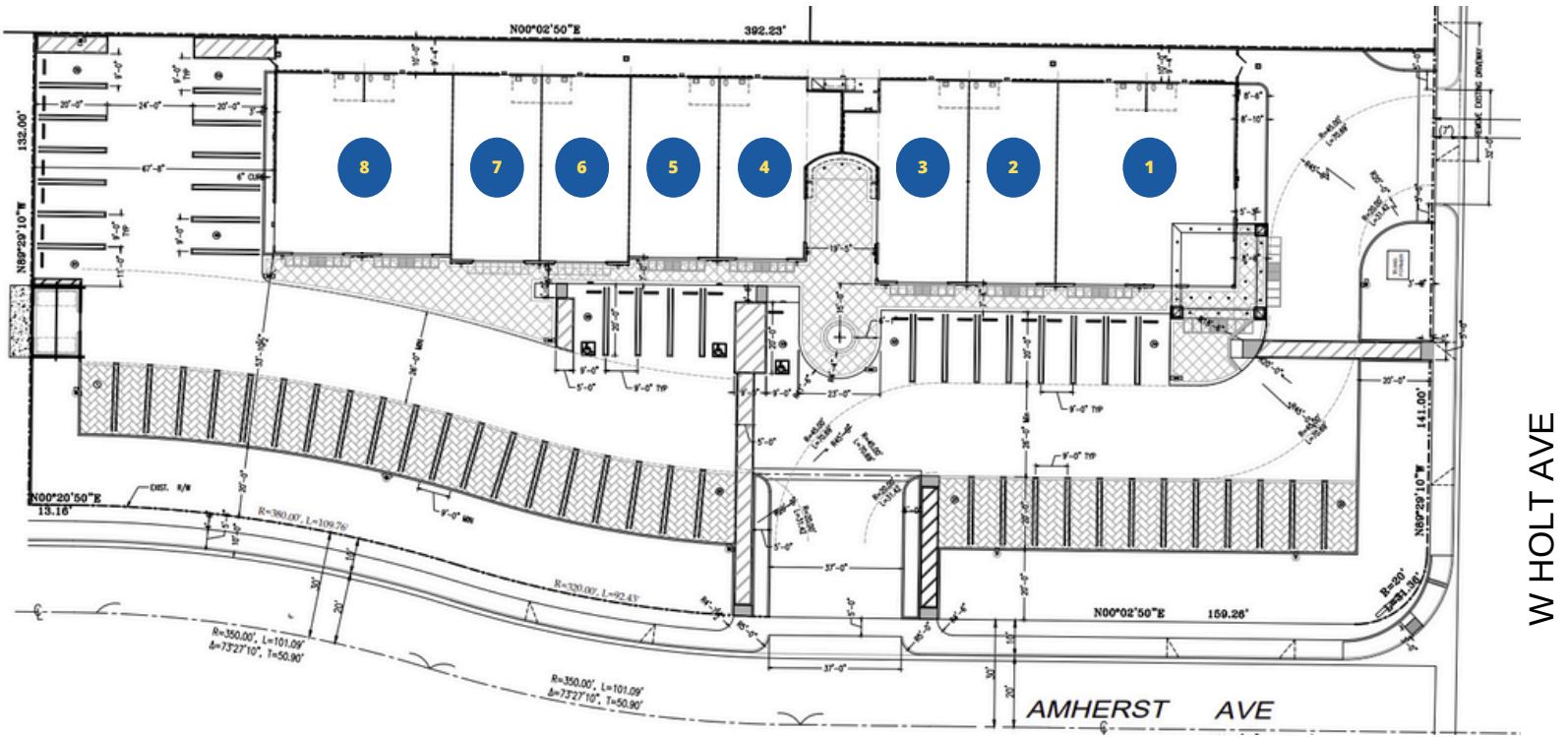

UNIT SIZE

- 1** ± 2,840 SF
- 2** ± 1,409 SF
- 3** ± 1,561 SF
- 4** ± 1,426 SF
- 5** ± 1,260 SF
- 6** ± 1,296 SF
- 7** ± 1,296 SF
- 8** ± 2,508 SF



GREAT EXPOSURE AND VISIBILITY ON MAIN THOROUGHFARE
HIGH TRAFFIC COUNT: APPROXIMATELY 24,916 VEHICLES PER DAY

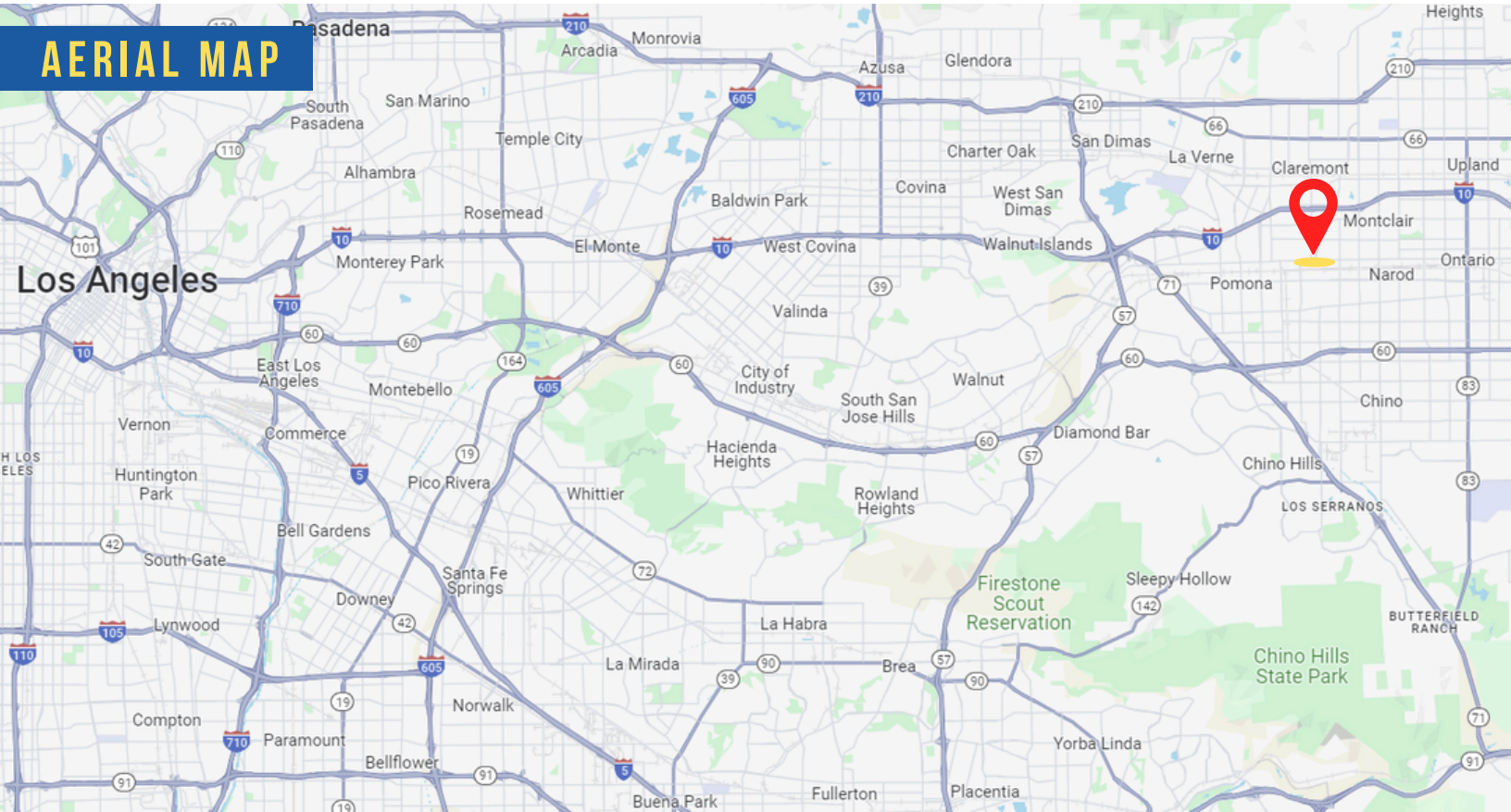

THE YAMZON TEAM

CONTACT

JORGE YAMZON

Remax Commercial

Senior Vice President / Director

Direct: 626-786-5869

Email: Jorgeyamzon@remax.net

CA DRE LICENSE #01359483

DEREK ING

Remax Commercial

VP / Senior Analyst

Direct: 626-272-0948

Email: Dereking.remaxcre@gmail.com

CA DRE LICENSE #02041751

JESSE SANCHEZ

Remax Commercial

Senior Sales Associate

Direct: 909-235-2776

Email: Jessesanchezremaxcre@gmail.com

CA DRE LICENSE #02092550