



For Lease

16250 W. 110th Street Lenexa, Kansas

Property Features

- Available space: 15,000± SF
 - Office area: 2,000 SF
- Year built: 1992
- Construction type: concrete
- Loading: 2 dock-high; 1 drive-in (16'x14')
- Clear height: 20'-26'
- Parking: 22 spaces
- Sprinkler system: wet
- Electrical service: 800 amp, 480v, 3-phase
- Zoning: BP2
- Lease rate: \$7.50 PSF net
- Nets:
 - Taxes: \$1.87 PSF
 - Insurance: \$0.13 PSF
 - CAM: \$0.50 PSF

John Stafford, SIOR

Vice Chair
+1 816 556 1184
john.stafford@colliers.com

Colliers Kansas City

4900 Main Street, Suite 400
Kansas City, Missouri 64112
+1 816 531 5303
colliers.com/kansascity

16250 W. 110th Street

Floor Plan

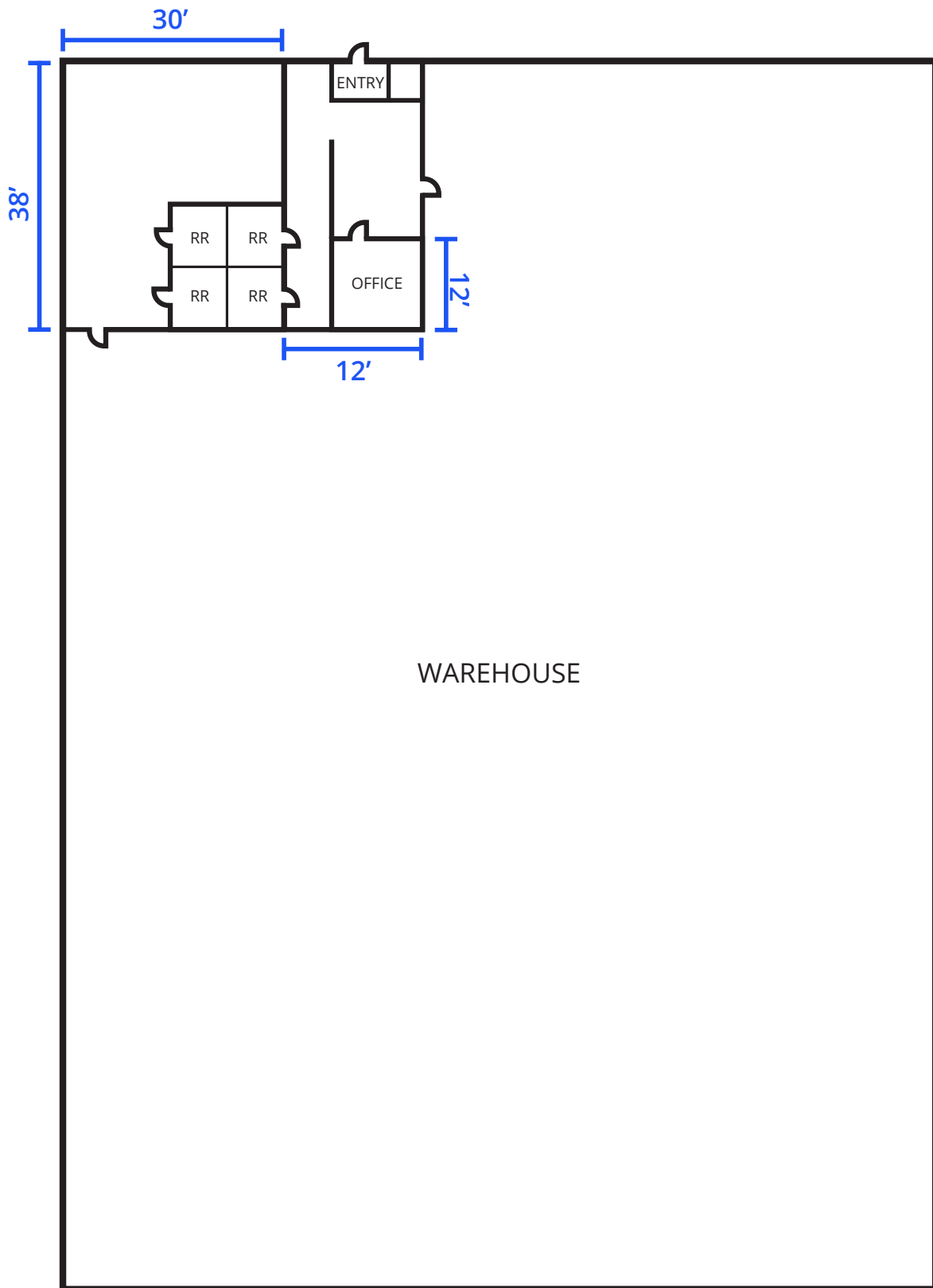

16250 W. 110th Street

Location Aerial

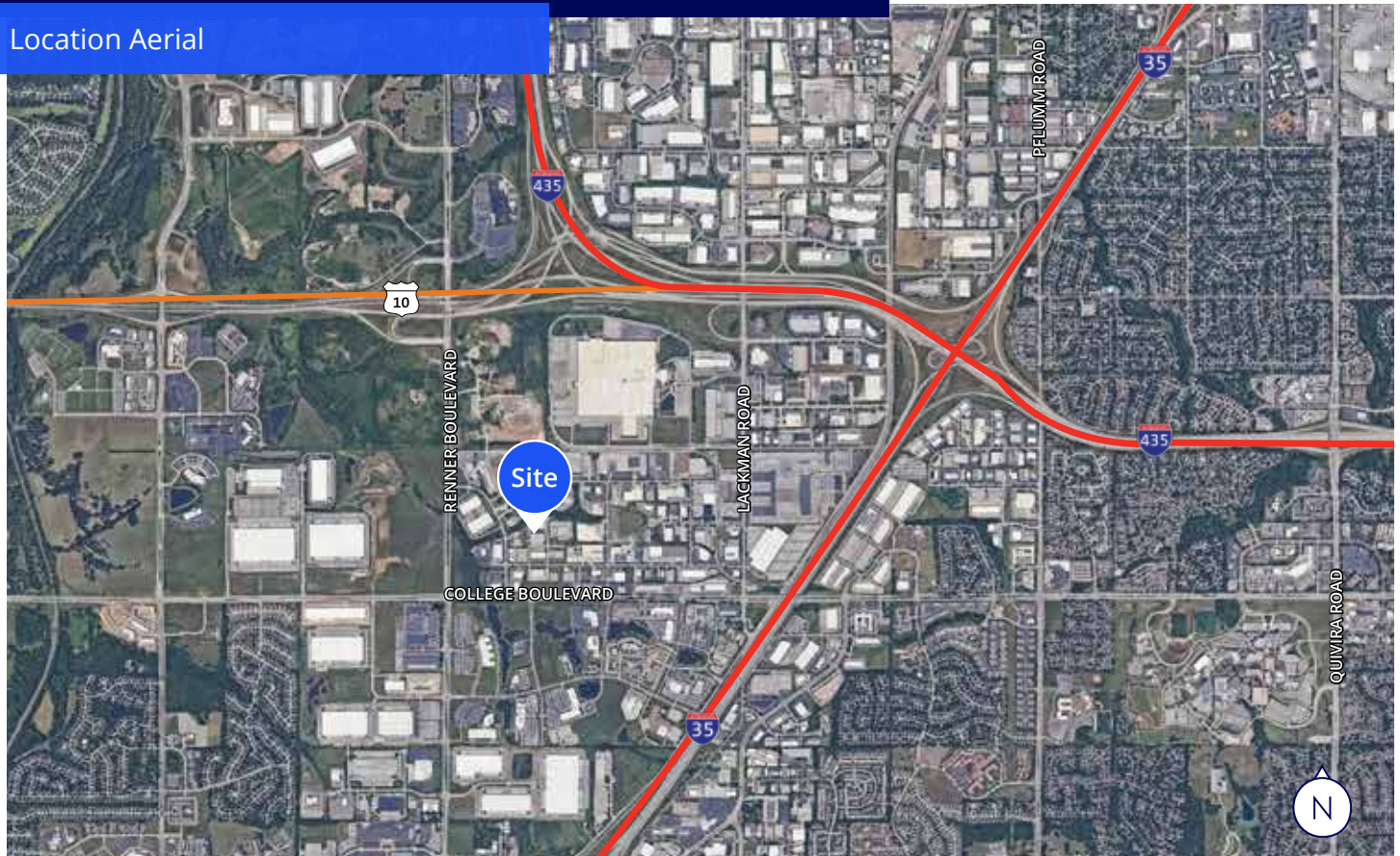

Site Aerial



16250 W. 110th Street

Loading

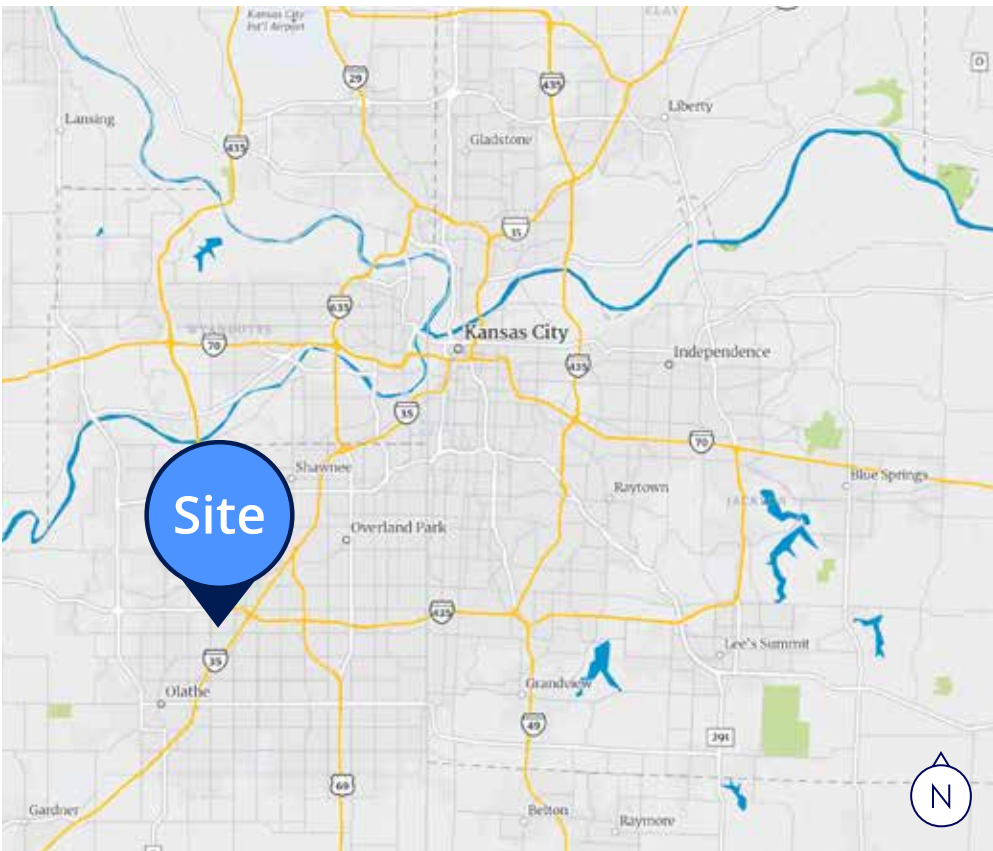

John Stafford, SIOR

Vice Chair

+1 816 556 1184

john.stafford@colliers.com

Colliers Kansas City

4900 Main Street, Suite 400

Kansas City, MO 64112

+1 816 531 5303

colliers.com/kansascity

