

PROPERTY SUMMARY



OFFERING SUMMARY

LEASE RATE:	\$500-\$1200 per month
NUMBER OF UNITS:	6
AVAILABLE SF:	120 SF
BUILDING SIZE:	15,000 SF

SUSAN DAVIS

O: 918.924.6199

sdavis@svn.com

OK #024512

CORE OFFICE BUILDING | 7690 East 126th Street South Bixby, OK 74008

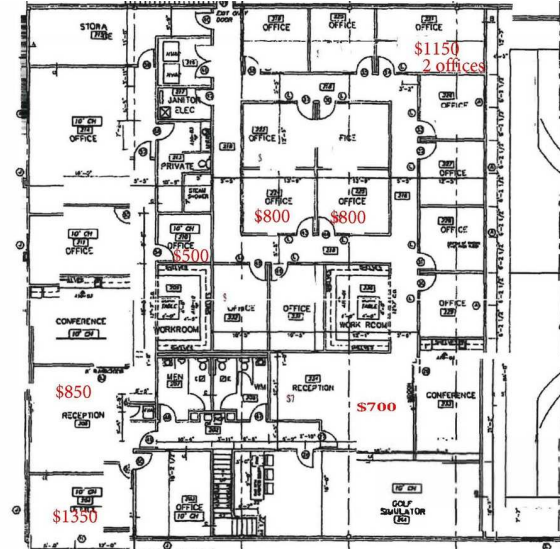

PROPERTY DESCRIPTION

Single offices for lease
Short term available
Gym membership with lease

PROPERTY HIGHLIGHTS

- Second Floor offices
- Gym membership with lease
- Single or multiple offices
- Shared conference room with shared break room
- Prices start at \$500 per month

SVN | OAK REALTY ADVISORS 1