

961 N AIR DEPOT BLVD MIDWEST CITY, OK 73110



COMMERCIAL
OKLAHOMA



± 5.00 AC FOR SALE

AVAILABLE NOW

LOT SIZE: ± 5.00 ACRES /
± 217,800 SF

SUBMARKET: East Oklahoma City

ZONING: R-6; Single Family Detached Residential District

UTILITIES: To Site

- Located at the corner of NE 10th & Air Depot Blvd in Midwest City, OK.
- 12 Mins north of Tinker Air Force Base

SALE PRICE: \$1,960,000

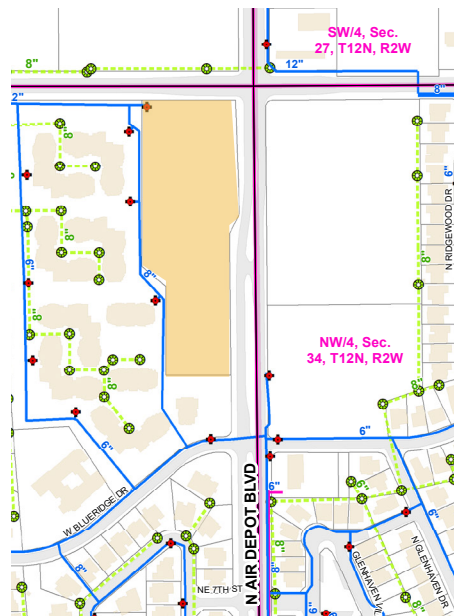

The City of
Midwest City
Water/Sewer
Infrastructure - 1/4 Secs
C-1 NE
NE/4, Sec. 33, T12N, R2W
July 6, 2020

Legend	
	Public Fire Hydrants
	Sewer Manholes
	Distribution Water Lines
	Well Water Lines
	OKC Cross Country Water Lines
	Sooner Utilities Water Lines
	Thunderbird Water Lines
	Sewer Lines
	Landmark Buildings
	Parcels in MWC
	Township/Range/Section Grid



BROKER CONTACT

EVAN ALTEMUS
+1 405 768 3444

ealtemus@commercialoklahoma.com

961 N AIR DEPOT BLVD MIDWEST CITY, OK 73110



COMMERCIAL
OKLAHOMA

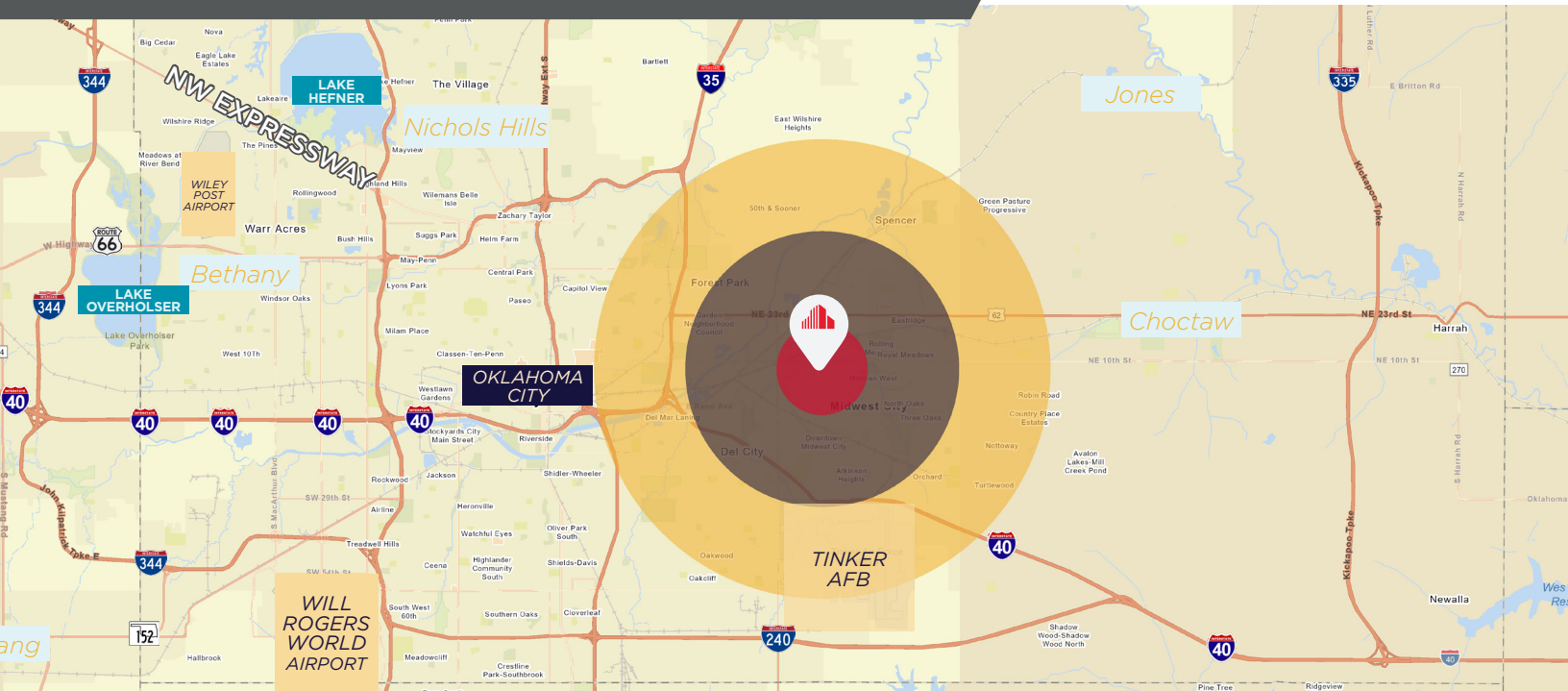

Demographics	1 Mile	3 Miles	5 Miles
2020 Population	10,540	53,455	112,328
2024 Population	10,478	53,835	113,429
2029 Est Population	10,539	54,303	114,995
2024 Daytime Population	8,221	55,766	115,757
2020 Total Households	4,510	22,748	46,005
2024 Total Households	4,557	22,977	46,789
2029 Est Total Households	4,616	23,294	47,730
2024 Average HH Income	\$77,115	\$63,770	\$68,673
2029 Est Average HH Income	\$90,205	\$75,177	\$81,217

Source: Esri forecasts for 2024 and 2029. U.S. Census Bureau 2000 and 2010 decennial Census data converted by Esri into 2020 geography.

BROKER CONTACT

EVAN ALTEMUS
+1 405 768 3444
ealtemus@commercialoklahoma.com

± 5.00 ACRES
LAND FOR SALE
\$1,960,000

©2025 Cushman & Wakefield | Commercial Oklahoma . Independently Owned and Operated / A Member of the Cushman & Wakefield Alliance All rights reserved. The information contained in this communication is strictly confidential. This information has been obtained from sources believed to be reliable but has not been verified. NO WARRANTY OR REPRESENTATION, EXPRESS OR IMPLIED, IS MADE AS TO THE CONDITION OF THE PROPERTY (OR PROPERTIES) REFERENCED HEREIN OR AS TO THE ACCURACY OR COMPLETENESS OF THE INFORMATION CONTAINED HEREIN, AND SAME IS SUBMITTED SUBJECT TO ERRORS, OMISSIONS, CHANGE OF PRICE, RENTAL OR OTHER CONDITIONS, WITHDRAWAL WITHOUT NOTICE, AND TO ANY SPECIAL LISTING CONDITIONS IMPOSED BY THE PROPERTY OWNER(S). ANY PROJECTIONS, OPINIONS OR ESTIMATES ARE SUBJECT TO UNCERTAINTY AND DO NOT SIGNIFY CURRENT OR FUTURE PROPERTY PERFORMANCE.