

HILLSBOROUGH & GEORGE ROAD, TAMPA, FL



2.10 acres of Land behind the Thortons on the corner of Hillsborough & George Road. CG zoning perfect for Hospitality/Hotel.

PROPERTY HIGHLIGHTS

- For Lease or Build to Suit
- 2.10 +/- acres
- Offsite Retention Pond
- Zoning CG
- ADT:
 - Hillsborough & George Rd: 59,500
 - Veterans Expressway: 67,000
- Proximity:
 - 4.6 miles to Tampa International Airport
 - 4.4 miles to International Plaza Mall
 - 4.2 miles to Westshore Business District

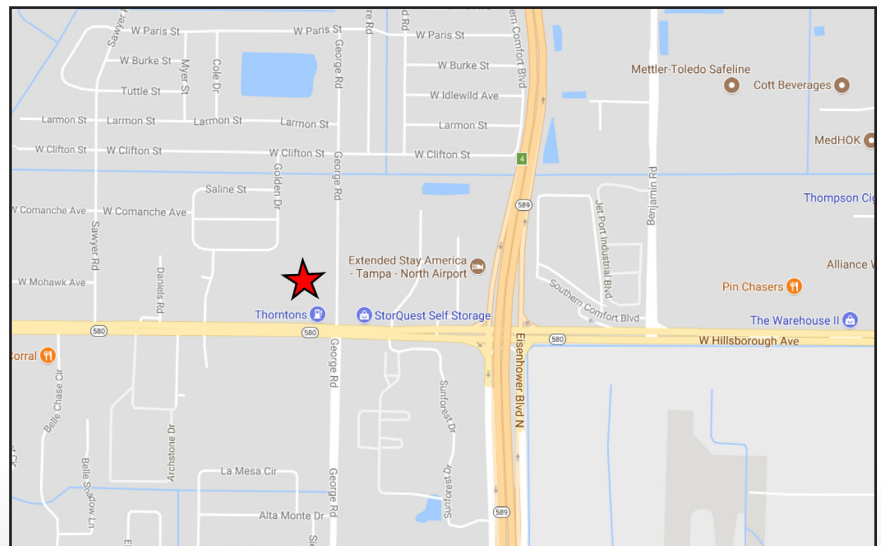

ASSIGNED AGENTS

Ryan Lolkus, President
Email: rloklus@thekraussorg.com
Office: (813) 885-5656
Cell: (727) 631-4697

SITE PLAN

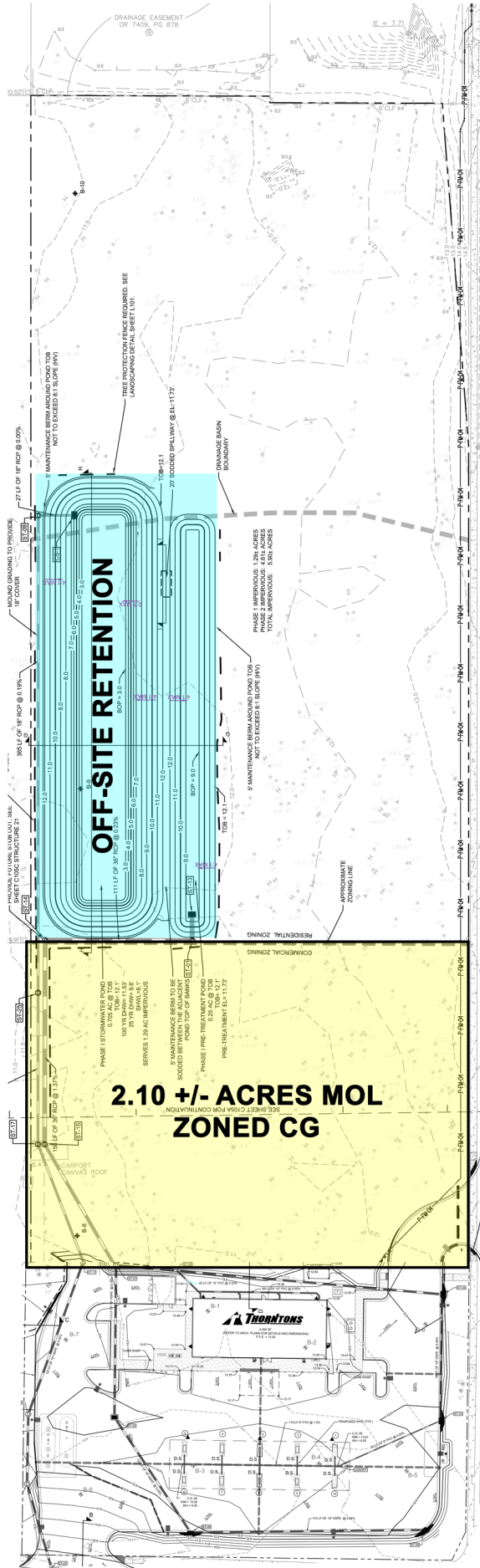

GEORGE ROAD



HILLSBOROUGH ROAD