



34 N LAKEWOOD AVE

34 N LAKEWOOD AVE
TULSA, OK 74115

Susan Davis
O: 918.924.6199
sdavis@svn.com

R16975930305910 (09/2023)

Property Summary

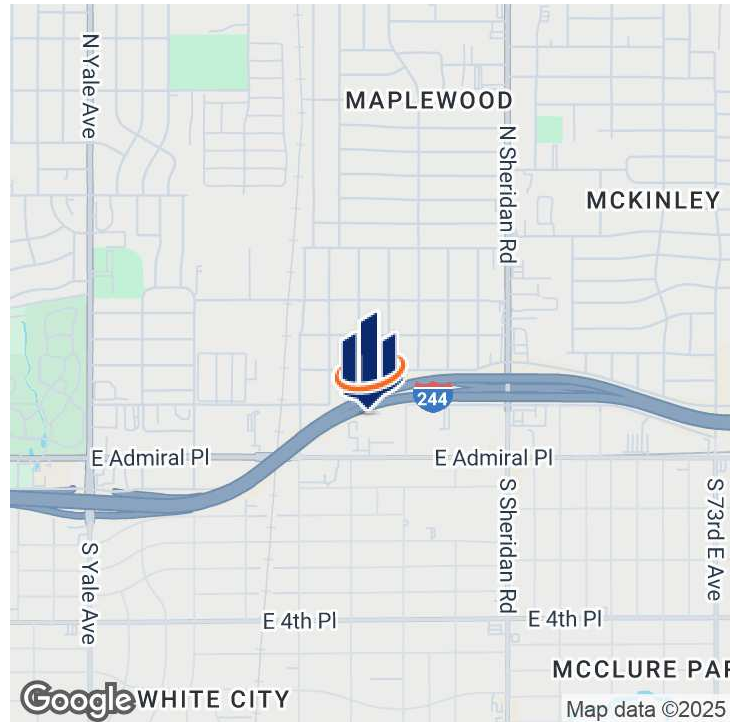

OFFERING SUMMARY

Lease Rate:	\$7.00 SF/yr (MG)
Number of Units:	6
Available SF:	30,388 SF
Lot Size:	97,516 SF
Building Size:	30,388 SF

PROPERTY DESCRIPTION

Former Overhead Garage Door Company
Six Buildings
Ample Parking
1-Dock Well
15 Overhead Doors

PROPERTY HIGHLIGHTS

- - Six versatile buildings for flexible use
- - Spacious warehouse for storage and operations
- - Showroom for customer engagement
- - 15 convenient overhead doors for easy access
- - Efficient dock well for loading and unloading
- - Ample parking for employees and visitors
- - Well-maintained grounds and landscaping
- - High visibility and easy access from N Lakewood Ave and Admiral Place

Additional Photos



3-05910
ood Ave E

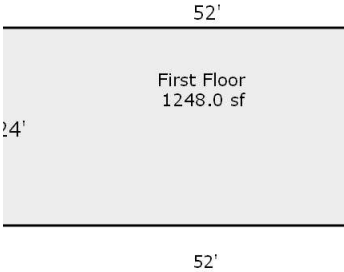
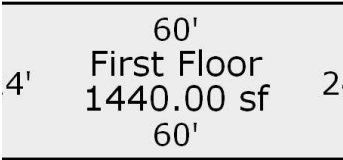
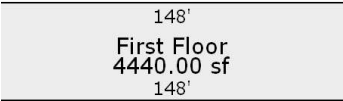
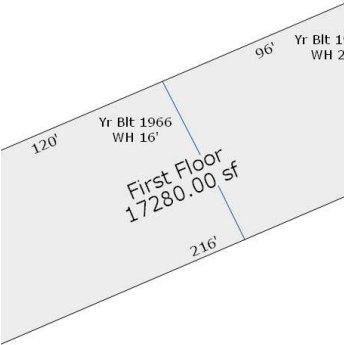
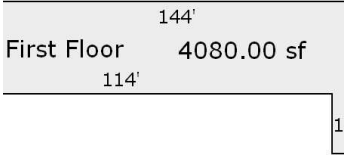
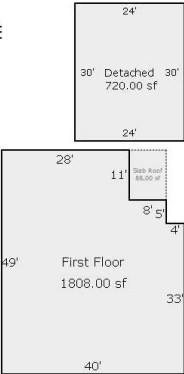

Location Map

