

FOR LEASE

NORTHWEST INDUSTRIAL CENTER 10633 WEST LITTLE YORK, SUITE 150 63,956 SF AVAILABLE

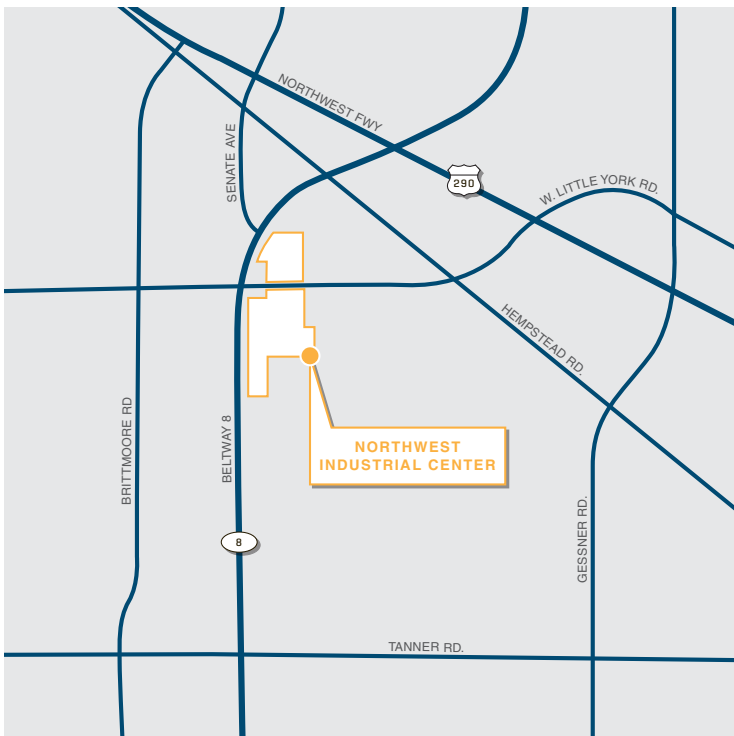

SUITE HIGHLIGHTS

- 63,956 SF total
- 11,858 SF of office
- 52,098 SF of warehouse
- 24' clear height
- 18 dock high doors
- 1 ramp
- Divisible to 28,640 SF

BUILDING HIGHLIGHTS

- Direct frontage on Beltway 8
- 2.3:1,000 parking ratio

For leasing information, please contact **Stream**
Jeremy Lumbreras | 713.300.0322 | jlumbreras@streamrealty.com
Jeff Pate | 713.300.0295 | jeff.pate@streamrealty.com
Matteson Hamilton | 713.300.0299 | mhamilton@streamrealty.com



NORTHWEST INDUSTRIAL CENTER
10633 WEST LITTLE YORK, SUITE 150
63,956 SF AVAILABLE

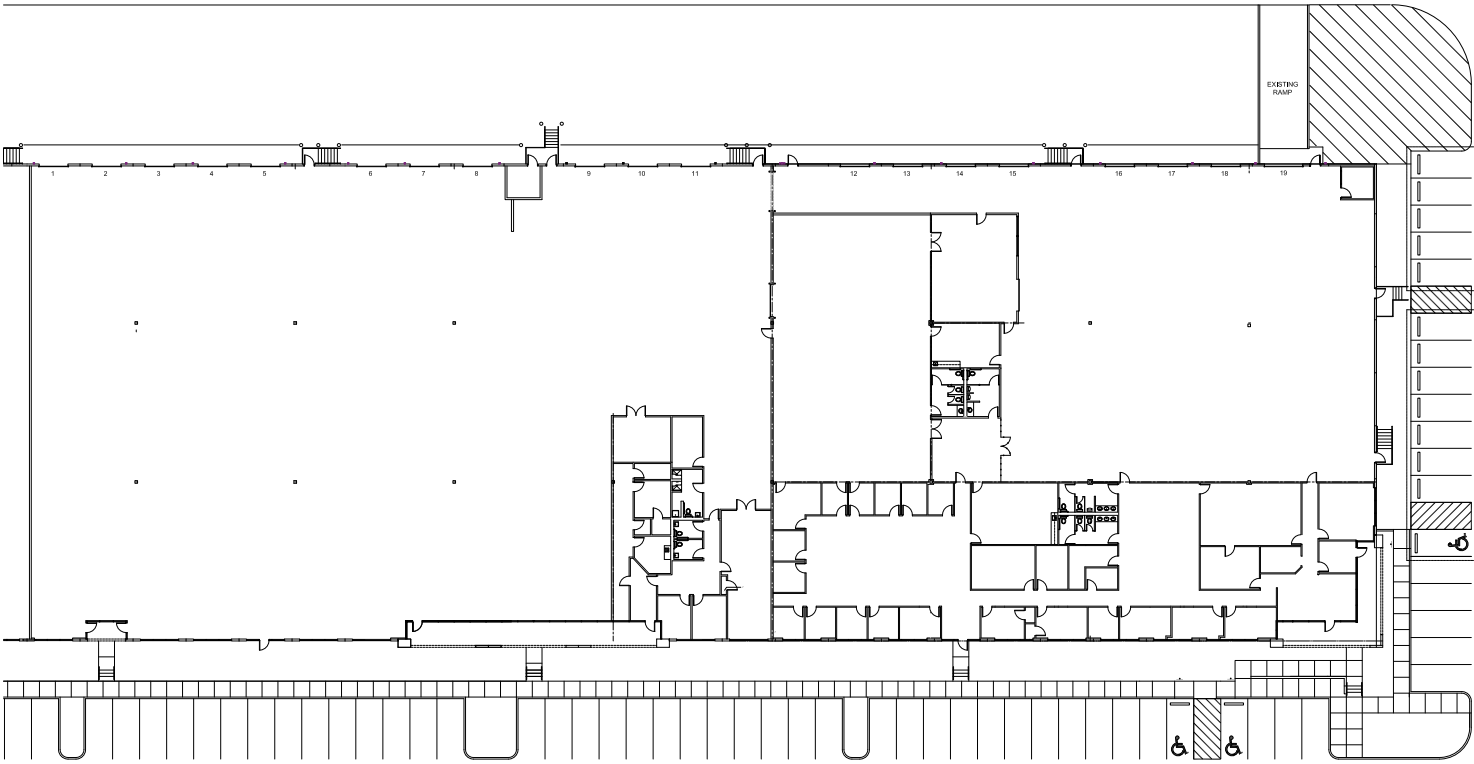

For leasing information, please contact **Stream**
Jeremy Lumbreras | 713.300.0322 | jlumbreras@streamrealty.com
Jeff Pate | 713.300.0295 | jeff.pate@streamrealty.com
Matteson Hamilton | 713.300.0299 | mhamilton@streamrealty.com

