

# LEASE

**PROFESSIONAL OFFICE SPACE**

**4885 RIVERSIDE DRIVE**

**MACON, BIBB COUNTY, GEORGIA 31210**

**LEASE RATE: \$16.00/RSF, FULL SERVICE**



**PROPERTY VIDEO: [HTTPS://WWW.YOUTUBE.COM/WATCH?V=GOLZBTMJYVG](https://www.youtube.com/watch?v=GOLZBTMJYVG)**

**STEPHANIE FOLSOM, CCIM**

**478.361.8259**

**stephanie@cbcgeorgia.com**

**990 Riverside Drive**

**Macon, GA 31201**



**COLDWELL BANKER  
COMMERCIAL**

**EBERHARDT & BARRY**

©2024 Coldwell Banker. All Rights Reserved. Coldwell Banker Commercial® and the Coldwell Banker Commercial logo are trademarks of Coldwell Banker Real Estate LLC. The Coldwell Banker® System is comprised of company owned offices which are owned by a subsidiary of Anywhere Advisors LLC and franchised offices which are independently owned and operated. The Coldwell Banker System fully supports the principles of the Equal Opportunity Act. The property information herein is derived from various sources that may include, but not be limited to, county records and may include approximations. Although the information is believed to be accurate, it is not warranted and you should not rely upon it without personal verification.

Created 7/11/24

## PROPERTY INFORMATION

---

Building	<ul style="list-style-type: none"><li>• 83,638 SQ FT</li><li>• Three floors</li><li>• Built in 1991</li></ul>
Available Suites	See Page 3
Floor Plans	See Pages 4 - 6
Zoning	C2
Lot Size	7.28 Acres (1± Acre undeveloped)
Traffic Count	15,000± AVG VPD

---

## PARKING

---

Parking Type	Surface
Number of Parking Spaces	230±
Parking Ratio	3:Spaces per 1,000 SQ FT

---

## PROPERTY HIGHLIGHTS

- 
- Located in North Macon off Interstate 75, Exit 171
  - Directly across from The Shoppes at River Crossing, a 750,000 SF regional open air shopping mall
  - 6 Miles from Downtown Macon
- 

**PROPERTY VIDEO: [HTTPS://YOUTU.BE/GOLZBTMJYVG](https://youtu.be/golzbtmjyvg)**



## AVAILABLE SUITES

SUITE	TENANT	SIZE (RSF)	MONTHLY LEASE RATE
100	Vacant	3,533± RSF	\$4,710.67
101	Dental Sleep Therapy of Macon, LLC		
102	Vacant	3,168± RSF	\$4,224.00
103	Vacant	8,097± RSF	\$10,796.00
125	Coldwell Banker Access Realty		
200 / 205	Lingo Communications		
206	Vacant - Available December 1, 2024	5,000± RSF	\$6,666.67
207	Vacant	9,638± RSF	\$12,850.67
225	Vacant	2,285± RSF	\$3,046.67
300	Vacant	6,279± RSF	\$8,372.00
301	Vacant	7,152± RSF	\$9,536.00
302	Vacant	5,087± RSF	\$6,782.67
310	Carter & Foster, LLC		
311	Vacant	7,089± RSF	\$9,452.00



## FLOOR PLAN - FIRST FLOOR

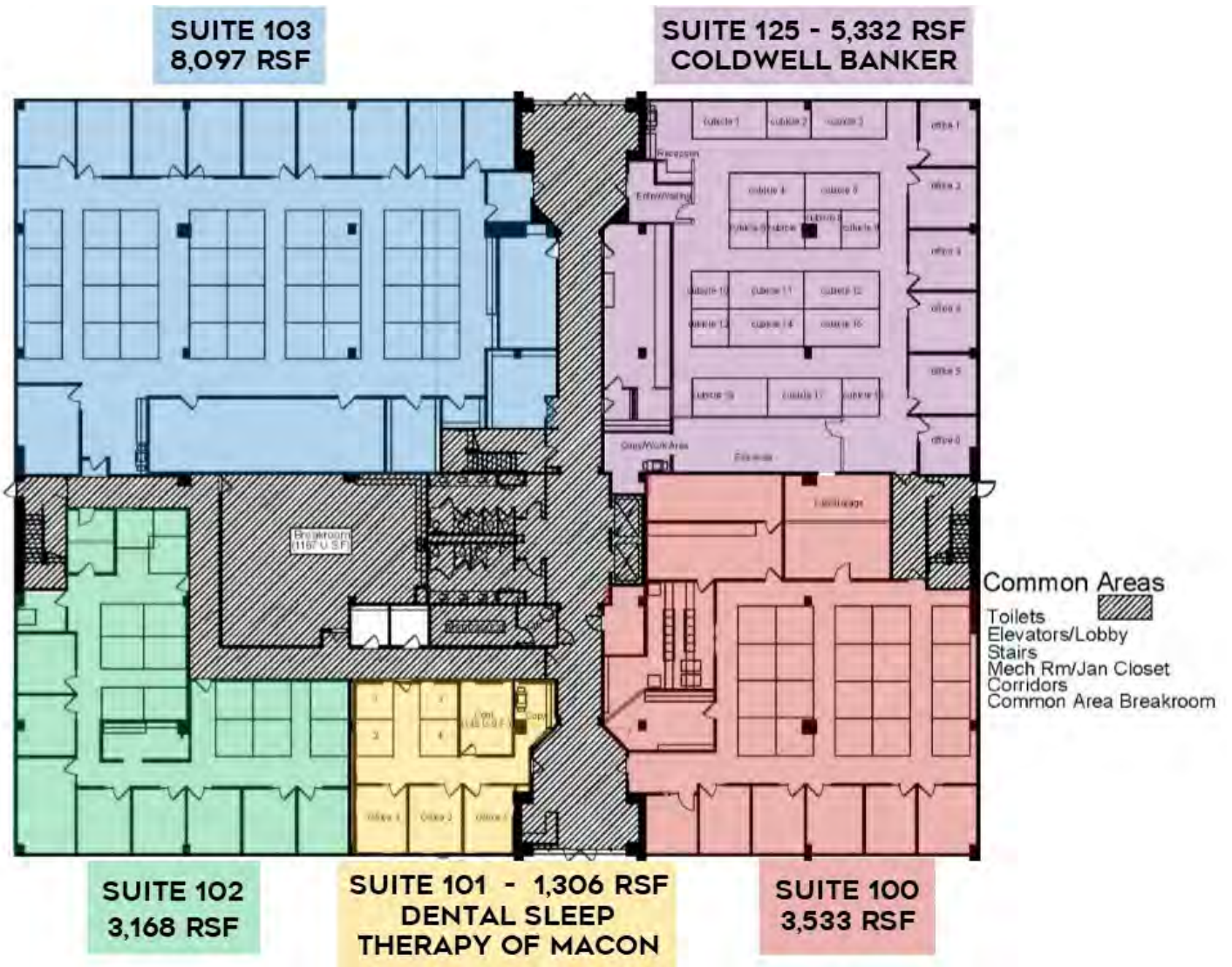

## FLOOR PLAN - SECOND FLOOR

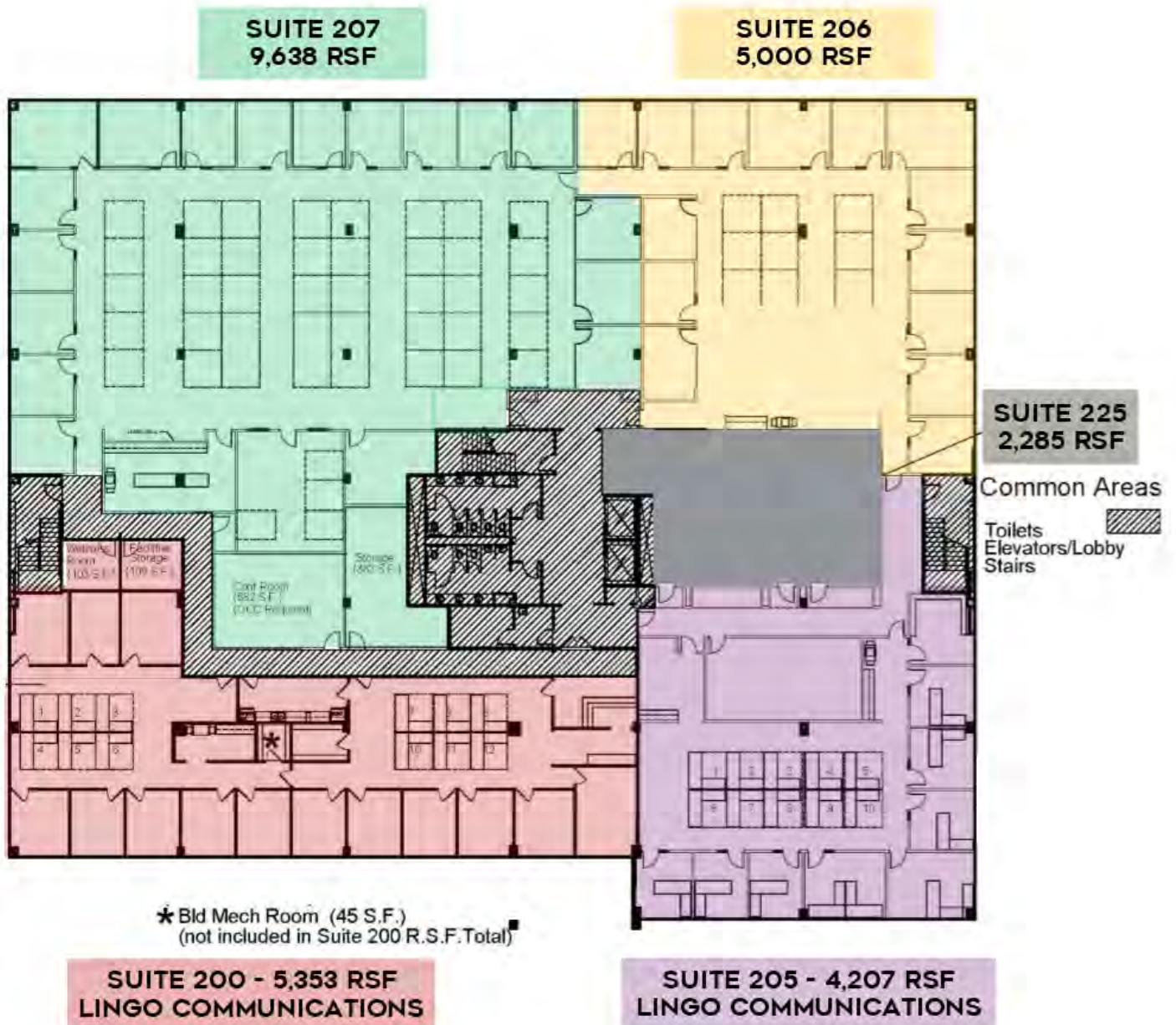

## FLOOR PLAN - THIRD FLOOR

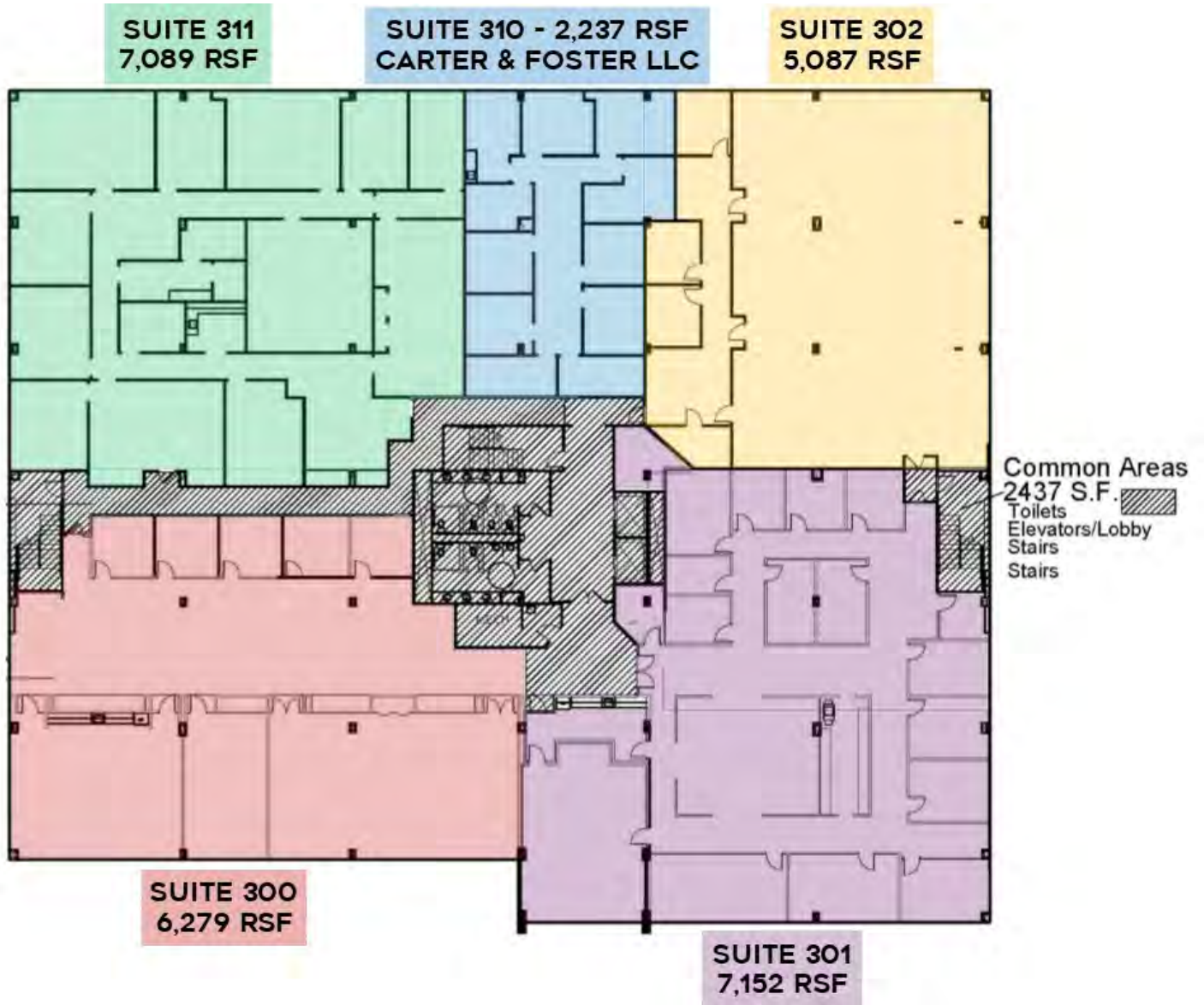

# LEASE

4885 RIVERSIDE DRIVE  
MACON, BIBB COUNTY, GEORGIA 31210



STEPHANIE FOLSOM, CCIM  
478.361.8259CELL  
STEPHANIE@CBCGEORGIA.COM  
CBCMACON.COM



**COLDWELL BANKER  
COMMERCIAL**  
EBERHARDT & BARRY

# LEASE

4885 RIVERSIDE DRIVE  
MACON, BIBB COUNTY, GEORGIA 31210



STEPHANIE FOLSOM, CCIM  
478.361.8259CELL  
STEPHANIE@CBCGEORGIA.COM  
CBCMACON.COM



**COLDWELL BANKER  
COMMERCIAL**  
EBERHARDT & BARRY



# LEASE

4885 RIVERSIDE DRIVE  
MACON, BIBB COUNTY, GEORGIA 31210

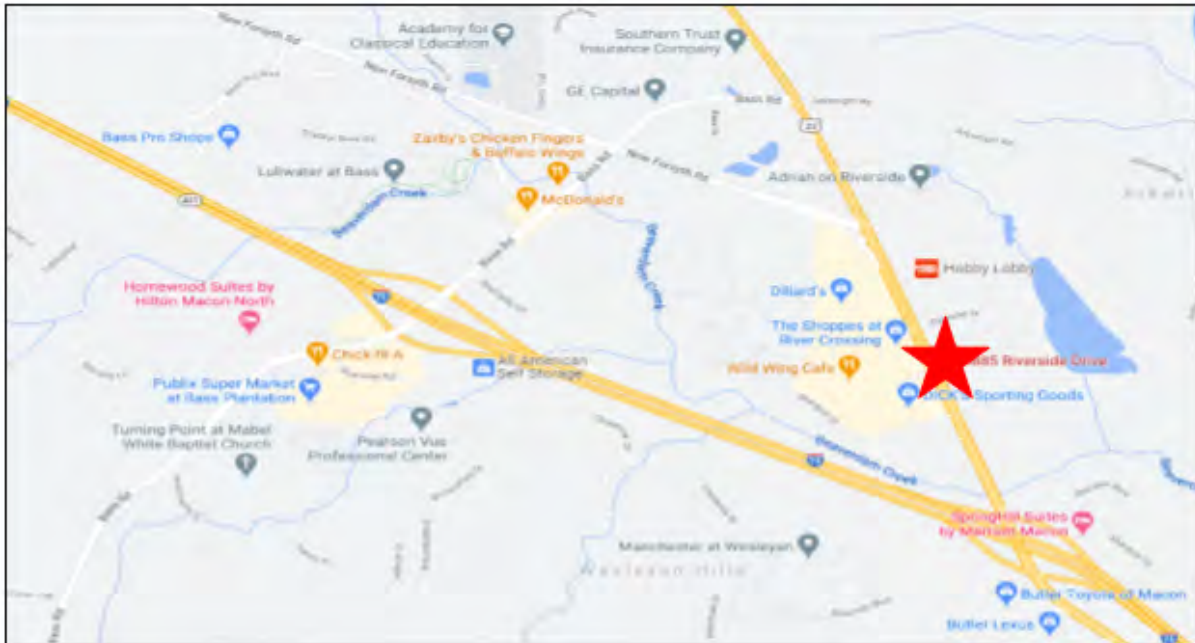

STEPHANIE FOLSOM, CCIM  
478.361.8259CELL  
STEPHANIE@CBCGEORGIA.COM  
CBCMACON.COM



**COLDWELL BANKER  
COMMERCIAL**  
EBERHARDT & BARRY

## DEMOGRAPHICS - BIBB COUNTY, GA

