

# FOR LEASE

# ±6,239 Square Feet

13560 LARWIN CIRCLE | SANTA FE SPRINGS | CA



## PROPERTY FEATURES

- High Image Building
- Approximately ± 1,100 SF Office Space
- 18' Minimum Warehouse Clearance Height
- 2 Ground Level Doors - 10'x10' and 12'x14'
- 600A, 277 / 480V 3 Phase Power
- Part of a Larger Master Planned Business Park
- Excellent Freeway Access
- Available March 1, 2026

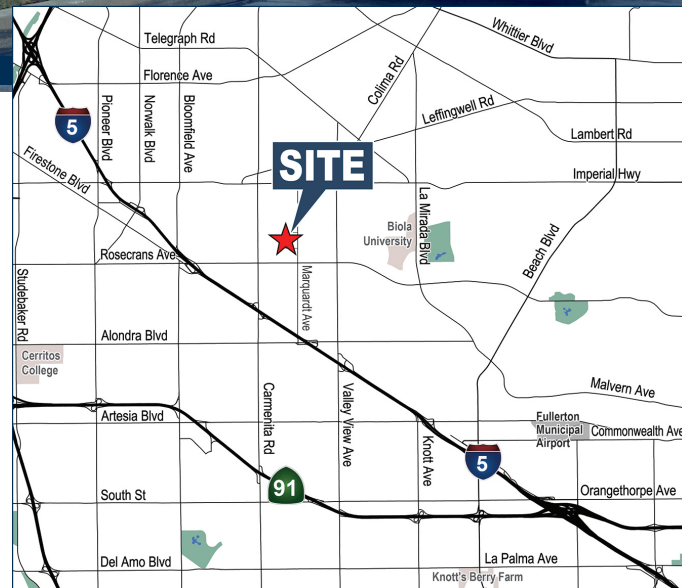

Exclusively Offered By:

**Voit**

REAL ESTATE SERVICES



2020 Main Street, Suite 100 | Irvine, CA 92614  
License #01991785 [www.voitco.com](http://www.voitco.com)



**LOREN CARGILE**

Vice President | Partner  
License #01431329

**(714) 935-2306**

[LCargile@voitco.com](mailto:LCargile@voitco.com)



13560 LARWIN CIRCLE | SANTA FE SPRINGS | CA

AERIAL



REAR OF BUILDING



Exclusively Offered By:

**Voit**

REAL ESTATE SERVICES



2020 Main Street, Suite 100 | Irvine, CA 92614  
License #01991785 [www.voitco.com](http://www.voitco.com)



**LOREN CARGILE**

Vice President | Partner  
License #01431329

**(714) 935-2306**

[LCargile@voitco.com](mailto:LCargile@voitco.com)

The information contained herein has been obtained from sources we deem reliable. While we have no reason to doubt its accuracy, we do not guarantee it. Licensed as Real Estate Salespersons by the DRE. ©2024 Voit Real Estate Services, Inc. All Rights Reserved. License #01991785.

SITE PLAN

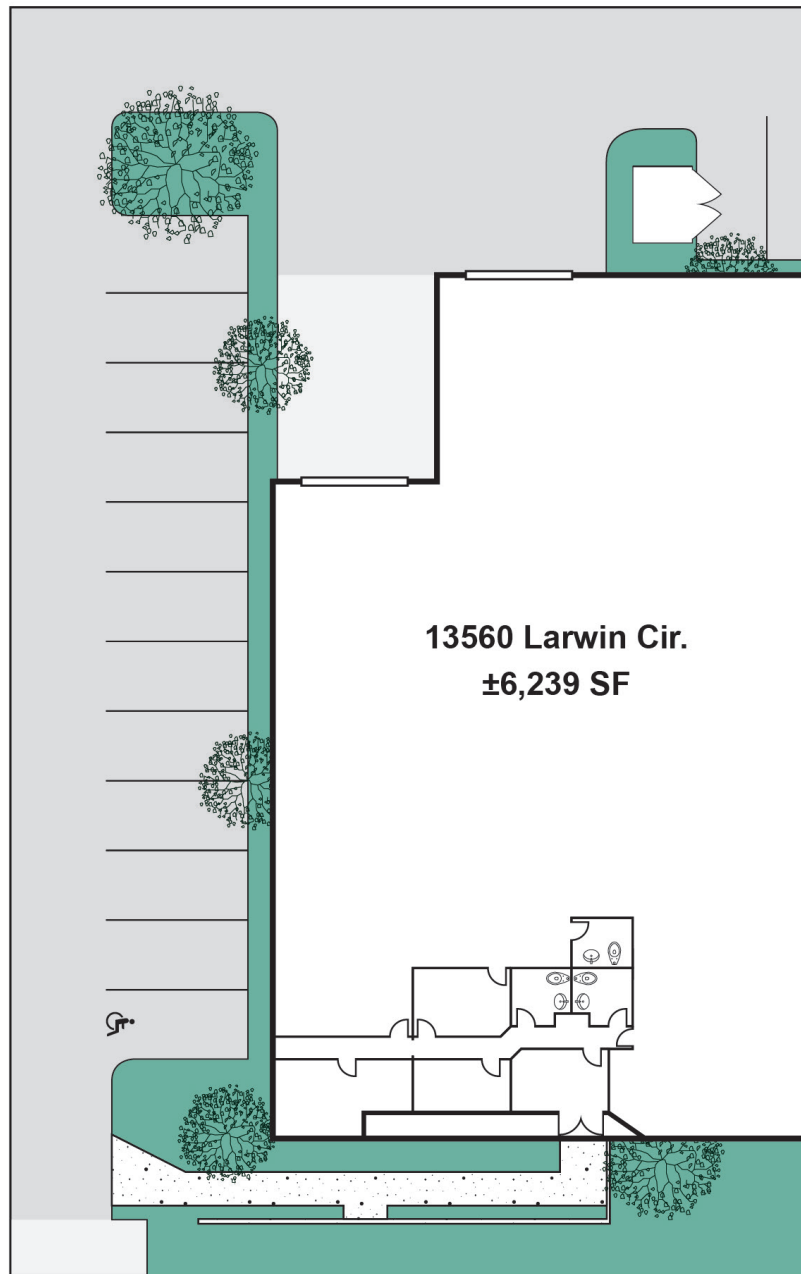

LARWIN CIR

Exclusively Offered By:

**Voit**

REAL ESTATE SERVICES



2020 Main Street, Suite 100 | Irvine, CA 92614  
License #01991785 [www.voitco.com](http://www.voitco.com)



**LOREN CARGILE**

Vice President | Partner  
License #01431329

**(714) 935-2306**

[LCargile@voitco.com](mailto:LCargile@voitco.com)