



# INDUSTRIAL FLEX SPACE AVAILABLE

7917 DERRY ST | HARRISBURG, PA 17111



[WWW.LANDMARKCR.COM](http://WWW.LANDMARKCR.COM)  
(717) 731.1990





**7917 DERRY ST  
HARRISBURG, PA 17111**

**INDUSTRIAL FLEX SPACE  
FOR LEASE**



**OFFERING SUMMARY**

<b>Available SF</b>	<b>8,000 SF</b>
<b>Lease Rate</b>	<b>\$11.95 /SF</b>
<b>Lease Type</b>	<b>NNN</b>
<b>OPEX</b>	<b>\$2.95/SF (2026)</b>
<b>Building Size</b>	<b>100,000 SF</b>
<b>Lot Size</b>	<b>10.8 Acres</b>
<b>Building Type</b>	<b>Industrial Flex</b>
<b>Submarket</b>	<b>Harrisburg East</b>
<b>Municipality</b>	<b>Swatara Township</b>
<b>County</b>	<b>Dauphin County</b>

**PROPERTY HIGHLIGHTS**

- Highly desired industrial flex space available for lease in LogistiCourt at Derry Street in Harrisburg, PA
- Ideally located near the intersection of Nyes Rd which offers quick access to
- Available spaces offer:
  - Two (2) 8,000 SF turn-key flex spaces, each with 2 drive-in doors, & 2 dock doors
  - Various warehouse/office configurations available for variety of Tenant needs
  - 18' clear ceiling height
  - Private exterior access and signage opportunity
- Highly desired corridor is currently undergoing large scale infrastructure to improve access from US-322 including new intersections and traffic signals.
- Join corporate neighbors: DHL Express, Red Bull, Lennox, UniFirst Uniform Services, Graybill Equipment & Repair, Agiliti, Total Mobility Services, Tanner Furniture, Dollar General, Burger King, Rutters, Truist Bank, & M1st FCU

**LANDMARK COMMERCIAL REALTY**  
425 N 21<sup>ST</sup> STREET, SUITE 302  
CAMP HILL, PA 17011  
P : 717.731.1990

**JASON GRACE, CCIM, SIOR**  
CEO & MANAGING PRINCIPAL  
JGRACE@LandmarkCR.com  
C: 717.421.1943

**MICHAEL CURRAN, SIOR**  
PRESIDENT & MANAGING DIRECTOR  
MCURRAN@LandmarkCR.com  
C: 717.805.9277

**JESSICA LILLY, MBA**  
SENIOR ASSOCIATE  
JLILLY@LandmarkCR.com  
C: 717.571.4324



**LANDMARKCR.COM**

### PROPERTY DETAILS

Property Address	7917 Derry St, Harrisburg, PA 17111
Property Name	LogistiCourt at Derry Street
Property Type	Industrial Flex
Property Size	100,000 SF
Tenancy	Multi
Lot Size	10.8 Acres
Year Built	2007
Drive In Doors	25
Dock Doors	25
Clear Ceiling Height	18'
Parking	3.1/1,000 SF
Construction	Masonry
Column Spacing	33'w x 40'd
Lighting	T-5
Sprinkled	Yes
Power	3-Phase
HVAC	Gas
Water/Sewer	Public
Submarket	Harrisburg East
County	Dauphin
Municipality	Swatara Twp
Zoning	Manufacturing General
Cross Streets	Derry St & Nyes Rd
APN	63-018-189
Taxes	\$128,840.14 (2025)

### PROPERTY OVERVIEW

The Property consists of a 100,000 SF light industrial building located in the Harrisburg East submarket of Central Pennsylvania. Constructed in 2007, the Property is appropriately sized for tenants in the market, and designed to support a variety of mixed use requirements with incremental bay sizing, plentiful dock and drive-in loading doors, and attractive store-front offices featuring at-entrance car parking. Recognized as one of the leading industrial sub-markets in the country, Central Pennsylvania features several regional parcel hubs (UPS, FedEx and USPS), four intermodal yards (NS and CSX) offering a mix of domestic and international delivery options, a robust highway network with all-directions interstate access to the dense population centers of the Northeast and Mid-Atlantic, and a deep common carrier and 3PL base. 7917 Derry Street occupies a unique infill location on the east side of Harrisburg, immediately adjacent to Norfolk Southern's Rutherford Interchange only a few short miles away via US Rt. 322.

In addition, the location offers a strong advantage for tenants looking to capitalize on the area's highly productive workforce by presenting short and practical commuting options to executive and associate level employees via the road network and public transportation. Another key location advantage is the simple proximity of the building to several of the area's largest employers, including Penn State Hershey Medical Center, Hershey Food Corp., Tyco Electronics, Commonwealth of PA, U.S. Federal Government, PA Turnpike Commission, Highmark Insurance, Health America Coventry and M & T Bank.



### AVAILABILITY

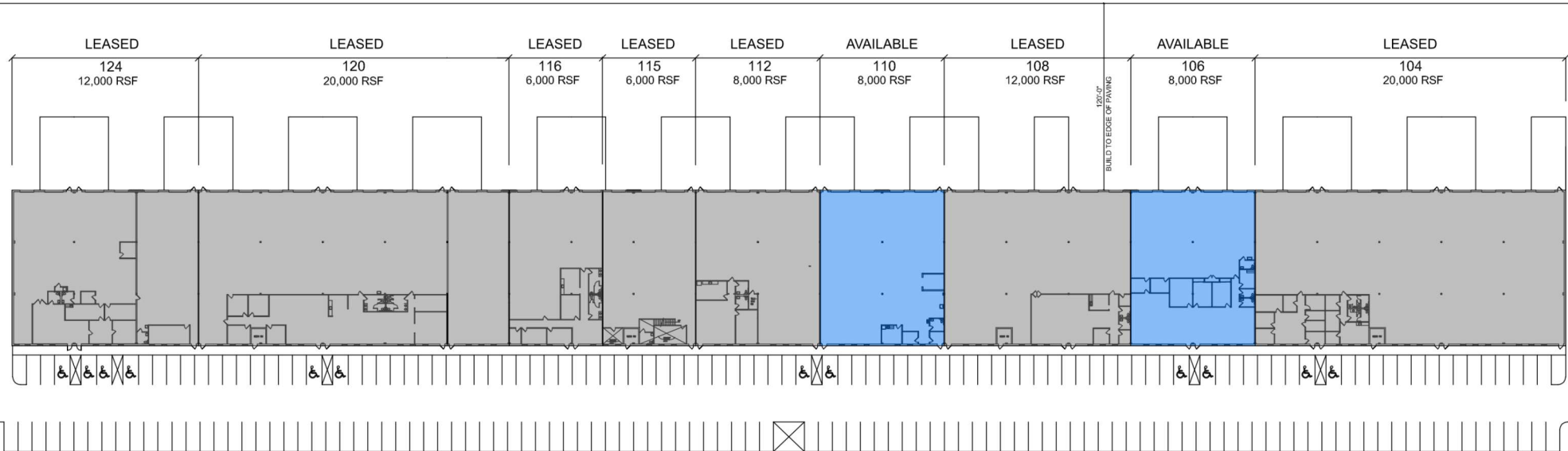

### LEASE INFORMATION

Suite	Space Use	Available SF	Lease Rate	OPEX	Comments
106	Flex	8,000 SF	\$11.95/SF (NNN)	\$2.95/SF (2026)	2 docks / 2 drive in
110	Flex	8,000 SF	\$11.95/SF (NNN)	\$2.95/SF (2026)	2 docks / 2 drive in

### SUITE 106 FLOOR PLAN

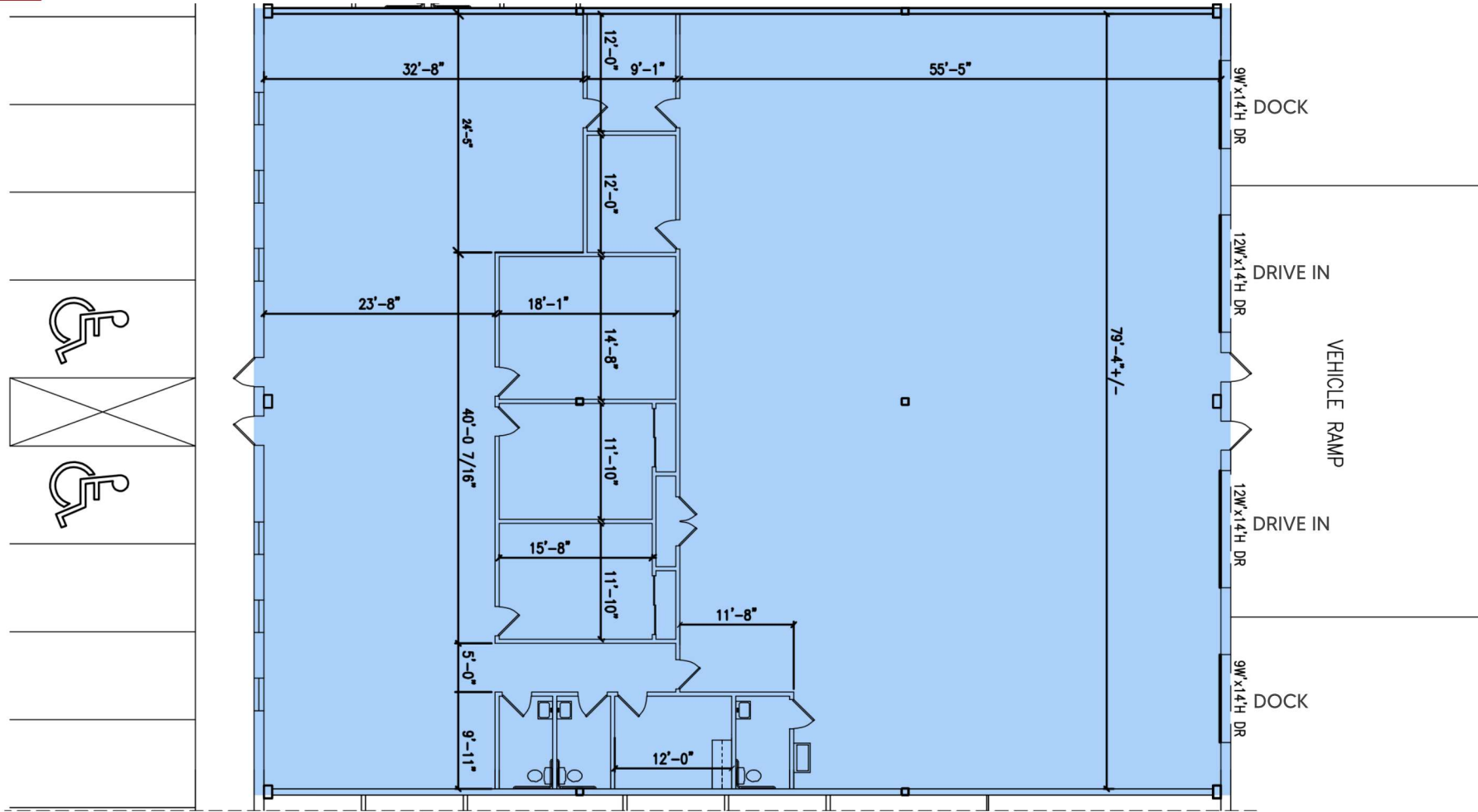

#### LEASE INFORMATION

Suite	Space Use	Available SF	Lease Rate	OPEX	Comments
106	Flex	8,000 SF	\$11.95/SF (NNN)	\$2.95/SF (2026)	2 docks / 2 drive in

### SUITE 110 FLOOR PLAN

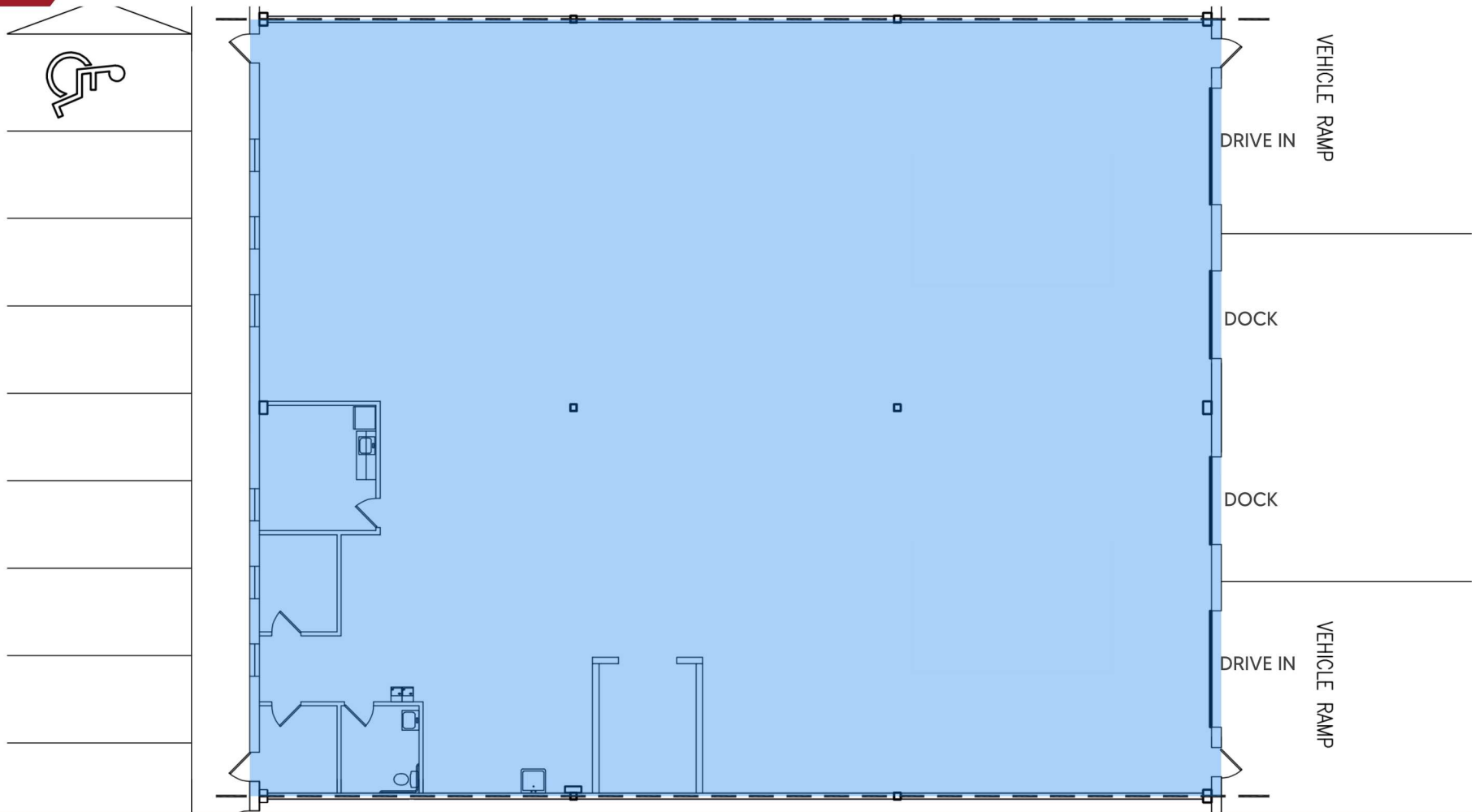

#### LEASE INFORMATION

Suite	Space Use	Available SF	Lease Rate	OPEX	Comments
110	Flex	8,000 SF	\$11.95/SF (NNN)	\$2.95/SF (2026)	2 docks / 2 drive in



7917 DERRY ST  
HARRISBURG, PA 17111

INDUSTRIAL FLEX SPACE  
FOR LEASE



LANDMARK COMMERCIAL REALTY  
425 N 21<sup>ST</sup> STREET, SUITE 302  
CAMP HILL, PA 17011  
P : 717.731.1990

JASON GRACE, CCIM, SIOR  
CEO & MANAGING PRINCIPAL  
JGRACE@LandmarkCR.com  
C: 717.421.1943

MICHAEL CURRAN, SIOR  
PRESIDENT & MANAGING DIRECTOR  
MCURRAN@LandmarkCR.com  
C: 717.805.9277

JESSICA LILLY, MBA  
SENIOR ASSOCIATE  
JLILLY@LandmarkCR.com  
C: 717.571.4324



LANDMARKCR.COM

SITE PLAN

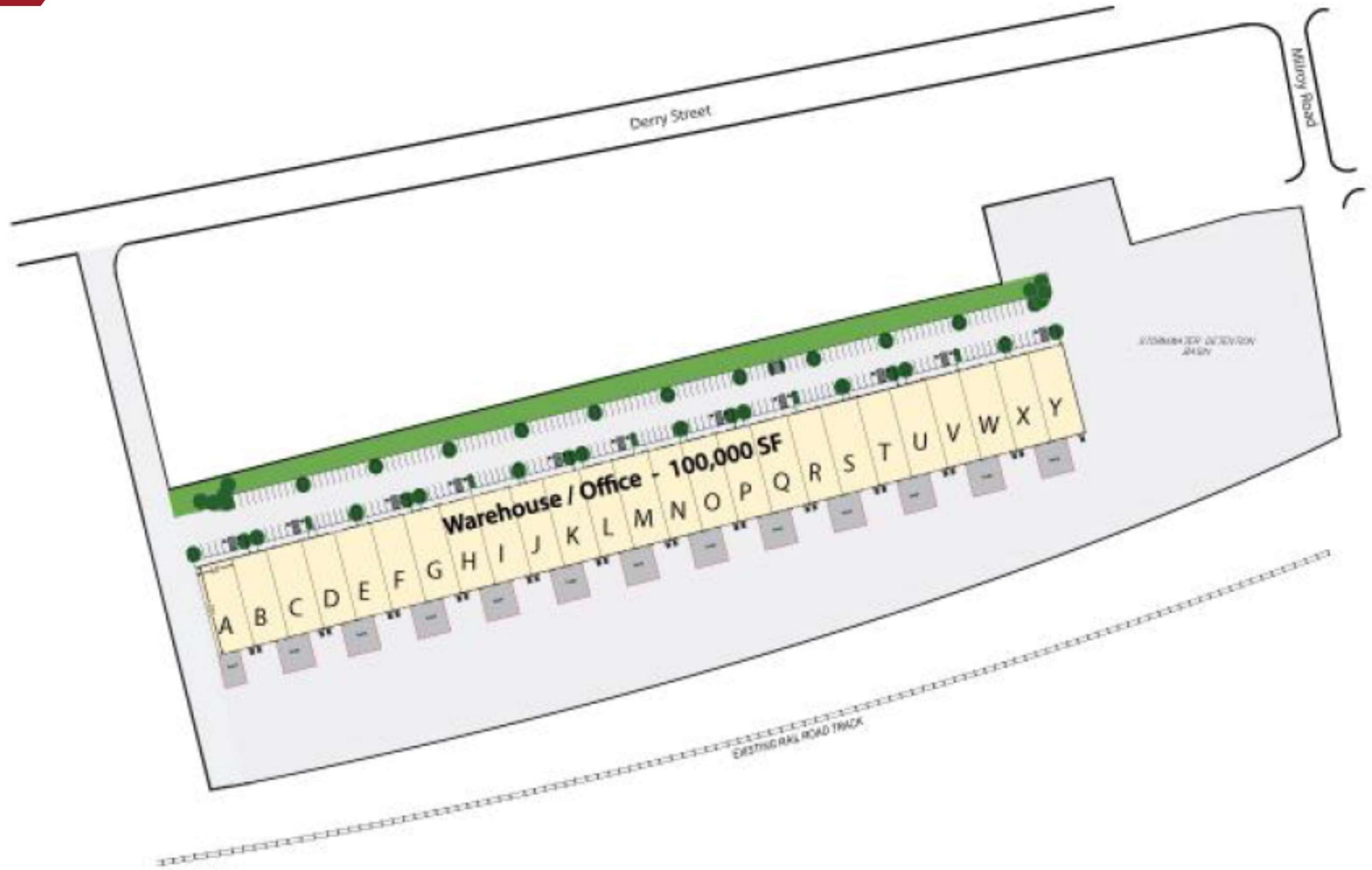

TRADE AERIAL



**LANDMARK COMMERCIAL REALTY**  
425 N 21<sup>ST</sup> STREET, SUITE 302  
CAMP HILL, PA 17011  
P : 717.731.1990

**JASON GRACE, CCIM, SIOR**  
CEO & MANAGING PRINCIPAL  
JGRACE@LandmarkCR.com  
C: 717.421.1943

**MICHAEL CURRAN, SIOR**  
PRESIDENT & MANAGING DIRECTOR  
MCURRAN@LandmarkCR.com  
C: 717.805.9277

**JESSICA LILLY, MBA**  
SENIOR ASSOCIATE  
JLILLY@LandmarkCR.com  
C: 717.571.4324



### DEMOGRAPHICS

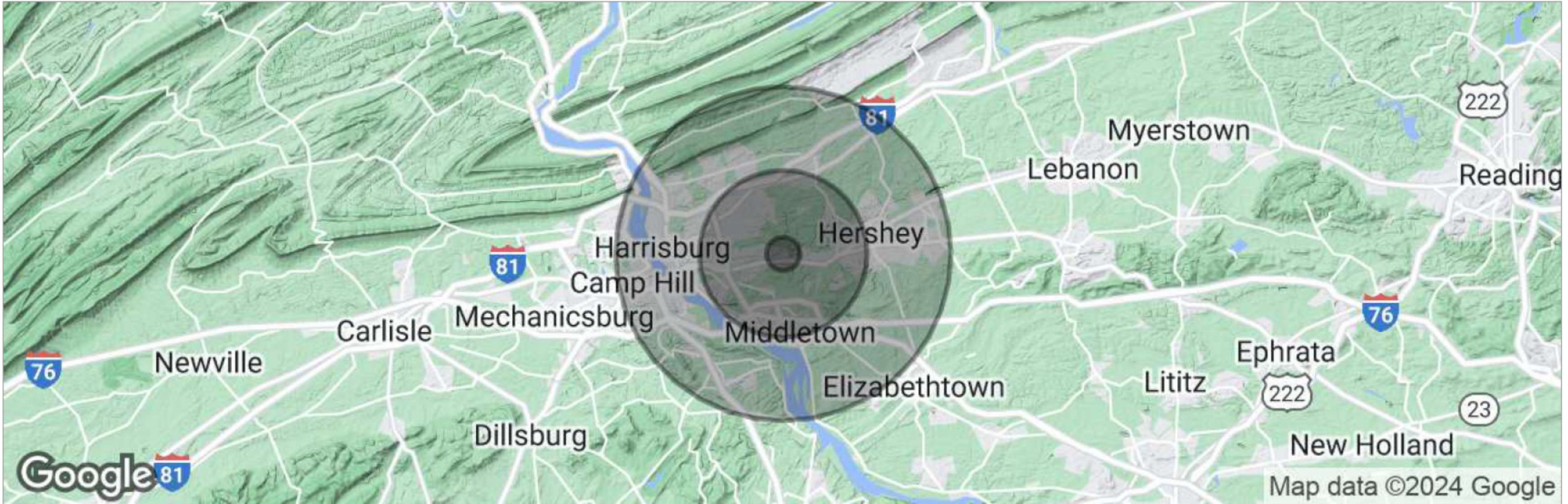

	1 MILE	5 MILES	10 MILES
Total Population	6,511	129,166	332,948
Population Density	2,073	1,644	1,060
Median Age	39	41	41
Median Age (Male)	38	40	40
Median Age (Female)	40	42	42
Total Households	2,574	51,635	135,915
# of Persons Per HH	2.5	2.5	2.4
Average HH Income	\$109,018	\$100,629	\$99,492
Average House Value	\$256,918	\$271,604	\$262,579



7917 DERRY ST  
HARRISBURG, PA 17111

INDUSTRIAL FLEX SPACE  
FOR LEASE

## CONFIDENTIALITY & DISCLAIMER

All materials and information received or derived from Landmark Commercial its directors, officers, agents, advisors, affiliates and/or any third party sources are provided without representation or warranty as to completeness, veracity, or accuracy, condition of the property, compliance or lack of compliance with applicable governmental requirements, developability or suitability, financial performance of the property, projected financial performance of the property for any party's intended use or any and all other matters.

Neither Landmark Commercial its directors, officers, agents, advisors, or affiliates makes any representation or warranty, express or implied, as to accuracy or completeness of the any materials or information provided, derived, or received. materials and information from any source, whether written or verbal, that may be furnished for review are not a substitute for a party's active conduct of its own due diligence to determine these and other matters of significance to such party. Landmark Commercial will not investigate or verify any such matters or conduct due diligence for a party unless otherwise agreed in writing.

### **EACH PARTY SHALL CONDUCT ITS OWN INDEPENDENT INVESTIGATION AND DUE DILIGENCE.**

Any party contemplating or under contract or in escrow for a transaction is urged to verify all information and to conduct their own inspections and Investigations including through appropriate third party independent professionals selected by such party. All financial data should be verified by the party including by obtaining and reading applicable documents and reports and consulting appropriate independent professionals. Landmark Commercial makes no warranties and/or representations regarding the veracity, completeness, or relevance of any financial data or assumptions. Landmark Commercial does not serve as a financial advisor to any party regarding any proposed transaction. All data and assumptions regarding financial performance, including that used for financial modeling purposes, may differ from actual data or performance. Any estimates of market rents and/or projected rents that may be provided to a party do not necessarily mean that rents can be established at or increased to that level. Parties must have evaluate any applicable contractual and governmental limitations as well as market conditions, vacancy factors and other issues in order to determine rents from or for the property.

Legal questions should be discussed by the party with an attorney. Tax questions should be discussed by the party with a certified public accountant or tax attorney. Title questions should be discussed by the party with a title officer or attorney. Questions regarding the condition of the property and whether the property complies with applicable governmental requirements should be discussed by the party with appropriate engineers, architects, contractors, other consultants and governmental agencies. All properties and services are marketed by Landmark Commercial in compliance with all applicable fair housing and equal opportunity laws.

LANDMARK COMMERCIAL REALTY  
425 N 21<sup>ST</sup> STREET, SUITE 302  
CAMP HILL, PA 17011  
P : 717.731.1990

JASON GRACE, CCIM, SIOR  
CEO & MANAGING PRINCIPAL  
JGRACE@LandmarkCR.com  
C: 717.421.1943

MICHAEL CURRAN, SIOR  
PRESIDENT & MANAGING DIRECTOR  
MCURRAN@LandmarkCR.com  
C: 717.805.9277

JESSICA LILLY, MBA  
SENIOR ASSOCIATE  
JLILLY@LandmarkCR.com  
C: 717.571.4324



LANDMARKCR.COM



## INDUSTRIAL FLEX SPACE AVAILABLE

For More Information Contact:

**JASON GRACE, CCIM, SIOR**  
CEO & MANAGING PRINCIPAL  
E: JGRACE@LANDMARKCR.COM  
C: 717.421.1943

**MICHAEL CURRAN, SIOR**  
PRESIDENT & EXECUTIVE MANAGING DIRECTOR  
E: MCURRAN@LANDMARKCR.COM  
C: 717.805.9277

**JESSICA LILLY, MBA**  
SENIOR ASSOCIATE  
E: JLILLY@LANDMARKCR.COM  
C: 717.571.4324

---

LANDMARK COMMERCIAL REALTY  
425 N 21st STREET, SUITE 302  
CAMP HILL, PA 17011  
P: 717.731.1990 F: 717.731.8765

