

**kl**n**b**

# 2-STORY ROOFTOP BAR AT IVY CITY

1408 OKIE ST NE, WASHINGTON, DC 20002



**7,780 SF ACROSS TWO LEVELS.  
2,104 SF OUTDOOR DECK ON SECOND LEVEL.**

**VICTOR SALCIDO**

vsalcido@kl**n**b.com | 240-755-2704

**JOE FLEISCHMANN**

joef@kl**n**b.com | 703-268-2708

**MICHAEL PRATT**

mpratt@kl**n**b.com | 202-420-7765

**kl**n**b.com**



# 2-STORY ROOFTOP BAR AT IVY CITY

1408 OKIE ST NE, WASHINGTON, DC 20002

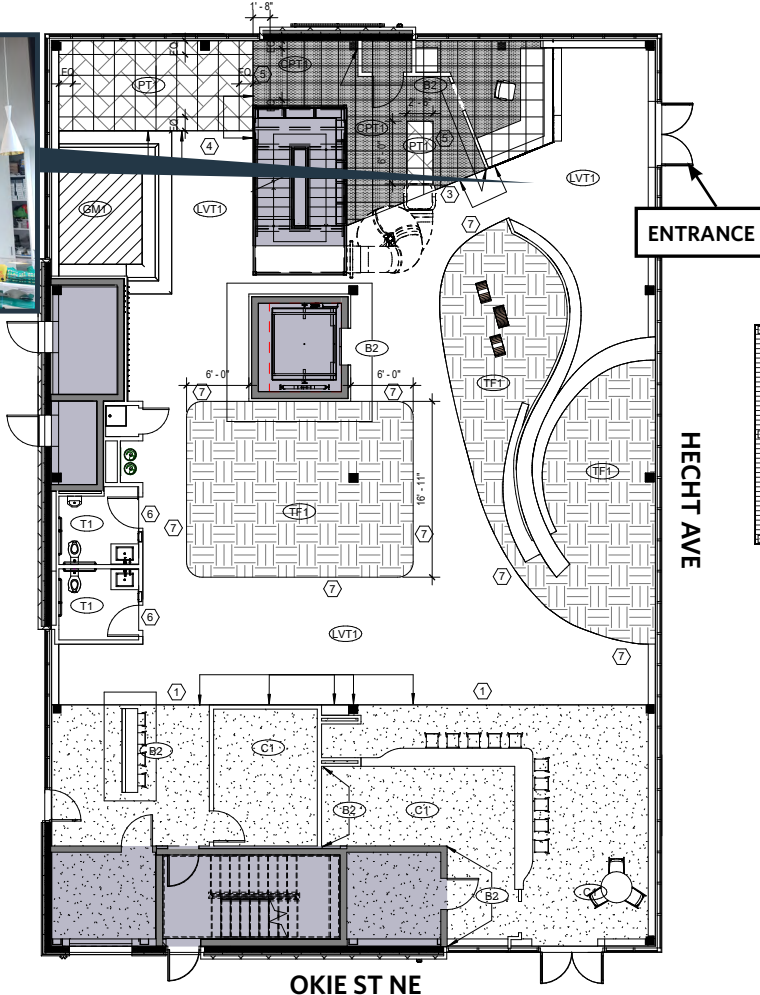
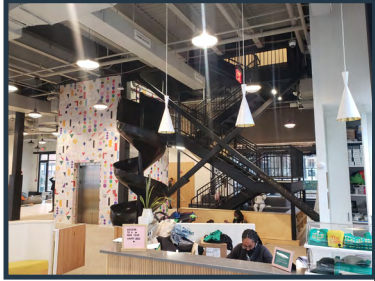

## FIRST LEVEL

[CLICK FOR VIDEO](#)

SIZE: 5,090 SF CEILING HEIGHT: 17'8"

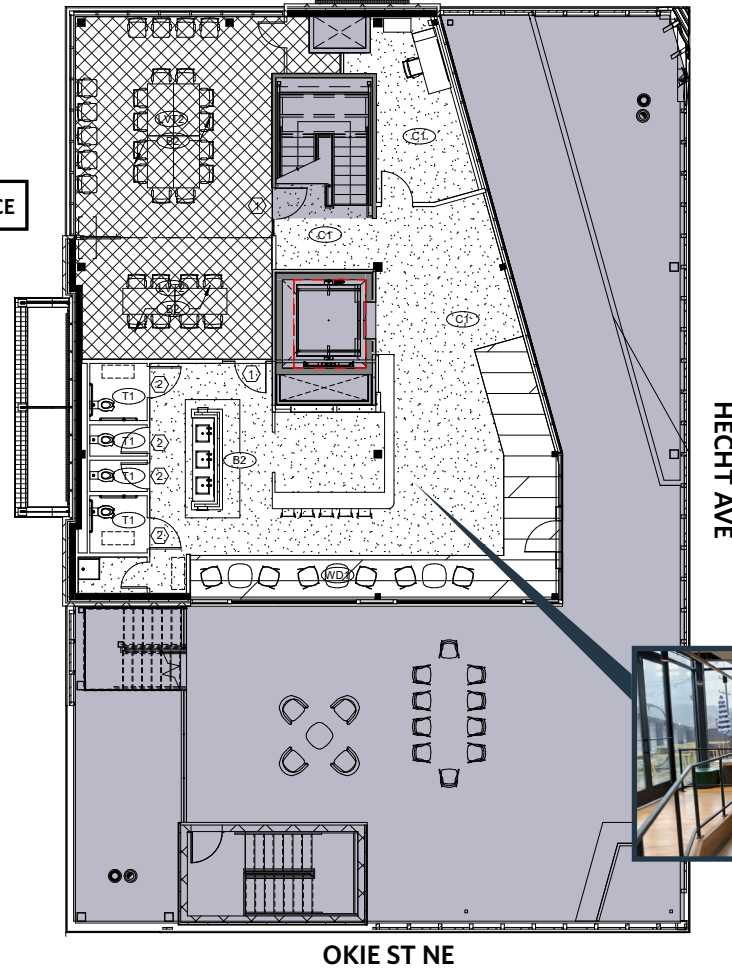

## SECOND LEVEL

[CLICK FOR VIDEO](#)

SIZE: 4,336 SF (including deck) CEILING HEIGHT: 11'7"

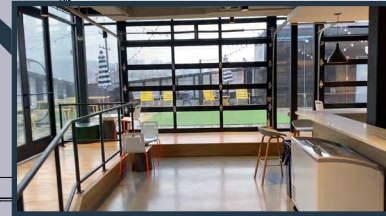

**VICTOR SALCIDO**

vscalido@klnb.com | 240-755-2704

**JOE FLEISCHMANN**

joef@klnb.com | 703-268-2708

**MICHAEL PRATT**

mpratt@klnb.com | 202-420-7765

# SITE PLAN

# 2-STORY ROOFTOP BAR AT IVY CITY

1408 OKIE ST NE, WASHINGTON, DC 20002



## 630 DEDICATED RETAIL PARKING SPACES (LEVELS P1-P4)

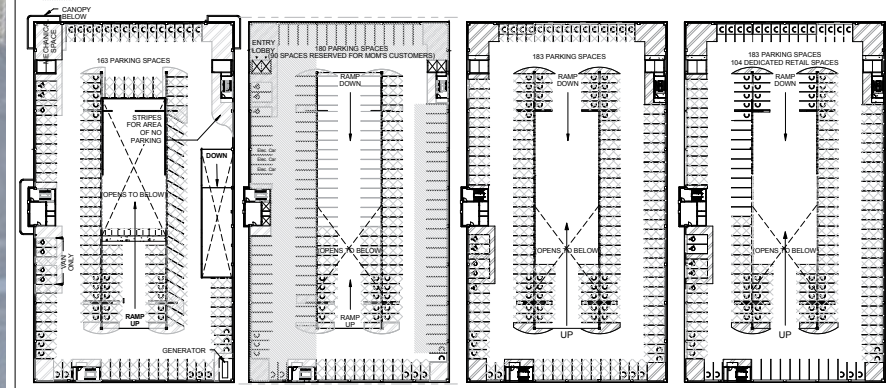

## RESIDENTIAL UNITS

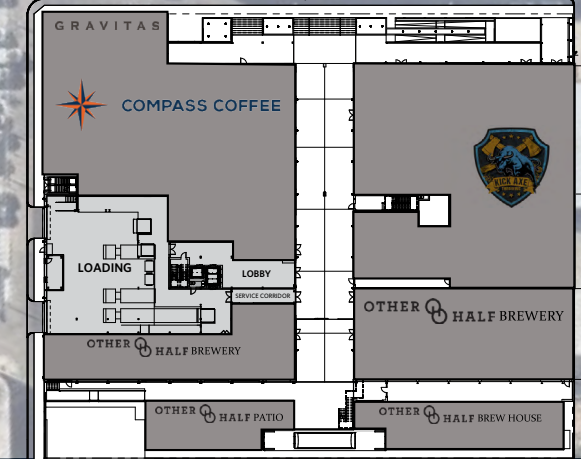

**VICTOR SALCIDO**  
vsalcido@klnb.com | 240-755-2704

**JOE FLEISCHMANN**  
joef@klnb.com | 703-268-2708

**MICHAEL PRATT**  
mpratt@klnb.com | 202-420-7765





# AERIAL

# 2-STORY ROOFTOP BAR AT IVY CITY

1408 OKIE ST NE, WASHINGTON, DC 20002

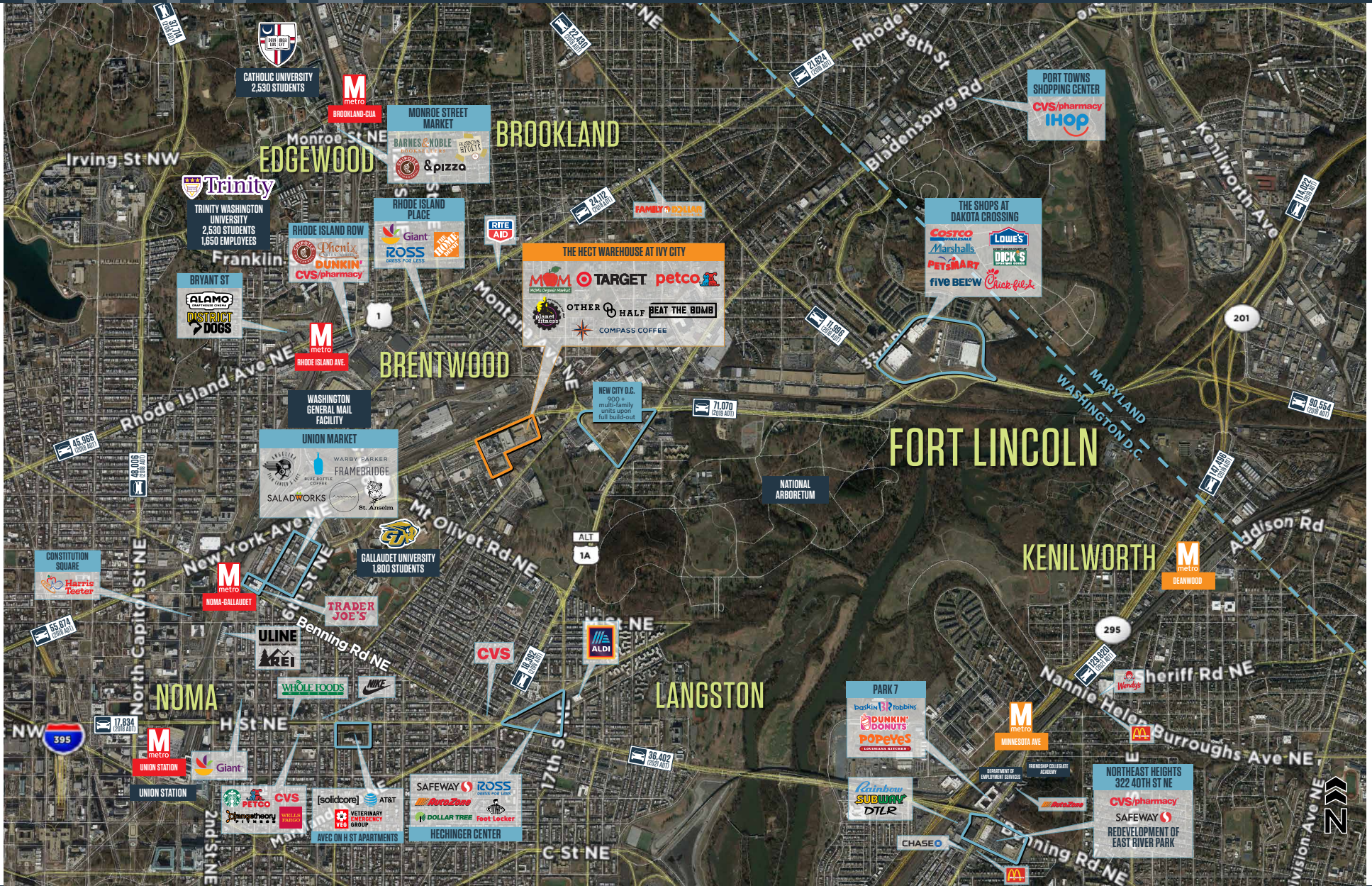

**VICTOR SALCIDO**  
vsalcido@klnb.com | 240-755-2704

**JOE FLEISCHMANN**  
joef@klnb.com | 703-268-2708

**MICHAEL PRATT**  
mpratt@klnb.com | 202-420-7765





# LOCATION

# 2-STORY ROOFTOP BAR AT IVY CITY

1408 OKIE ST NE, WASHINGTON, DC 20002

## 10 MINUTE DRIVE TIME TAPESTRY



### LAPTOPS & LATTES

HOUSEHOLDS: 17,306 (20.7%)  
MEDIAN AGE: 37.4



### METRO RENTERS





HOUSEHOLDS: 12,807 (14.8%)  
MEDIAN AGE: 32.5



### TRENDSETTERS

HOUSEHOLDS: 11,249 (13.7%)  
MEDIAN AGE: 36.3

## 10 MIN DRIVE 10 MIN WALK

	10 MIN DRIVE	10 MIN WALK
 POPULATION	189,936	2,978
 DAYTIME POPULATION	249,209	6,001
 AVG HH INCOME	\$150,737	\$83,974
 EDUCATION	34.7%	31.3%
 HOUSEHOLDS	86,534	1,299

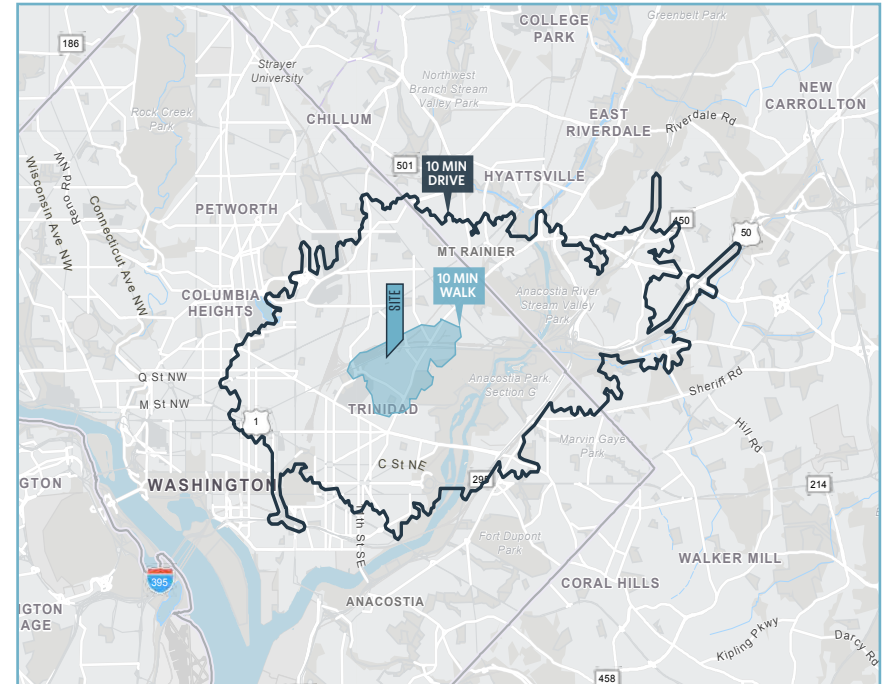

## TRAFFIC COUNTS

NEW YORK AVE.....71,068 ADT

**VICTOR SALCIDO**

vsalcido@klnb.com | 240-755-2704

**JOE FLEISCHMANN**

joef@klnb.com | 703-268-2708

**MICHAEL PRATT**

mpratt@klnb.com | 202-420-7765







# 2-STORY ROOFTOP BAR AT IVY CITY

1408 OKIE ST NE, WASHINGTON, DC 20002

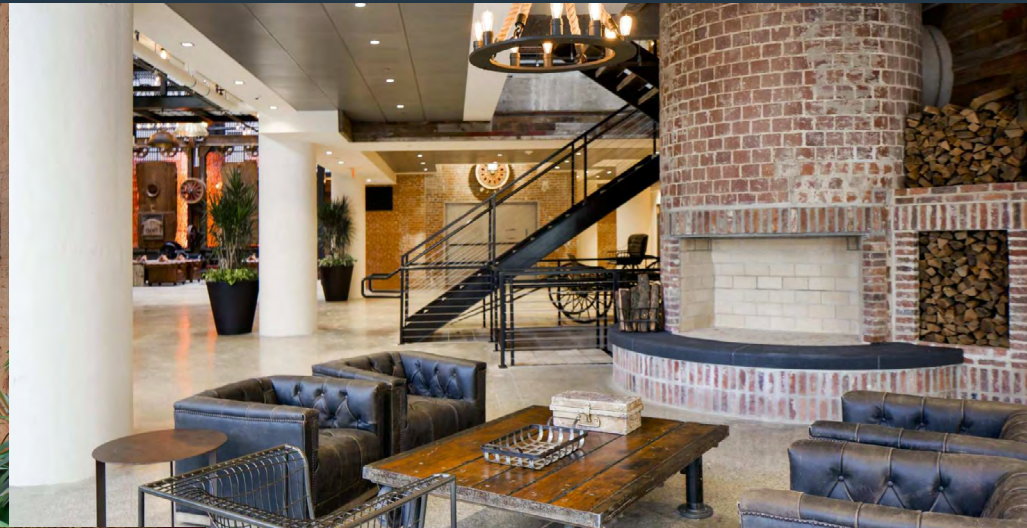

FOR MORE INFORMATION, PLEASE CONTACT:

<b>VICTOR SALCIDO</b>	<b>JOE FLEISCHMANN</b>	<b>MICHAEL PRATT</b>
<a href="mailto:vsalcido@klnb.com">vsalcido@klnb.com</a>	<a href="mailto:joef@klnb.com">joef@klnb.com</a>	<a href="mailto:mpratt@klnb.com">mpratt@klnb.com</a>
240-755-2704	703-268-2708	202-420-7765

[CLICK TO VIEW PROPERTY WEBSITE](#)

While we have no reason to doubt the accuracy of any of the information supplied, we cannot, and do not, guarantee its accuracy. All information should be independently verified prior to a purchase or lease of the property. We are not responsible for errors, omissions, misuse, or misinterpretation of information contained herein and make no warranty of any kind, express or implied, with respect to the property or any other matters.