



CELINA, TEXAS | Development Opportunity





Life Connected.

CELINA DEVELOPMENT | Overview

Development Opportunity

Welcome to Celina, Texas. Located on the bustling FM-289 just outside of Frisco, Texas near Dallas, TX. These two 10 acre tracts are currently zoned AG and are located adjacent to a well-known residential subdivision just outside of downtown Celina, Texas. It is one of the fastest growing areas for residential development in the state of Texas.

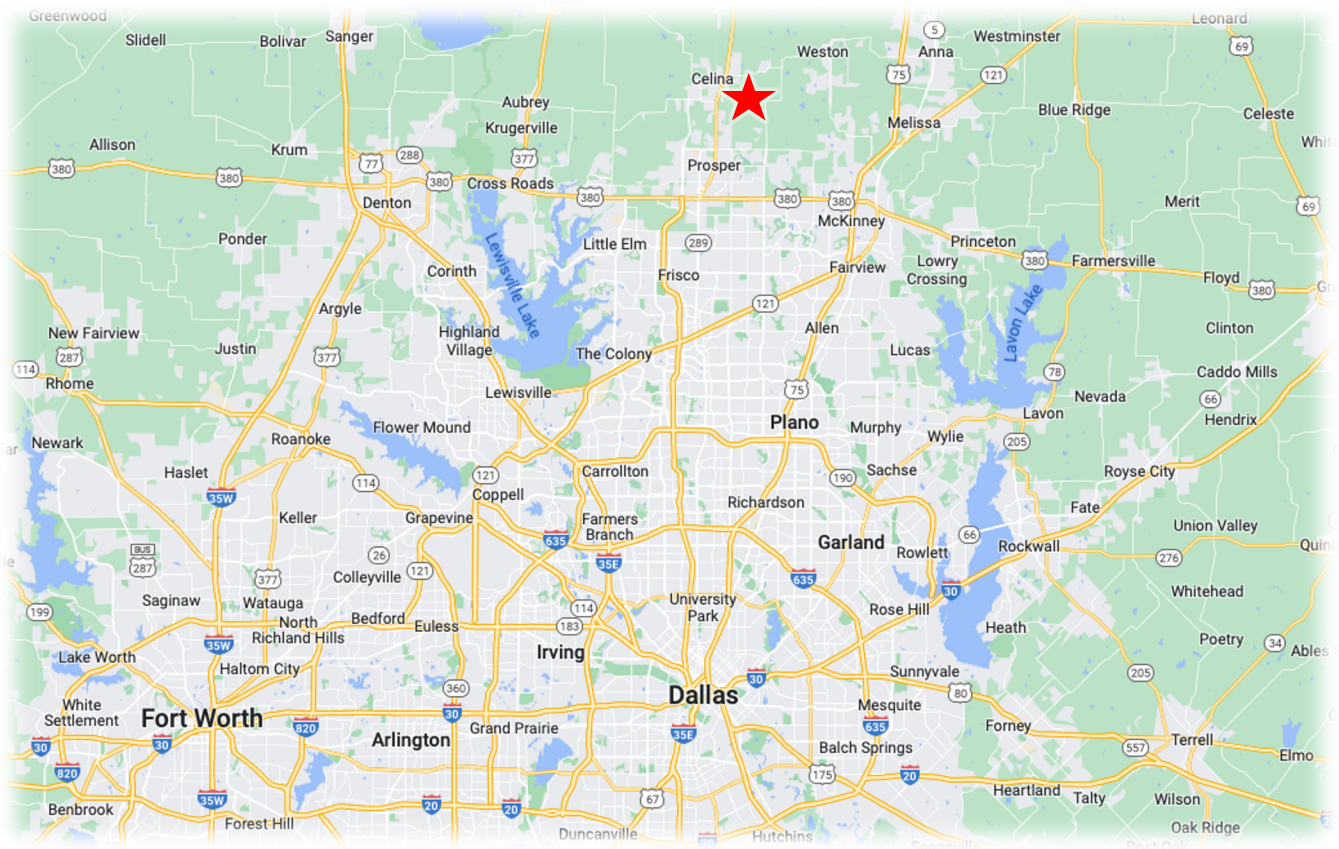

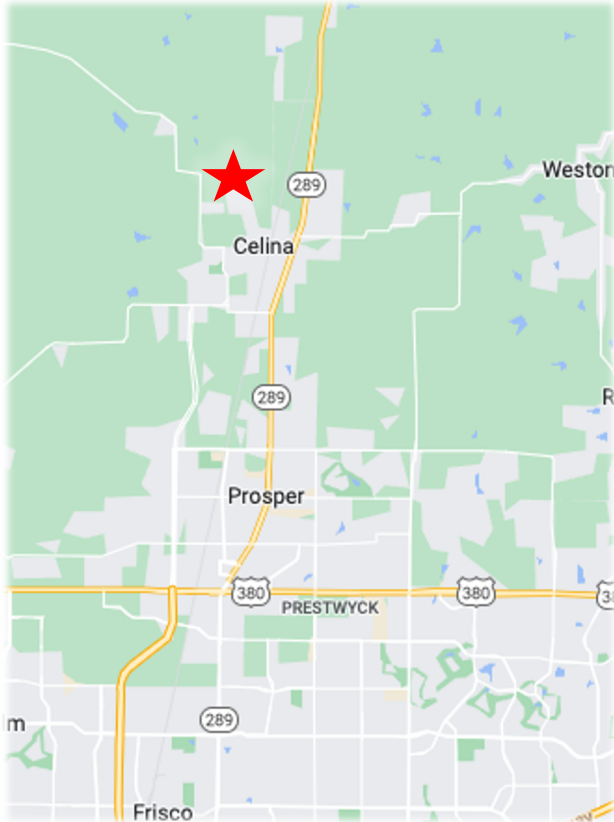

PROPERTY KEY FEATURES

- Close to FM 289
- Zoned Agriculture.
- 162,023 people within 10 miles
- \$212,542 Average Household Income.
- Excellent visibility.
- Traffic counts – 20,394 FM 289
- Near City of Frisco, TX.
- Right outside of City of Dallas.



Life Connected.



Complete Profile

2010-2020 Census, 2023 Estimates with 2028 Projections
 Calculated using Weighted Block Centroid from Block Groups



Lat/Lon: 33.3249/-96.7862

Celina, TX	5 mi radius		10 mi radius		15 mi radius	
Population						
Estimated Population (2023)	28,312		162,023		682,052	
Projected Population (2028)	36,306		189,038		788,245	
Census Population (2020)	24,457		147,147		627,982	
Census Population (2010)	8,442		61,006		358,333	
Projected Annual Growth (2023-2028)	7,994	5.6%	27,015	3.3%	106,194	3.1%
Historical Annual Growth (2020-2023)	3,855	-	14,876	3.4%	54,069	2.9%
Historical Annual Growth (2010-2020)	16,015	19.0%	86,141	14.1%	269,649	7.5%
Estimated Population Density (2023)	361 <i>psm</i>		516 <i>psm</i>		965 <i>psm</i>	
Trade Area Size	78.5 <i>sq mi</i>		314.0 <i>sq mi</i>		706.8 <i>sq mi</i>	
Households						
Estimated Households (2023)	8,924		53,470		232,501	
Projected Households (2028)	12,148		66,128		285,662	
Census Households (2020)	7,579		47,882		211,274	
Census Households (2010)	2,664		20,046		120,275	
Projected Annual Growth (2023-2028)	3,225	7.2%	12,658	4.7%	53,161	4.6%
Historical Annual Change (2010-2023)	6,260	18.1%	33,424	12.8%	112,226	7.2%
Average Household Income						
Estimated Average Household Income (2023)	\$212,542		\$181,470		\$157,404	
Projected Average Household Income (2028)	\$164,435		\$155,201		\$135,621	
Census Average Household Income (2010)	\$103,736		\$102,826		\$95,421	
Census Average Household Income (2000)	\$81,514		\$82,539		\$78,137	
Projected Annual Change (2023-2028)	-\$48,107	-4.5%	-\$26,269	-2.9%	-\$21,784	-2.8%
Historical Annual Change (2000-2023)	\$131,028	7.0%	\$98,931	5.2%	\$79,268	4.4%
Median Household Income						
Estimated Median Household Income (2023)	\$150,240		\$152,378		\$135,748	
Projected Median Household Income (2028)	\$154,995		\$155,764		\$137,768	
Census Median Household Income (2010)	\$78,444		\$89,827		\$83,876	
Census Median Household Income (2000)	\$61,183		\$66,119		\$65,524	
Projected Annual Change (2023-2028)	\$4,755	0.6%	\$3,386	0.4%	\$2,020	0.3%
Historical Annual Change (2000-2023)	\$89,058	6.3%	\$86,259	5.7%	\$70,224	4.7%
Per Capita Income						
Estimated Per Capita Income (2023)	\$67,001		\$59,892		\$53,694	
Projected Per Capita Income (2028)	\$55,030		\$54,295		\$49,182	
Census Per Capita Income (2010)	\$32,733		\$33,778		\$32,029	
Census Per Capita Income (2000)	\$27,503		\$27,489		\$26,910	
Projected Annual Change (2023-2028)	-\$11,971	-3.6%	-\$5,597	-1.9%	-\$4,512	-1.7%
Historical Annual Change (2000-2023)	\$39,498	6.2%	\$32,404	5.1%	\$26,784	4.3%
Estimated Average Household Net Worth (2023)	\$1.14 M		\$1.11 M		\$979,494	

Complete Profile

2010-2020 Census, 2023 Estimates with 2028 Projections
 Calculated using Weighted Block Centroid from Block Groups



Lat/Lon: 33.3249/-96.7862

Celina, TX	5 mi radius		10 mi radius		15 mi radius	
Race and Ethnicity						
Total Population (2023)	28,312		162,023		682,052	
White (2023)	20,395	72.0%	101,198	62.5%	393,909	57.8%
Black or African American (2023)	2,079	7.3%	18,435	11.4%	88,386	13.0%
American Indian or Alaska Native (2023)	216	0.8%	834	0.5%	3,818	0.6%
Asian (2023)	1,825	6.4%	21,787	13.4%	100,986	14.8%
Hawaiian or Pacific Islander (2023)	17	-	111	-	454	-
Other Race (2023)	1,040	3.7%	4,821	3.0%	28,298	4.1%
Two or More Races (2023)	2,740	9.7%	14,837	9.2%	66,200	9.7%
Population < 18 (2023)	7,490 26.5%		44,828 27.7%		183,885 27.0%	
White Not Hispanic	4,950	66.1%	24,124	53.8%	85,742	46.6%
Black or African American	514	6.9%	5,430	12.1%	25,366	13.8%
Asian	325	4.3%	6,158	13.7%	29,583	16.1%
Other Race Not Hispanic	444	5.9%	2,521	5.6%	9,760	5.3%
Hispanic	1,257	16.8%	6,595	14.7%	33,434	18.2%
Not Hispanic or Latino Population (2023)	24,172 85.4%		141,017 87.0%		576,297 84.5%	
Not Hispanic White	19,328	80.0%	95,949	68.0%	368,014	63.9%
Not Hispanic Black or African American	2,017	8.3%	18,073	12.8%	86,538	15.0%
Not Hispanic American Indian or Alaska Native	85	0.4%	392	0.3%	1,551	0.3%
Not Hispanic Asian	1,776	7.3%	21,580	15.3%	100,352	17.4%
Not Hispanic Hawaiian or Pacific Islander	13	-	72	-	303	-
Not Hispanic Other Race	46	0.2%	290	0.2%	1,293	0.2%
Not Hispanic Two or More Races	908	3.8%	4,660	3.3%	18,247	3.2%
Hispanic or Latino Population (2023)	4,140 14.6%		21,006 13.0%		105,755 15.5%	
Hispanic White	1,067	25.8%	5,249	25.0%	25,895	24.5%
Hispanic Black or African American	62	1.5%	361	1.7%	1,848	1.7%
Hispanic American Indian or Alaska Native	132	3.2%	442	2.1%	2,267	2.1%
Hispanic Asian	50	1.2%	207	1.0%	634	0.6%
Hispanic Hawaiian or Pacific Islander	4	0.1%	39	0.2%	152	0.1%
Hispanic Other Race	994	24.0%	4,531	21.6%	27,005	25.5%
Hispanic Two or More Races	1,832	44.2%	10,177	48.4%	47,953	45.3%
Not Hispanic or Latino Population (2020)	20,838 85.2%		128,431 87.3%		529,895 84.4%	
Hispanic or Latino Population (2020)	3,619 14.8%		18,715 12.7%		98,087 15.6%	
Not Hispanic or Latino Population (2010)	6,920 82.0%		52,909 86.7%		300,633 83.9%	
Hispanic or Latino Population (2010)	1,522 18.0%		8,097 13.3%		57,700 16.1%	
Not Hispanic or Latino Population (2028)	30,934 85.2%		164,467 87.0%		665,360 84.4%	
Hispanic or Latino Population (2028)	5,372 14.8%		24,571 13.0%		122,886 15.6%	
Projected Annual Growth (2023-2028)	1,232 6.0%		3,565 3.4%		17,131 3.2%	
Historical Annual Growth (2010-2020)	2,097 13.8%		10,618 13.1%		40,387 7.0%	

Complete Profile

2010-2020 Census, 2023 Estimates with 2028 Projections
 Calculated using Weighted Block Centroid from Block Groups



Lat/Lon: 33.3249/-96.7862

Celina, TX		5 mi radius		10 mi radius		15 mi radius	
Total Age Distribution (2023)							
Total Population		28,312		162,023		682,052	
Age Under 5 Years		1,527	5.4%	10,914	6.7%	45,283	6.6%
Age 5 to 9 Years		2,003	7.1%	12,686	7.8%	52,536	7.7%
Age 10 to 14 Years		2,448	8.6%	13,570	8.4%	54,521	8.0%
Age 15 to 19 Years		2,109	7.4%	10,826	6.7%	45,506	6.7%
Age 20 to 24 Years		1,572	5.6%	8,024	5.0%	34,361	5.0%
Age 25 to 29 Years		1,382	4.9%	9,958	6.1%	42,245	6.2%
Age 30 to 34 Years		1,631	5.8%	12,521	7.7%	54,036	7.9%
Age 35 to 39 Years		1,872	6.6%	13,845	8.5%	61,255	9.0%
Age 40 to 44 Years		2,095	7.4%	13,224	8.2%	57,651	8.5%
Age 45 to 49 Years		2,192	7.7%	11,521	7.1%	48,900	7.2%
Age 50 to 54 Years		2,156	7.6%	10,505	6.5%	43,218	6.3%
Age 55 to 59 Years		1,957	6.9%	9,338	5.8%	37,788	5.5%
Age 60 to 64 Years		1,555	5.5%	8,035	5.0%	33,160	4.9%
Age 65 to 69 Years		1,365	4.8%	6,326	3.9%	25,871	3.8%
Age 70 to 74 Years		1,155	4.1%	5,207	3.2%	21,052	3.1%
Age 75 to 79 Years		611	2.2%	2,900	1.8%	12,351	1.8%
Age 80 to 84 Years		338	1.2%	1,434	0.9%	6,821	1.0%
Age 85 Years or Over		344	1.2%	1,190	0.7%	5,495	0.8%
Median Age		38.1		35.5		35.5	
Age 19 Years or Less		8,086	28.6%	47,996	29.6%	197,847	29.0%
Age 20 to 64 Years		16,413	58.0%	96,970	59.8%	412,615	60.5%
Age 65 Years or Over		3,813	13.5%	17,057	10.5%	71,589	10.5%
Female Age Distribution (2023)							
Female Population		13,938	49.2%	80,838	49.9%	344,679	50.5%
Age Under 5 Years		734	5.3%	5,314	6.6%	22,036	6.4%
Age 5 to 9 Years		936	6.7%	5,883	7.3%	25,803	7.5%
Age 10 to 14 Years		1,153	8.3%	6,509	8.1%	26,689	7.7%
Age 15 to 19 Years		959	6.9%	5,092	6.3%	22,116	6.4%
Age 20 to 24 Years		735	5.3%	4,052	5.0%	17,206	5.0%
Age 25 to 29 Years		670	4.8%	5,055	6.3%	21,728	6.3%
Age 30 to 34 Years		808	5.8%	6,444	8.0%	28,125	8.2%
Age 35 to 39 Years		936	6.7%	7,146	8.8%	31,142	9.0%
Age 40 to 44 Years		1,089	7.8%	6,620	8.2%	28,903	8.4%
Age 45 to 49 Years		1,109	8.0%	5,653	7.0%	23,973	7.0%
Age 50 to 54 Years		1,067	7.7%	5,198	6.4%	21,372	6.2%
Age 55 to 59 Years		968	6.9%	4,786	5.9%	19,228	5.6%
Age 60 to 64 Years		714	5.1%	4,002	5.0%	16,936	4.9%
Age 65 to 69 Years		724	5.2%	3,284	4.1%	14,058	4.1%
Age 70 to 74 Years		556	4.0%	2,654	3.3%	11,173	3.2%
Age 75 to 79 Years		344	2.5%	1,621	2.0%	6,741	2.0%
Age 80 to 84 Years		212	1.5%	844	1.0%	4,047	1.2%
Age 85 Years or Over		226	1.6%	682	0.8%	3,402	1.0%
Female Median Age		38.6		35.8		35.8	
Age 19 Years or Less		3,781	27.1%	22,798	28.2%	96,644	28.0%
Age 20 to 64 Years		8,095	58.1%	48,954	60.6%	208,614	60.5%
Age 65 Years or Over		2,062	14.8%	9,085	11.2%	39,421	11.4%

Complete Profile

2010-2020 Census, 2023 Estimates with 2028 Projections
 Calculated using Weighted Block Centroid from Block Groups



Lat/Lon: 33.3249/-96.7862

Celina, TX		5 mi radius		10 mi radius		15 mi radius	
Male Age Distribution (2023)							
Male Population		14,374	50.8%	81,186	50.1%	337,373	49.5%
Age Under 5 Years		793	5.5%	5,600	6.9%	23,247	6.9%
Age 5 to 9 Years		1,067	7.4%	6,803	8.4%	26,733	7.9%
Age 10 to 14 Years		1,295	9.0%	7,061	8.7%	27,832	8.2%
Age 15 to 19 Years		1,150	8.0%	5,734	7.1%	23,390	6.9%
Age 20 to 24 Years		837	5.8%	3,972	4.9%	17,155	5.1%
Age 25 to 29 Years		713	5.0%	4,903	6.0%	20,517	6.1%
Age 30 to 34 Years		823	5.7%	6,077	7.5%	25,911	7.7%
Age 35 to 39 Years		936	6.5%	6,699	8.3%	30,113	8.9%
Age 40 to 44 Years		1,006	7.0%	6,604	8.1%	28,748	8.5%
Age 45 to 49 Years		1,082	7.5%	5,868	7.2%	24,927	7.4%
Age 50 to 54 Years		1,089	7.6%	5,307	6.5%	21,847	6.5%
Age 55 to 59 Years		989	6.9%	4,552	5.6%	18,560	5.5%
Age 60 to 64 Years		841	5.9%	4,034	5.0%	16,224	4.8%
Age 65 to 69 Years		641	4.5%	3,042	3.7%	11,813	3.5%
Age 70 to 74 Years		599	4.2%	2,553	3.1%	9,879	2.9%
Age 75 to 79 Years		267	1.9%	1,279	1.6%	5,610	1.7%
Age 80 to 84 Years		127	0.9%	590	0.7%	2,774	0.8%
Age 85 Years or Over		117	0.8%	508	0.6%	2,093	0.6%
Male Median Age		36.7		34.7		34.9	
Age 19 Years or Less		4,305	29.9%	25,198	31.0%	101,203	30.0%
Age 20 to 64 Years		8,317	57.9%	48,016	59.1%	204,002	60.5%
Age 65 Years or Over		1,752	12.2%	7,972	9.8%	32,168	9.5%
Males per 100 Females (2023)							
Overall Comparison		103		100		98	
Age Under 5 Years		108	51.9%	105	51.3%	105	51.3%
Age 5 to 9 Years		114	53.3%	116	53.6%	104	50.9%
Age 10 to 14 Years		112	52.9%	108	52.0%	104	51.0%
Age 15 to 19 Years		120	54.5%	113	53.0%	106	51.4%
Age 20 to 24 Years		114	53.3%	98	49.5%	100	49.9%
Age 25 to 29 Years		106	51.6%	97	49.2%	94	48.6%
Age 30 to 34 Years		102	50.4%	94	48.5%	92	48.0%
Age 35 to 39 Years		100	50.0%	94	48.4%	97	49.2%
Age 40 to 44 Years		92	48.0%	100	49.9%	99	49.9%
Age 45 to 49 Years		98	49.4%	104	50.9%	104	51.0%
Age 50 to 54 Years		102	50.5%	102	50.5%	102	50.5%
Age 55 to 59 Years		102	50.5%	95	48.7%	97	49.1%
Age 60 to 64 Years		118	54.1%	101	50.2%	96	48.9%
Age 65 to 69 Years		89	47.0%	93	48.1%	84	45.7%
Age 70 to 74 Years		108	51.9%	96	49.0%	88	46.9%
Age 75 to 79 Years		78	43.8%	79	44.1%	83	45.4%
Age 80 to 84 Years		60	37.4%	70	41.2%	69	40.7%
Age 85 Years or Over		52	34.1%	74	42.7%	62	38.1%
Age 19 Years or Less		114	53.2%	111	52.5%	105	51.2%
Age 20 to 39 Years		105	51.2%	95	48.8%	95	48.8%
Age 40 to 64 Years		101	50.3%	100	50.1%	100	50.0%
Age 65 Years or Over		85	45.9%	88	46.7%	82	44.9%

Complete Profile

2010-2020 Census, 2023 Estimates with 2028 Projections
 Calculated using Weighted Block Centroid from Block Groups



Lat/Lon: 33.3249/-96.7862

Celina, TX		5 mi radius		10 mi radius		15 mi radius	
Household Type (2023)							
Total Households		8,924		53,470		232,501	
Households with Children		4,110	46.1%	25,331	47.4%	106,544	45.8%
Average Household Size		3.2		3.0		2.9	
Household Density per Square Mile		114		170		329	
Population Family		26,717	94.4%	152,022	93.8%	621,599	91.1%
Population Non-Family		1,548	5.5%	9,887	6.1%	57,791	8.5%
Population Group Quarters		47	0.2%	114	-	2,661	0.4%
Family Households		7,677	86.0%	45,363	84.8%	185,660	79.9%
Married Couple Households		6,497	84.6%	37,926	83.6%	148,392	79.9%
Other Family Households with Children		1,180	15.4%	7,438	16.4%	37,269	20.1%
Family Households with Children		4,105	53.5%	25,290	55.7%	106,390	57.3%
Married Couple with Children		3,414	83.2%	20,802	82.3%	82,782	77.8%
Other Family Households with Children		691	16.8%	4,488	17.7%	23,608	22.2%
Family Households No Children		3,572	46.5%	20,073	44.3%	79,270	42.7%
Married Couple No Children		3,083	86.3%	17,124	85.3%	65,609	82.8%
Other Family Households No Children		489	13.7%	2,950	14.7%	13,660	17.2%
Non-Family Households		1,247	14.0%	8,107	15.2%	46,841	20.1%
Non-Family Households with Children		6	0.5%	41	0.5%	153	0.3%
Non-Family Households No Children		1,241	99.5%	8,065	99.5%	46,688	99.7%
Average Family Household Size		3.5		3.4		3.3	
Average Family Income		\$231,510		\$194,990		\$172,099	
Median Family Income		\$163,727		\$165,204		\$154,161	
Average Non-Family Household Size		1.2		1.2		1.2	
Marital Status (2023)							
Population Age 15 Years or Over		22,335		124,853		529,711	
Never Married		4,892	21.9%	24,053	19.3%	127,442	24.1%
Currently Married		14,943	66.9%	84,622	67.8%	323,970	61.2%
Previously Married		2,499	11.2%	16,178	13.0%	78,299	14.8%
Separated		582	23.3%	3,451	21.3%	14,403	18.4%
Widowed		364	14.6%	4,081	25.2%	18,003	23.0%
Divorced		1,553	62.1%	8,645	53.4%	45,894	58.6%
Educational Attainment (2023)							
Adult Population Age 25 Years or Over		18,654		106,003		449,844	
Elementary (Grade Level 0 to 8)		403	2.2%	2,389	2.3%	12,888	2.9%
Some High School (Grade Level 9 to 11)		375	2.0%	2,081	2.0%	11,805	2.6%
High School Graduate		2,468	13.2%	13,189	12.4%	63,796	14.2%
Some College		3,732	20.0%	18,127	17.1%	78,473	17.4%
Associate Degree Only		1,689	9.1%	8,503	8.0%	35,768	8.0%
Bachelor Degree Only		7,309	39.2%	40,818	38.5%	157,875	35.1%
Graduate Degree		2,677	14.4%	20,896	19.7%	89,239	19.8%
Any College (Some College or Higher)		15,408	82.6%	88,344	83.3%	361,356	80.3%
College Degree + (Bachelor Degree or Higher)		9,986	53.5%	61,714	58.2%	247,115	54.9%

Complete Profile

2010-2020 Census, 2023 Estimates with 2028 Projections
 Calculated using Weighted Block Centroid from Block Groups



Lat/Lon: 33.3249/-96.7862

Celina, TX		5 mi radius		10 mi radius		15 mi radius	
Housing							
Total Housing Units (2023)		10,126		58,543		251,503	
Total Housing Units (2020)		8,207		51,335		224,110	
Historical Annual Growth (2020-2023)		1,918	-	7,208	-	27,393	-
Housing Units Occupied (2023)		8,924	88.1%	53,470	91.3%	232,501	92.4%
Housing Units Owner-Occupied		7,810	87.5%	44,187	82.6%	167,279	71.9%
Housing Units Renter-Occupied		1,114	12.5%	9,283	17.4%	65,222	28.1%
Housing Units Vacant (2023)		1,202	11.9%	5,073	8.7%	19,002	7.6%
Household Size (2023)							
Total Households		8,924		53,470		232,501	
1 Person Households		1,114	12.5%	6,780	12.7%	38,979	16.8%
2 Person Households		2,717	30.4%	16,233	30.4%	69,661	30.0%
3 Person Households		1,676	18.8%	11,424	21.4%	47,885	20.6%
4 Person Households		1,921	21.5%	11,488	21.5%	45,931	19.8%
5 Person Households		1,013	11.4%	5,143	9.6%	20,176	8.7%
6 Person Households		324	3.6%	1,777	3.3%	7,134	3.1%
7 or More Person Households		158	1.8%	625	1.2%	2,735	1.2%
Household Income Distribution (2023)							
HH Income \$200,000 or More		2,779	31.1%	15,983	29.9%	60,521	26.0%
HH Income \$150,000 to \$199,999		1,641	18.4%	9,931	18.6%	35,140	15.1%
HH Income \$125,000 to \$149,999		1,377	15.4%	6,324	11.8%	22,902	9.9%
HH Income \$100,000 to \$124,999		739	8.3%	5,971	11.2%	25,658	11.0%
HH Income \$75,000 to \$99,999		717	8.0%	4,644	8.7%	24,850	10.7%
HH Income \$50,000 to \$74,999		641	7.2%	4,521	8.5%	25,807	11.1%
HH Income \$35,000 to \$49,999		271	3.0%	2,182	4.1%	13,937	6.0%
HH Income \$25,000 to \$34,999		311	3.5%	1,392	2.6%	8,308	3.6%
HH Income \$15,000 to \$24,999		411	4.6%	1,182	2.2%	6,881	3.0%
HH Income \$10,000 to \$14,999		2	-	319	0.6%	2,988	1.3%
HH Income Under \$10,000		35	0.4%	1,021	1.9%	5,509	2.4%
Household Vehicles (2023)							
Households 0 Vehicles Available		178	2.0%	930	1.7%	5,807	2.5%
Households 1 Vehicle Available		898	10.1%	9,715	18.2%	59,921	25.8%
Households 2 Vehicles Available		4,311	48.3%	28,616	53.5%	112,060	48.2%
Households 3 or More Vehicles Available		3,537	39.6%	14,209	26.6%	54,712	23.5%
Total Vehicles Available		22,053		115,146		467,189	
Average Vehicles per Household		2.5		2.2		2.0	
Owner-Occupied Household Vehicles		19,756	89.6%	99,368	86.3%	367,352	78.6%
Average Vehicles per Owner-Occupied Household		2.5		2.2		2.2	
Renter-Occupied Household Vehicles		2,297	10.4%	15,778	13.7%	99,837	21.4%
Average Vehicles per Renter-Occupied Household		2.1		1.7		1.5	
Travel Time (2023)							
Worker Base Age 16 years or Over		15,435		89,054		380,797	
Travel to Work in 14 Minutes or Less		1,531	9.9%	8,844	9.9%	48,318	12.7%
Travel to Work in 15 to 29 Minutes		2,907	18.8%	18,184	20.4%	85,386	22.4%
Travel to Work in 30 to 59 Minutes		3,972	25.7%	22,293	25.0%	91,399	24.0%
Travel to Work in 60 Minutes or More		835	5.4%	5,064	5.7%	20,226	5.3%
Work at Home		6,191	40.1%	34,667	38.9%	135,468	35.6%
Average Minutes Travel to Work		26.8		27.7		26.2	

Complete Profile

2010-2020 Census, 2023 Estimates with 2028 Projections
 Calculated using Weighted Block Centroid from Block Groups



Lat/Lon: 33.3249/-96.7862

Celina, TX	5 mi radius		10 mi radius		15 mi radius	
Transportation To Work (2023)						
Worker Base Age 16 years or Over	15,435		89,054		380,797	
Drive to Work Alone	8,052	52.2%	47,590	53.4%	212,951	55.9%
Drive to Work in Carpool	941	6.1%	5,061	5.7%	23,581	6.2%
Travel to Work by Public Transportation	27	0.2%	116	0.1%	655	0.2%
Drive to Work on Motorcycle	6	-	44	-	150	-
Bicycle to Work	5	-	36	-	375	-
Walk to Work	43	0.3%	355	0.4%	2,162	0.6%
Other Means	170	1.1%	1,184	1.3%	5,455	1.4%
Work at Home	6,191	40.1%	34,667	38.9%	135,468	35.6%
Daytime Demographics (2023)						
Total Businesses	848		4,953		25,187	
Total Employees	4,223		23,418		149,349	
Company Headquarter Businesses	13	1.6%	77	1.5%	506	2.0%
Company Headquarter Employees	158	3.7%	877	3.7%	16,150	10.8%
Employee Population per Business	5.0 to 1		4.7 to 1		5.9 to 1	
Residential Population per Business	33.4 to 1		32.7 to 1		27.1 to 1	
Adj. Daytime Demographics Age 16 Years or Over	10,586		56,412		287,205	
Labor Force						
Labor Population Age 16 Years or Over (2023)	21,832		122,196		519,033	
Labor Force Total Males (2023)	10,960	50.2%	60,289	49.3%	254,079	49.0%
Male Civilian Employed	8,461	77.2%	48,522	80.5%	204,273	80.4%
Male Civilian Unemployed	484	4.4%	1,653	2.7%	7,005	2.8%
Males in Armed Forces	29	0.3%	113	0.2%	294	0.1%
Males Not in Labor Force	1,986	18.1%	10,001	16.6%	42,506	16.7%
Labor Force Total Females (2023)	10,872	49.8%	61,908	50.7%	264,954	51.0%
Female Civilian Employed	6,974	64.1%	40,531	65.5%	176,525	66.6%
Female Civilian Unemployed	206	1.9%	1,606	2.6%	6,010	2.3%
Females in Armed Forces	6	-	36	-	85	-
Females Not in Labor Force	3,686	33.9%	19,734	31.9%	82,335	31.1%
Unemployment Rate	690	3.2%	3,259	2.7%	13,014	2.5%
Occupation (2023)						
Occupation Population Age 16 Years or Over	15,435		89,054		380,797	
Occupation Total Males	8,461	54.8%	48,522	54.5%	204,272	53.6%
Occupation Total Females	6,974	45.2%	40,531	45.5%	176,525	46.4%
Management, Business, Financial Operations	4,425	28.7%	26,326	29.6%	103,003	27.0%
Professional, Related	4,409	28.6%	28,154	31.6%	115,800	30.4%
Service	1,878	12.2%	8,658	9.7%	42,794	11.2%
Sales, Office	2,820	18.3%	16,976	19.1%	75,621	19.9%
Farming, Fishing, Forestry	60	0.4%	194	0.2%	719	0.2%
Construction, Extraction, Maintenance	1,181	7.7%	4,096	4.6%	17,677	4.6%
Production, Transport, Material Moving	661	4.3%	4,648	5.2%	25,183	6.6%
White Collar Workers	11,654	75.5%	71,456	80.2%	294,424	77.3%
Blue Collar Workers	3,781	24.5%	17,598	19.8%	86,373	22.7%

Complete Profile

2010-2020 Census, 2023 Estimates with 2028 Projections
 Calculated using Weighted Block Centroid from Block Groups



Lat/Lon: 33.3249/-96.7862

Celina, TX			5 mi radius		10 mi radius		15 mi radius	
Units In Structure (2023)								
Total Units			8,924		53,470		232,501	
1 Detached Unit	8,046	90.2%	46,049	86.1%	178,593	76.8%		
1 Attached Unit	111	1.2%	845	1.6%	5,726	2.5%		
2 Units	60	0.7%	233	0.4%	1,850	0.8%		
3 to 4 Units	93	1.0%	567	1.1%	4,099	1.8%		
5 to 9 Units	105	1.2%	1,167	2.2%	8,107	3.5%		
10 to 19 Units	115	1.3%	1,160	2.2%	9,092	3.9%		
20 to 49 Units	61	0.7%	584	1.1%	4,996	2.1%		
50 or More Units	230	2.6%	1,963	3.7%	16,527	7.1%		
Mobile Home or Trailer	102	1.1%	859	1.6%	3,338	1.4%		
Other Structure	-	-	42	-	173	-		
Homes Built By Year (2023)								
Homes Built 2020 or later	524	5.2%	2,191	3.7%	7,087	2.8%		
Homes Built 2010 to 2019	3,780	37.3%	24,195	41.3%	87,286	34.7%		
Homes Built 2000 to 2009	2,051	20.3%	14,663	25.0%	74,589	29.7%		
Homes Built 1990 to 1999	1,019	10.1%	5,110	8.7%	29,177	11.6%		
Homes Built 1980 to 1989	586	5.8%	3,387	5.8%	16,078	6.4%		
Homes Built 1970 to 1979	364	3.6%	1,743	3.0%	7,991	3.2%		
Homes Built 1960 to 1969	222	2.2%	976	1.7%	5,101	2.0%		
Homes Built 1950 to 1959	119	1.2%	554	0.9%	2,465	1.0%		
Homes Built 1940 to 1949	232	2.3%	366	0.6%	993	0.4%		
Homes Built Before 1939	27	0.3%	284	0.5%	1,734	0.7%		
Median Age of Homes	21.8	yrs	20.0	yrs	21.6	yrs		
Home Values (2023)								
Owner Specified Housing Units			7,810		44,187		167,279	
Home Values \$1,000,000 or More	288	3.7%	1,319	3.0%	4,459	2.7%		
Home Values \$750,000 to \$999,999	547	7.0%	2,766	6.3%	9,419	5.6%		
Home Values \$500,000 to \$749,999	2,008	25.7%	10,372	23.5%	34,874	20.8%		
Home Values \$400,000 to \$499,999	1,983	25.4%	10,505	23.8%	32,904	19.7%		
Home Values \$300,000 to \$399,999	1,627	20.8%	11,422	25.9%	44,451	26.6%		
Home Values \$250,000 to \$299,999	458	5.9%	3,608	8.2%	19,578	11.7%		
Home Values \$200,000 to \$249,999	431	5.5%	1,952	4.4%	10,993	6.6%		
Home Values \$175,000 to \$199,999	98	1.3%	381	0.9%	2,408	1.4%		
Home Values \$150,000 to \$174,999	65	0.8%	280	0.6%	1,654	1.0%		
Home Values \$125,000 to \$149,999	124	1.6%	249	0.6%	834	0.5%		
Home Values \$100,000 to \$124,999	38	0.5%	225	0.5%	942	0.6%		
Home Values \$90,000 to \$99,999	1	-	11	-	66	-		
Home Values \$80,000 to \$89,999	6	-	82	0.2%	333	0.2%		
Home Values \$70,000 to \$79,999	3	-	25	-	227	0.1%		
Home Values \$60,000 to \$69,999	27	0.3%	84	0.2%	300	0.2%		
Home Values \$50,000 to \$59,999	10	0.1%	65	0.1%	692	0.4%		
Home Values \$35,000 to \$49,999	11	0.1%	127	0.3%	530	0.3%		
Home Values \$25,000 to \$34,999	6	-	93	0.2%	532	0.3%		
Home Values \$10,000 to \$24,999	35	0.5%	304	0.7%	782	0.5%		
Home Values Under \$10,000	44	0.6%	318	0.7%	1,302	0.8%		
Owner-Occupied Median Home Value	\$453,841		\$439,185		\$416,111			
Renter-Occupied Median Rent	\$1,562		\$1,580		\$1,425			

Complete Profile

2010-2020 Census, 2023 Estimates with 2028 Projections
 Calculated using Weighted Block Centroid from Block Groups



Lat/Lon: 33.3249/-96.7862

Celina, TX	5 mi radius		10 mi radius		15 mi radius	
Total Annual Consumer Expenditure (2023)						
Total Household Expenditure	\$1.13 B		\$5.88 B		\$22.87 B	
Total Non-Retail Expenditure	\$601.37 M		\$3.13 B		\$12.17 B	
Total Retail Expenditure	\$528.19 M		\$2.75 B		\$10.7 B	
Apparel	\$41.52 M		\$216.58 M		\$838.65 M	
Contributions	\$41.78 M		\$215.25 M		\$824.39 M	
Education	\$42.84 M		\$222.02 M		\$841.79 M	
Entertainment	\$67.32 M		\$349.77 M		\$1.35 B	
Food and Beverages	\$160.97 M		\$840.91 M		\$3.28 B	
Furnishings and Equipment	\$41.44 M		\$215.16 M		\$830.79 M	
Gifts	\$32.59 M		\$166.98 M		\$640.08 M	
Health Care	\$88.86 M		\$461.95 M		\$1.81 B	
Household Operations	\$46.3 M		\$240.55 M		\$929.79 M	
Miscellaneous Expenses	\$21.66 M		\$112.52 M		\$436.4 M	
Personal Care	\$15.12 M		\$78.73 M		\$306.06 M	
Personal Insurance	\$9.12 M		\$46.92 M		\$178.87 M	
Reading	\$2.5 M		\$12.97 M		\$50.27 M	
Shelter	\$235.71 M		\$1.23 B		\$4.8 B	
Tobacco	\$4.98 M		\$26.52 M		\$108.32 M	
Transportation	\$202.72 M		\$1.06 B		\$4.11 B	
Utilities	\$74.15 M		\$388.35 M		\$1.53 B	
Monthly Household Consumer Expenditure (2023)						
Total Household Expenditure	\$10,548		\$9,168		\$8,198	
Total Non-Retail Expenditure	\$5,616	53.2%	\$4,880	53.2%	\$4,361	53.2%
Total Retail Expenditures	\$4,932	46.8%	\$4,288	46.8%	\$3,836	46.8%
Apparel	\$388	3.7%	\$338	3.7%	\$301	3.7%
Contributions	\$390	3.7%	\$335	3.7%	\$295	3.6%
Education	\$400	3.8%	\$346	3.8%	\$302	3.7%
Entertainment	\$629	6.0%	\$545	5.9%	\$484	5.9%
Food and Beverages	\$1,503	14.3%	\$1,311	14.3%	\$1,177	14.4%
Furnishings and Equipment	\$387	3.7%	\$335	3.7%	\$298	3.6%
Gifts	\$304	2.9%	\$260	2.8%	\$229	2.8%
Health Care	\$830	7.9%	\$720	7.9%	\$648	7.9%
Household Operations	\$432	4.1%	\$375	4.1%	\$333	4.1%
Miscellaneous Expenses	\$202	1.9%	\$175	1.9%	\$156	1.9%
Personal Care	\$141	1.3%	\$123	1.3%	\$110	1.3%
Personal Insurance	\$85	0.8%	\$73	0.8%	\$64	0.8%
Reading	\$23	0.2%	\$20	0.2%	\$18	0.2%
Shelter	\$2,201	20.9%	\$1,918	20.9%	\$1,720	21.0%
Tobacco	\$46	0.4%	\$41	0.5%	\$39	0.5%
Transportation	\$1,893	17.9%	\$1,647	18.0%	\$1,474	18.0%
Utilities	\$692	6.6%	\$605	6.6%	\$549	6.7%