

AVAILABLE
KINGMAN, AZ

Kingman Airport Logistics Center
4200 East Industrial Blvd., Kingman, AZ 89401
620,000 SF



Class A Warehouse Space
I-40 / New I-11 Corridor



- Immediate access to Southern California markets
- 34' and 65' heights; 51'x50' and 100' column spacing
- Twin rail spur w/ exterior rail/truck dock platform and receiving house.
- Multiple dock-high and drive-in loading
- Divisible / Expandable
- Opportunity Zone with Foreign Trade Zone available
- Heavy Power Available, 15 MW substation on site

CONTACT US

Thad Smith - Big Industrial LLC
Off. 702-625-3880
Cell: 714-390-2356
Email: tsmith@bigindustrial.com



Kingman 4200

617,114 SF.
40 Acre Site (add'l 16 Acres is Available for expanding facility, trailer stor., stor.)
KINGMAN AIRPORT LOGISTICS CENTER
4200 N. Industrial Boulevard, Kingman, AZ

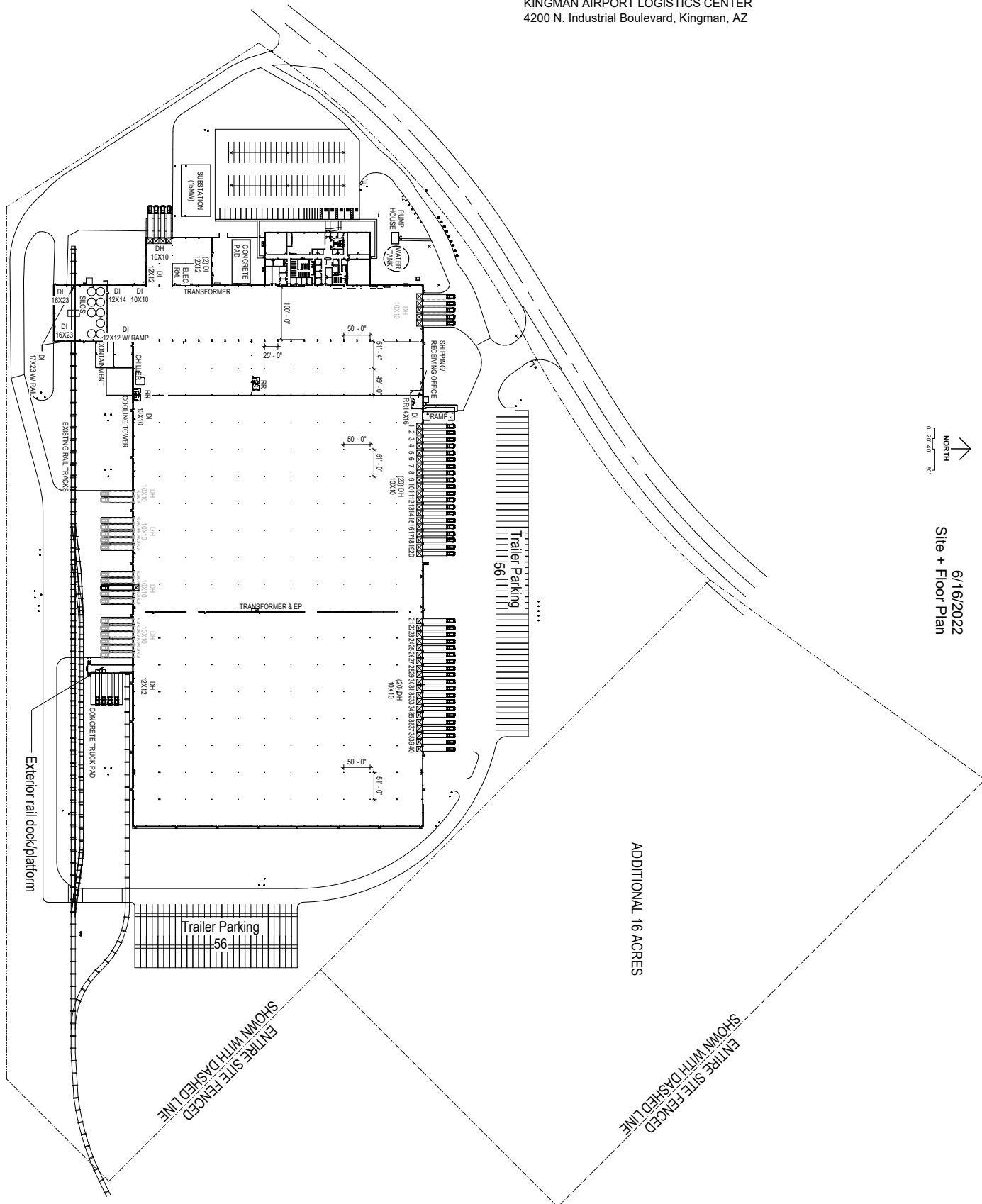

© 2022 Big Industrial, LLC ("BIG"). All rights reserved. This information has been obtained from sources believed reliable, but has not been verified for accuracy or completeness. You should conduct a careful, independent investigation of the property and verify all information. Any reliance on this information is solely at your own risk. BIG and the BIG logo are service marks of BIG. All other marks displayed on this document are the property of their respective owners. Photos herein are the property of their respective owners. Use of these images without the express written consent of the owner is prohibited. March2022