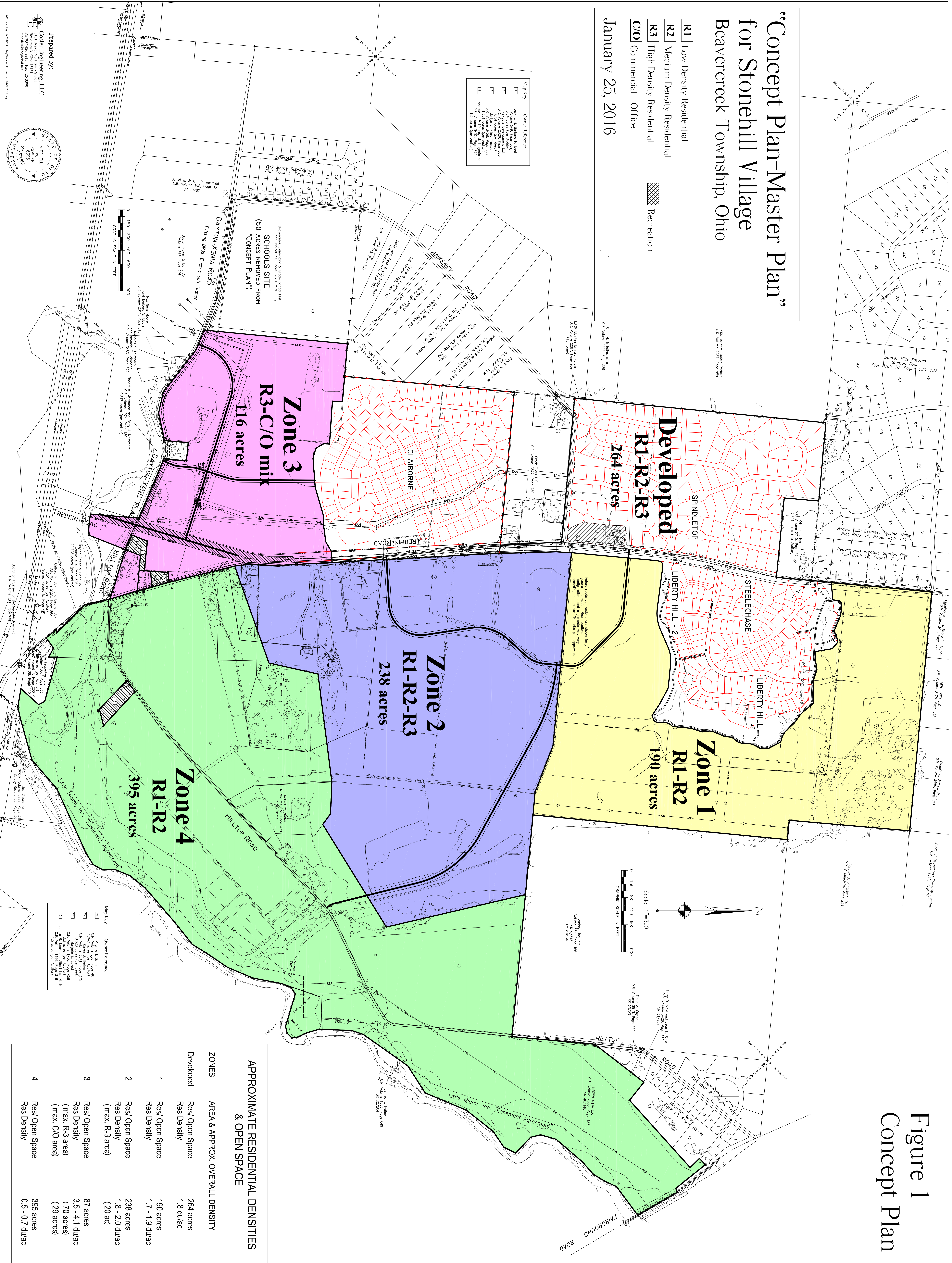

Figure 1
Concept Plan



**“Concept Plan-Master Plan”
for Stonehill Village
Beaver Creek Township, Ohio**

R1 Low Density Residential
R2 Medium Density Residential
R3 High Density Residential
C/O Commercial - Office

Recreation

January 25, 2016

Main Key

1	John L. & Barbara E. Boser 0.88 acres (per address) O.R. Volume 2102, Page 380
2	0.88 acres (per address) O.R. Volume 2102, Page 380
3	0.88 acres (per address) O.R. Volume 2102, Page 380
4	0.88 acres (per address) O.R. Volume 2102, Page 380
5	0.88 acres (per address) O.R. Volume 2102, Page 380
6	0.88 acres (per address) O.R. Volume 2102, Page 380
7	0.88 acres (per address) O.R. Volume 2102, Page 380
8	0.88 acres (per address) O.R. Volume 2102, Page 380
9	0.88 acres (per address) O.R. Volume 2102, Page 380
10	0.88 acres (per address) O.R. Volume 2102, Page 380
11	0.88 acres (per address) O.R. Volume 2102, Page 380
12	0.88 acres (per address) O.R. Volume 2102, Page 380
13	0.88 acres (per address) O.R. Volume 2102, Page 380
14	0.88 acres (per address) O.R. Volume 2102, Page 380
15	0.88 acres (per address) O.R. Volume 2102, Page 380
16	0.88 acres (per address) O.R. Volume 2102, Page 380
17	0.88 acres (per address) O.R. Volume 2102, Page 380
18	0.88 acres (per address) O.R. Volume 2102, Page 380
19	0.88 acres (per address) O.R. Volume 2102, Page 380
20	0.88 acres (per address) O.R. Volume 2102, Page 380
21	0.88 acres (per address) O.R. Volume 2102, Page 380
22	0.88 acres (per address) O.R. Volume 2102, Page 380
23	0.88 acres (per address) O.R. Volume 2102, Page 380
24	0.88 acres (per address) O.R. Volume 2102, Page 380
25	0.88 acres (per address) O.R. Volume 2102, Page 380
26	0.88 acres (per address) O.R. Volume 2102, Page 380
27	0.88 acres (per address) O.R. Volume 2102, Page 380
28	0.88 acres (per address) O.R. Volume 2102, Page 380
29	0.88 acres (per address) O.R. Volume 2102, Page 380
30	0.88 acres (per address) O.R. Volume 2102, Page 380
31	0.88 acres (per address) O.R. Volume 2102, Page 380
32	0.88 acres (per address) O.R. Volume 2102, Page 380
33	0.88 acres (per address) O.R. Volume 2102, Page 380
34	0.88 acres (per address) O.R. Volume 2102, Page 380
35	0.88 acres (per address) O.R. Volume 2102, Page 380
36	0.88 acres (per address) O.R. Volume 2102, Page 380
37	0.88 acres (per address) O.R. Volume 2102, Page 380
38	0.88 acres (per address) O.R. Volume 2102, Page 380
39	0.88 acres (per address) O.R. Volume 2102, Page 380
40	0.88 acres (per address) O.R. Volume 2102, Page 380
41	0.88 acres (per address) O.R. Volume 2102, Page 380
42	0.88 acres (per address) O.R. Volume 2102, Page 380
43	0.88 acres (per address) O.R. Volume 2102, Page 380
44	0.88 acres (per address) O.R. Volume 2102, Page 380
45	0.88 acres (per address) O.R. Volume 2102, Page 380
46	0.88 acres (per address) O.R. Volume 2102, Page 380
47	0.88 acres (per address) O.R. Volume 2102, Page 380
48	0.88 acres (per address) O.R. Volume 2102, Page 380
49	0.88 acres (per address) O.R. Volume 2102, Page 380
50	0.88 acres (per address) O.R. Volume 2102, Page 380
51	0.88 acres (per address) O.R. Volume 2102, Page 380
52	0.88 acres (per address) O.R. Volume 2102, Page 380
53	0.88 acres (per address) O.R. Volume 2102, Page 380
54	0.88 acres (per address) O.R. Volume 2102, Page 380
55	0.88 acres (per address) O.R. Volume 2102, Page 380
56	0.88 acres (per address) O.R. Volume 2102, Page 380
57	0.88 acres (per address) O.R. Volume 2102, Page 380
58	0.88 acres (per address) O.R. Volume 2102, Page 380
59	0.88 acres (per address) O.R. Volume 2102, Page 380
60	0.88 acres (per address) O.R. Volume 2102, Page 380
61	0.88 acres (per address) O.R. Volume 2102, Page 380
62	0.88 acres (per address) O.R. Volume 2102, Page 380
63	0.88 acres (per address) O.R. Volume 2102, Page 380
64	0.88 acres (per address) O.R. Volume 2102, Page 380
65	0.88 acres (per address) O.R. Volume 2102, Page 380
66	0.88 acres (per address) O.R. Volume 2102, Page 380
67	0.88 acres (per address) O.R. Volume 2102, Page 380
68	0.88 acres (per address) O.R. Volume 2102, Page 380
69	0.88 acres (per address) O.R. Volume 2102, Page 380
70	0.88 acres (per address) O.R. Volume 2102, Page 380
71	0.88 acres (per address) O.R. Volume 2102, Page 380
72	0.88 acres (per address) O.R. Volume 2102, Page 380
73	0.88 acres (per address) O.R. Volume 2102, Page 380
74	0.88 acres (per address) O.R. Volume 2102, Page 380
75	0.88 acres (per address) O.R. Volume 2102, Page 380
76	0.88 acres (per address) O.R. Volume 2102, Page 380
77	0.88 acres (per address) O.R. Volume 2102, Page 380
78	0.88 acres (per address) O.R. Volume 2102, Page 380
79	0.88 acres (per address) O.R. Volume 2102, Page 380
80	0.88 acres (per address) O.R. Volume 2102, Page 380
81	0.88 acres (per address) O.R. Volume 2102, Page 380
82	0.88 acres (per address) O.R. Volume 2102, Page 380
83	0.88 acres (per address) O.R. Volume 2102, Page 380
84	0.88 acres (per address) O.R. Volume 2102, Page 380
85	0.88 acres (per address) O.R. Volume 2102, Page 380
86	0.88 acres (per address) O.R. Volume 2102, Page 380
87	0.88 acres (per address) O.R. Volume 2102, Page 380
88	0.88 acres (per address) O.R. Volume 2102, Page 380
89	0.88 acres (per address) O.R. Volume 2102, Page 380
90	0.88 acres (per address) O.R. Volume 2102, Page 380
91	0.88 acres (per address) O.R. Volume 2102, Page 380
92	0.88 acres (per address) O.R. Volume 2102, Page 380
93	0.88 acres (per address) O.R. Volume 2102, Page 380
94	0.88 acres (per address) O.R. Volume 2102, Page 380
95	0.88 acres (per address) O.R. Volume 2102, Page 380
96	0.88 acres (per address) O.R. Volume 2102, Page 380
97	0.88 acres (per address) O.R. Volume 2102, Page 380
98	0.88 acres (per address) O.R. Volume 2102, Page 380
99	0.88 acres (per address) O.R. Volume 2102, Page 380
100	0.88 acres (per address) O.R. Volume 2102, Page 380

Prepared by:
Center Engineering, LLC
 6333
 15000
 43000

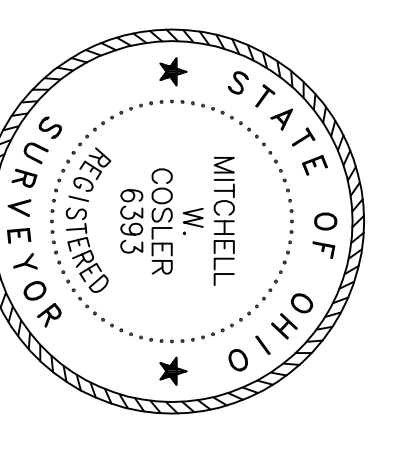

**APPROXIMATE RESIDENTIAL DENSITIES
& OPEN SPACE**

ZONES	AREA & APPROX. OVERALL DENSITY
1	Res/ Open Space Res Density 190 acres 1.7 - 1.9 du/ac
2	Res/ Open Space Res Density 238 acres 1.8 - 2.0 du/ac (20 ac)
3	Res/ Open Space Res Density 87 acres 3.5 - 4.1 du/ac (70 acres) (29 acres)
4	Res/ Open Space Res Density 395 acres 0.5 - 0.7 du/ac