



SANDERS CORNER RETAIL CENTER

708 - 730 W NORTHFIELDED BLVD

MURFREESBORO, TN 37130

RETAIL & RESTAURANT
SPACES AVAILABLE



ABOUT THE PROPERTY

Sanders Corner is a highly visible and well-established retail center located along W Northfield Boulevard, one of Murfreesboro's busiest retail corridors. The property features a mix of restaurants and service retailers and is positioned within a dense residential trade area supported by strong household incomes and consistent daytime activity.

The center offers excellent frontage, abundant parking, and easy ingress/egress, making it ideal for a wide range of retail, medical, or service tenants seeking prime positioning in one of Middle Tennessee's most dynamic markets.

PRIME RETAIL CORRIDOR | HIGH TRAFFIC LOCATION | AVG. HH INCOME \$80,000+ | CLOSE TO MTSU & I-24

SPACES AVAILABLE:

Suite #	SF	Asking Rate	
730- A & B	3,000	\$45 / SF / YR	Restaurant W/ Patio
730 - C	1,503	\$40 / SF / YR	
730 - D	1,794	\$40 / SF / YR	
708 - A	1,358	\$50 / SF / YR	Drive Thru W/ Patio

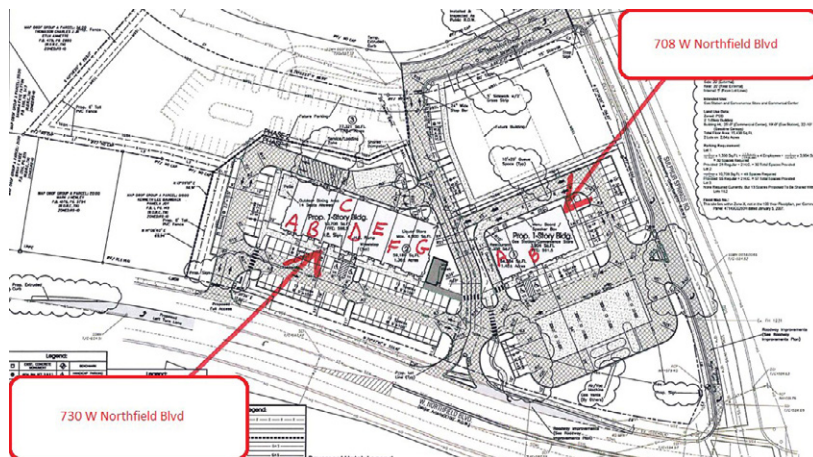

CONTACT:

SHAWN HANIFF | MANAGING BROKER | (615) 319-5122 | SHANIFF@CWPROPERTIESLLC.COM

COMMONWEALTH PROPERTIES, LLC. | (615) 292-4062 | 1019 16TH AVE S. | NASHVILLE, TN 37272



SANDERS CORNER RETAIL CENTER 708 - 730 W NORTHFIELD BLVD

MURFREESBORO, TN 37130

LEASE HIGHLIGHTS:

- Highly visible Northfield Blvd frontage in a dense retail corridor
- ±3,000 SF inline space ideal for retail, restaurant, or service use
- Excellent signage, visibility, and easy access with ample parking
- Surrounded by strong national retailers and growing residential neighborhoods
- Average household income over \$80,000 within a 3-mile radius
- Just minutes to MTSU, Memorial Blvd, and I-24

HIGH VISIBILITY ON NORTHFIELD BLVD | DENSE RESIDENTIAL TRADE AREA | EXCELLENT SIGNAGE



CONTACT:

SHAWN HANIFF | MANAGING BROKER | (615) 319-5122 | SHANIFF@CWPROPERTIESLLC.COM

COMMONWEALTH PROPERTIES, LLC. | (615) 292-4062 | 1019 16TH AVE S. | NASHVILLE, TN 37272