

# CLASS A OFFICE SPACE FOR LEASE

Euronet Worldwide Building | 17300 Chenal Pkwy | Little Rock, AR 72223



## GARY SMITH

DIR OF BUSINESS DEVELOPMENT | PARTNER

📞 501.375.3200 | 📠 501.244.7509

[gsmith@kelleycp.com](mailto:gsmith@kelleycp.com)

## CHERYL WHITE, RPA

SR PROPERTY MANAGER | PARTNER

📞 501.375.3200 | 📠 501.244.7506

[cwhite@kelleycp.com](mailto:cwhite@kelleycp.com)



**KELLEY COMMERCIAL  
PARTNERS**



# CLASS A OFFICE SPACE FOR LEASE

Euronet Worldwide Building | 17300 Chenal Pkwy | Little Rock, AR 72223

## AVAILABLE

Suite 125: ±2,052 SF

Suite 301: ±4,275 SF

## PRICE

Contact agent for pricing information

## COMMENTS

- Class A professional office space
- One of Chenal's finest office buildings
- Quiet office environment
- Scenic landscaping
- Nearby amenities include: The Centre at Chenal, The Promenade at Chenal, and some of the city's most popular restaurants

## DEMOGRAPHICS

	1 MILE	3 MILES	5 MILES	10 MILES
DAYTIME POPULATION	3,202	40,865	87,455	270,627
AVERAGE HH INCOME	\$95,443	\$121,756	\$104,631	\$84,210
TOTAL HH	1,251	17,886	38,170	114,858

## TRAFFIC COUNTS

Chenal Pkwy: 28,600 VPD

Kanis Rd: 8,100 VPD



## GARY SMITH

DIR OF BUSINESS DEVELOPMENT | PARTNER

📞 501.375.3200 | 📠 501.244.7509

gsmith@kelleycp.com

## CHERYL WHITE, RPA

SR PROPERTY MANAGER | PARTNER

📞 501.375.3200 | 📠 501.244.7506

cwhite@kelleycp.com



**KELLEY COMMERCIAL  
PARTNERS**



# CLASS A OFFICE SPACE FOR LEASE

Euronet Worldwide Building | 17300 Chenal Pkwy | Little Rock, AR 72223

**SUITE 125: ±2,052 SF**



**GARY SMITH**

DIR OF BUSINESS DEVELOPMENT | PARTNER

☎ 501.375.3200 | 📠 501.244.7509

gsmith@kelleycp.com

**CHERYL WHITE, RPA**

SR PROPERTY MANAGER | PARTNER

☎ 501.375.3200 | 📠 501.244.7506

cwhite@kelleycp.com



**KELLEY COMMERCIAL  
PARTNERS**



# CLASS A OFFICE SPACE FOR LEASE

Euronet Worldwide Building | 17300 Chenal Pkwy | Little Rock, AR 72223

## SUITE 301: ±4,275 SF

- Reception/waiting area
- Large bull pen area
- 4 windowed offices
- Supply room
- Large conference room
- Large break room
- Abundance of windows and natural light.



### GARY SMITH

DIR OF BUSINESS DEVELOPMENT | PARTNER

☎ 501.375.3200 | 📠 501.244.7509

[gsmith@kelleycp.com](mailto:gsmith@kelleycp.com)

### CHERYL WHITE, RPA

SR PROPERTY MANAGER | PARTNER

☎ 501.375.3200 | 📠 501.244.7506

[cwhite@kelleycp.com](mailto:cwhite@kelleycp.com)



**KELLEY COMMERCIAL  
PARTNERS**

# CLASS A OFFICE SPACE FOR LEASE

Euronet Worldwide Building | 17300 Chenal Pkwy | Little Rock, AR 72223

## FLOOR PLAN - 1ST FLOOR

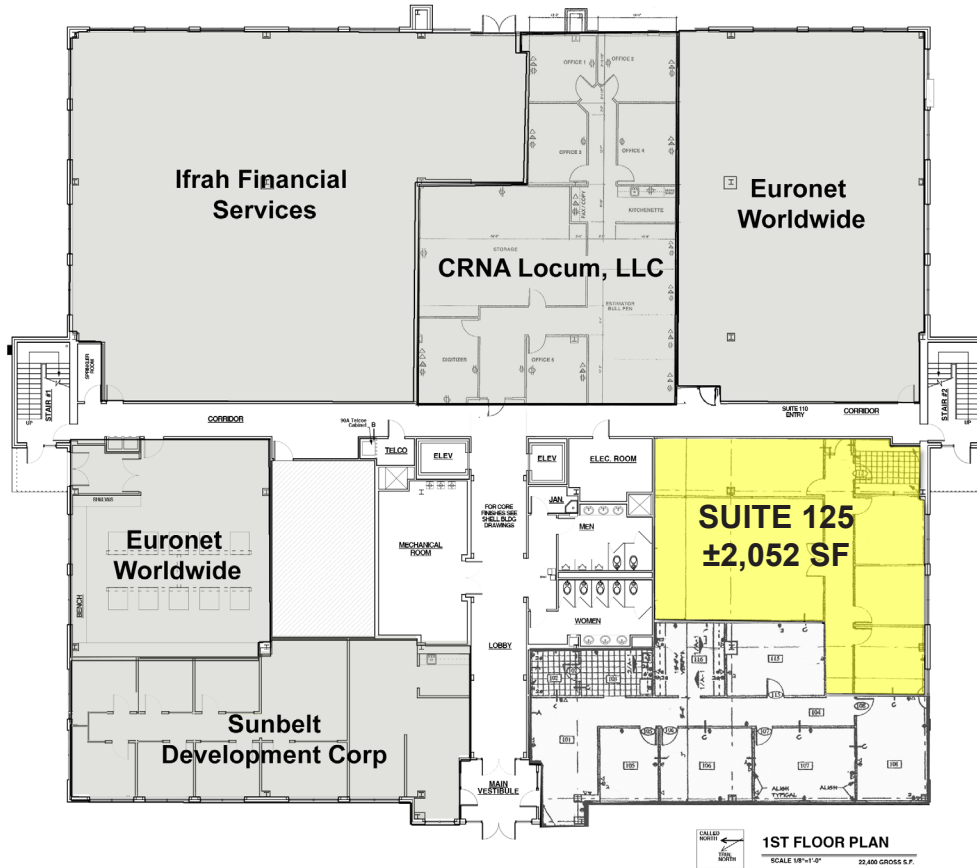

## FLOOR PLAN - 3RD FLOOR

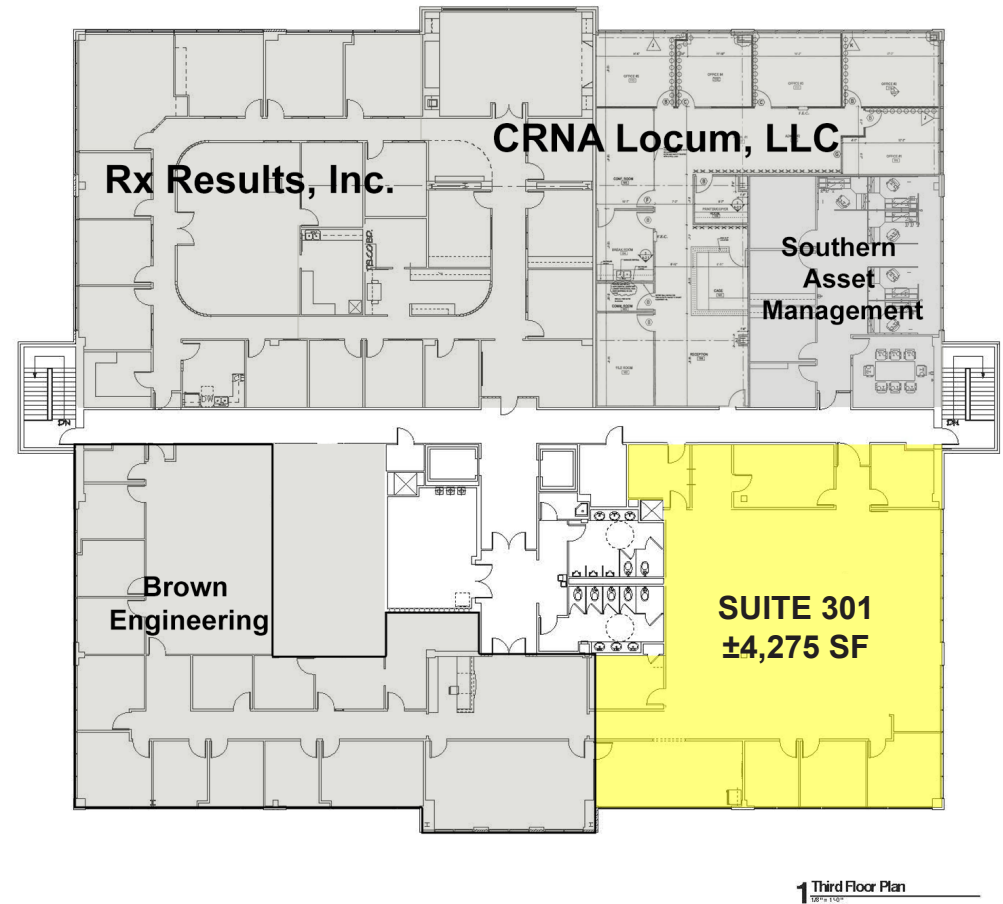

**GARY SMITH**  
DIR OF BUSINESS DEVELOPMENT | PARTNER  
☎ 501.375.3200 | 📠 501.244.7509  
gsmith@kelleycp.com

**CHERYL WHITE, RPA**  
SR PROPERTY MANAGER | PARTNER  
☎ 501.375.3200 | 📠 501.244.7506  
cwhite@kelleycp.com



## ABOUT KELLEY COMMERCIAL PARTNERS

Kelley Commercial Partners is a full-service commercial real estate firm providing the highest caliber of services to owners, investors, landlords, and tenants. We service clients with the focused attention that only a privately-owned local firm can offer. At Kelley Commercial Partners, we take pride in maintaining long-term relationships built on trust, resourcefulness, and reliability.



**GARY SMITH**  
DIR OF BUSINESS DEVELOPMENT | PARTNER



**CHERYL WHITE, RPA**  
SENIOR PROPERTY MANAGER | PARTNER

Kelley Commercial Partners is the agent for the owner of the property described herein. All information contained herein is secured from sources we believe to be reliable. However, no information is guaranteed in any way. Any reproduction of this material, in whole or in part is prohibited without prior written consent of Kelley Commercial Partners.

BROKERAGE

PROPERTY MANAGEMENT

DEVELOPMENT MANAGEMENT

CONSULTING

---

425 W. Capitol Avenue, Suite 300  
Little Rock, AR 72201  
501.375.3200

4100 Corporate Center Drive, Suite 101  
Springdale, AR 72762  
479.443.8002



**KELLEY COMMERCIAL  
PARTNERS**

[kelleycp.com](http://kelleycp.com) | [in](#) [f](#) [@](#)

**CHAINLINKS**  
RETAIL ADVISORS