

GROUND LEASE AVAILABLE

## PRIME CORNER PARCEL

NWC TAHQUITZ CANYON & SUNRISE WAY | PALM SPRINGS, CA

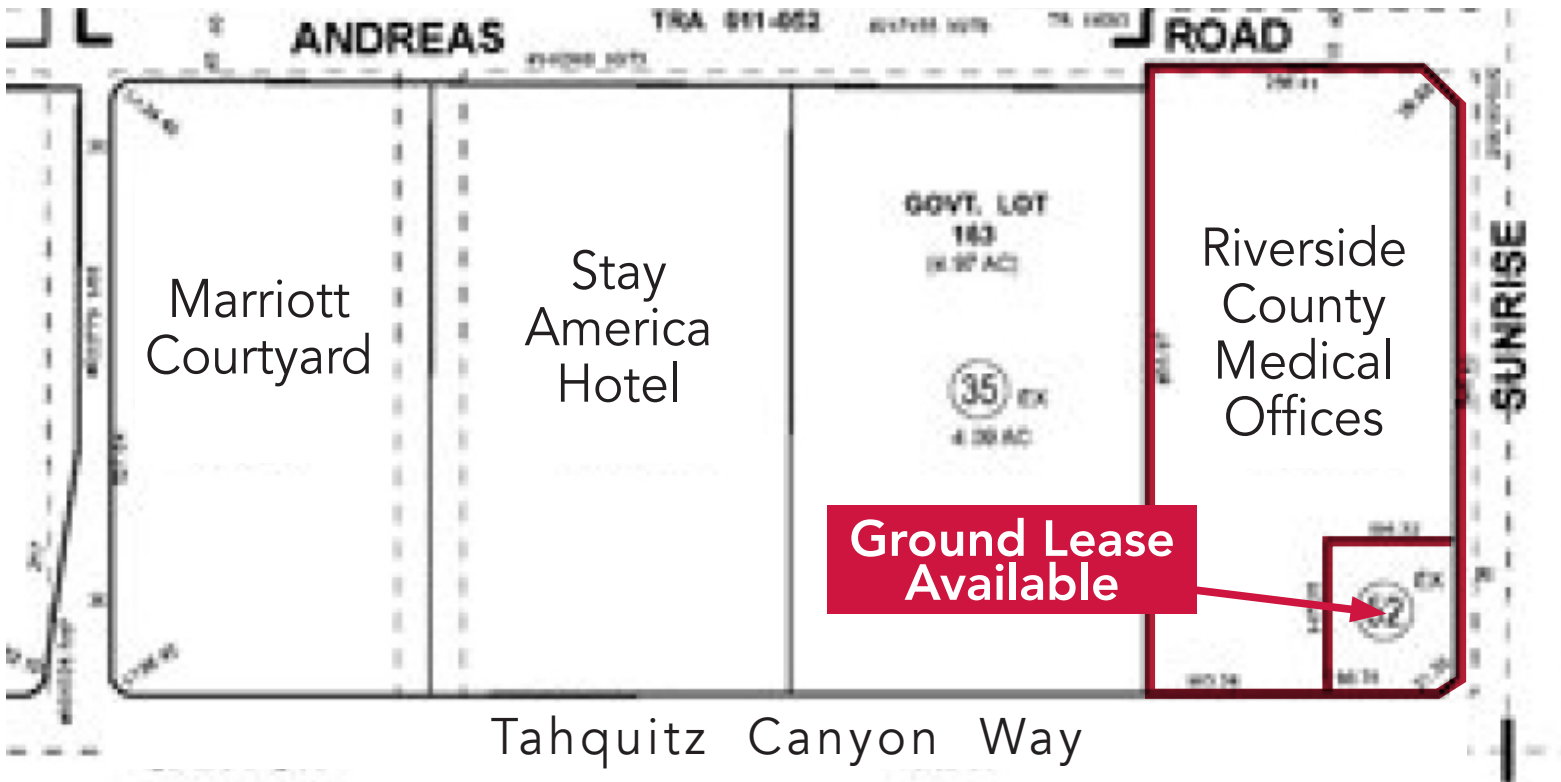

### FEATURES

- In the heart of Palm Springs business district
- 16,988 ± SF, lighted, corner parcel available
- Adjacent to 35,500 SF County Medical Building
- Strong demographics in under-served trade area
- Central business area serving full-time residents, snowbird's & tourists
- Easy access. Excellent visibility & signage



2025 DEMOGRAPHICS			
	1MI	3MI	5MI
POPULATION	12,863	54,668	110,504
# OF HOUSEHOLDS	7,269	29,430	50,704
AVERAGE HH INCOME	\$124,768	\$129,362	\$119,594

**Maggie Montez**  
mmontez@leedesert.com  
760.346.2520  
LIC #01070683

**Shawna Strange**  
sstrange@leedesert.com  
760.346.2533  
LIC #01718495

73000 Highway 111, Suite 200 | Palm Desert, CA 92260 | [www.LeePalmDesert.com](http://www.LeePalmDesert.com) | Corp ID # 01911964



All information furnished regarding property for sale, rental or financing is from sources deemed reliable, but no warranty or representation is made to the accuracy thereof and same is submitted to errors, omissions, change of price, rental or other conditions prior to sale, lease or financing or withdrawal without notice. No liability of any kind is to be imposed on the broker herein.



GROUND LEASE AVAILABLE

## PRIME CORNER PARCEL

NWC TAHQUITZ CANYON & SUNRISE WAY | PALM SPRINGS, CA

### AERIAL

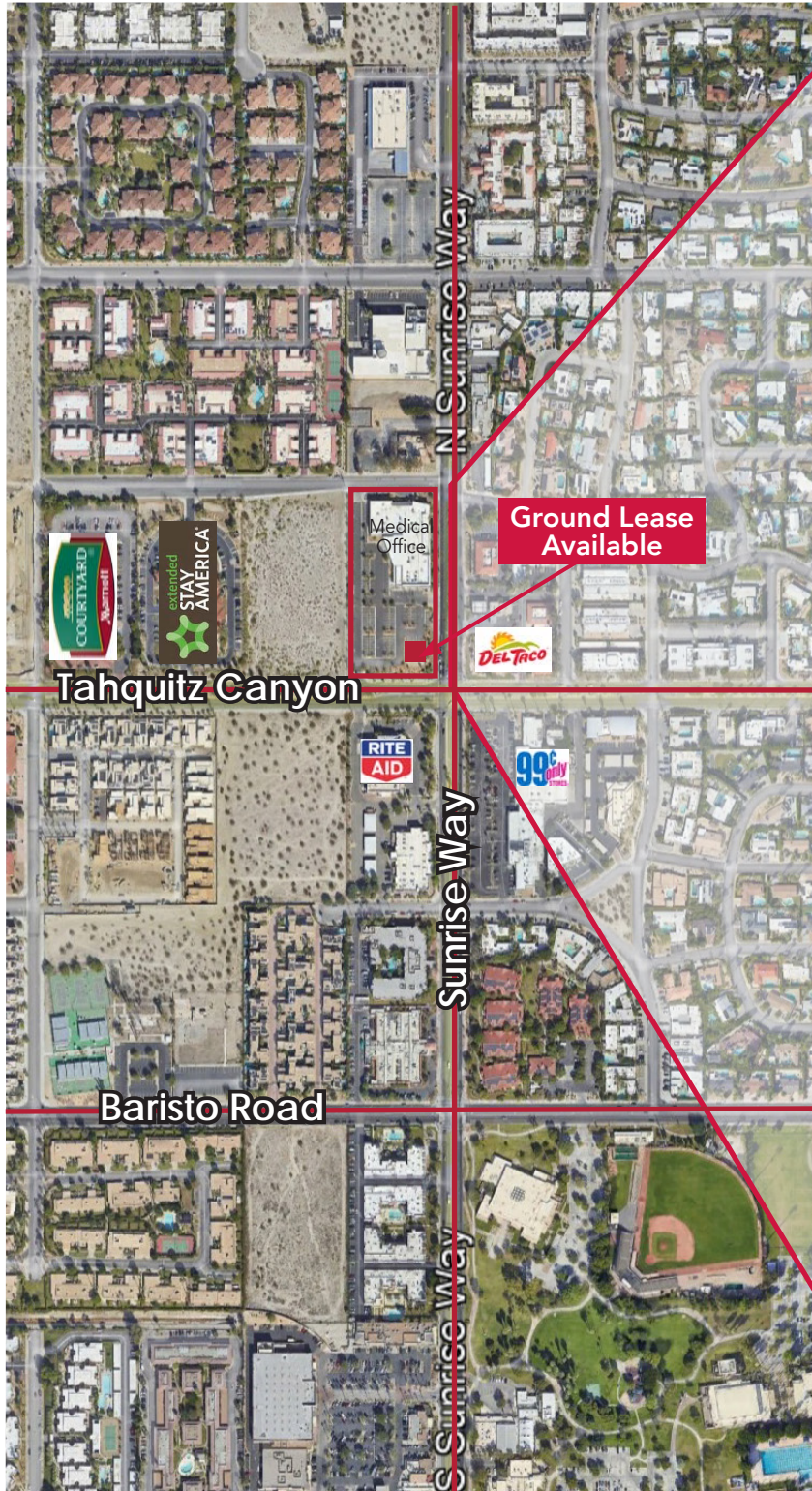

### SITE PLAN

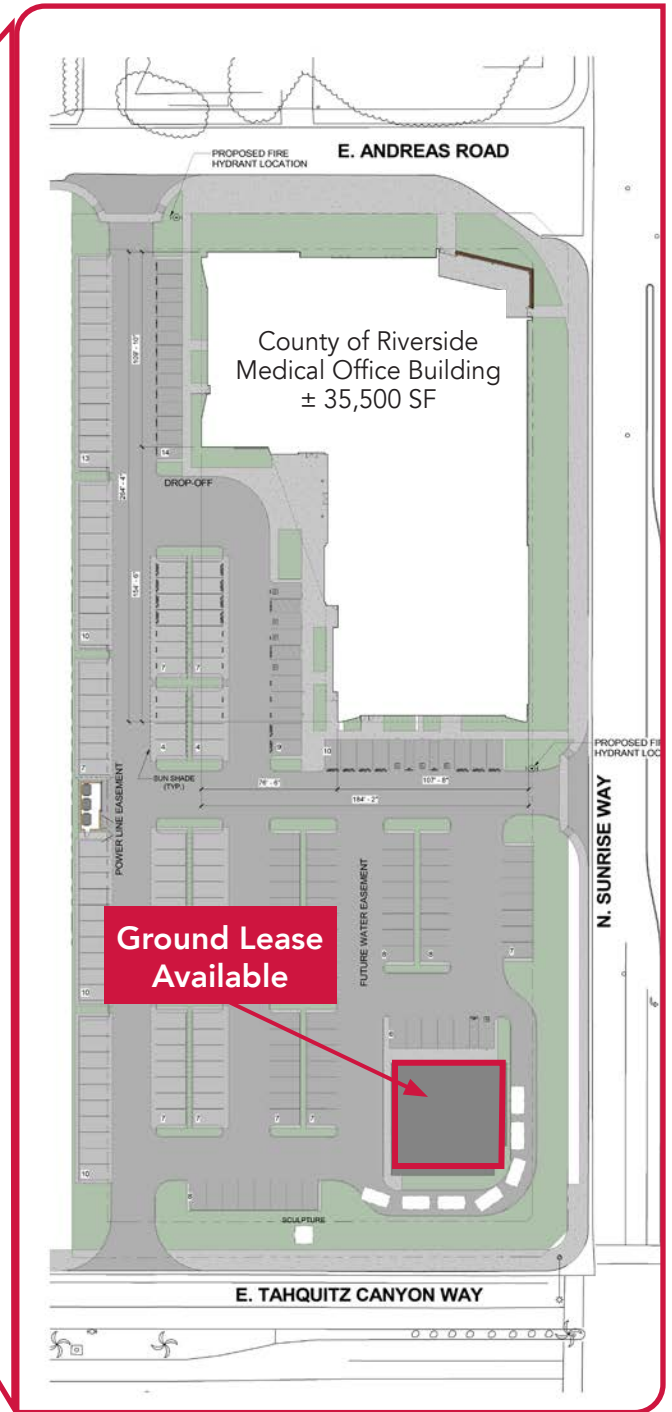

**Maggie Montez**  
mmontez@leedesert.com  
760.346.2520  
LIC #01070683

**Shawna Strange**  
sstrange@leedesert.com  
760.346.2533  
LIC #01718495