

# FOR LEASE

## ± 1,043 SF



## 5623 TEXOMA PARKWAY

Sherman, TX 75090

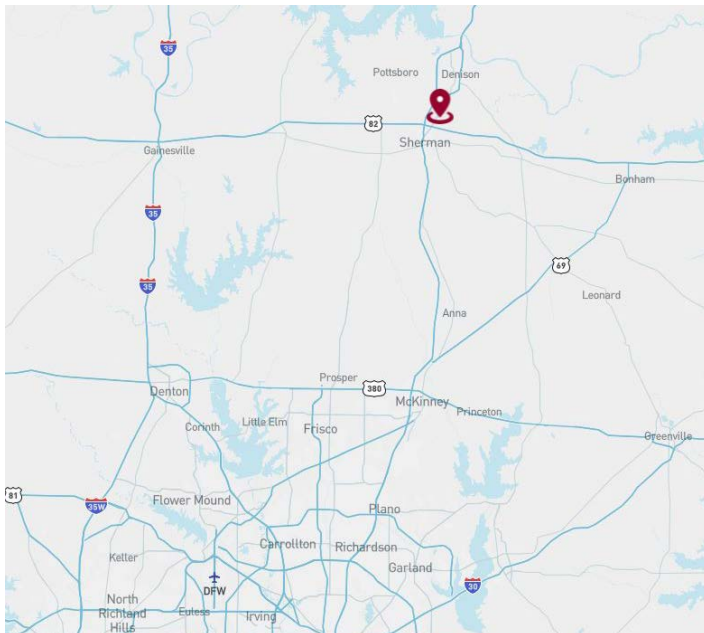

## AVAILABILITY HIGHLIGHTS

- ± 1,043 Available Square Feet
- Ample Parking
- 100% HVAC
- Ideal for Office and Retail Use
- Front Park, Rear Load
- Available now

## ECONOMIC DATA

Call Broker for Lease Rate; \$3.20 OPEX

FOR LEASING INFORMATION:

**Phil Rosenfeld**  
Principal

[prosenfeld@lee-associates.com](mailto:prosenfeld@lee-associates.com)  
469.222.4159

**LEE & ASSOCIATES**  
COMMERCIAL REAL ESTATE SERVICES  
[leedallas.com](http://leedallas.com)

± 1,043 SF

FOR LEASE

SITE PLAN

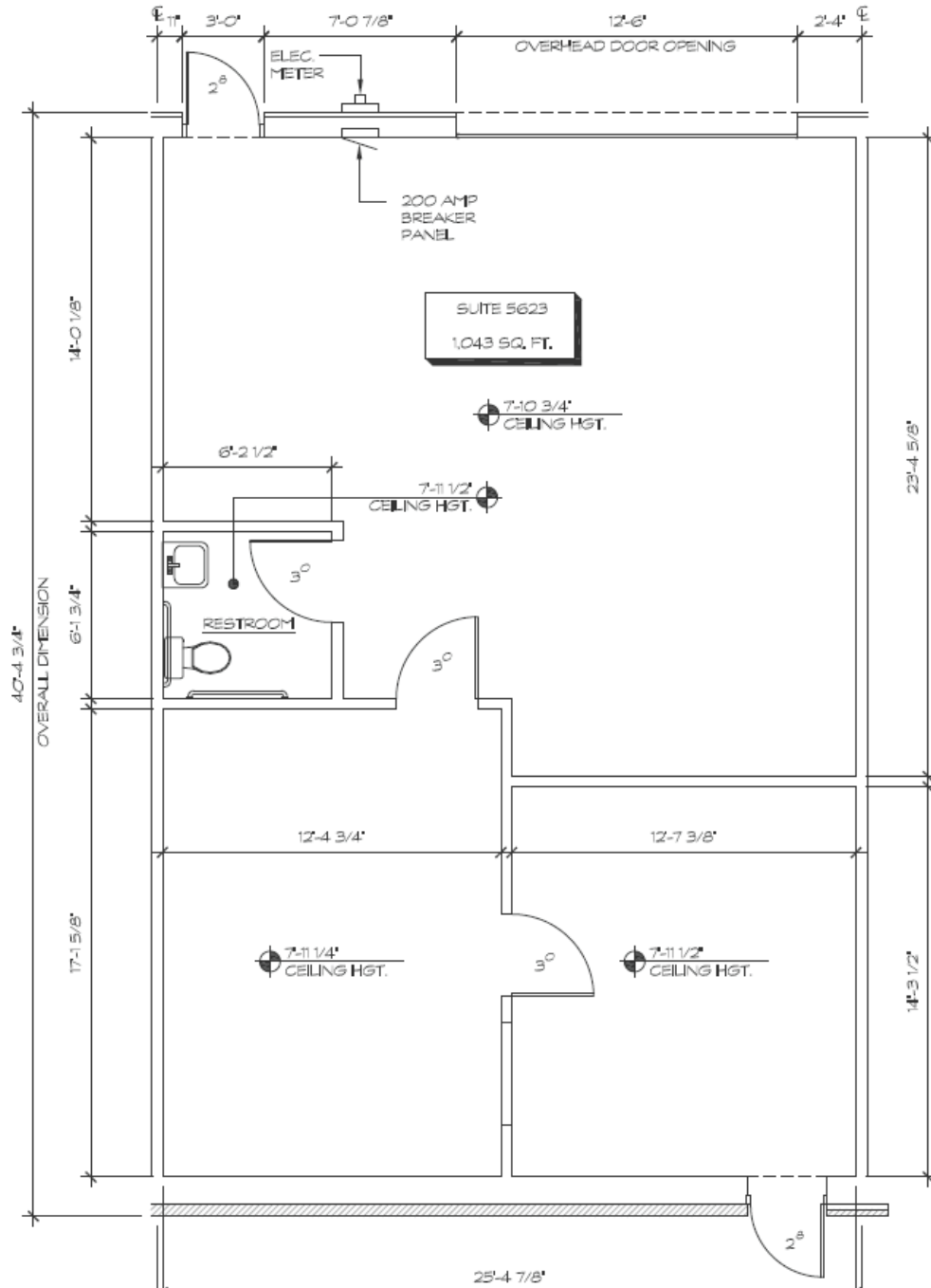

All information furnished regarding property for sale, rental or financing is from sources deemed reliable, but no warranty or representation is made to the accuracy thereof and same is submitted to errors, omissions, change of price, rental or other conditions prior to sale, lease or financing or withdrawal without notice. No liability of any kind is to be imposed on the broker herein.

FOR LEASING INFORMATION:

**Phil Rosenfeld**  
Principal

[prosenfeld@lee-associates.com](mailto:prosenfeld@lee-associates.com)

469.222.4159

**LEE & ASSOCIATES**  
COMMERCIAL REAL ESTATE SERVICES

[leedallas.com](http://leedallas.com)