

# 25,200 SF

**2000 NW 97th Ave  
Doral, FL 33172**

Prologis Beacon at 97th

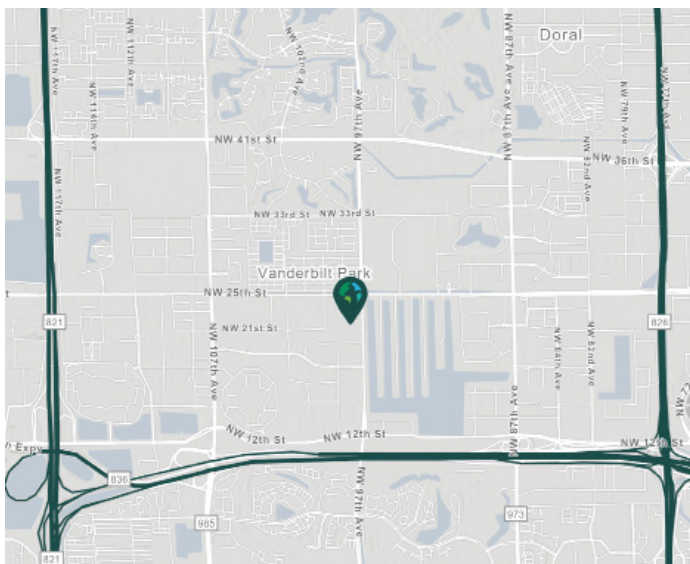

## Property Features

Available Space	25,200 SF
Office SF	2,500 SF
Clear Height	24'
Column Spacing	40'x30'
Dock Doors	8
Drive-in Doors	1
Truck Court	160' shared
Car Parking Spots	1.4/1,000

- Easy access to Miami International Airport and PortMiami
- Direct access to SR 836 (Dolphin Expressway), with easy access to SR 826 (Palmetto Expressway) and Florida's Turnpike.



Unlock the full potential of your warehouse with one strategic, single-source partner.

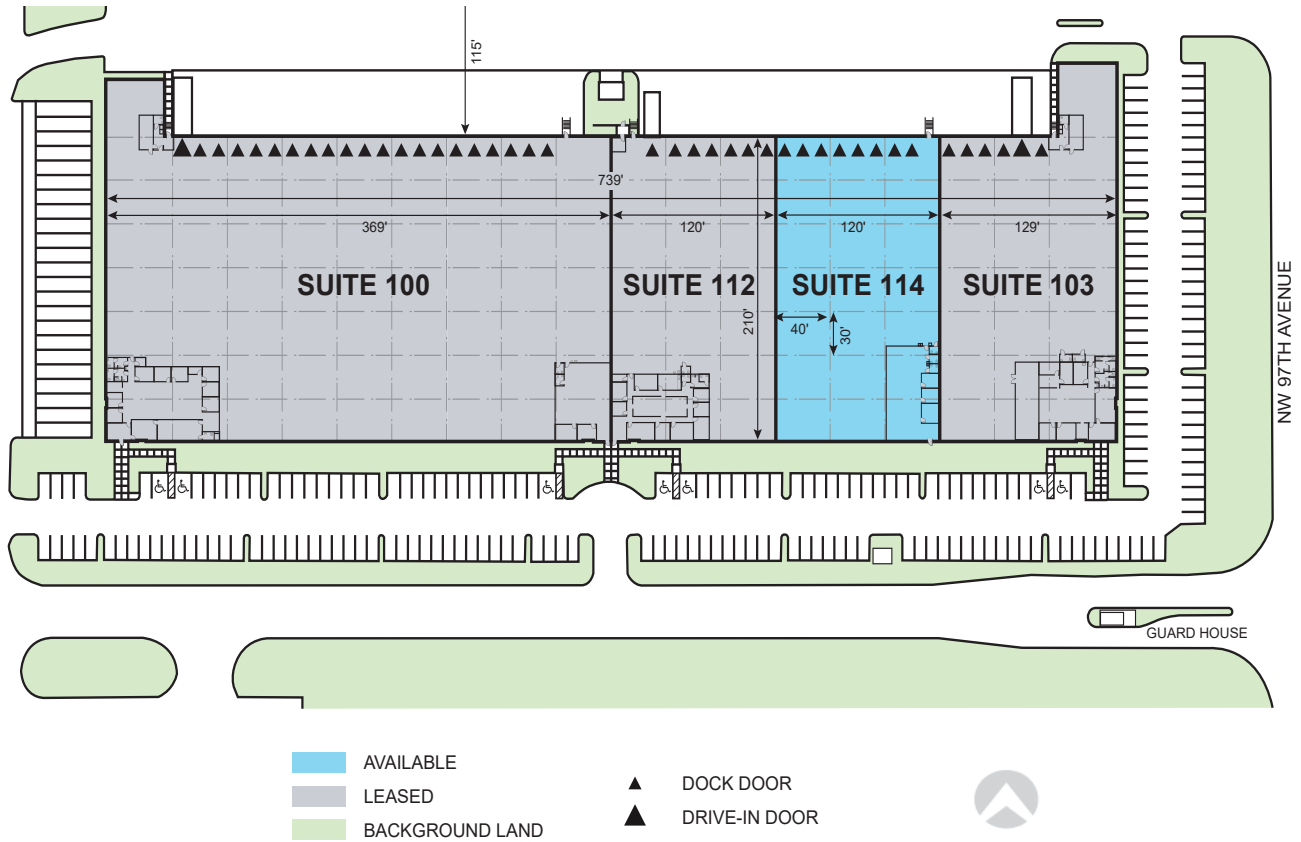

# CBRE

**CBRE**  
**David Albert**  
 david.albert@cbre.com  
 ph +1 305 519 4401

**CBR**  
**Mateo Coman**  
 mateo.coman@cbre.com  
 ph +1 810 626 8613

**Prologis**  
**Barbara Mantecon**  
 bmantecon@prologis.com  
 ph +1 305 793 9369  
 prologis.com

**Prologis**  
**Diana T. Escobar**  
 descobar@prologis.com  
 ph +1 786 960 2121  
 prologis.com