

# FOR LEASE

# 12,565 SF – 35,867 SF



## CLASS A OFFICE & INDUSTRIAL FLEX

## 10000

COVINGTON CROSS DR,  
LAS VEGAS, NV 89144

**Arlan Adamsen**  
**702-780-1111**  
**Arlan@KCommercial.com**

*COVECO, LLC*



## LEASE SUMMARY

STARTING  
RENT

**\$2.25/SF NNN**

LEASABLE  
UNITS

**12,565 - 35,867 SF**

FLEXIBLE  
USES

**Office  
Call Center  
Warehouse  
Light Manufacturing  
R&D**

STARTING  
CAM FEE

**\$0.70/SF**

LOT SIZE

**4.05 Acres  
5.28 Acres With Extra Land**

ELECTRICAL  
POWER

**3,000 Amps 208/120 V, 3-phase**

CLEAR  
HEIGHT

**20'**

HVAC

**Entire Building**

PARKING

**240 Spaces (6.7/1000 SF)  
367 Spaces (10.2/1000 SF) with  
Extra Land**

ZONING

**P-C  
EC Summerlin**

CLASS

**A**







## PROPERTY OVERVIEW

- ✓ **12,565 - 35,867 SF Office, Warehouse, Light Manufacturing, R&D**
- ✓ **Options for Various Dock-High and Drive-In Loading Available**
- ✓ **10.2/1000 SF Parking Spaces with Optional Extra Land**
- ✓ **Built in 1997**
- ✓ **P-C (EC Summerlin) Allows for Office, Light Industry, Business, Profesional, and Support Commercial Services**
- ✓ **Fully Fire Sprinklered**
- ✓ **Easy Access from Summerlin Parkway and Town Center**
- ✓ **Located in the Highly Desirable Commercial Corridor of Summerlin**

Disclaimer: The information contained herein (on this page and included pages) has been obtained through sources deemed reliable but cannot be guaranteed or relied upon as to its accuracy. Any information should be verified through independent sources by interested parties. All measurements and calculations are approximate. The property may no longer be available for sale or lease, may be withdrawn, its offering price changed, or sold or leased to another party at anytime and without notice. Please do not provide any information deemed private or confidential.

*COVECO, LLC*

# Single Tenant

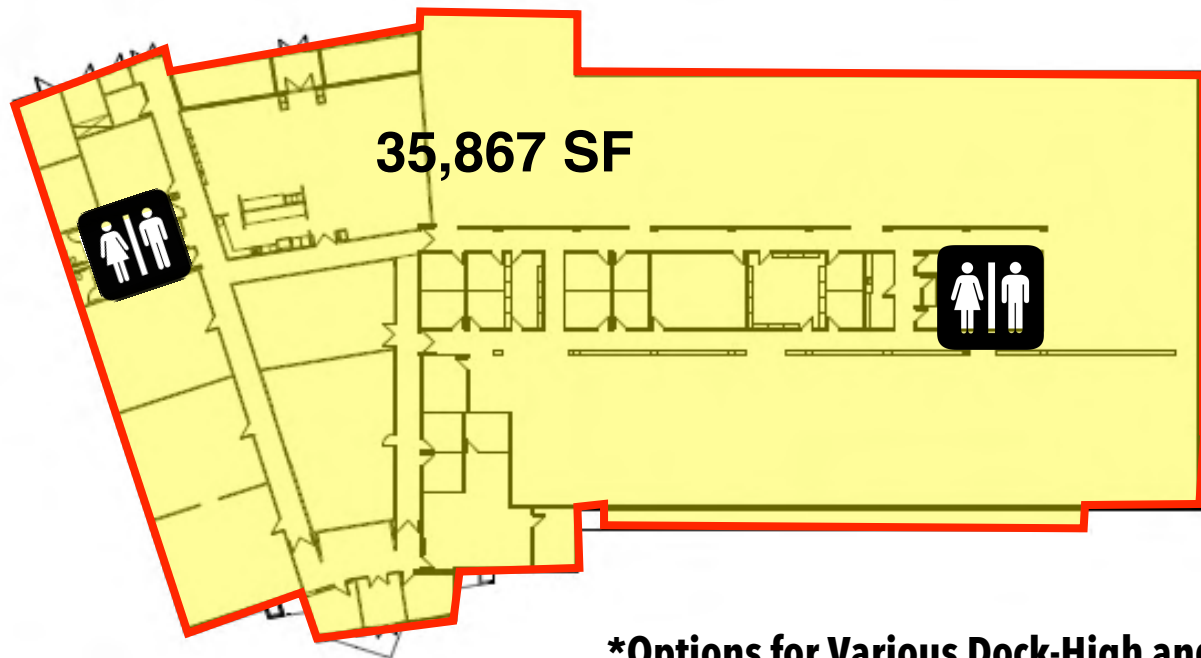

**\*Options for Various Dock-High and Drive-In Loading Available**

# Multi-Tenant

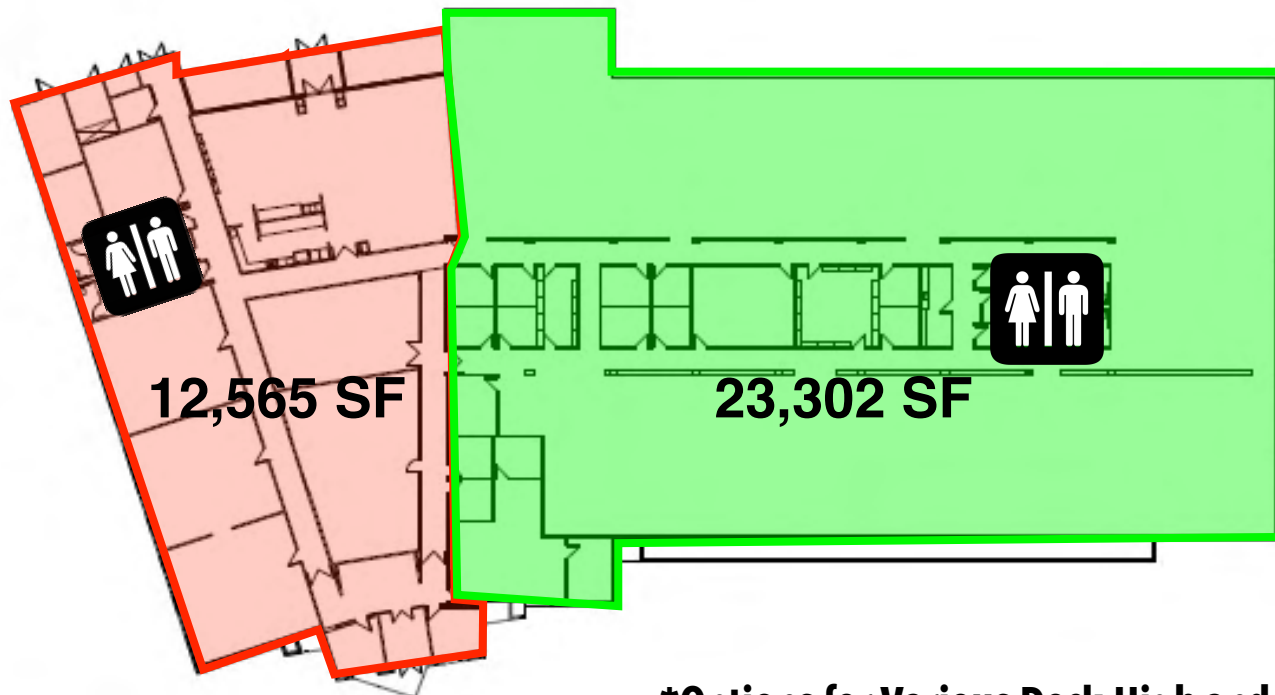

**\*Options for Various Dock-High and Drive-In Loading Available**





COVECO, LLC



# LOCATION

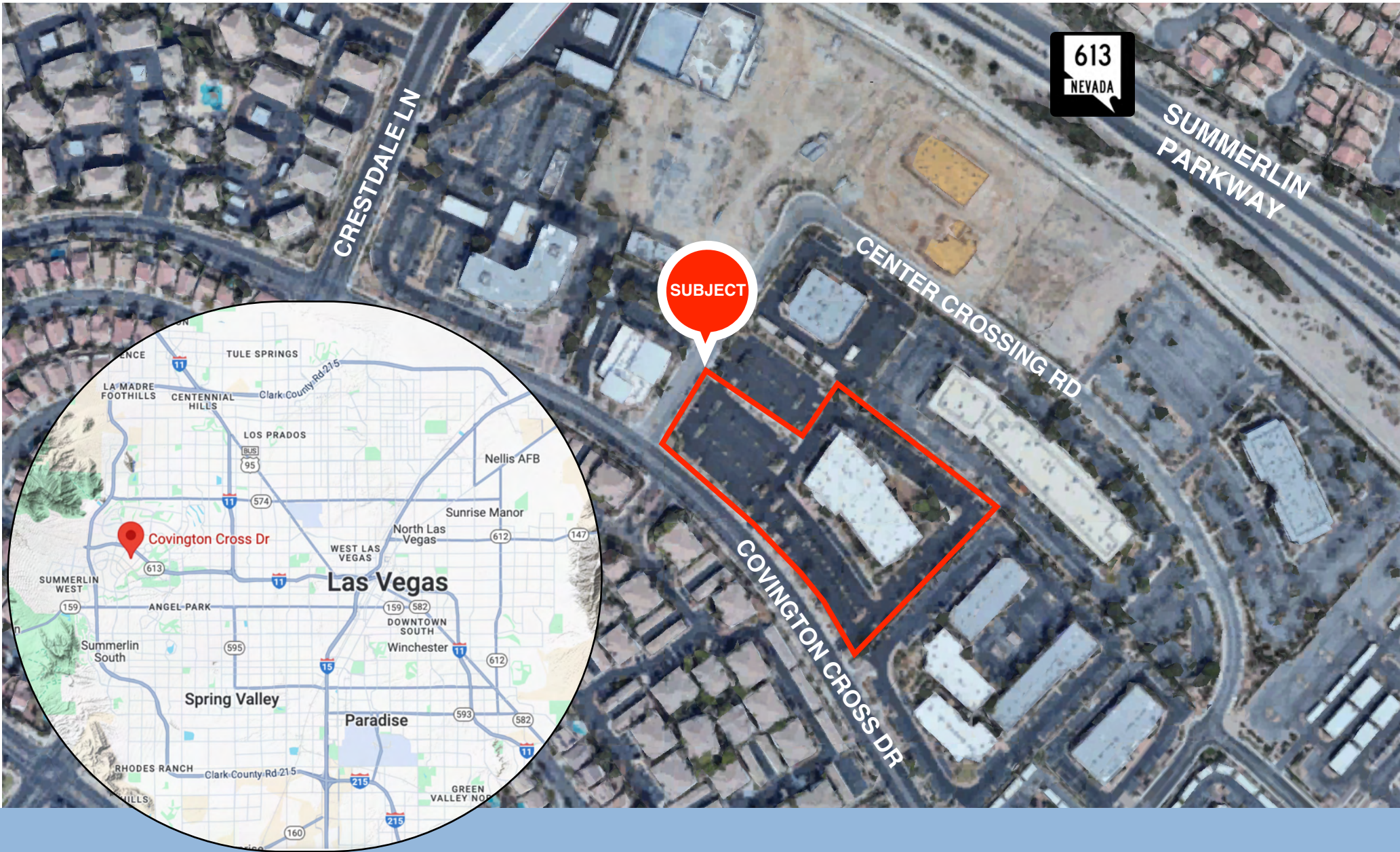

**Arlan Adamsen**  
**702-780-1111**  
**Arlan@KCommercial.com**

*COVECO, LLC*