



**Plug and Play
Biotech space**

**SF Available:
8,392-15,000**

**Sublease through
April 2026**

400 Seaport Ct,
Redwood City, CA

Innovation Properties Group
181 2nd Street, San Francisco, CA
www.ipgsf.com | CL 02031924

Ivan Smiljanic | Partner
(510) 717-5008 | Ivan@ipgsf.com
BRE 01995999

Rocky Kile | Associate
(401) 263-4218 | rocky@ipgsf.com
BRE 02233435



INNOVATION PROPERTIES GROUP

Space Features:

- 60% Lab // 40% Office.
- Three (3) BSL2 labs
- Analytical open lab
- Heavy power
- Open office
- Five (5) meeting rooms.
- Kitchen
- Abundant surface parking
- Generous private outdoor space
- 6,600 SF of predesigned lab expansion available

Innovation Properties Group

181 2nd Street, San Francisco, CA
www.ipgsf.com | CL 02031924

Ivan Smiljanic | Partner

(510) 717-5008 | Ivan@ipgsf.com
BRE 01995999

Chris Baker | Senior Associate

(650) 315-9858 | Chris@ipgsf.com
BRE 02116566

400 Seaport Ct, Redwood City

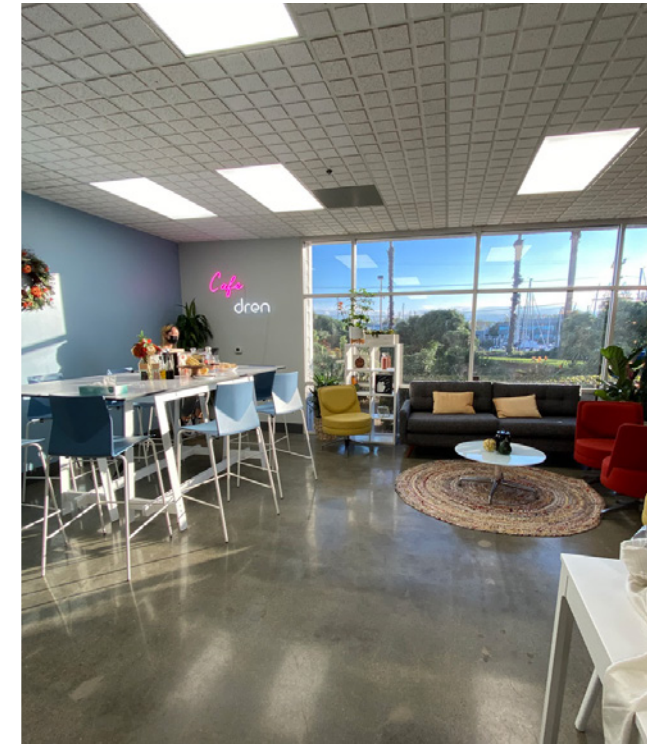

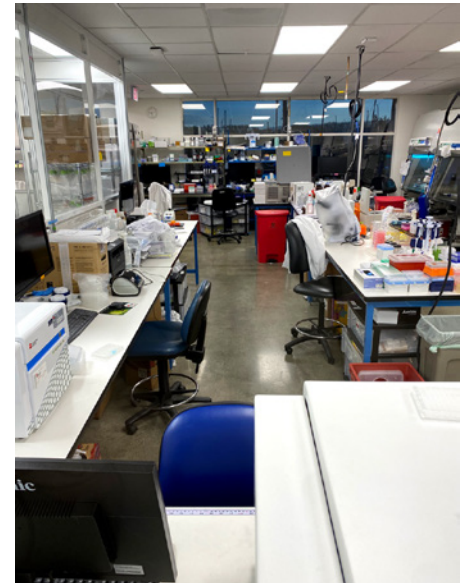
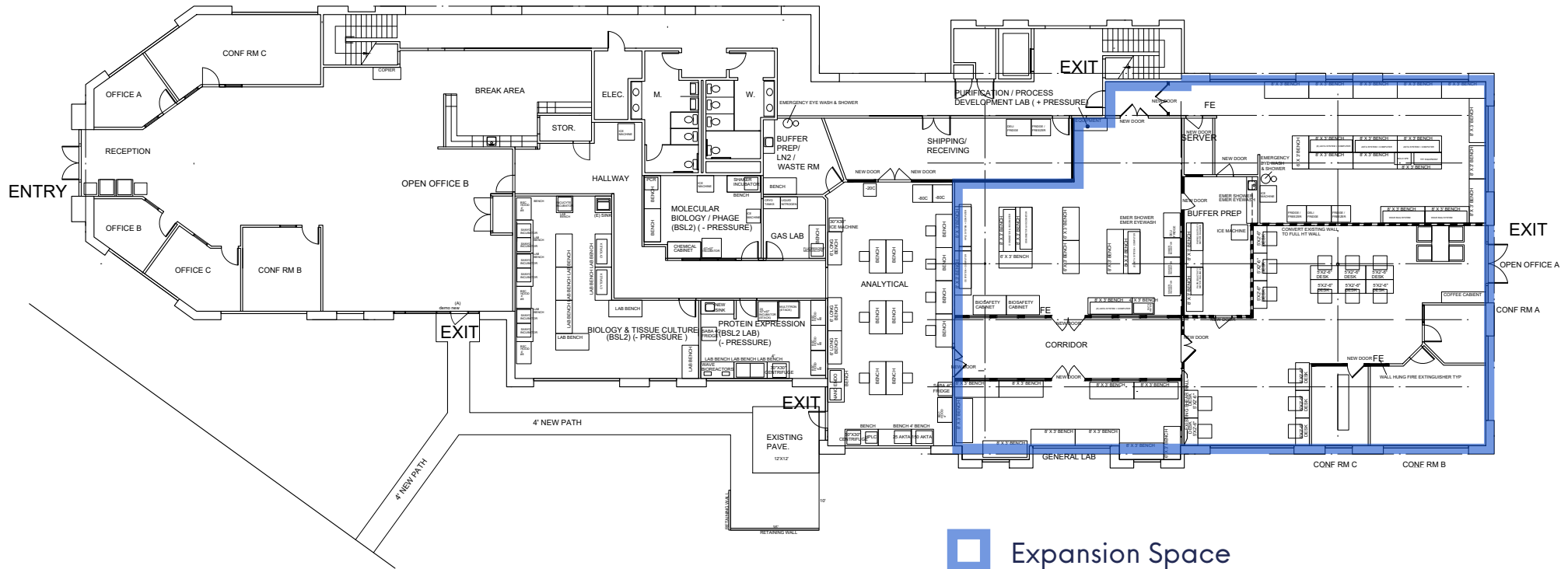

Location Features:

- Next to the Sequoia Yacht Club
- Right off Seaport Blvd @ Port of Redwood City
- Excellent freeway access to Hwy 101 & 280
- Walking distance to Seaport Centre Caltrain Shuttle

Amenities



caltrain.com



City of Redwood City - LinkedIn



marinas.com



Innovation Properties Group
181 2nd Street, San Francisco, CA
www.ipgsf.com | CL 02031924

Ivan Smiljanic | Partner
(510) 717-5008 | Ivan@ipgsf.com
BRE 01995999

Rocky Kile | Associate
(401) 263-4218 | rocky@ipgsf.com
BRE 02233435



400 Seaport Ct Redwood City



Innovation Properties Group
181 2nd Street, San Francisco, CA
www.ipgsf.com | CL 02031924

Ivan Smiljanic | Partner
(510) 717-5008 | Ivan@ipgsf.com
BRE 01995999

Rocky Kile | Associate
(401) 263-4218 | rocky@ipgsf.com
BRE 02233435