



TREE TABLE

1	22" OAK
2	2 TREE CLUSTER 11" 11"
3	23" OAK
4	04" OAK
5	29" OAK
6	2 TREE CLUSTER 12" 10"
7	4 TREE CLUSTER 12" 10" 14" 10"
8	4 TREE CLUSTER 09" 12" 10" 10"
9	32" OAK
10	MISC SIZE PALM TREE

LEGEND

- DIMENSION POINT—NOTHING FOUND OR SET
- ⊙ SANITARY SEWER MANHOLE
- DRAIN INLET
- ⊠ STREET LIGHT
- ⊕ SEWER BOX
- UNKNOWN RISER
- ⊕ MISC SIGN
- ⊕ FIRE HYDRANT
- ⊕ WATER VALVE
- ⊕ ELECTRICAL BOX
- WOOD FENCE
- - - EASEMENT
- PROPERTY LINE
- ASPHALT SURFACE

BENCH MARK

ASSUMED ELEVATION BASED ON CSDS VSN NETWORK

BASIS OF BEARINGS

THE MERIDIAN OF THIS SURVEY IS IDENTICAL TO THAT OF 128 PM 3 BASED ON FOUND MONUMENTS.

SURVEYOR'S STATEMENT

THIS SURVEY IS BASED UPON A FIELD SURVEY CONDUCTED UNDER MY DIRECTION. THE BOUNDARY SHOWN IS BASED ON THE RESOLUTION SHOWN ON 128 PM 3. THE ONLY EASEMENTS SHOWN ARE THOSE THAT WERE REFERENCED ON SAID MAP. THERE WAS NO TITLE REPORT SUPPLIED THEREFORE EASEMENTS AND SETBACKS OF RECORD MAY EXIST.

PRELIMINARY

BRENDAN WILLIAMS, P.L.S. 9049 11-17-2022 DATE

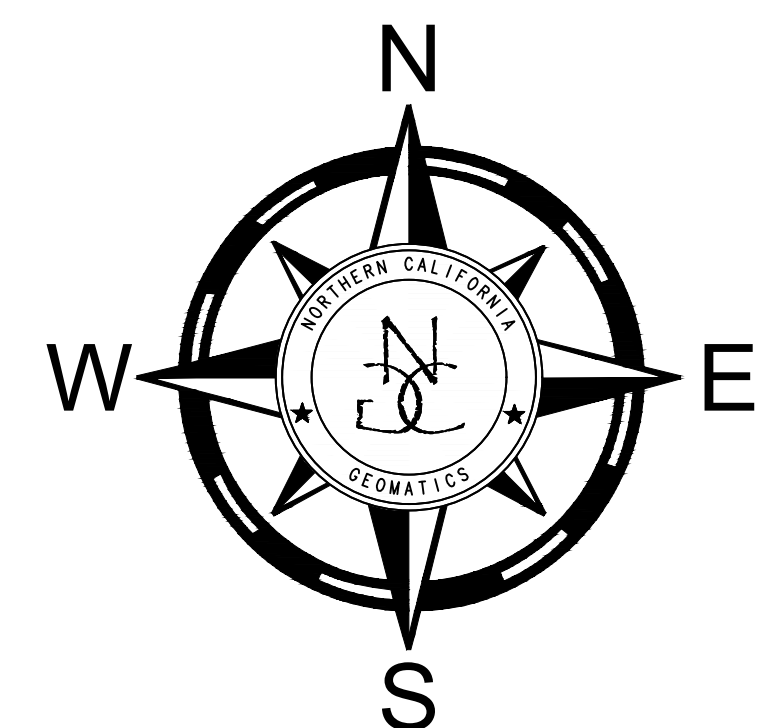

TOPOGRAPHIC SURVEY

PARCEL 2 OF 128 PM 3
APN 016-0161-039-0000

COUNTY of SACRAMENTO, STATE of CALIFORNIA
PREPARED FOR: BOBBY RICH RIVERSIDE BLVD SACRAMENTO, CA 95822
PREPARED BY: NORTHERN CALIFORNIA GEOMATICS 1044 DIAMANTE ROBLES CT. DIAMOND SPRINGS, CA 95619 (530) 957-0293

DRAWN BW	DATE OF FIELD WORK NOV. 12, 2022	REVISIONS NONE
APPROVED BW	DATE NOV. 17, 2022	
SCALE 1"=10'	SHEET SHEET 1 of 1	PROJECT NO. 20221219