

2641 Allan Drive  
Elk Grove Village, IL



22,994 SF

Available For Sublease

DuPage

Real Estate Taxes

September 30, 2025

Sublease Expiration

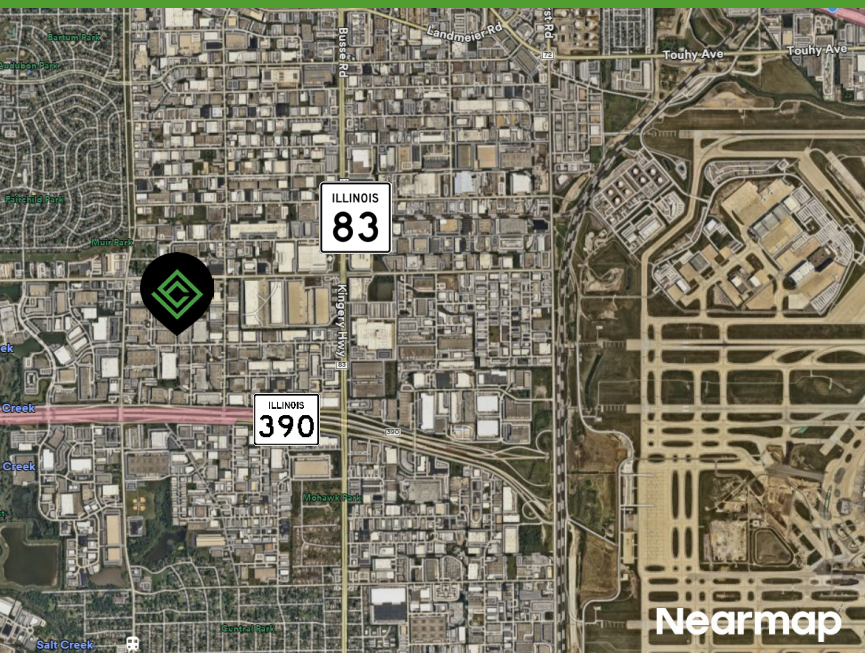

## Features

- 22,994 SF Available for Sublease
- ± 2,000 SF office
- 24' clear height
- 4 exterior loading docks
- 1 drive-in door
- Sprinklered (Wet System)
- Sublease Expiration September 30, 2025
- Lease rate: \$9.35 psf Gross
- Less than 5 miles to O'Hare Int'l Airport



RYAN MULLINS  
Broker  
[rmullins@coreindrealty.com](mailto:rmullins@coreindrealty.com)  
630-339-3127

MATTHEW LEE  
Partner  
[mlee@coreindrealty.com](mailto:mlee@coreindrealty.com)  
630-786-2341

2641 Allan Drive  
Elk Grove Village, IL



# 22,994 SF For Sublease

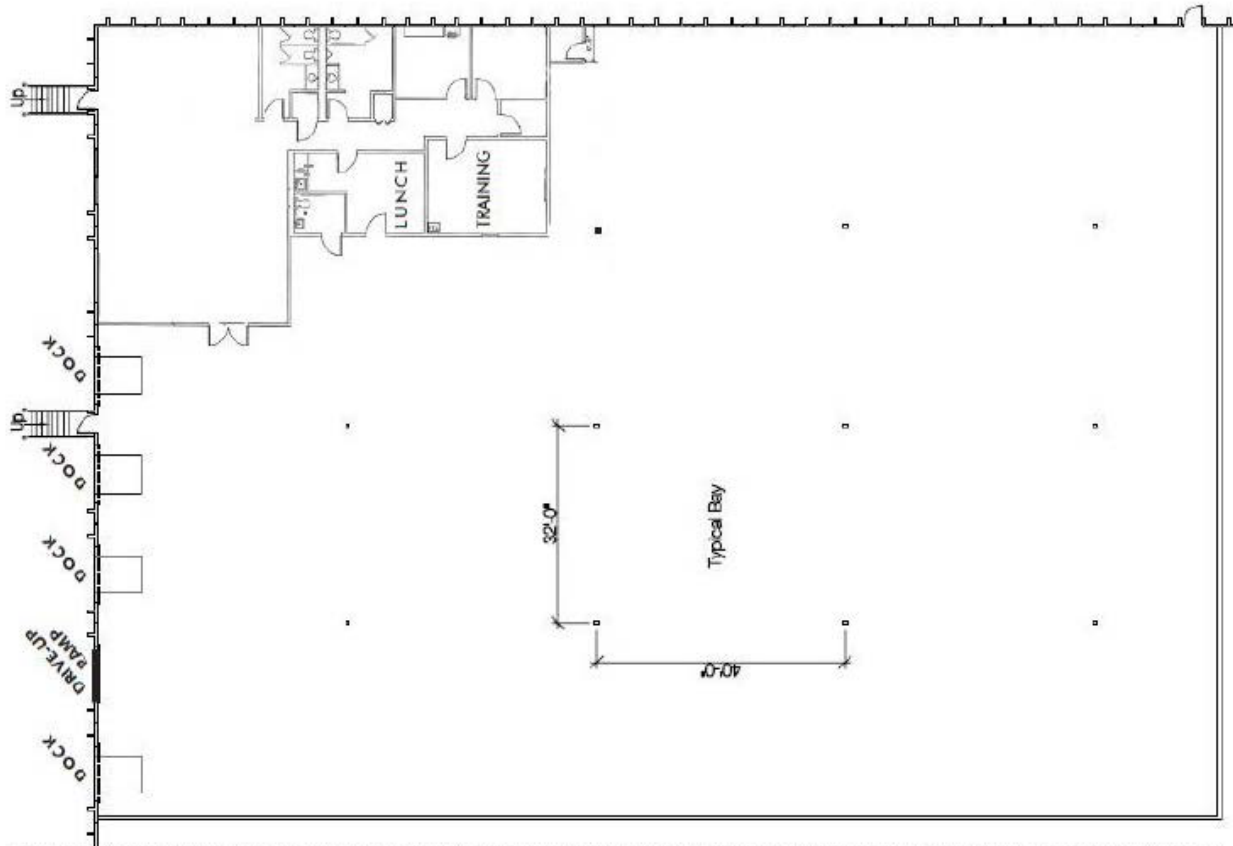

## CORE INDUSTRIAL REALTY

1211 W. 22nd Street, Suite 529  
Oak Brook, IL 60523  
[coreindrealty.com](http://coreindrealty.com) | 630-786-2424

**RYAN MULLINS**  
Broker  
[rmullins@coreindrealty.com](mailto:rmullins@coreindrealty.com)  
630-339-3127

**MATTHEW LEE**  
Partner  
[mlee@coreindrealty.com](mailto:mlee@coreindrealty.com)  
630-786-2341

Submitted subject to error, change in status or withdrawal without notice.