

WESTBROOK PLAZA

668 Dawsonville Highway
Gainesville, GA, 30501

AVAILABLE FOR LEASE

2,437 SF of available space



For Leasing Information:

Anna Crist

anna.crist@bridger-properties.com

Jack Arnold

jack.arnold@bridger-properties.com

404-632-9074



- Gainesville is one of Georgia's premier and high-end suburbs.
- Affluent surrounding population due to the growth of downtown Gainesville and Lake Lanier.
- Located in Gainesville's top retail market -- surrounded by all national retailers.
- 27,009 vehicles per day travel right in front of Westbrook Plaza.
- Unparalleled visibility of Dawsonville Highway.



WESTBROOK PLAZA

SITE PLAN

UNIT	TENANT	SF
670	Best Buy	30,564
662	Burn Boot Camp	6,000
660	Pet Pleasers Bakery	1,600
658 B	Haydee's Cafe	2,820
658 A	WNB Factory	2,600
656	Paris Nails	2,000
654 B	AVAILABLE	2,437
654 A	Tune Up	1,724

WESTBOOK PLAZA

SUITE 654 B LOD

WESTBROOK PLAZA

668 DAWSONVILLE HWY
GAINESVILLE, GA 30501

SUITE 654B

2437 SF

2437 RSF TOTAL

14'-5" DECK HEIGHT
11'-0" CEILING HEIGHT

14'-5" DECK HEIGHT
11'-0" CEILING HEIGHT

OPEN AREA

78'-9" x 30'-4"

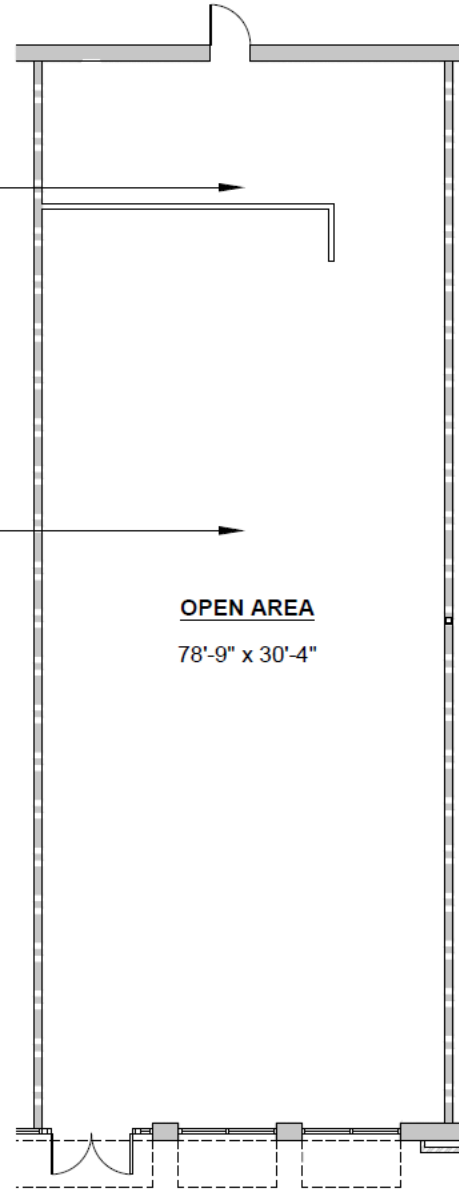
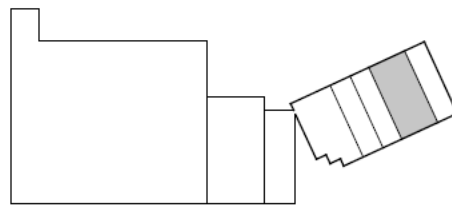

WESTBROOK PLAZA

TRADE AREA OVERVIEW



Population 2020

1 Mile	6,598
3 Mile	48,106
5 Mile	80,926



Households 2020

1 Mile	2,249
3 Mile	15,267
5 Mile	26,768



Household Income 2020

1 Mile	\$66,284
3 Mile	\$73,393
5 Mile	\$80,717



WESTBROOK PLAZA

PROPERTY PHOTOS

