

**AVISON
YOUNG**

*Site Improvements
Underway*

Available Immediately



**±6.79 AC Site with
±15,008 - 35,684 SF Industrial Space**

280 Furniture Dr, Salisbury, NC 28147

Building specifications

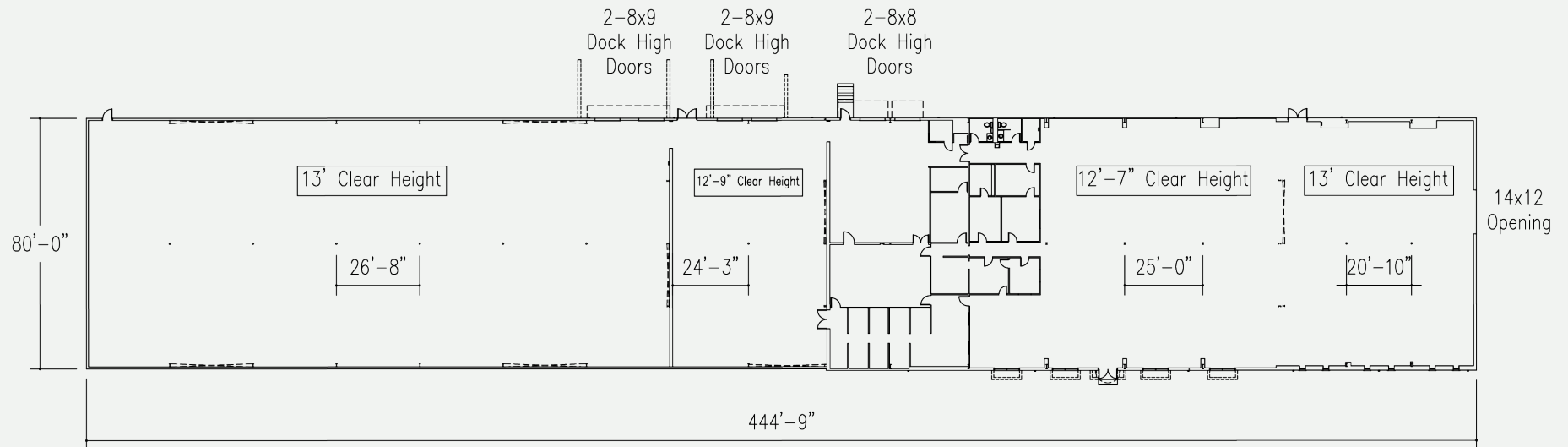

PROPERTY DETAILS

ADDRESS	280 Furniture Dr Salisbury, NC 28147
AVAILABLE SF	±15,008 - 35,684 SF
OFFICE SF	±3,601 SF
ACREAGE	±6.79 AC
YEAR BUILT	1978; Renovated 2024
CLEAR HEIGHT	12'-7" at the eave 13' center
LOADING	Six (6) dock high doors One (1) drive-in
AUTO PARKING	19 spaces
AVAILABILITY	Immediately



Property overview



Property Improvements Underway



Interior demolition to expand warehouse footprint



Demolition of existing ACT ceiling



Clearing, grubbing and grading to accommodate additional Industrial Outdoor Storage ("IOS") area



New grade level roll up door



Area overview

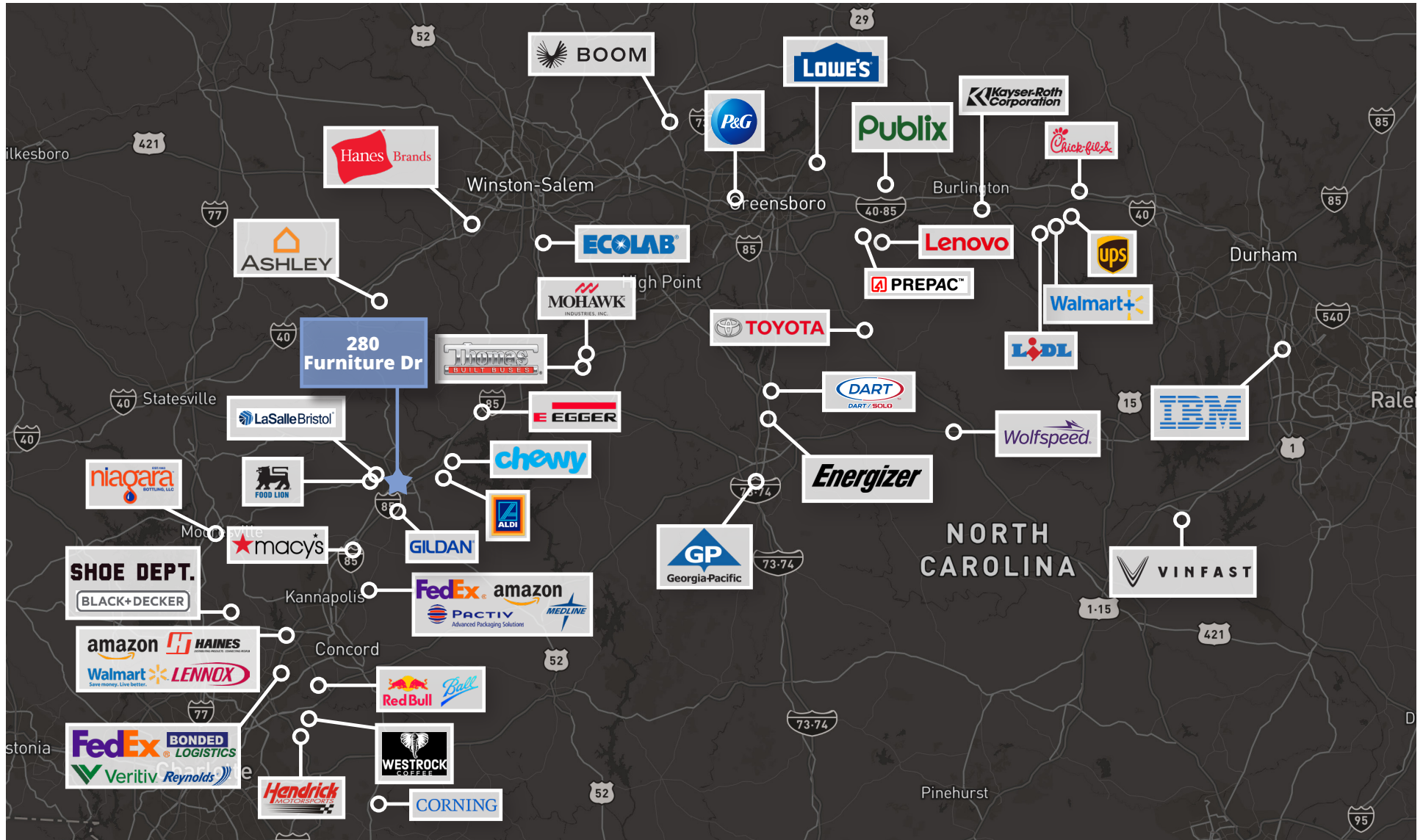

Gray Gaines
Vice President
704.413.0230
gray.gaines@avisonyoung.com

Abby Rights
Vice President
704.413.0235
abby.rights@avisonyoung.com

**AVISON
YOUNG**