

CURVE	RADIUS	ARC LENGTH	DELTA ANGLE	CHORD BEARING	CHORD LENGTH
C1	25.00'	39.34'	90°10'16"	N 40°00'15" E	35.41'
(C1)	(25.00')	(39.34')	(90°10'16")	(N 40°00'15" E)	(35.41')
C2	363.60'	125.10'	19°42'45"	N 75°09'29" E	124.48'
(C2)	(363.60')	(125.10')	(19°42'45")	(N 75°09'29" E)	(124.48')
C3	300.00'	103.56'	19°44'46"	N 75°12'02" E	103.00'
(C3)	(300.00')	(103.57')	(19°44'46")	(N 75°12'02" E)	(103.00')

LINE	BEARING	DISTANCE
L1	N 85°16'00" E	41.23'
(L1)	(N 85°16'00" E)	(41.23')
L2	N 24°41'17" W	55.60'
(L2)	(N 24°41'05" W)	(55.60')

**LEGEND**

- be found in the drawing.  
These standard symbols will
- SSR ○ SET 5/8" STEEL REBAR WITH 'USI' CAP
  - FSR ● FOUND 5/8" STEEL REBAR
  - PP ○ POWER POLE
  - PLM ↓ PIPELINE MARKER
  - LP ○ LIGHT POLE
  - GI ■ GRATE INLET
  - SOL ● SOLLARD
  - CO ○ SEWER CLEANOUT
  - GM ⊗ GAS METER
  - CPED ⊠ CABLE PEDESTAL
  - TPED ⊙ TELEPHONE PEDESTAL
  - SDMH ⊕ STORM DRAIN MANHOLE
  - WM ⊕ WATER METER
  - SIGN ⊕ SIGN
  - ET ⊕ ELECTRIC TRANSFORMER
  - FP ⊕ FLAG POLE
  - ○ ○ ○ ○ CHAIN LINK FENCE
  - — — — — OVERHEAD LINES
  - — — — — EXISTING SANITARY SEWER
  - — — — — EXISTING WATER MAIN
  - — — — — EASEMENT STORM DRAIN LINE
  - — — — — EASEMENT LINE
  - — — — — BUILDING SETBACK LINE
  - — — — — EXISTING PIPELINE
  - — — — — EXISTING RAILROAD TRACKS
  - — — — — RECORD BEARING & DISTANCE

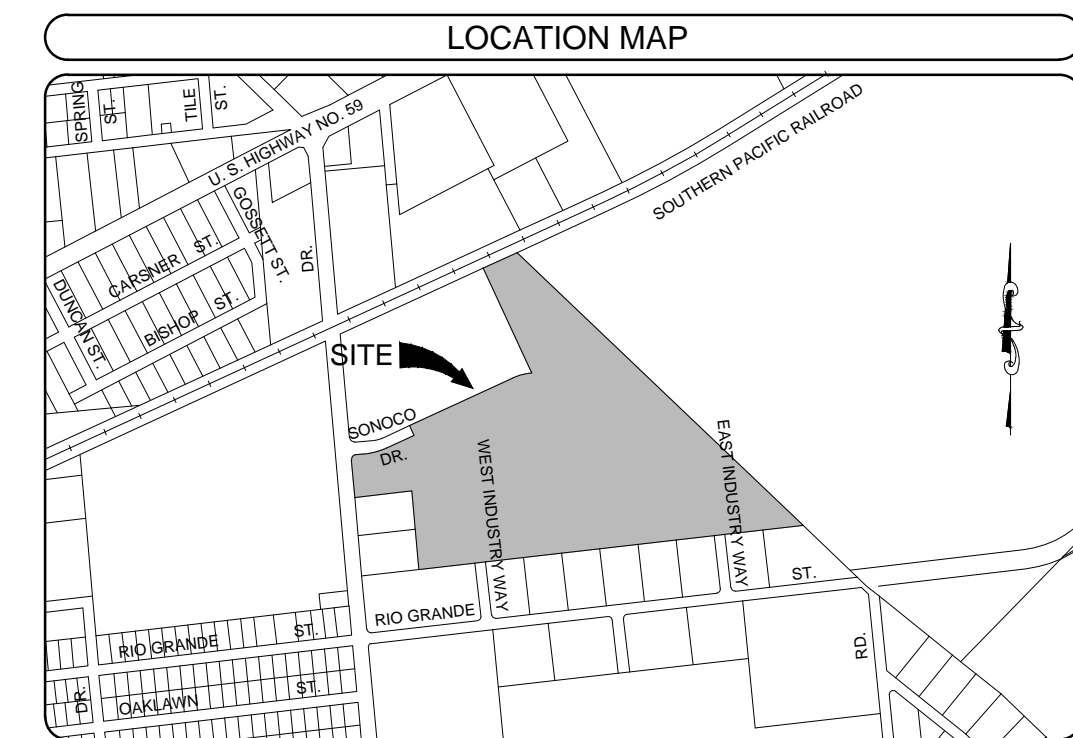

NOTE:  
BASIS OF BEARING IS BASED ON THE TEXAS STATE PLANE COORDINATE SYSTEM (NAD 83), SOUTH CENTRAL ZONE (4204). THIS SURVEY WAS ADJUSTED USING A COMBINED SCALE FACTOR OF 1.00009484592090 (GEOID12B).

- Note:  
The referenced tract is subject to:
- Record Title Search Performed and Provided by Stewart Title Guaranty Company, File No. 1814832.
  - Subject to Restrictive Covenants and/or Easements Recorded in:  
Volume 108, Page 537, Deed Records, Victoria County, Texas. (Does not Affect)  
Volume 179, Page 635, Deed Records, Victoria County, Texas. (Shown Hereon)  
Volume 353, Page 7, Deed Records, Victoria County, Texas. (Does not Affect)  
Volume 597, Page 291, Deed Records, Victoria County, Texas. (Shown Hereon)  
Volume 637, Page 1, Deed Records, Victoria County, Texas. (Shown Hereon)  
Volume 1435, Page 461, Deed Records, Victoria County, Texas. (Shown Hereon)  
Volume 1476, Page 559, Deed Records, Victoria County, Texas. (Shown Hereon)

TO THE LIENHOLDERS AND/OR THE OWNERS OF THE PREMISES SURVEYED AND TO THE TITLE COMPANY:  
THE UNDERSIGNED DOES HEREBY CERTIFY THAT THIS SURVEY WAS MADE ON THE GROUND OF THE PROPERTY LEGALLY DESCRIBED HEREON ON 08/30/2022, AND IS CORRECT, AND THAT THERE ARE NO DISCREPANCIES, CONFLICTS, SHORTAGES IN AREA, BOUNDARY LINE CONFLICTS, ENCROACHMENTS, OVERLAPPING OF IMPROVEMENTS, EASEMENTS OR RIGHTS OF WAY, EXCEPT AS SHOWN HEREON, AND THAT SAID PROPERTY HAS ACCESS TO AND FROM A DEDICATED ROADWAY.

ACCORDING TO THE FLOOD INSURANCE RATE MAP (FIRM) FOR THE CITY OF VICTORIA, VICTORIA COUNTY, TEXAS, COMMUNITY PANEL NUMBER 480638 0010E, MAP REVISED JUN. 1, 2012, THE SUBJECT PROPERTY IS PARTIALLY LOCATED IN ZONE X WHICH IS NOT A SPECIAL FLOOD HAZARD AREA, AND PARTIALLY LOCATED IN ZONE AE WHICH IS A SPECIAL FLOOD HAZARD AREA. BASE FLOOD ELEVATION DETERMINED.

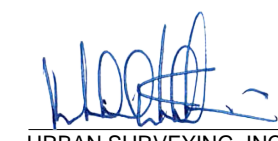
SIGNED:  09/13/2022  
URBAN SURVEYING, INC.  
BY: MICHAEL K. WILLIAMS  
REGISTERED PROFESSIONAL LAND SURVEYOR  
TEXAS No. 6616



VICTORIA, TEXAS 77901  
2004 N. COMMERCE ST.  
PHONE: (361) 576-9837  
FIRM # 10271100

CUERO, TEXAS 79054  
104 E. FRENCH ST.  
PHONE: (361) 277-9061 FAX: (361) 277-9063  
FIRM # 10021101

12661 SILICON DRIVE  
SAN ANTONIO, TEXAS 78248  
PHONE: (210) 287-8884 FAX: (210) 287-8704  
FIRM # 10138493



Land Surveying + Aerial Imaging  
since 1971

**LAND TITLE SURVEY**

PROJECT:   
DESCRIPTION:   
DGN BY: EBD  
DATE: 08/30/22  
FILE: S25408.00  
JOB: S25408.00  
SHEET 1 OF 1