

# FOR LEASE

**39,869 SF**  
AVAILABLE NOW

**4820 NORTH CHURCH LANE SE**

ATLANTA, GEORGIA 30339

# 4820 NORTH CHURCH LANE SE

ATLANTA, GEORGIA 30339

**SUITE B | 39,869 TOTAL SF**

39,869 TOTAL SF

## SUITE INFORMATION

<b>Total Size:</b>	39,869 SF
<b>Office:</b>	2,000 SF
<b>Warehouse:</b>	37,869 SF
<b>Loading:</b>	Nine (9) Dock High Doors One (1) Drive-In Door
<b>Clear Height:</b>	24'
<b>Power:</b>	2000 Amps, 208y/120v 3-Phase
<b>Available:</b>	Immediately

**FULL BUILDING (104,391 SF)  
ALSO AVAILABLE FOR LEASE**

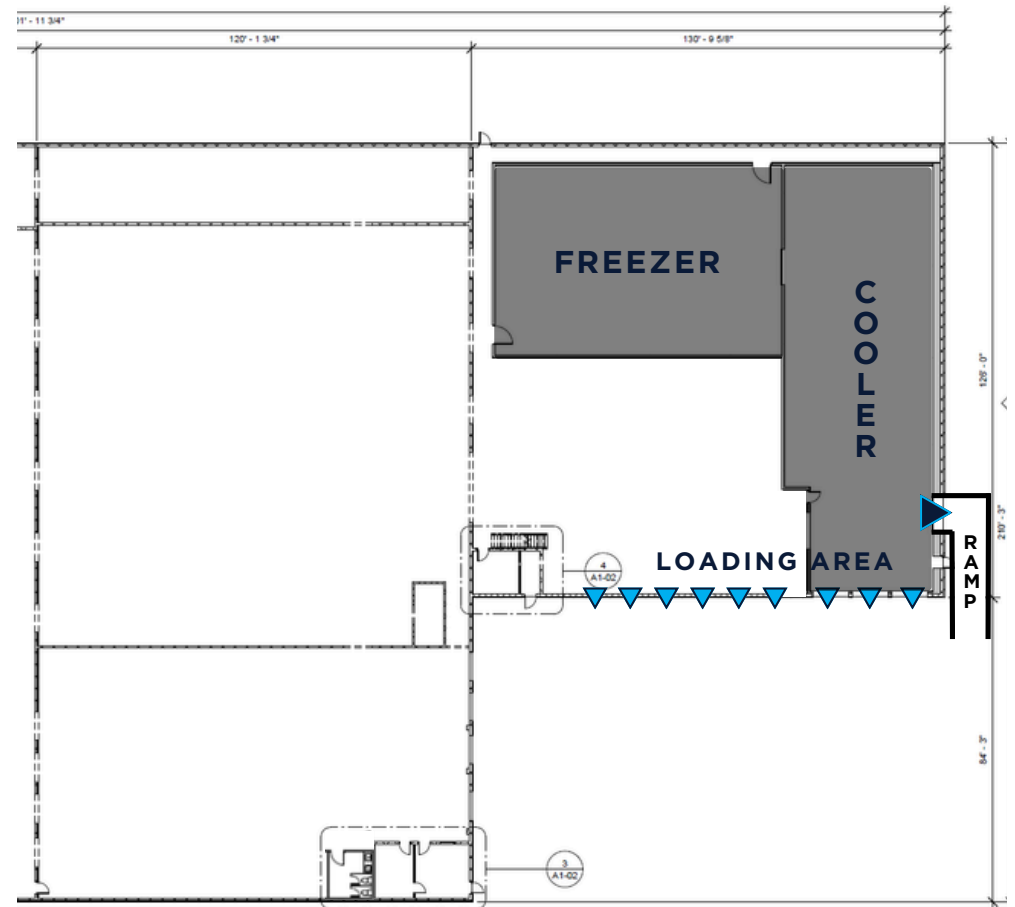
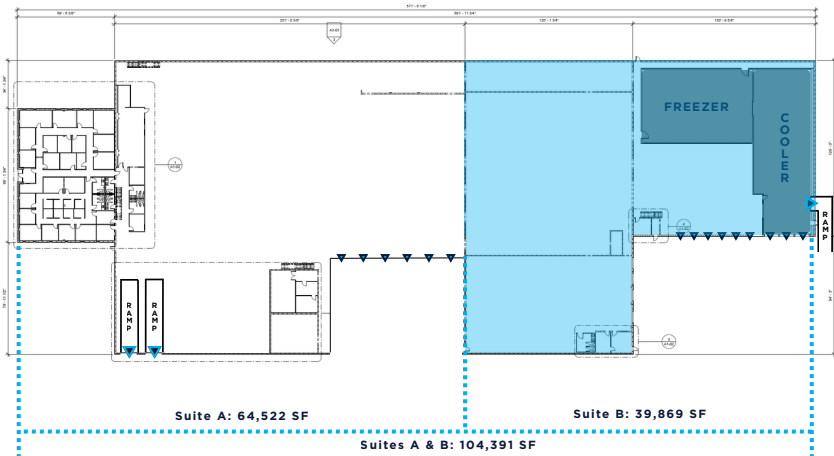

▼ DOCK HIGH DOOR ▼ DRIVE-IN DOOR

# TRUCK COURT



# ADDITIONAL PHOTOS



# ADDITIONAL PHOTOS

## OFFICE



## OVERSIZED BREAKROOM



# PREMIER LOCATION

## I-285:

Situated less than a mile away, this premier highway encircles the Atlanta metropolitan area, connecting to all other major interstates serving the city.

## I-75:

4 miles from the property, offering access to Chattanooga, Tennessee, to the north and Macon, Georgia, and Florida to the south.

## I-20:

Located 7.5 miles away, providing connections to Birmingham, Alabama, to the west and Augusta, Georgia, and Columbia, South Carolina, to the east.

## I-85:

Located just 8 miles from the property, northbound on I-85 connects you to Greenville, South Carolina, Charlotte, North Carolina and beyond, while southbound leads to Atlanta and points south, including Montgomery, Alabama and ultimately, Mobile, Alabama.

## Hartsfield-Jackson Atlanta International Airport:

Situated 20 miles away, providing convenient access to domestic and international destinations worldwide.

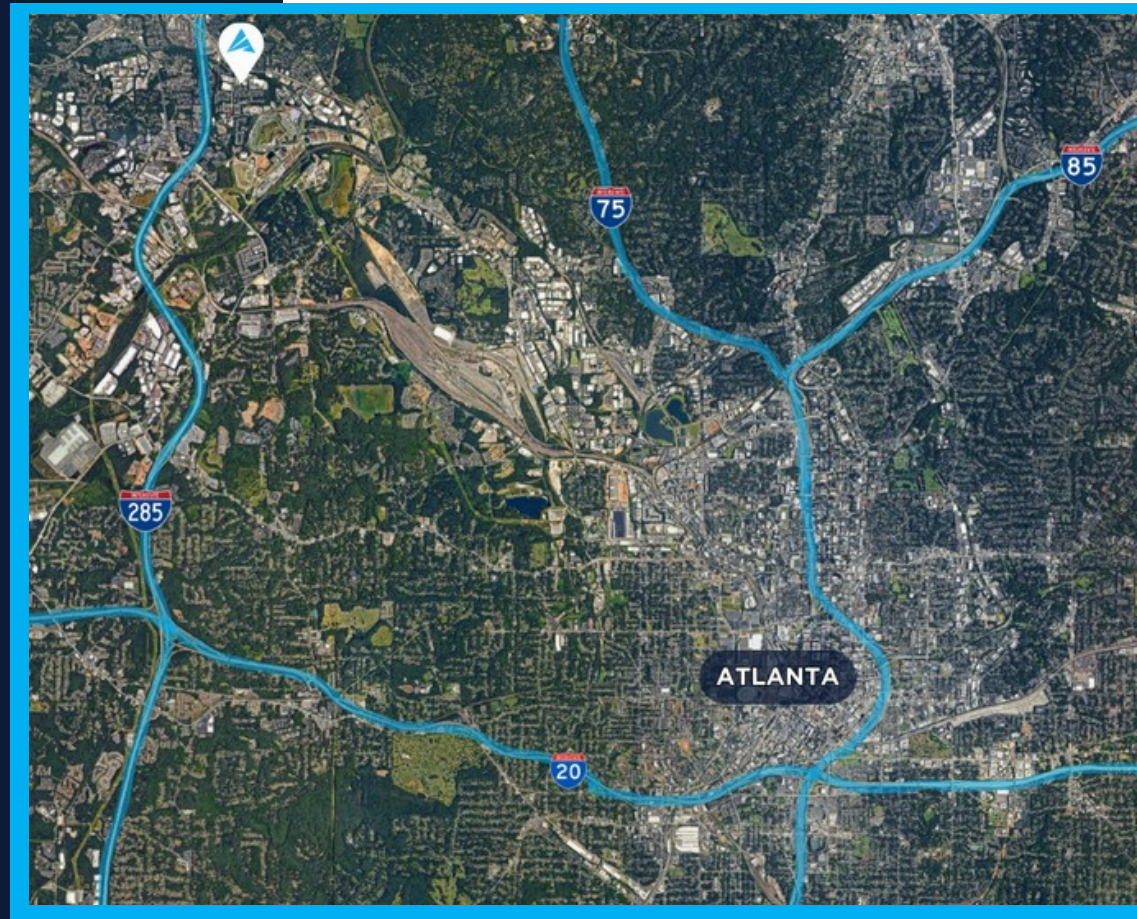



## 4820 NORTH CHURCH LANE SE

ATLANTA, GA 30339

### PROPERTY HIGHLIGHTS

<b>Total Size:</b>	104,391 SF
<b>Total Office:</b>	8,500 SF
<b>Total Warehouse:</b>	95,891 SF
<b>Loading:</b>	Fifteen (15) Dock High Doors Three (3) Drive-In Ramps
<b>Clear Height:</b>	24'
<b>Available:</b>	Immediately
<b>Location:</b>	+/- 0.8 miles from I-285 +/- 4 miles from I-75 +/- 7.5 miles from I-20 +/- 8 miles from I-85 +/- 20 miles from Atlanta Airport



# CONTACT INFORMATION



**ANDY HEAD**

**Office:** (404) 595 - 1466

**Cell:** (404) 713 - 4601

**ahead@apexindustrialre.com**

