

LAKES MERCHANDISE MART

3849-3999 NW 19TH STREET
LAUDERDALE LAKES, FL

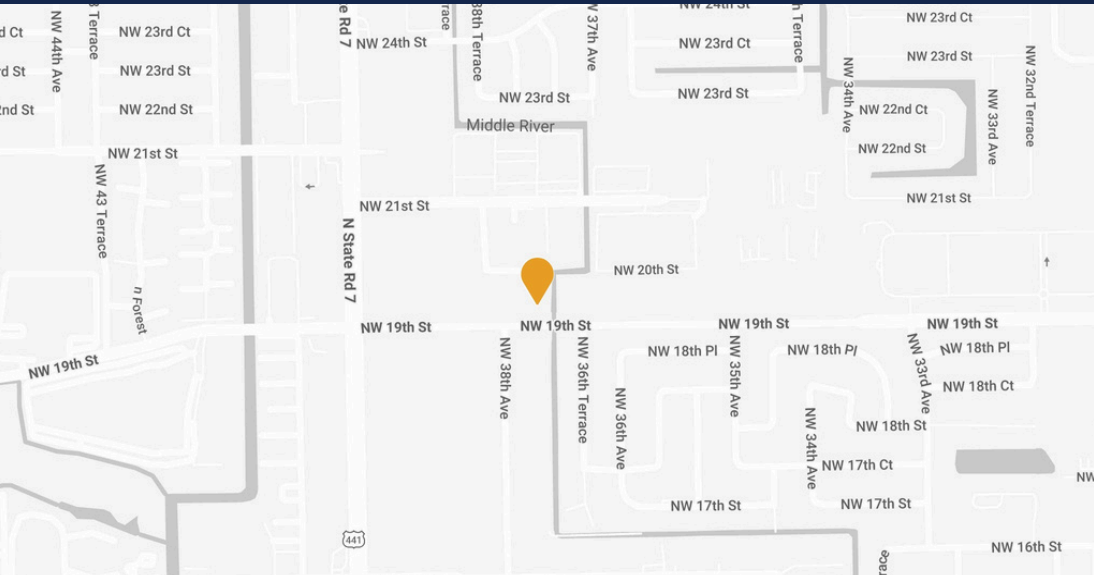

FLEXIBLE WAREHOUSE AND INDUSTRIAL SPACE AVAILABLE



PROPERTY HIGHLIGHTS

- Variety of Spaces Available: Flex Space, Industrial Warehouse
- Abundant Free Parking
- 20' Clear Height
- Ground-level access with overhead doors for convenient loading

ABOUT PROPERTY



Property Type:
Industrial / Flex



Renovated: 2024



Total SF: 164,954 sf



Rent: \$19.00-\$21.00 psf
FSG



Zoning: B-4, allowing for showrooms, retail, storage, and light industrial use

HB | CAPITAL

Jacky Enderica
954-335-3615
LMM@hbcapital.com

3849-3999 NW 19TH STREET
LAUDERDALE LAKES

HB | CAPITAL



SAMPLE
SINGLE BAY
2,136 sf

SAMPLE
DOUBLE BAY
4,272 sf

LAKES MERCHANDISE MART

JACKY ENDERICA | 954-335-3615 | LMM@HBCAPITAL.COM

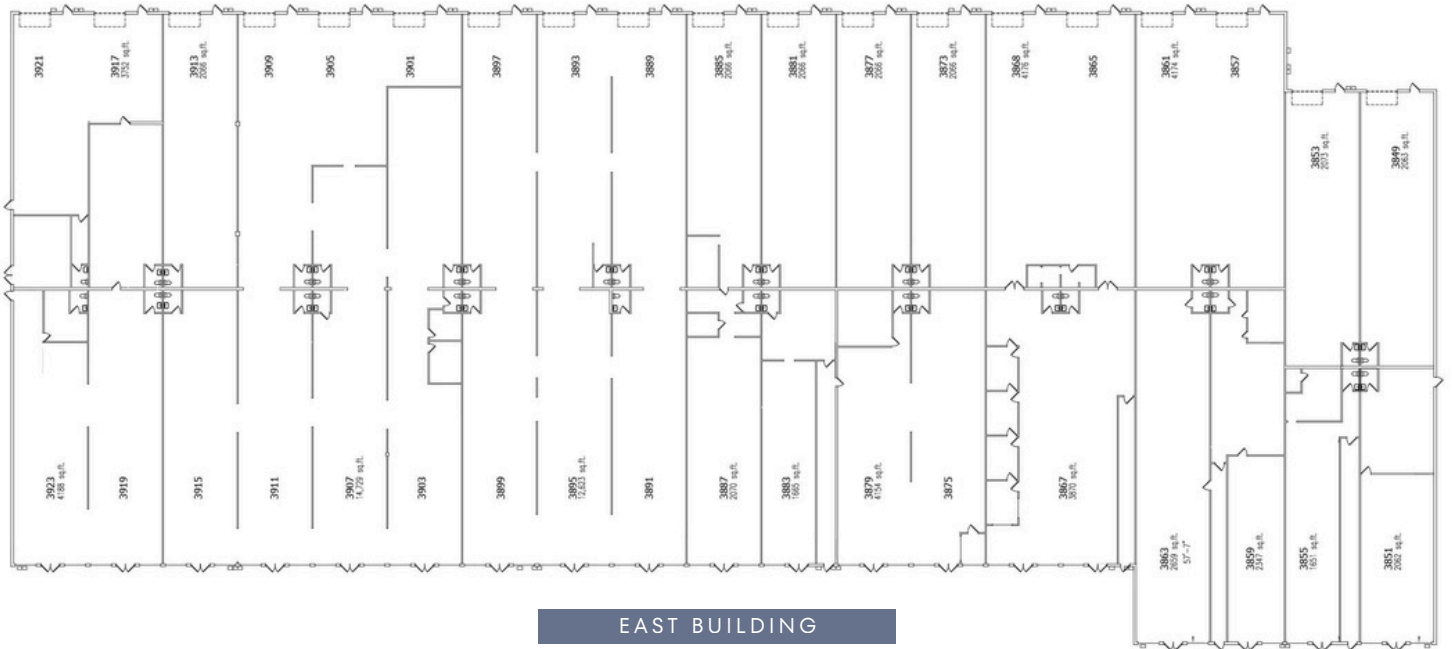
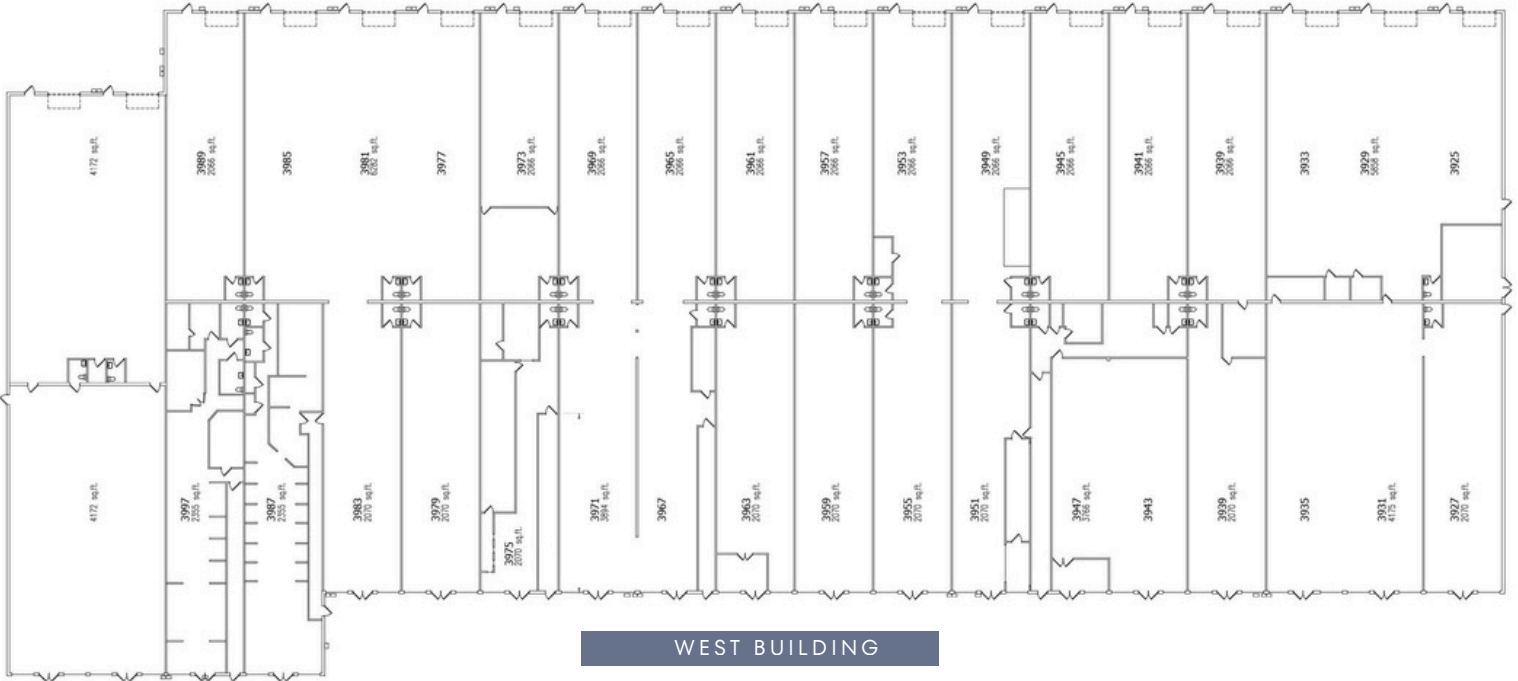

Available
2,120 sf – 15,000 sf

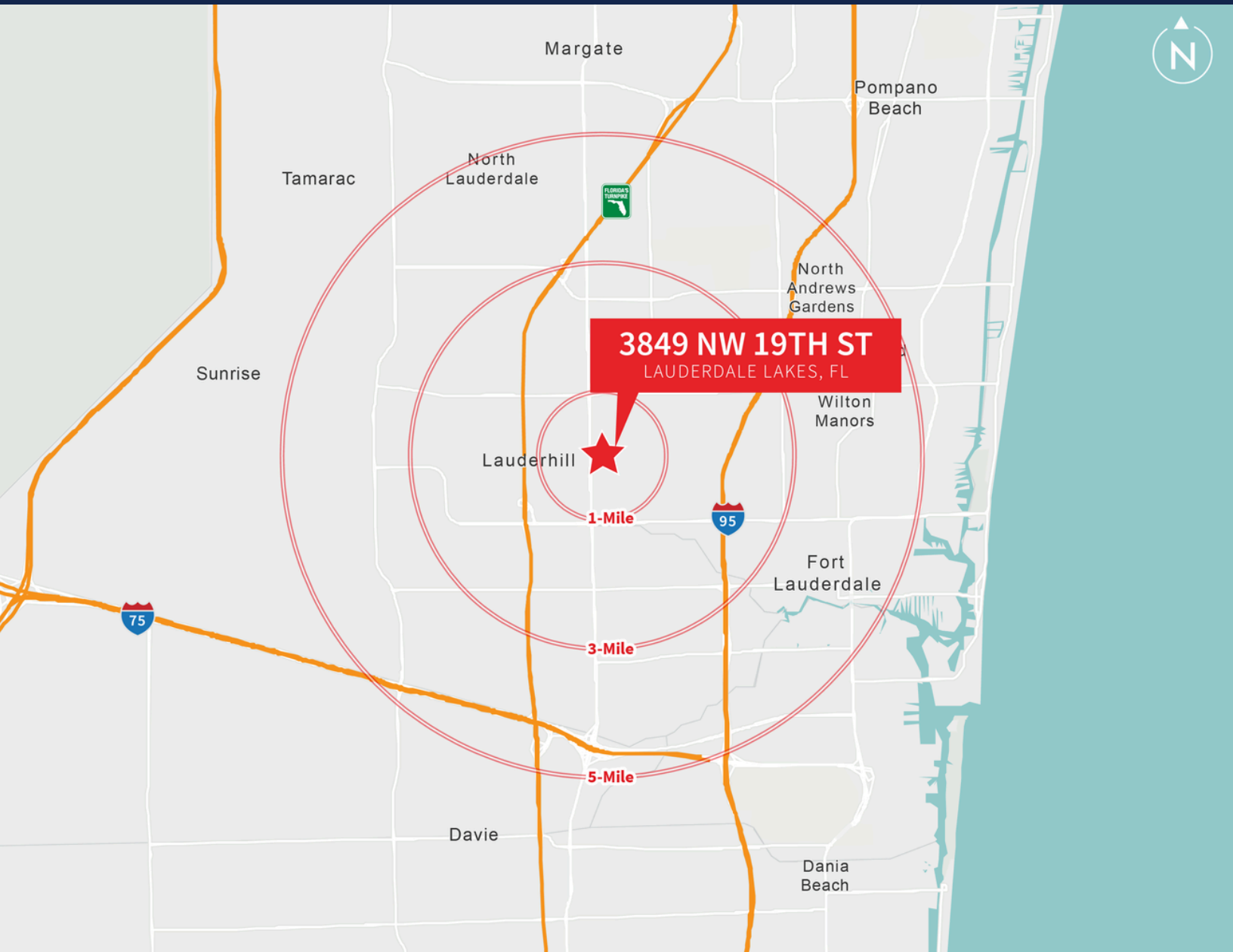

POPULATION & HOUSEHOLDS

1 MILE

3 MILES

5 MILES

Total Population	31,566	198,443	500,806
Avg # of Households	12,130	72,989	203,934
Daytime Employment	8,523	72,987	295,717

LAKES MERCHANDISE MART



3849-3999

NW 19TH STREET
LAUDERDALE LAKES, FL

CONTACT

Jacky Enderica
954-335-3615
LMM@hbcapital.com

HB | CAPITAL

HB Capital Group
16701 Collins Avenue
Sunny Isles Beach, FL 33160

www.hbcapital.com