

VECTOR PARK

Office/Warehouse Space For Lease

1461 London Bridge Road
Virginia Beach/Oceana area

Each unit is approximately 900 sf that can be combined to create the perfect location for your growing business. Combine two units to create a **PASS THROUGH UNIT**.

EACH UNIT

SIZE	30' X 30' = 900 SF approximately
OVERHEAD DOOR	1 - 12' X 12'
PERSONAL ENTRANCE	YES - 1 PER UNIT
PARKING SPOTS	3 PER UNIT
EXPANDABLE	YES - COMBINE UNITS TO CREATE LARGER SPACES

PROPERTY

ZONING	I-1 LIGHT INDUSTRIAL
OFFICE	OPTIONAL
INTERIOR HEIGHT	14'
ELECTRICAL	110 - SINGLE PHASE 220 CAN BE INSTALLED
PRIVATE BATHROOM	YES
ACCESS	24 HOUR
WATER AND SEWER	PAID

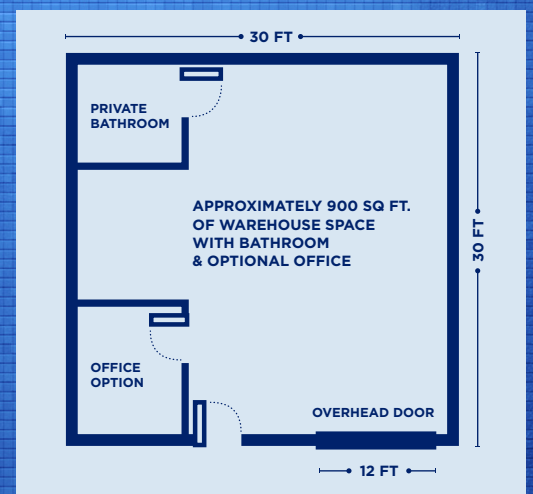

CALL TODAY! 757-498-9713

The Miller Group deals in a large variety of Warehouse and Flex Spaces (Warehouse/Office space) in the Lynnhaven area and throughout Hampton Roads. If this property doesn't meet your needs, call us for more information about additional properties.

The Miller
Group

www.millergroupva.com