



THALHIMER

RETAIL FOR LEASE

The Shops at Stratford Hills

7045 Forest Hill Avenue | Richmond, Virginia

1,000 – 7,360 SF AVAILABLE IMMEDIATELY



Join Publix – Now Open | Drive-thru Opportunity Available

For more information, contact:

JIM ASHBY

Senior Vice President

804 697 3455

jim.ashby@thalhimer.com

REILLY MARCHANT

Senior Associate

804 697 3478

reilly.marchant@thalhimer.com

Thalhimer Center
11100 W. Broad Street
Glen Allen, VA 23060
www.thalhimer.com

Independently Owned and Operated / A Member of the Cushman & Wakefield Alliance

Cushman & Wakefield | Thalhimer © 2015. No warranty or representation, express or implied, is made to the accuracy or completeness of the information contained herein, and same is submitted subject to errors, omissions, change of price, rental or other conditions, withdrawal without notice, and to any special listing conditions imposed by the property owner(s). As applicable, we make no representation as to the condition of the property (or properties) in question.

Property Features

- **JOIN PUBLIX - NOW OPEN**
- 1,000 – 7,360 SF AVAILABLE IMMEDIATELY
- OUTPARCELS AVAILABLE ON FOREST HILL
- 3,800 SF fronting Forest Hill Avenue available
- 2,400 SF restaurant space available
- Pylon signage
- Join our newest tenants, Tuesday Morning, Domino's and America's Best Wings

Traffic Counts

Forest Hill Avenue	28,000 VPD
Chippenham Parkway	53,000 VPD

Join Tenants/Nearby Retailers



For more information, contact:

JIM ASHBY
Senior Vice President
804 697 3455
jim.ashby@thalhimer.com

REILLY MARCHANT
Senior Associate
804 697 3478
reilly.marchant@thalhimer.com

Thalhimer Center
11100 W. Broad Street
Glen Allen, VA 23060
www.thalhimer.com

RETAIL FOR LEASE

The Shops at Stratford Hills

7045 Forest Hill Avenue | Richmond, Virginia

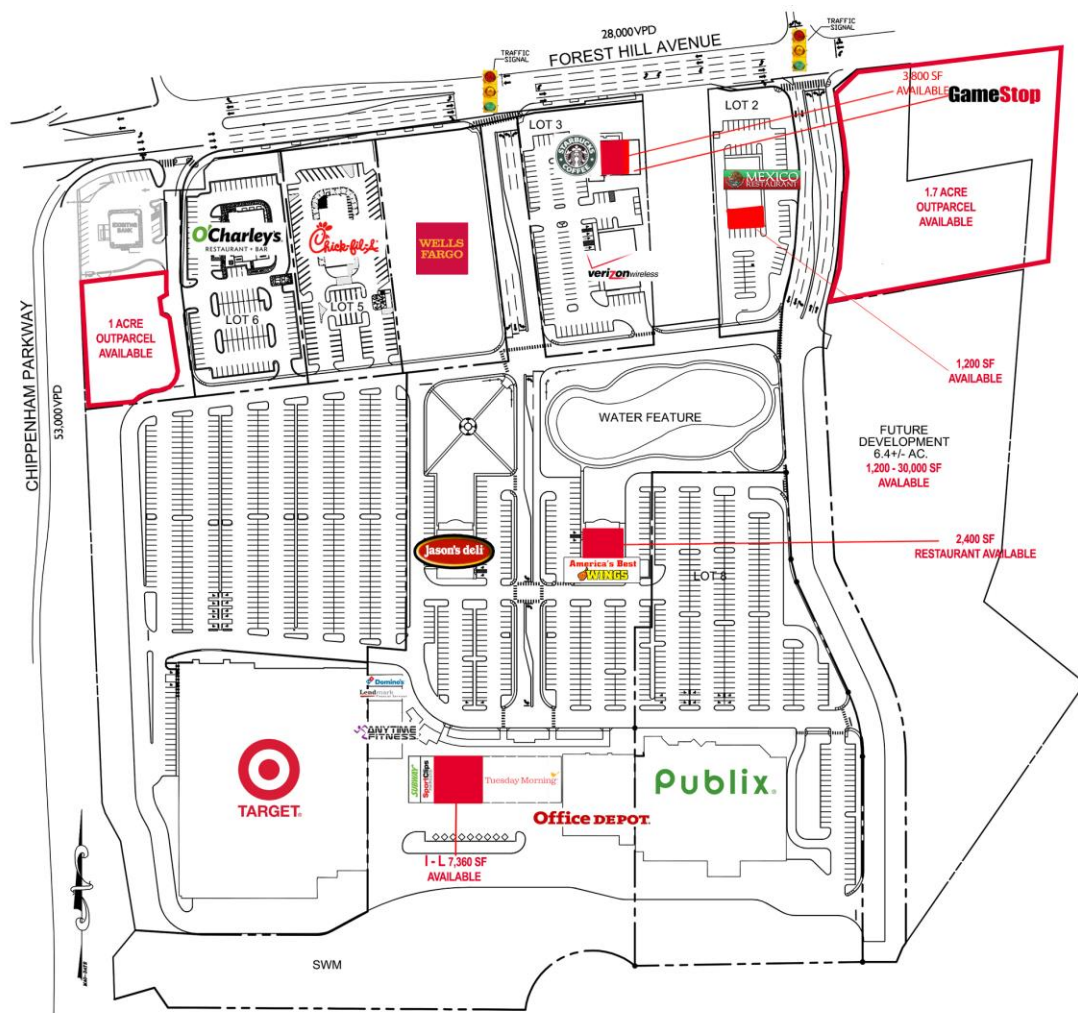

Demographics

	1 Mile	3 Miles	5 Miles
Population	5,937	66,415	223,341
Avg. HH Income	\$86,861	\$95,020	\$82,957
Daytime Population	6,437	69,132	303,181

For more information, contact:

JIM ASHBY
Senior Vice President
804 697 3455
jim.ashby@thalhimer.com

REILLY MARCHANT
Senior Associate
804 697 3478
reilly.marchant@thalhimer.com

Thalhimer Center
11100 W. Broad Street
Glen Allen, VA 23060
www.thalhimer.com

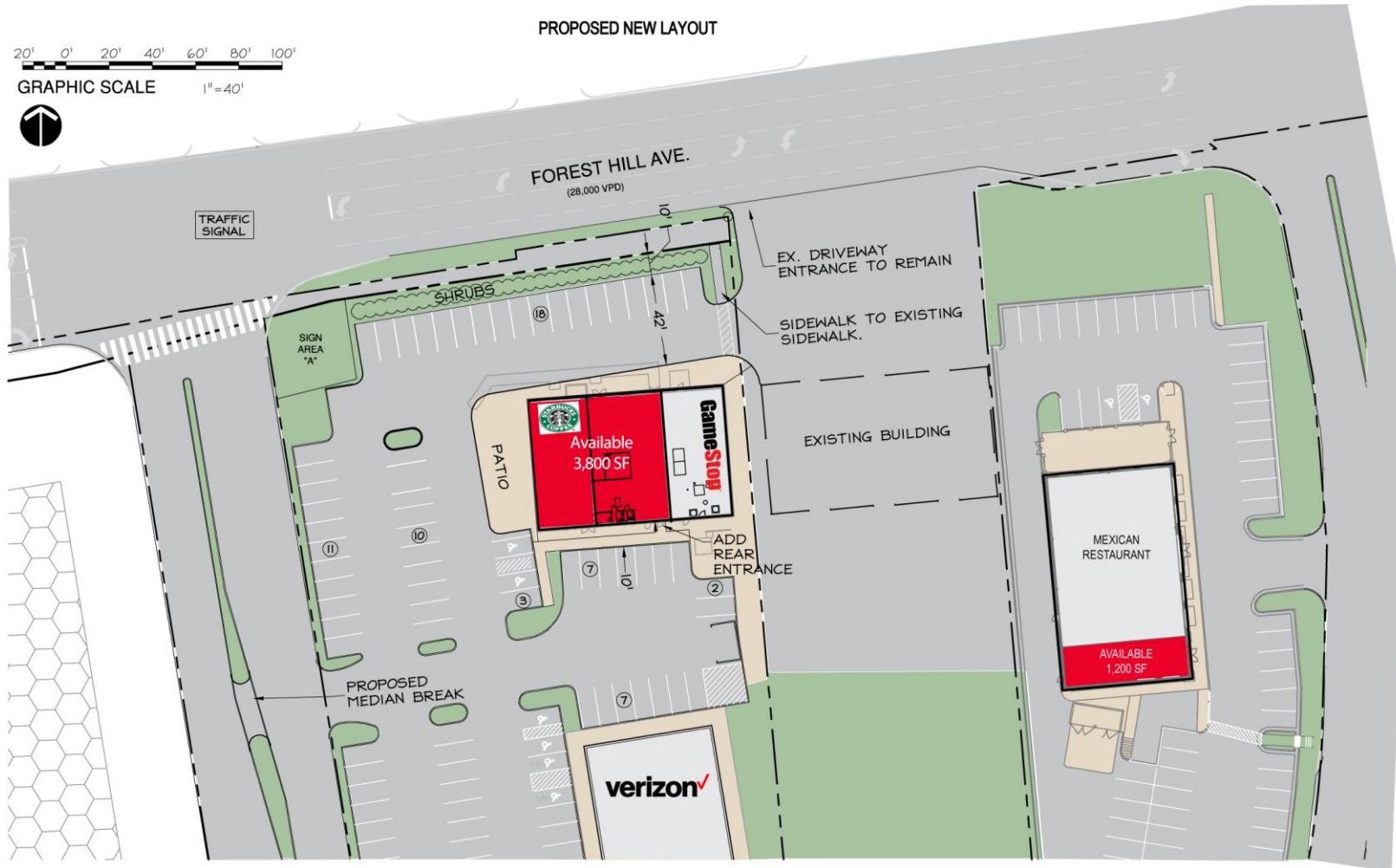

For more information, contact:

JIM ASHBY
Senior Vice President
804 697 3455
jim.ashby@thalhimer.com

REILLY MARCHANT
Senior Associate
804 697 3478
reilly.marchant@thalhimer.com

Thalhimer Center
11100 W. Broad Street
Glen Allen, VA 23060
www.thalhimer.com

RETAIL FOR LEASE
The Shops at Stratford Hills
 7045 Forest Hill Avenue | Richmond, Virginia

DriveThru Concept

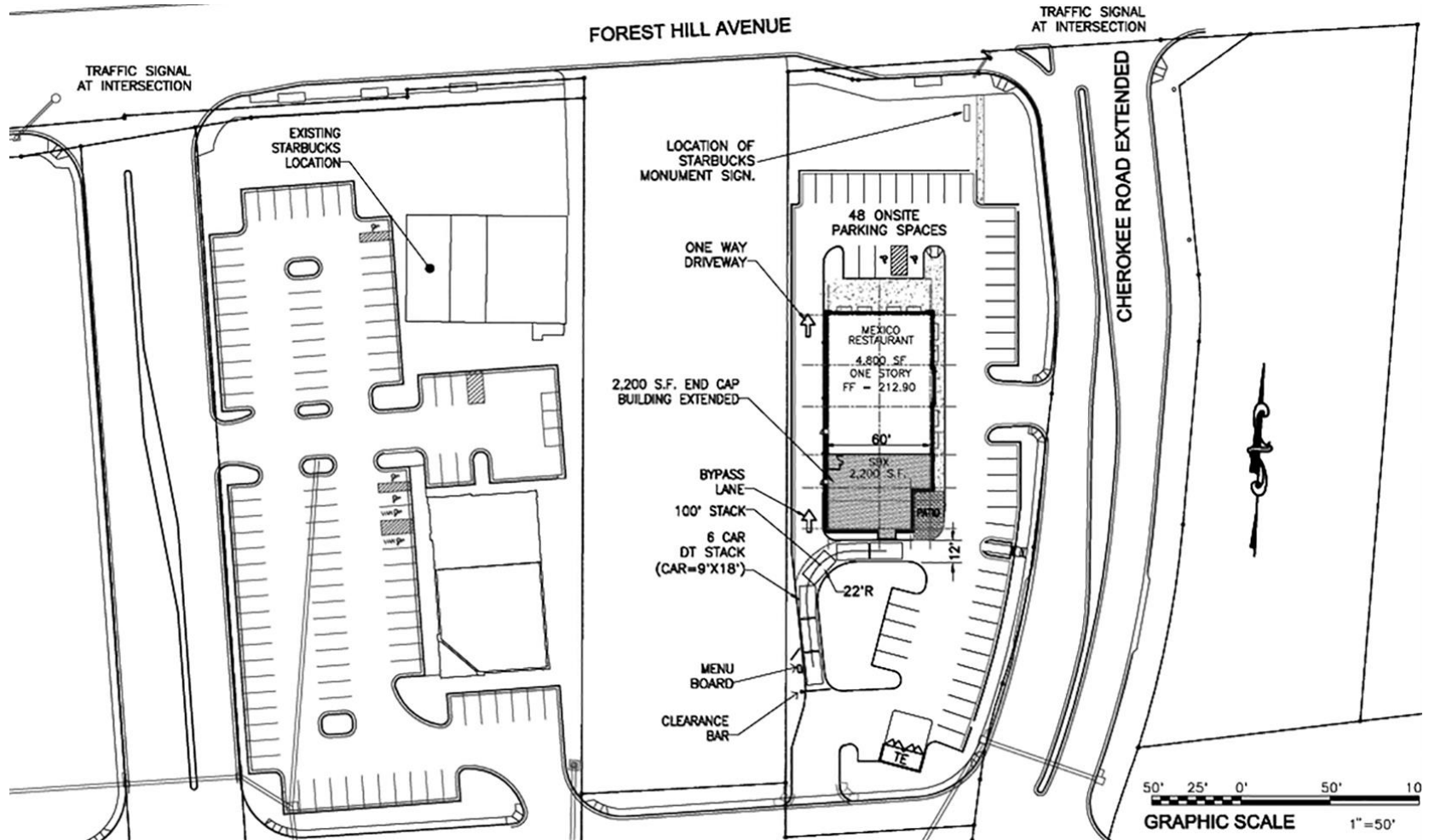

For more information, contact:

JIM ASHBY
 Senior Vice President
 804 697 3455
jim.ashby@thalhimer.com

REILLY MARCHANT
 Senior Associate
 804 697 3478
reilly.marchant@thalhimer.com

Thalhimer Center
 11100 W. Broad Street
 Glen Allen, VA 23060
www.thalhimer.com



For more information, contact:

JIM ASHBY
Senior Vice President
804 697 3455
jim.ashby@thalhimer.com

REILLY MARCHANT
Senior Associate
804 697 3478
reilly.marchant@thalhimer.com

Thalhimer Center
11100 W. Broad Street
Glen Allen, VA 23060
www.thalhimer.com



THALHIMER

RETAIL FOR LEASE

The Shops at Stratford Hills

7045 Forest Hill Avenue | Richmond, Virginia

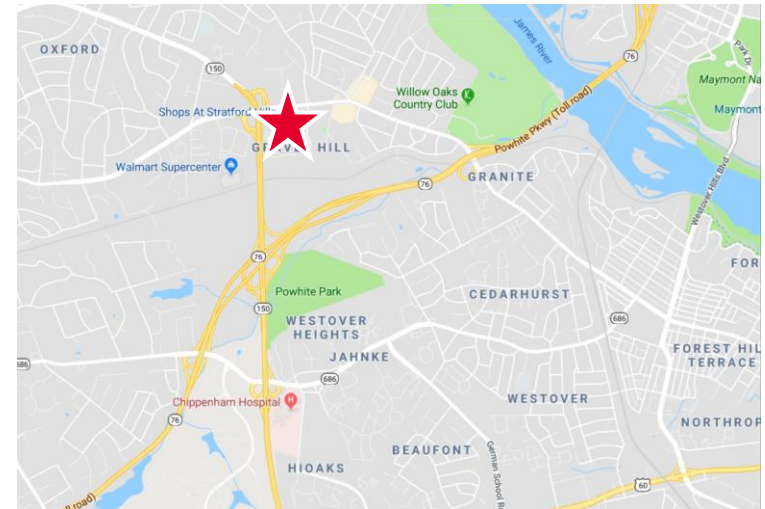
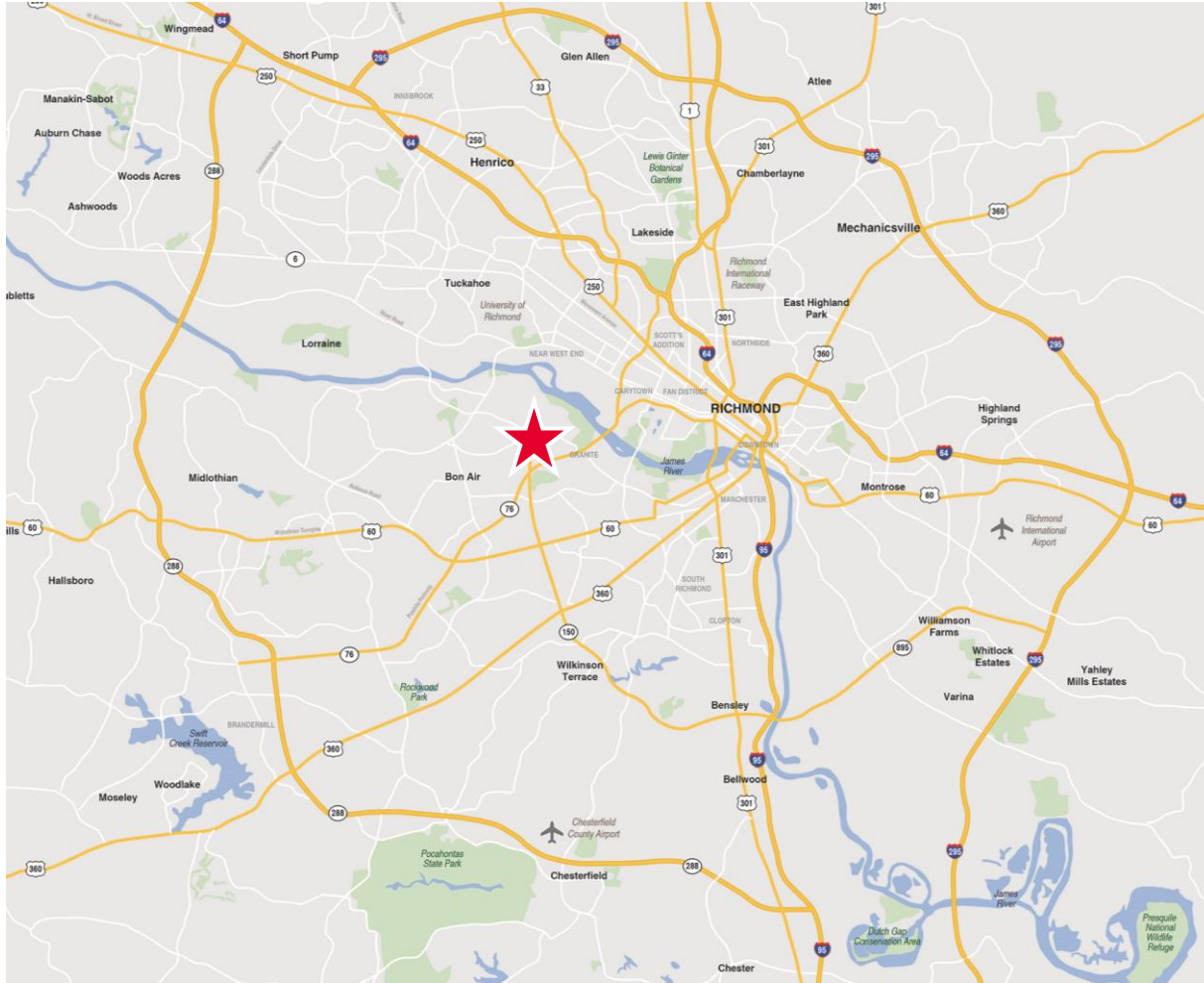

For more information, contact:

JIM ASHBY
Senior Vice President
804 697 3455
jim.ashby@thalhimer.com

REILLY MARCHANT
Senior Associate
804 697 3478
reilly.marchant@thalhimer.com

Thalhimer Center
11100 W. Broad Street
Glen Allen, VA 23060
www.thalhimer.com

Independently Owned and Operated / A Member of the Cushman & Wakefield Alliance

Cushman & Wakefield \ Thalhimer © 2015. No warranty or representation, express or implied, is made to the accuracy or completeness of the information contained herein, and same is submitted subject to errors, omissions, change of price, rental or other conditions, withdrawal without notice, and to any special listing conditions imposed by the property owner(s). As applicable, we make no representation as to the condition of the property (or properties) in question.