

# CUTLER DRIVE OFFICE/WAREHOUSE

230 North Cutler Drive | North Salt Lake, UT 84054

# CUTLER DRIVE OFFICE/WAREHOUSE

230 North Cutler Drive | North Salt Lake, UT 84054

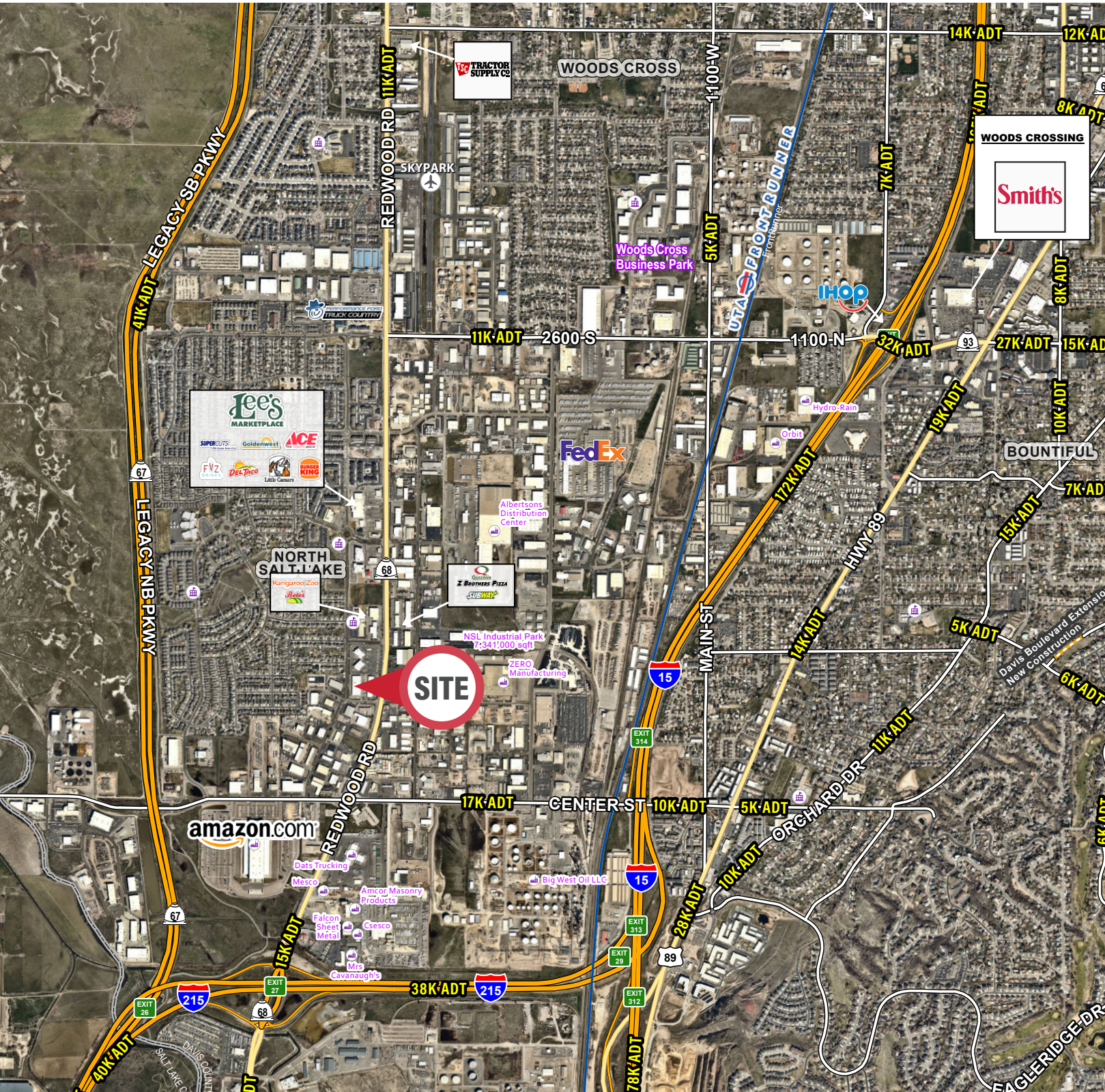

## FOR SALE

\$1,520,000 (\$200 PSF)

## Property Highlights

- Total: 7,600 SF
  - Warehouse: 4,500 SF
  - Office: 3,100 SF (Two-Story)
- 18' Clear Height
- Loading: One (1) Automatic 10' x 14' Grade-Level Door
- Power: 200 Amp | 240V | 3-Phase | 4 Wire
- Fire Sprinkler System
- LED & Motion-Sensed Lighting
- Temperature Controlled Warehouse
- Two (2) Restrooms
- Breakroom / Kitchen
- Four (4) Private Offices
- Access: Quick Access to I-15, I-215, Redwood Road and Legacy Parkway
- Location: Located in the Highly Desirable North Salt Lake Sub-Market.

## Contact

**SKYLER PETERSON, SIOR**  
Executive Vice President  
m 801.656.7354  
speterson@legendcommercial.com

**TRE BOURDEAUX, SIOR**  
Vice President  
m 801.824.0397  
tbourdeaux@legendcommercial.com

**PARKER TAGGART**  
Senior Associate  
m 801.928.1815  
ptaggart@legendcommercial.com



## Contact

**SKYLER PETERSON, SIOR**  
Executive Vice President  
m 801.656.7354  
speterson@legendcommercial.com

**TRE BOURDEAUX, SIOR**  
Vice President  
m 801.824.0397  
tbourdeaux@legendcommercial.com

**PARKER TAGGART**  
Senior Associate  
m 801.928.1815  
ptaggart@legendcommercial.com



# CUTLER DRIVE OFFICE/WAREHOUSE

230 North Cutler Drive | North Salt Lake, UT 84054

1st Floor

2nd Floor

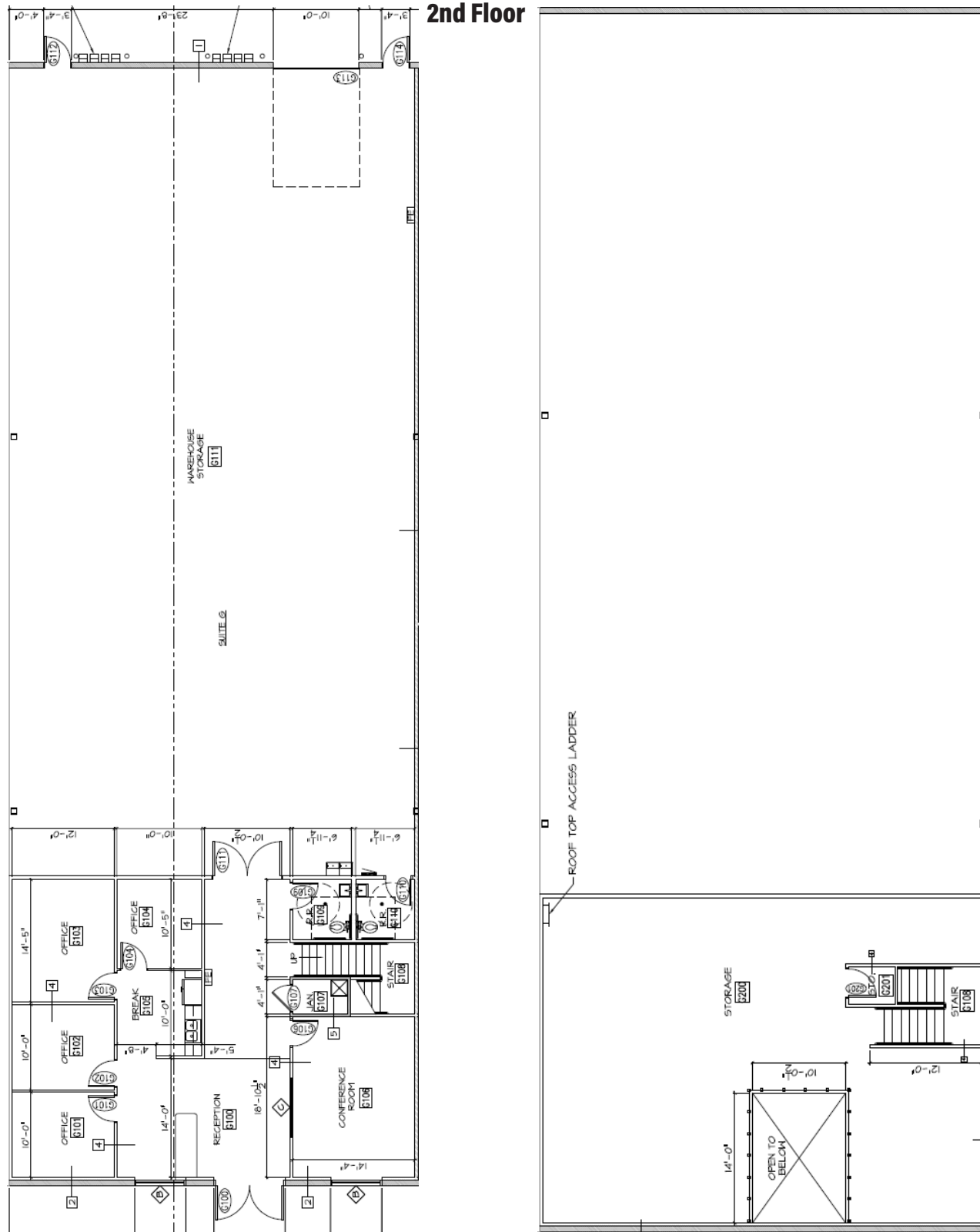

Contact

**SKYLER PETERSON, SIOR** Executive Vice President  
m 801.656.7354  
speterson@legendcommercial.com

**TRE BOURDEAUX, SIOR** Vice President  
m 801.824.0397  
tbourdeaux@legendcommercial.com

**PARKER TAGGART** Senior Associate  
m 801.928.1815  
ptaggart@legendcommercial.com



Contact

**SKYLER PETERSON, SIOR** Executive Vice President  
m 801.656.7354  
speterson@legendcommercial.com

**TRE BOURDEAUX, SIOR** Vice President  
m 801.824.0397  
tbourdeaux@legendcommercial.com

**PARKER TAGGART** Senior Associate  
m 801.928.1815  
ptaggart@legendcommercial.com

