



1013 Manhattan Avenue

#Commercial

corcoran



Mike Laurent, Lic. RE
Salesperson
m 347.596.3461

Christopher Cavorti, Lic. Assoc.
RE Broker
m 914.804.7091

Donald Lai, Lic. Assoc. RE
Broker
m 917.947.9917



WEB ID: 23662681 | RETAIL/RESTAURANT | 649 SF
ASKING RENT: \$5,400 / MONTH | PPSF: \$100

Introducing 1013 Manhattan Avenue - a standout retail opportunity in the heart of Greenpoint, Brooklyn. This approximately 649-square-foot corner storefront offers prime visibility and exceptional versatility. With generous frontage ideal for impactful branding and signage, the space is perfectly suited for food and beverage concepts, boutique luxury retail, or lifestyle brands looking to make a statement. The unit has been fully vanilla-boxed, providing a clean, efficient foundation for a tenant to quickly build out and activate their brand identity. Located just steps from the G train and positioned along a lively pedestrian corridor, the site benefits from strong daily foot traffic and a vibrant local community.

Whether you're expanding your brand or debuting your concept in NYC, 1013 Manhattan Avenue delivers the rare combination of location, visibility, and vibe that defines today's most successful retail environments.

Neighbors include: Glasserie, Radio Bakery, Nerina, The Brew Inn, Wenwen, Odd Fox Coffee, and more.

National Retailers galore with Apple, Alo, Sephora, Equinox, Nike, Lululemon, Levi's, Warby Parker, Everlane, Glossier, Chanel, Hermès, Aesop, Levain, Blue Bottle, Sweetgreen, and more close by.

Real estate agents affiliated with The Corcoran Group are independent contractor sales associates and are not employees of The Corcoran Group. The Corcoran Group is a licensed real estate broker located at 590 Madison Ave, NY, NY 10022. All information furnished regarding property for sale or rent or regarding financing is from sources deemed reliable, but Corcoran makes no warranty or representation as to the accuracy thereof. Buyer's Brokerage Compensation not valid unless confirmed in writing by applicable parties. All property information is presented subject to errors, omissions, price changes, changed property conditions, and withdrawal of the property from the market, without notice. Equal Housing Opportunity. All dimensions provided are approximate. To obtain exact dimensions, Corcoran advises you to hire a qualified architect or engineer.

1013 Manhattan Avenue

#Commercial

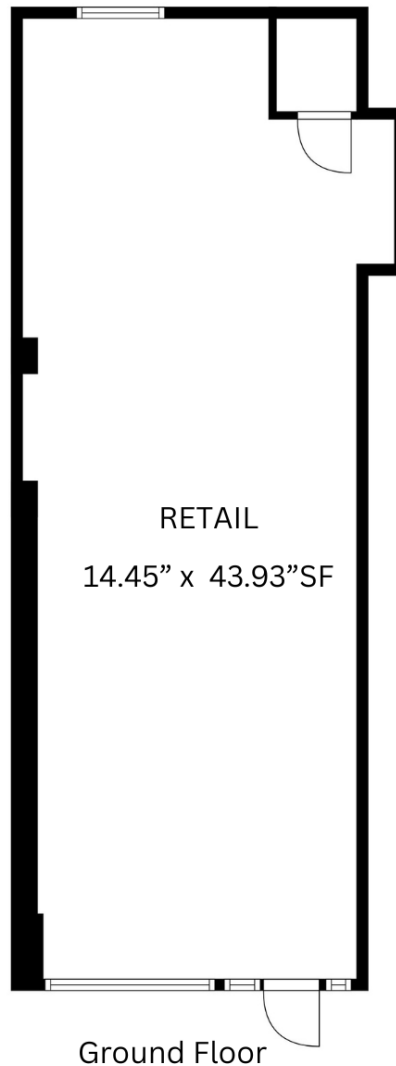

Estimated Net Square Footage: 649 SF

Scale in feet. Indicative only. Dimensions are approximate. All Information contained herein is gathered from sources we believe to be reliable. However, we cannot guarantee its accuracy and interested persons should rely on their own enquires

**Expertise You Can Trust.
Real Estate With Results.**

RESIDENTIAL | COMMERCIAL | NEW DEVELOPMENT ADVISORY
NYC - WESTCHESTER - HAMPTONS - GREENWICH CT
#1 TEAM IN WILLIAMSBURG SINCE 2014 WITH OVER \$1.2 BILLION SOLD

TFT@CORCORAN.COM | [@THEFORRAYTEAM](https://www.theforrayteam.com)

