

518 & 520-522 N CHARLES STR.

BALTIMORE, MARYLAND

Monument
Sotheby's
INTERNATIONAL REALTY



AVAILABLE FOR SALE

PROPERTY HIGHLIGHTS

- Listing Price: \$2,400,000.00
- Zoning; OR-2
- Building Size: 8,760 sq.ft
- 1 Parking lot - approximately 30 spaces
- Ground Level Restaurant - Vacant
- 2nd Floor Office - Leased
- Parking Lot - Leased
- Easy access to Inner Harbor, National Aquarium, and other Baltimore icons
- Conveniently located close to I-95
- 3.2 miles from Johns Hopkins University
- 10.8 miles from BWI Arrivals

Maja Likakis, Associate Broker

Cell 443.850.9968

maja@monumentsothebysrealty.com

Monument Sotheby's International Realty • 443-746-2090 • 12143 Clarksville Pike | Clarksville, Maryland 21029

www.MAJAREALESTATE.com | Each office is independently owned and operated.

518 & 520 - 522 N CHARLES STR.

BALTIMORE, MARYLAND

Monument
Sotheby's
INTERNATIONAL REALTY



AVAILABLE FOR SALE

PROPERTY HIGHLIGHTS

- Located in the Mount Vernon/Station North arts and entertainment district, the area is packed with theaters and attractions
- Walters Art Museum (just south down Mount Vernon Place)
- The neighborhood is highly walkable, close to shops, restaurants, and cultural attractions
- Just under 1½ miles from Baltimore Penn Station, offering Amtrak, MARC, and Light Rail access

Maja Likakis, Associate Broker

Cell 443.850.9968

maja@monumentsothebysrealty.com

Monument Sotheby's International Realty • 443-746-2090 • 12143 Clarksville Pike | Clarksville, Maryland 21029

www.MAJAREALESTATE.com | Each office is independently owned and operated.

AERIAL

518 & 520 - 522 N CHARLES STR, BALTIMORE, MARYLAND

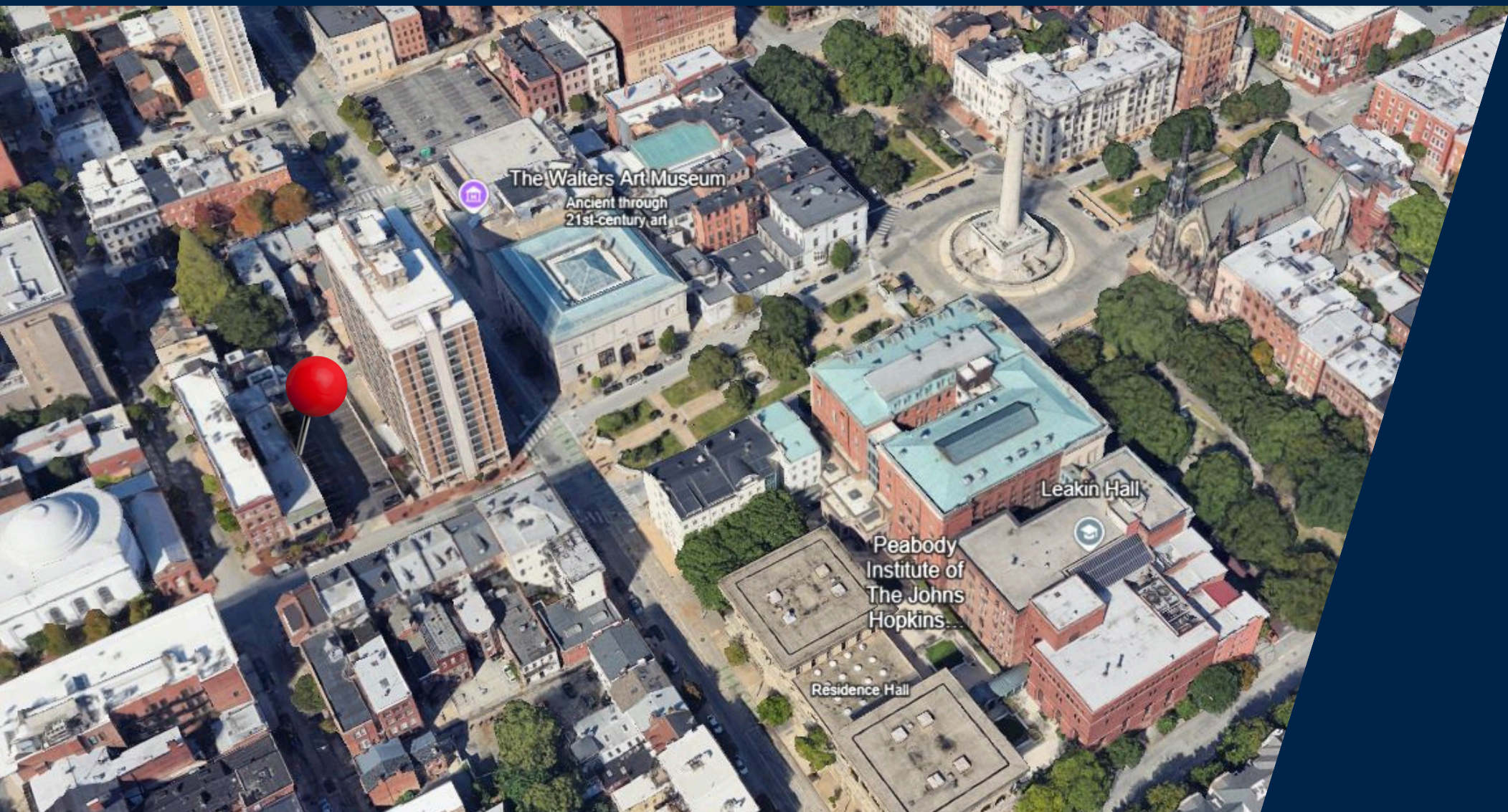

Maja Likakis, Associate Broker

Cell 443.850.9968

maja@monumentsothebysrealty.com

Monument Sothebys International Realty • 443-746-2090 • 12143 Clarksville Pike | Clarksville, Maryland 21029

www.MAJAREALESTATE.com | Each office is independently owned and operated.

Monument

Sotheby's

INTERNATIONAL REALTY

FLOOR PLAN 518 & 520 - 522 N CHARLES STR, BALTIMORE, MARYLAND

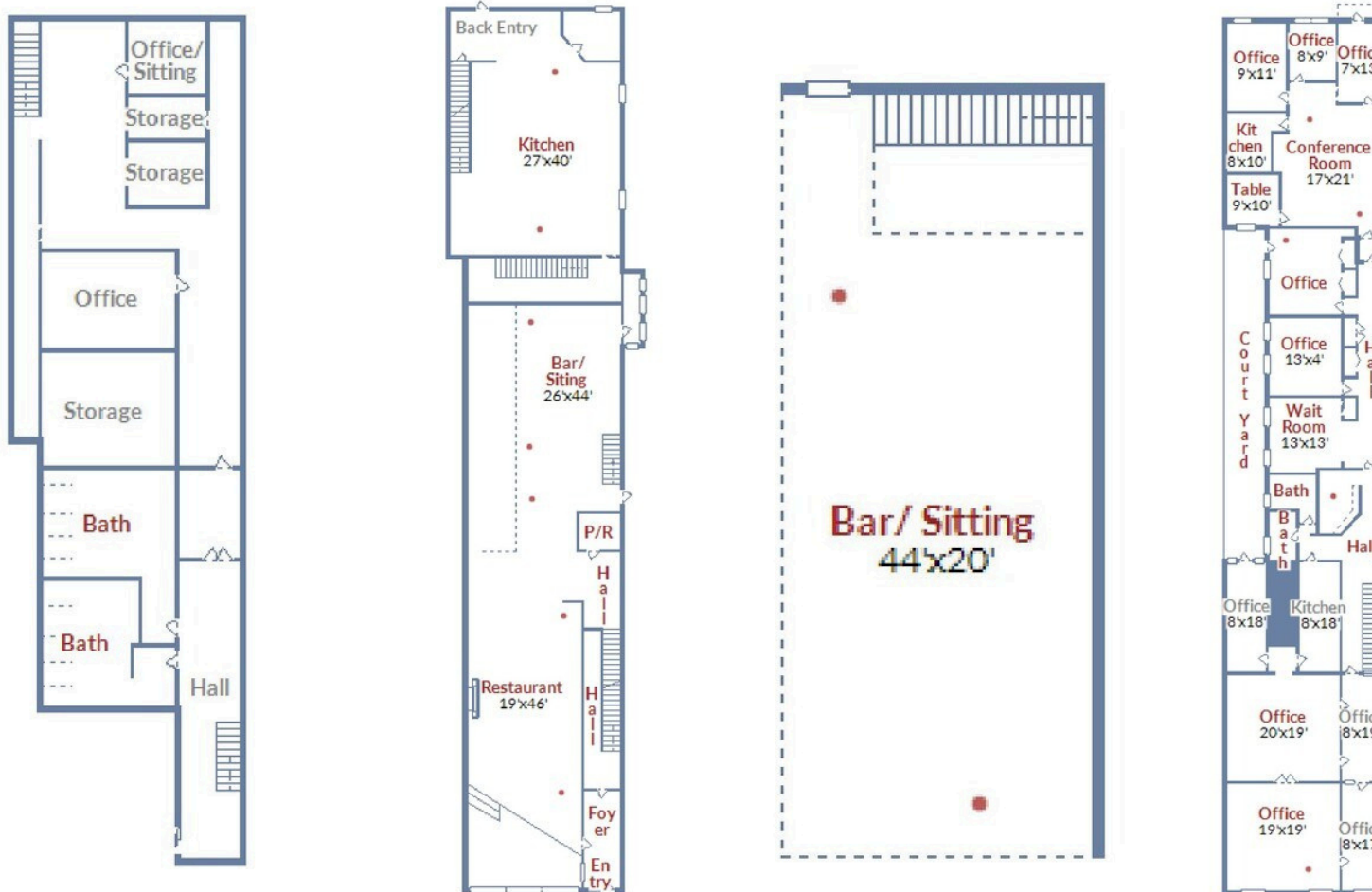

This floor plan is provided for informational purposes only. It is not to scale and is intended to give a general layout of the property. No warranty or representation is made as to the accuracy or completeness of the layout depicted.

Maja Likakis, Associate Broker

Cell 443.850.9968

maja@monumentsothebysrealty.com

Monument Sothebys International Realty • 443-746-2090 • 12143 Clarksville Pike | Clarksville, Maryland 21029

www.MAJAREALESTATE.com | Each office is independently owned and operated.

Monument

Sotheby's

INTERNATIONAL REALTY