

FOR LEASE

±17,318 SF INDUSTRIAL BUILDING

18042 Cortney Ct, Ste A
City of Industry, CA 91748



PROPERTY HIGHLIGHTS

- ▶ 3,370 SF Office (2-Story)
- ▶ Two (2) Dock High Loading Positions (Internal Dockwell)
- ▶ One (1) Ground/Grade Level Loading Door
- ▶ 21' Clear Height
- ▶ 3 Restrooms (Including Restroom with a Shower)
- ▶ Shared Private Fenced Yard (Shared with Only One Other Tenant)

PROPERTY AERIAL



LOCATION MAP

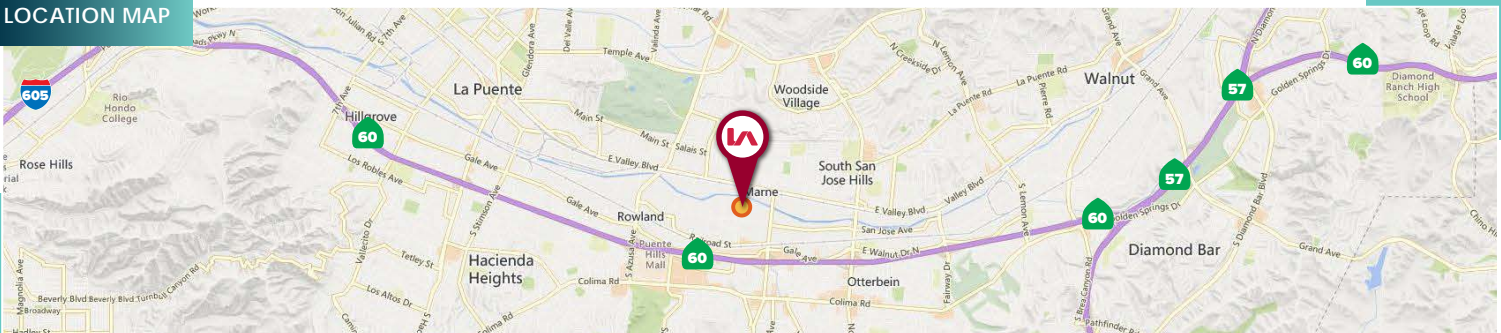

MICHAEL LEE MBA, SIOR, CCIM
Senior Vice President | Lic. ID # 01703179
P \\ 562.568.2018
E \\ mlee@lee-associates.com



BEN FUKUKURA
Senior Vice President | Lic. ID # 01952494
P \\ 562.568.2040
E \\ bfukukura@lee-associates.com

LOCAL EXPERTISE. INTERNATIONAL REACH. WORLD CLASS.



FOR LEASE

±17,318 SF INDUSTRIAL BUILDING

18042 Cortney Ct, Ste A
City of Industry, CA 91748

SITE PLAN

**Not to Scale*

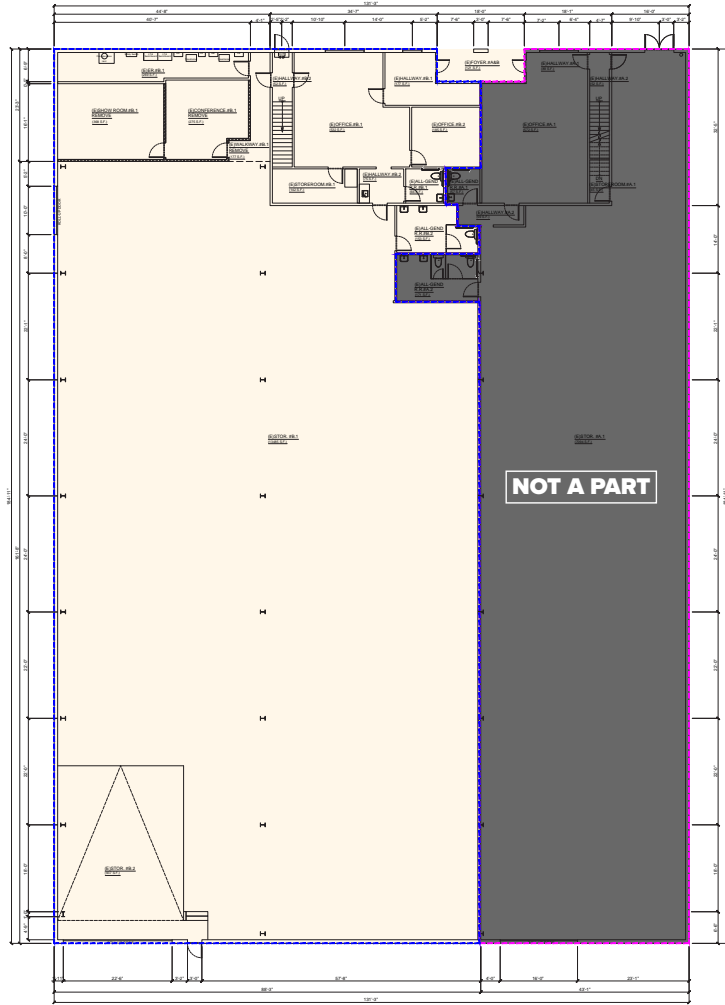

FIRST FLOOR

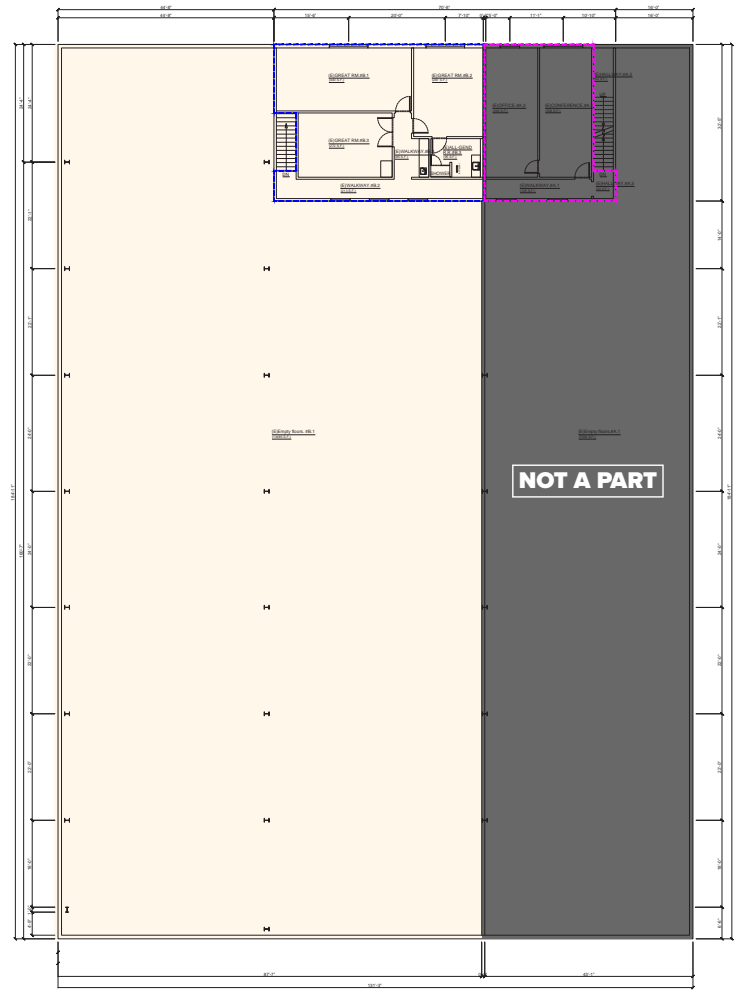

SECOND FLOOR



MICHAEL LEE MBA, SIOR, CCIM
Senior Vice President | Lic. ID # 01703179
P \\ 562.568.2018
E \\ mlee@lee-associates.com



BEN FUKUKURA
Senior Vice President | Lic. ID # 01952494
P \\ 562.568.2040
E \\ bfukukura@lee-associates.com

LOCAL EXPERTISE. INTERNATIONAL REACH. WORLD CLASS.

