

FOR LEASE

±3,031 SF



5631 TEXOMA PARKWAY

Sherman, TX 75090

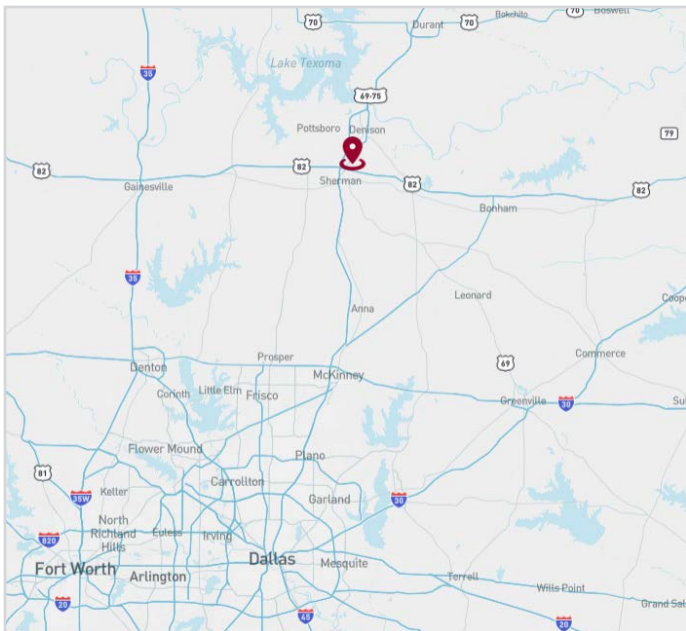

AVAILABILITY HIGHLIGHTS

- ±3,031 Available Square Feet
- Ample Parking
- Ideal for Office or Retail Use
- 1 Rear Overhead Door
- Available now

ECONOMIC DATA

Contact Broker for Lease Rate; \$3.20/SF OPEX

FOR LEASING INFORMATION:

Phil Rosenfeld
Principal

prosenfeld@lee-associates.com
469.222.4159



leedallas.com

±3,031 SF

FOR LEASE

SITE PLAN

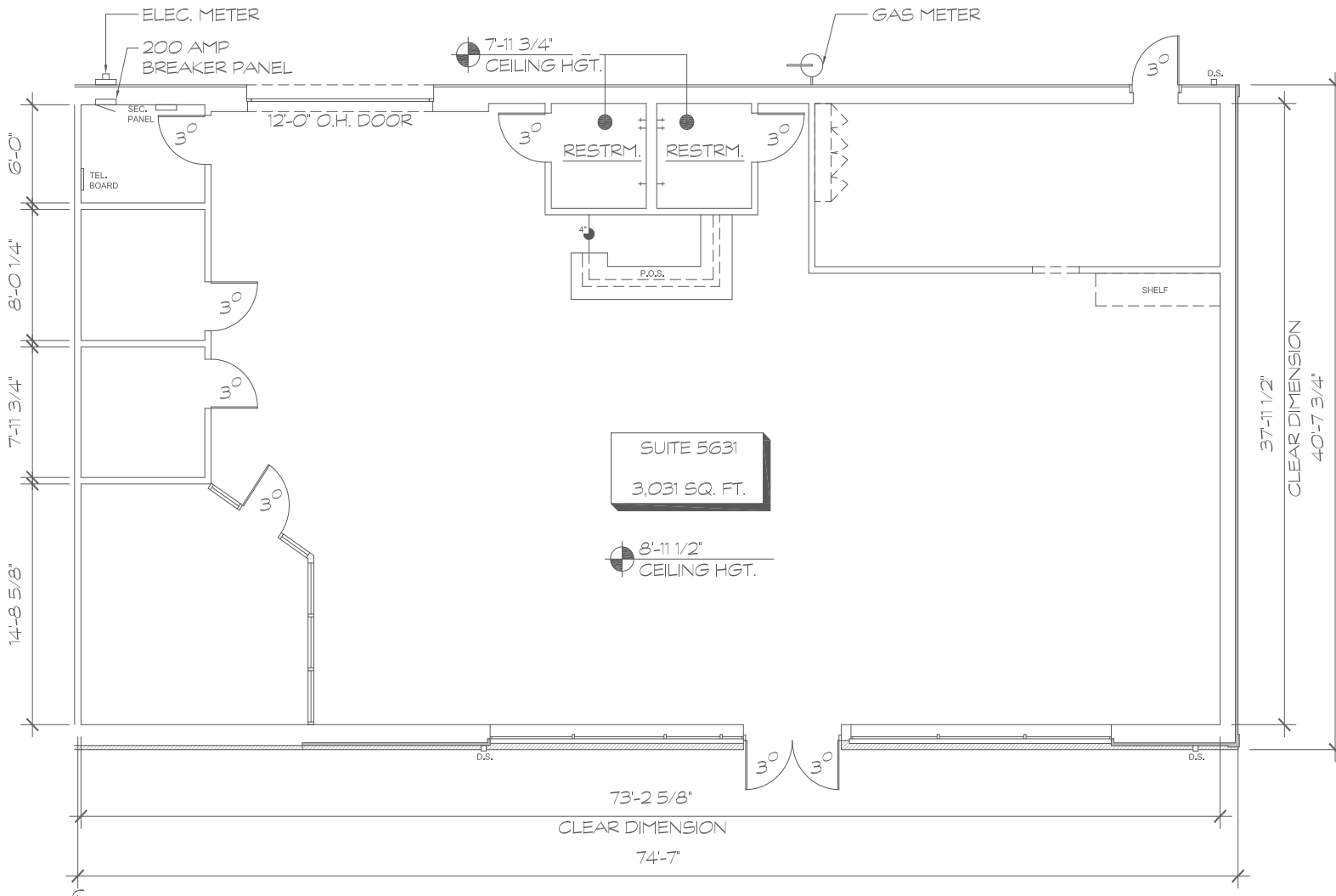

FOR LEASING INFORMATION:

Phil Rosenfeld
Principal
prosenfeld@lee-associates.com
469.222.4159

LEE & ASSOCIATES
COMMERCIAL REAL ESTATE SERVICES

leadallas.com