

# INDUSTRIAL KITCHEN WITH RETAIL EXPOSURE

## For Lease ±5,172 Square Feet

2565 Middlefield Rd, Redwood City, California



### PROPERTY HIGHLIGHTS

- ±5,172 Square Feet
- Lease Rate Includes Equipment, (tenant to verify)
- Grade Level Door (10 x 12')
- ±18' Clear Height
- Space Heater
- 3 Parking Spaces
- 200 Amps of Power, (tenant to verify)
- Shop Sinks
- Call To Tour
- Asking \$2.10/SF, Industrial Gross
- Please Do Not Disturb Tenant
- Available June 1, 2023



*For more information, please contact:*



**Joe Gorme**  
**Principal**  
t 408-242-6657  
joe.gorme@equuscre.com  
CA RE Lic #01238833



**Martin Chiechi**  
**Senior Managing Director**  
t 408-987-4178  
martin.chiechi@nrmk.com  
CA RE Lic #00806069

2565 Middlefield Road  
Redwood City, California

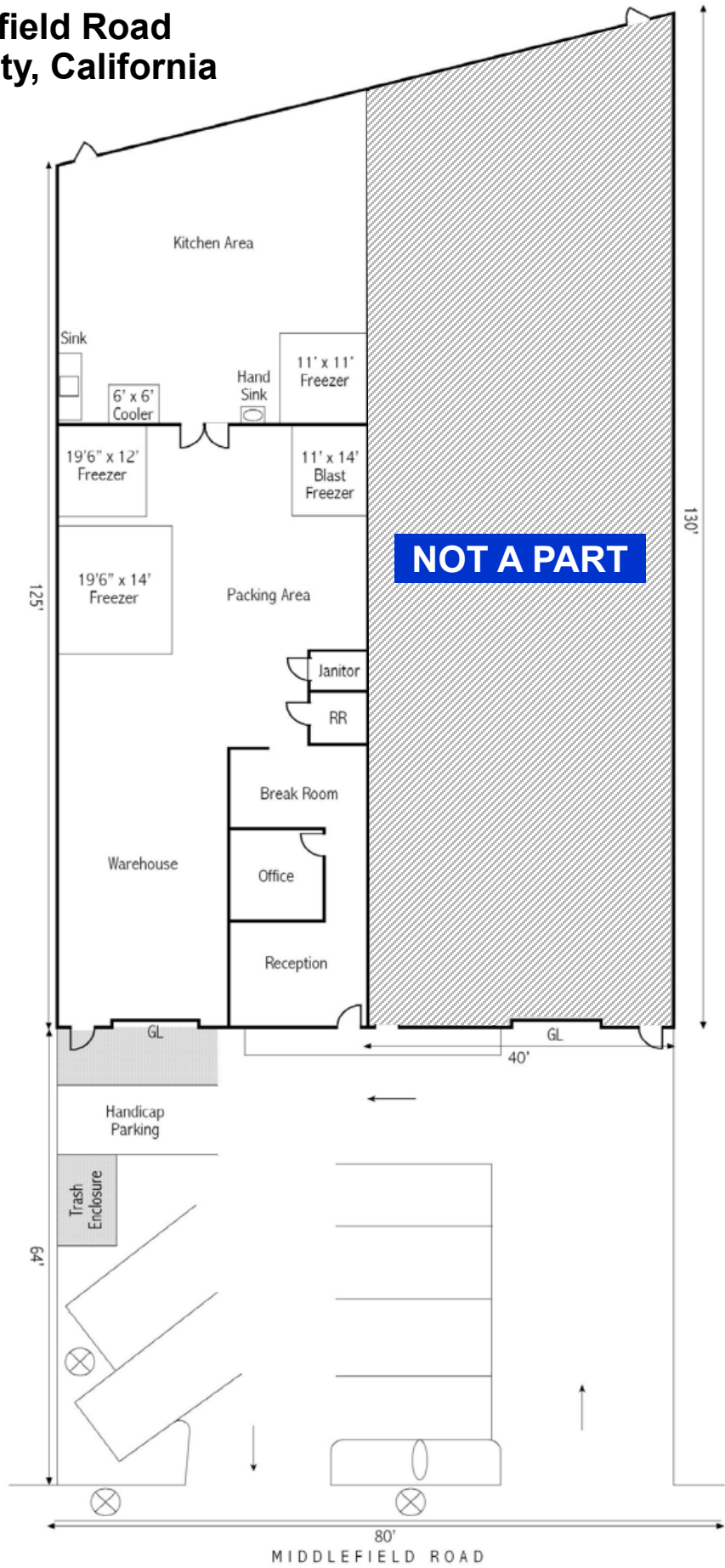

• NOT TO SCALE •