

22420-22440 HURON RIVER DR.  
ROCKWOOD, MICHIGAN

RETAIL FOR LEASE  
3,900 Square Feet Available



**SIGNATURE  
ASSOCIATES**  
KNOW SIGNATURE | KNOW RESULTS

**STRIP CENTER**



## PROPERTY FEATURES

- 3,900 square feet available
- 12,000 square foot building
- Located on .53 acres
- Zoned Retail
- 22 parking spaces
- Built in 1985
- Lease rate: \$12.00/sq. ft. NNN

**Comments:** Opportunity to lease office or retail in this well-located strip center. Just off I-75, the site serves locals and travelers.



For more information, please contact:

**JUSTIN GAFFREY**  
(248) 799 3143  
jgaffrey@signatureassociates.com

**SIGNATURE ASSOCIATES**  
One Towne Square, Suite 1200  
Southfield, MI 48076  
www.signatureassociates.com

# 22420-22440 Huron River Dr. – Rockwood, Michigan

Retail For Lease

3,900  
Square Feet  
AVAILABLE



## DEMOGRAPHICS

	POPULATION	MED. HH INCOME
1 MILE	3,615	\$76,321
3 MILE	24,199	\$75,929
5 MILE	62,561	\$73,459

## TRAFFIC COUNTS (TWO-WAY)

5,983	Huron River Dr. NW. of Fort Rd.
12,453	Huron River Dr. SE. of Fort Rd.
60,356	I-75 S. of Huron River Dr.
63,566	I-75 N. of Huron River Dr.



For more information, please contact:

**JUSTIN GAFFREY**

(248) 799 3143

[jgaffrey@signatureassociates.com](mailto:jgaffrey@signatureassociates.com)

**SIGNATURE ASSOCIATES**

One Towne Square, Suite 1200

Southfield, MI 48076

[www.signatureassociates.com](http://www.signatureassociates.com)

22420-22440 Huron River Dr. – Rockwood, Michigan

Retail For Lease

3,900  
Square Feet  
AVAILABLE

Site Plan

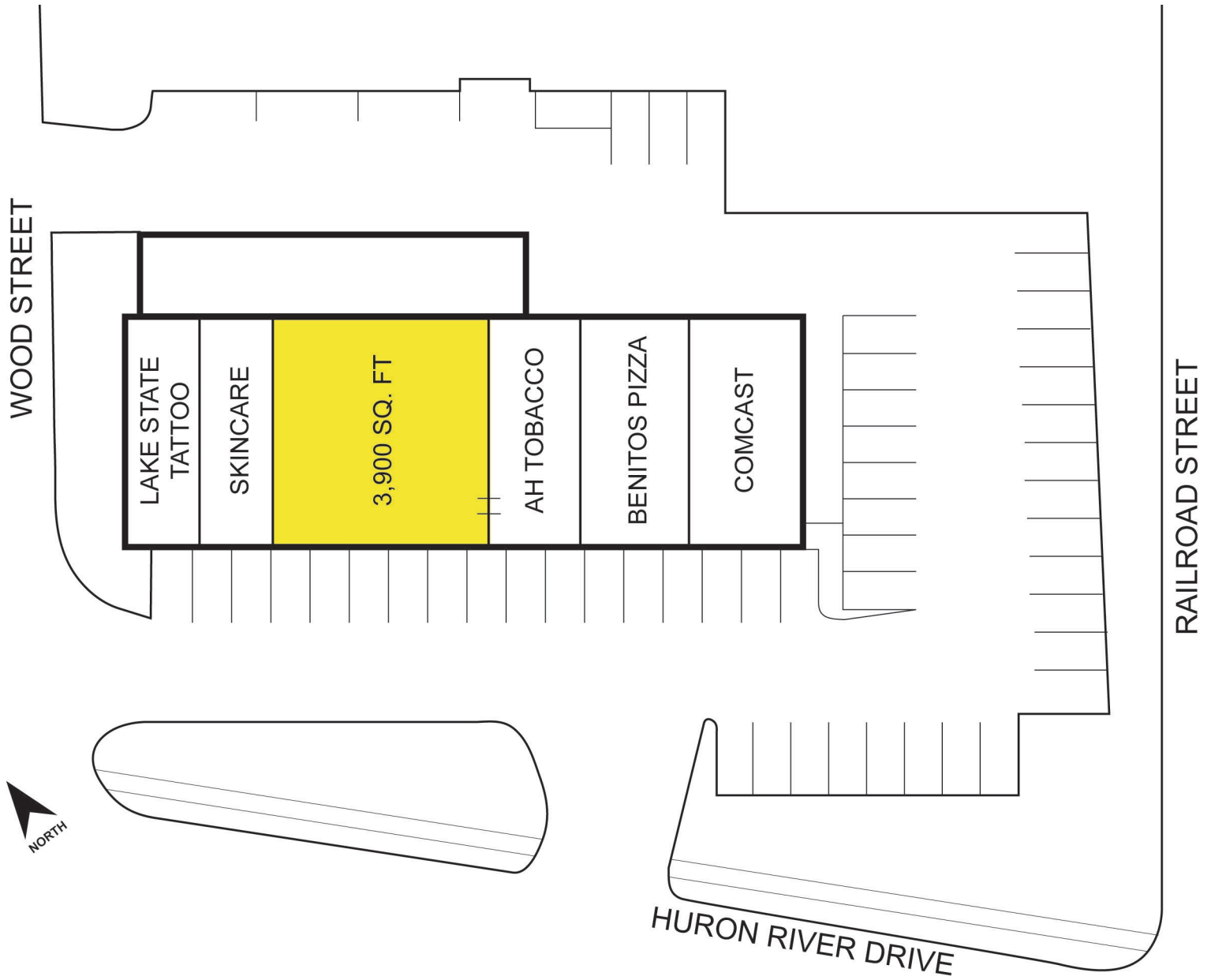

For more information, please contact:

**JUSTIN GAFFREY**

(248) 799 3143

[jgaffrey@signatureassociates.com](mailto:jgaffrey@signatureassociates.com)

**SIGNATURE ASSOCIATES**

One Towne Square, Suite 1200

Southfield, MI 48076

[www.signatureassociates.com](http://www.signatureassociates.com)