

# ARA-C

2449 S 6755 W, West Valley City, Utah 84128

226,442 SF

AVAILABLE



# FOR LEASE

## PROPERTY HIGHLIGHTS

- Building Square Feet: 632,700
- Dock High Doors: 37 (22 equipped)
- Grade Level/Ramp Doors: 3 (12' x 14')
- Clear Height: 36'
- Column Spacing: 50' x 55'
- Electrical: 800 AMP, 480/277 v. 3 phase
- Floor: 7" thick, reinforced
- Lighting: T-5
- Heating: Gas Unit Heaters
- Fire Protection: ESFR
- Roofing: R-20
- Office: Approx. 2,800 SF
- Lease Rate: Negotiable
- Available September 1, 2024

## FOR MORE INFORMATION CONTACT:

**Taylor R. Thomas**  
O 801.977.6329  
C 801.949.8302  
tthomas@freeportwest.com

# ARA-C

2449 S 6755 W, West Valley City, Utah 84128

## 226,442 SF

### AVAILABLE

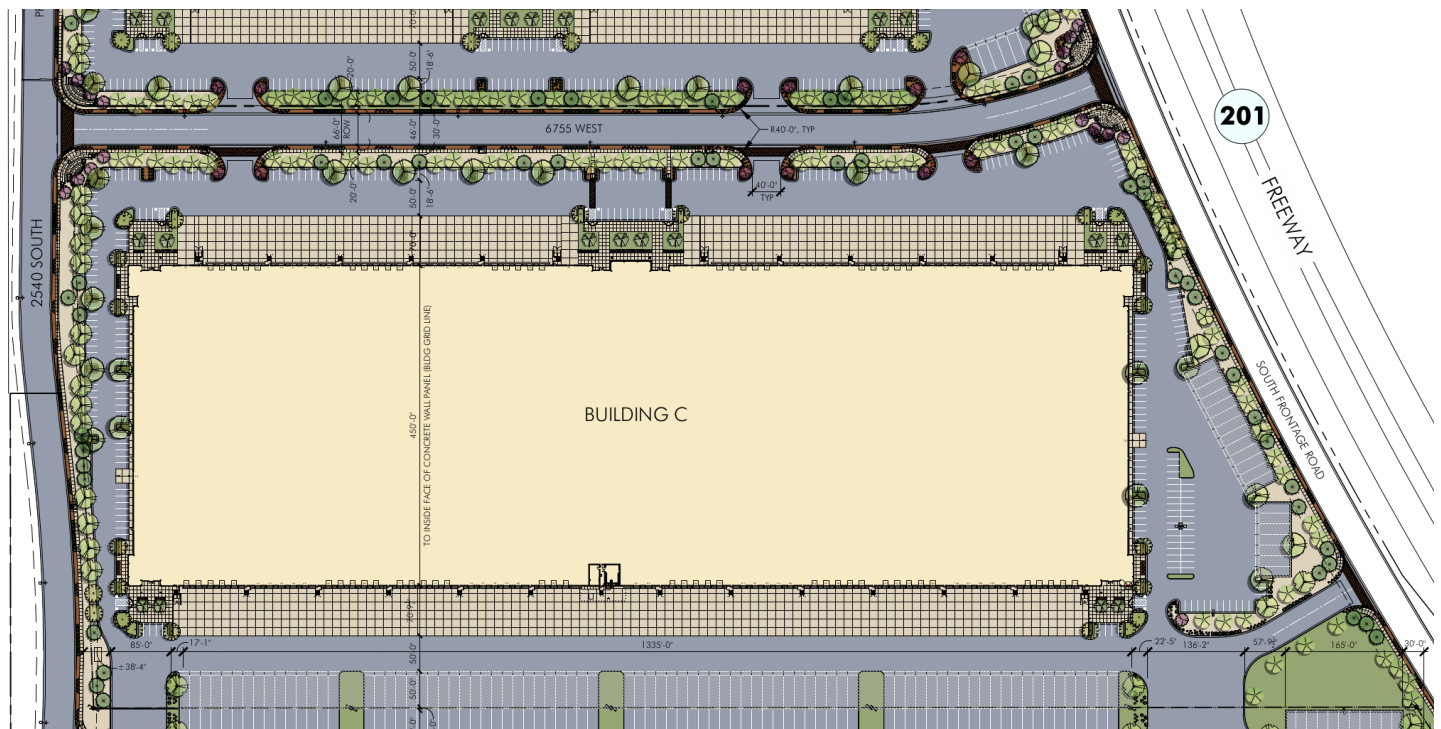
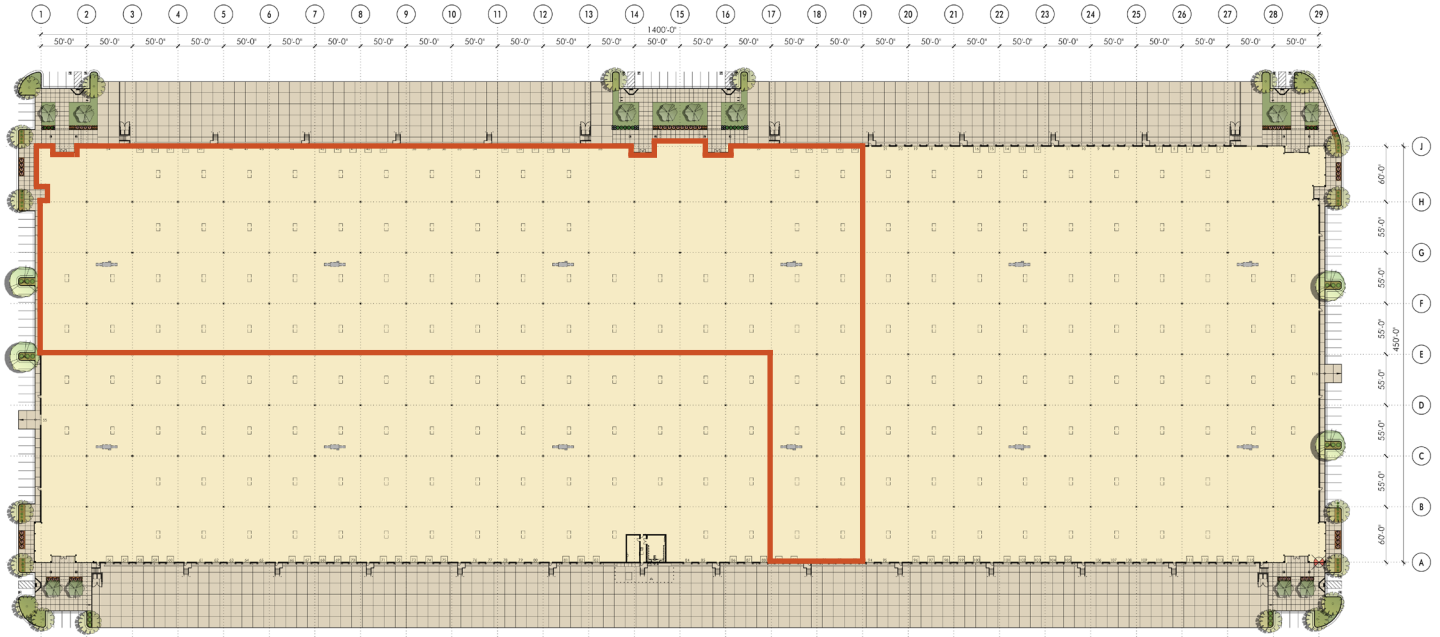

# ARA-C

2449 S 6755 W, West Valley City, Utah 84128

**226,442 SF**

AVAILABLE



- Located off 7200 West and SR 201 in West Valley City
- Minutes from I-80, I-15, I-215, Bangerter Highway
- Eight miles from the Salt Lake International Airport