

81X30

81X30

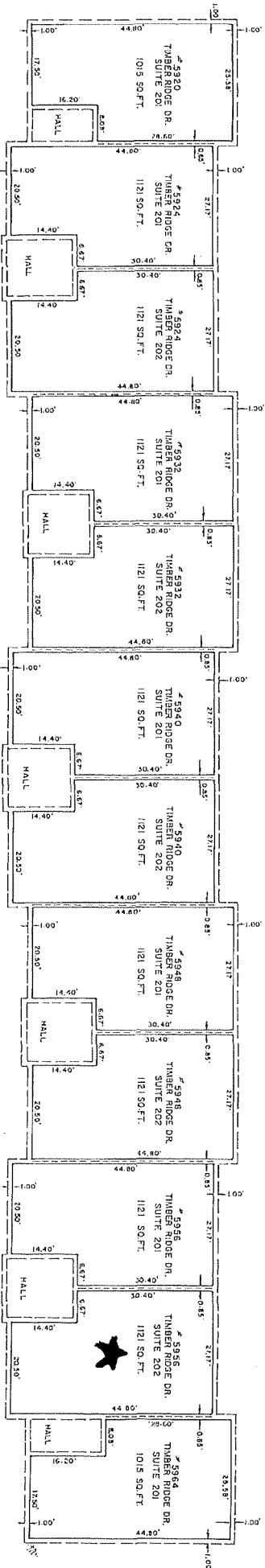

**SECOND FLOOR**  
 FINISH ELEV. = 492.75  
 FLOOR ELEV. = 492.75

- 5920 TIMBER RIDGE DRIVE SUITE 201 - 1,015 SQ. FT.
- 5922 TIMBER RIDGE DRIVE SUITE 201 - 1,015 SQ. FT.
- 5924 TIMBER RIDGE DRIVE SUITE 201 - 1,015 SQ. FT.
- 5926 TIMBER RIDGE DRIVE SUITE 201 - 1,015 SQ. FT.
- 5928 TIMBER RIDGE DRIVE SUITE 201 - 1,015 SQ. FT.
- 5930 TIMBER RIDGE DRIVE SUITE 201 - 1,015 SQ. FT.
- 5932 TIMBER RIDGE DRIVE SUITE 201 - 1,015 SQ. FT.
- 5934 TIMBER RIDGE DRIVE SUITE 201 - 1,015 SQ. FT.
- 5936 TIMBER RIDGE DRIVE SUITE 201 - 1,015 SQ. FT.
- 5938 TIMBER RIDGE DRIVE SUITE 201 - 1,015 SQ. FT.
- 5940 TIMBER RIDGE DRIVE SUITE 201 - 1,015 SQ. FT.
- 5942 TIMBER RIDGE DRIVE SUITE 201 - 1,015 SQ. FT.
- 5944 TIMBER RIDGE DRIVE SUITE 201 - 1,015 SQ. FT.
- 5946 TIMBER RIDGE DRIVE SUITE 201 - 1,015 SQ. FT.
- 5948 TIMBER RIDGE DRIVE SUITE 201 - 1,015 SQ. FT.
- 5950 TIMBER RIDGE DRIVE SUITE 201 - 1,015 SQ. FT.
- 5952 TIMBER RIDGE DRIVE SUITE 201 - 1,015 SQ. FT.
- 5954 TIMBER RIDGE DRIVE SUITE 201 - 1,015 SQ. FT.
- 5956 TIMBER RIDGE DRIVE SUITE 201 - 1,015 SQ. FT.
- 5958 TIMBER RIDGE DRIVE SUITE 201 - 1,015 SQ. FT.
- 5960 TIMBER RIDGE DRIVE SUITE 201 - 1,015 SQ. FT.
- 5962 TIMBER RIDGE DRIVE SUITE 201 - 1,015 SQ. FT.
- 5964 TIMBER RIDGE DRIVE SUITE 201 - 1,015 SQ. FT.

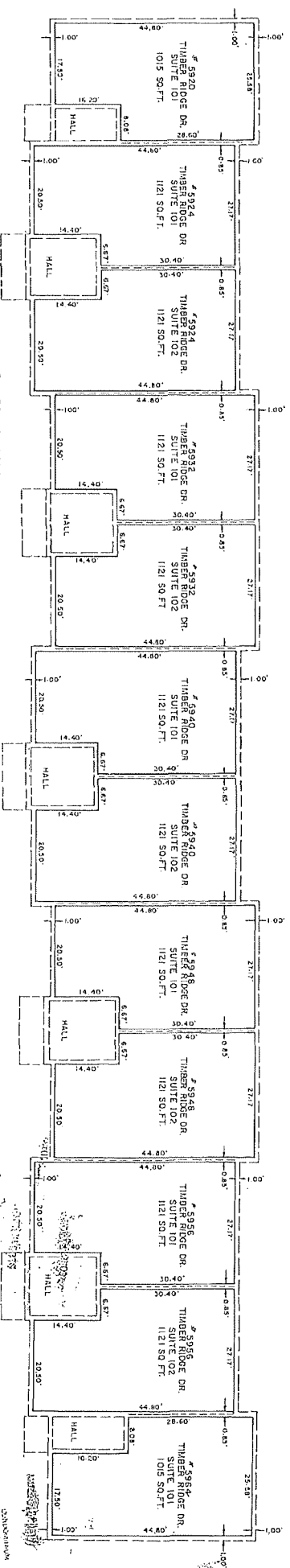

**FIRST FLOOR**  
 FINISH ELEV. = 470.60  
 FLOOR ELEV. = 467.60

**DUKES & ASSOC.**  
 LAND SURVEYING INC.  
 700 S. MAIN ST.  
 LOUISVILLE, KENTUCKY 40214  
 937-5539 FAX 933-0740

DATE: MARCH 12, 2001 SCALE: 1" = 10'

**HOGAN-PROSPECT VILLAGE, LLC**  
 a Kentucky Limited Liability Company  
 c/o Hogan Development Company  
 P.O. Box 7606  
 7400 New Lagrange Road, Suite 404  
 Louisville, Kentucky 40257

**PROSPECT VILLAGE PROFESSIONAL OFFICE CONDOMINIUMS**  
 5910 TIMBER RIDGE DRIVE  
 PROSPECT, KENTUCKY 40059

CONDOMINIUM  
 UNIT 201  
 UNIT 202  
 UNIT 101  
 UNIT 102

DATE: 3/12/01  
 DRAWN BY: [Signature]  
 CHECKED BY: [Signature]  
 TITLE: [Title]

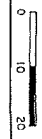

81X30

81X30