

FOR SUBLEASE

215 S DOUGLAS ST

EL SEGUNDO, CA 90245



Property Highlights

33,600 SF available for sublease (minimum 23,600 SF)

Freestanding industrial CTU building

Prestigious El Segundo Utah Tract

Close to Rosecrans restaurant row

Truck high and ground level loading

49 car parking spaces

18' minimum clear height/sprinklered

800 Amps/ESCM zoning

Neighbors include Space Force, Varda Space & Aerospace Corp

Sublease through July 31, 2027

\$2.15/SF

NET LEASE RATE

49

PARKING SPACES

18'

CLEAR HEIGHT

HARVEY BEESEN, SIOR
310.906.3264
harvey.beesen@kidder.com
LIC N° 00615891

LUKE STAUBITZ, SIOR
310.906.3288
luke.staubitz@kidder.com
LIC N° 01037737

ANDREW DILFER, SIOR, GLS
310.906.3280
andrew.dilfer@kidder.com
LIC N° 01455665

KIDDER.COM

This information supplied herein is from sources we deem reliable. It is provided without any representation, warranty, or guarantee, expressed or implied as to its accuracy. Prospective Buyer or Tenant should conduct an independent investigation and verification of all matters deemed to be material, including, but not limited to, statements of income and expenses. Consult your attorney, accountant, or other professional advisor.

km Kidder Mathews

SITE PLAN

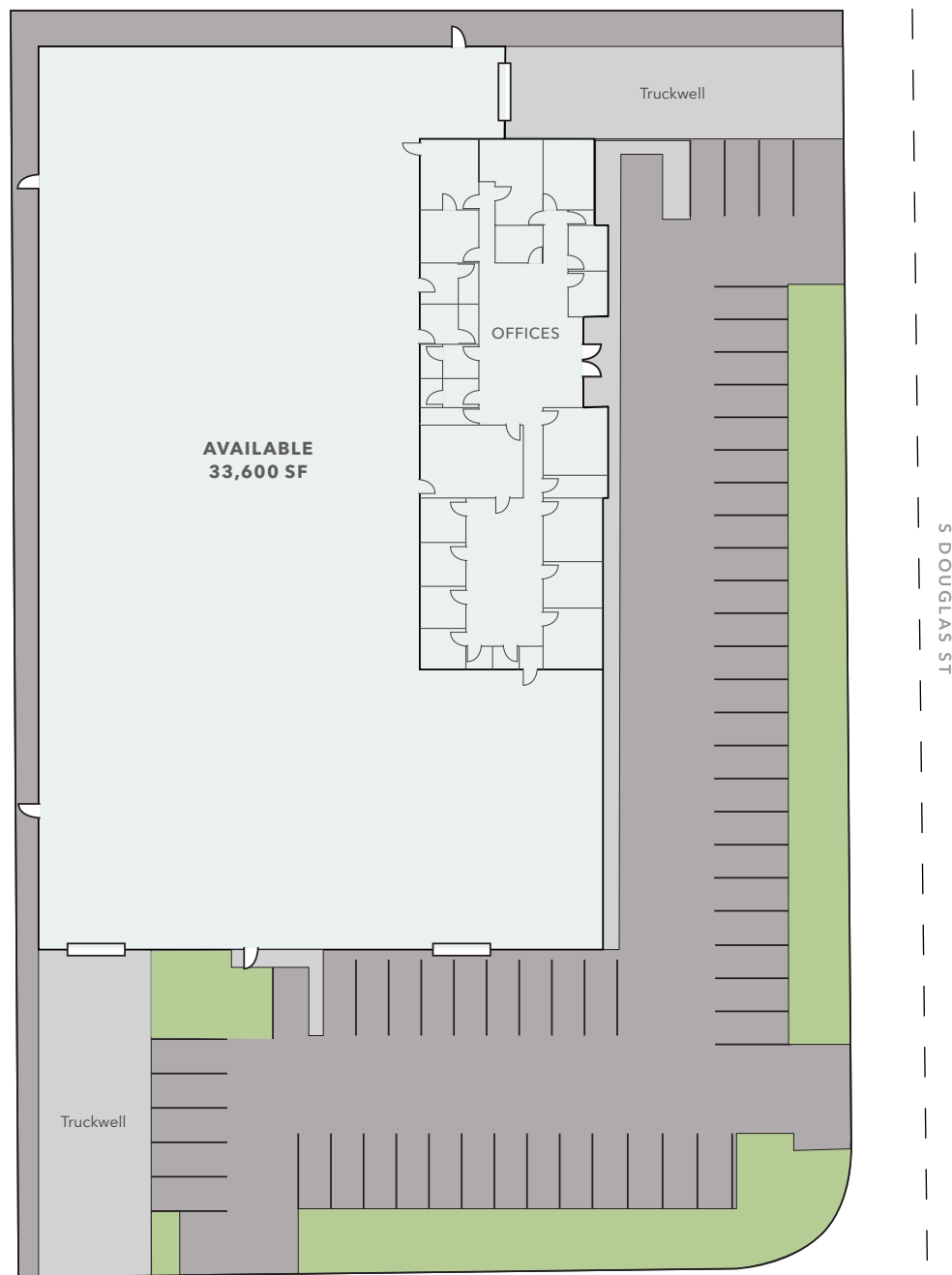

HARVEY BEESEN, SIOR 310.906.3264 | harvey.beesen@kidder.com | LIC N° 00615891
LUKE STAUBITZ, SIOR 310.906.3288 | luke.staubitz@kidder.com | LIC N° 01037737
ANDREW DILFER, SIOR, GLS 310.906.3280 | andrew.dilfer@kidder.com | LIC N° 01455665

KIDDER.COM

This information supplied herein is from sources we deem reliable. It is provided without any representation, warranty, or guarantee, expressed or implied as to its accuracy. Prospective Buyer or Tenant should conduct an independent investigation and verification of all matters deemed to be material, including, but not limited to, statements of income and expenses. Consult your attorney, accountant, or other professional advisor.