

For sublease

723 Broadway Avenue, Holbrook, NY

40,000 SF

Available size

Approx. 4,000 SF

Office

4 dock doors

Loading

13'6" clear

Ceiling height

30' x 40'

Column spacing

Sublease term through 9/2027

Gas heat

Fully sprinklered

2 bathrooms in office

2 bathrooms in warehouse

Comments



Max Omstrom

max.omstrom@jll.com

+1 631 962 2504

Doug Omstrom

doug.omstrom@jll.com

+1 631 962 2899

jll.com

Jones Lang LaSalle Brokerage, Inc.



Floor plan

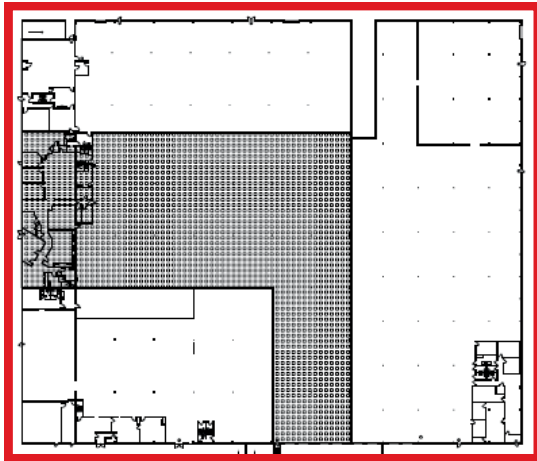
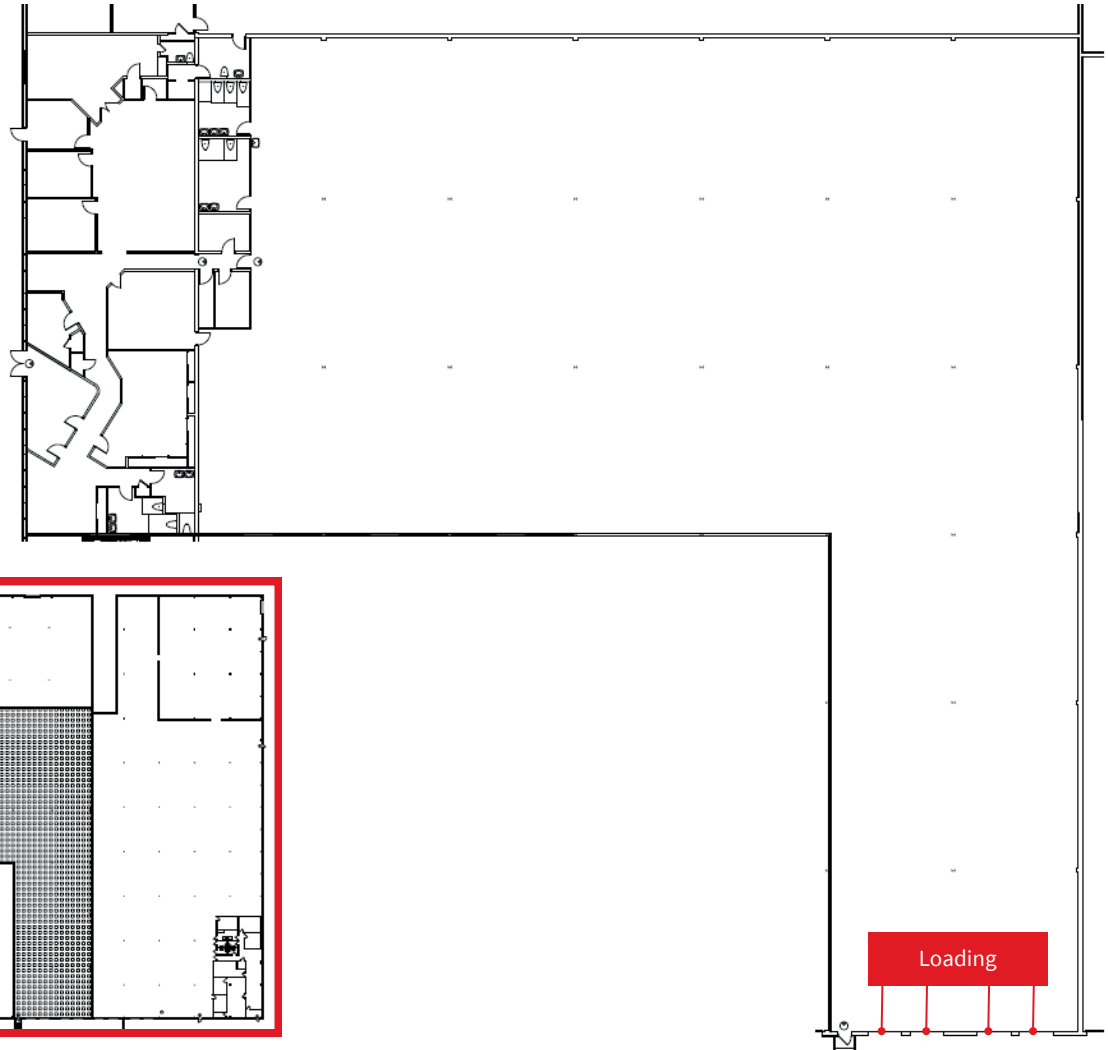

Key distances

400 feet

to Veterans Memorial Highway

0.9 miles

to Sunrise Highway

3.0 miles

to MacArthur Airport

4.6 miles

to LIRR Ronkonkoma

4.7 miles

to Long Island Expressway

41.1 miles

to JFK Airport

