

# 926 BRADY

ATL STOCKYARDS GA



## GROUND LEVEL

19,107 RSF

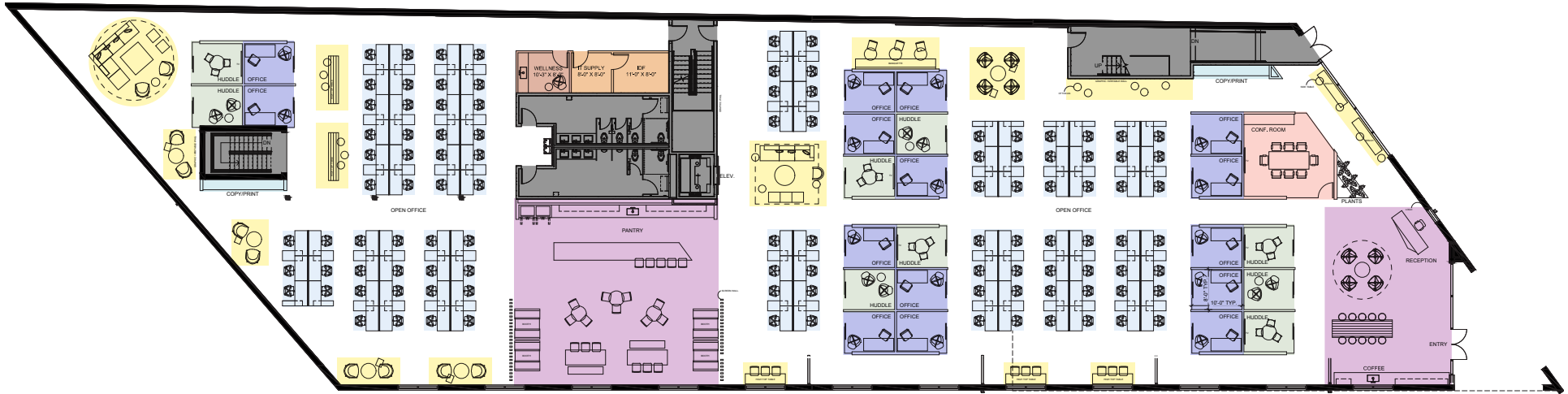

Note: Drawing is Not to Scale

PROGRAM SUMMARY		QTY	SEATS
<b>HEADCOUNT</b>			
	OFFICES	-	15
	WORKSTATIONS	-	104
	<b>TOTAL</b>	-	119
<b>MEETING</b>			
	HUDDLE	9	23
	CONFERENCE	1	8
	<b>TOTAL</b>	-	31
<b>COLLABORATIONS</b>			
	WORK CAFE	-	56
	OPEN OFFICE	-	60
	<b>TOTAL</b>	-	116
	SUPPORT	-	-
	COPY/PRINT	-	-
	WELLNESS/MOTHER'S ROOM	-	-

For leasing information, please contact:

Zach Wooten  
zach.wooten@transwestern.com  
O: 404.842.6540 | M: 404.308.5085

Stephen Clifton  
stephen.clifton@transwestern.com  
O: 404.842.6538 | M: 803.238.0719

Leased by:



A strategic development of:



WESTBRIDGE

# 926 BRADY

ATL STOCKYARDS GA



## TERRACE LEVEL

8,607 RSF

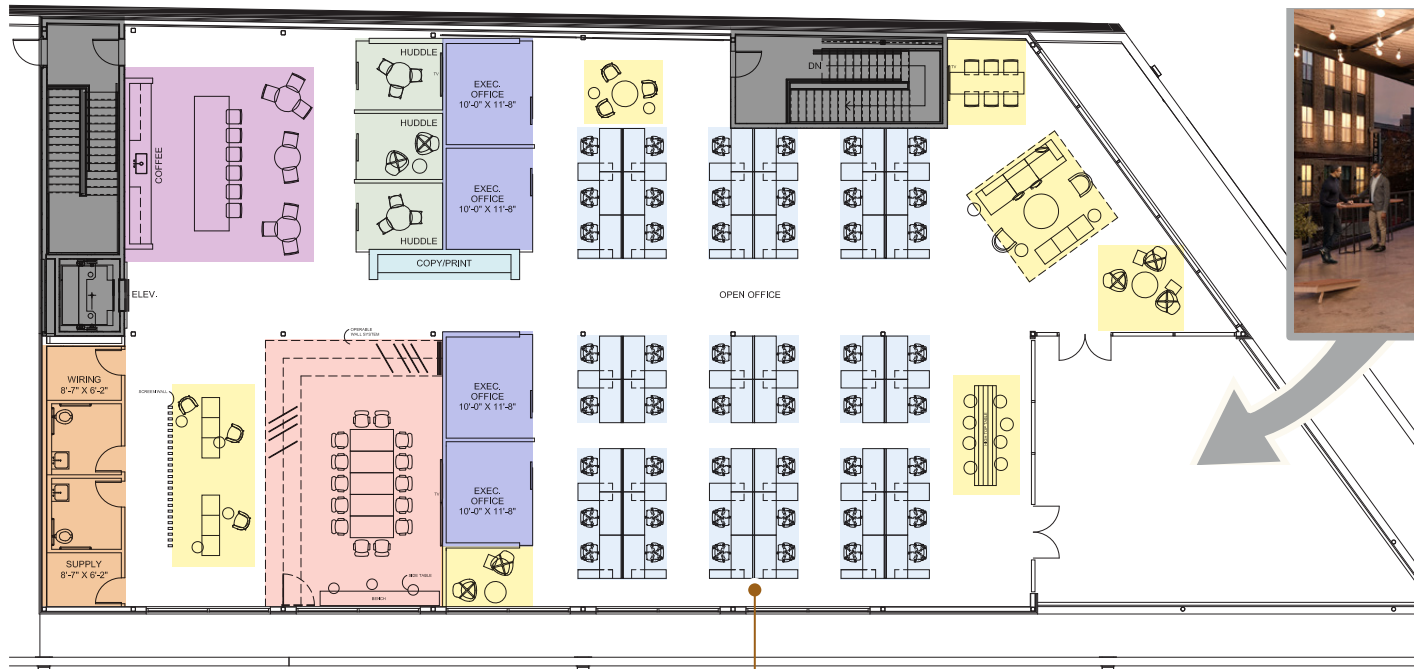

TERRACE: 1,087 SF

INTERIOR: 8,607 SF



Note: Drawing is Not to Scale

PROGRAM SUMMARY	QTY	SEATS
<b>HEADCOUNT</b>		
OFFICES	-	4
WORKSTATIONS	-	48
<b>TOTAL</b>	-	<b>52</b>
<b>MEETING</b>		
HUDDLE	3	8
CONFERENCE	1	20
<b>TOTAL</b>	-	<b>28</b>
<b>COLLABORATIONS</b>		
WORK CAFE	-	14
OPEN OFFICE	-	39
<b>TOTAL</b>	-	<b>53</b>
<b>SUPPORT</b>		
COPY/PRINT	-	-
WELLNESS/MOTHER'S ROOM	-	-

For leasing information, please contact:

Zach Wooten  
zach.wooten@transwestern.com  
O: 404.842.6540 | M: 404.308.5085

Stephen Clifton  
stephen.clifton@transwestern.com  
O: 404.842.6538 | M: 803.238.0719

Leased by:



A strategic development of:



WESTBRIDGE

# 926 BRADY

ATL STOCKYARDS GA



## LOWER LEVEL

9,103 RSF

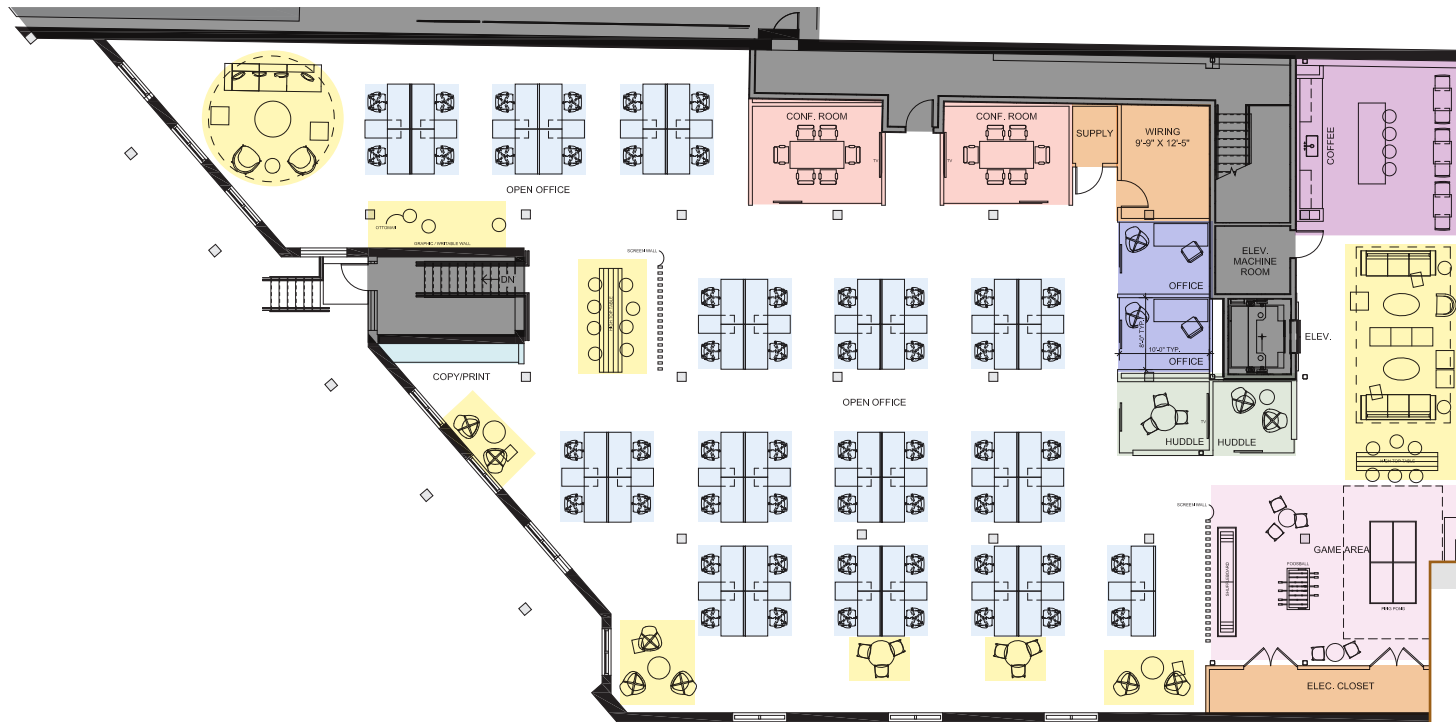

Note: Drawing is Not to Scale

PROGRAM SUMMARY	QTY	SEATS
<b>HEADCOUNT</b>		
OFFICES	-	2
WORKSTATIONS	-	54
<b>TOTAL</b>	-	56
<b>MEETING</b>		
HUDDLE	2	5
CONFERENCE	2	12
<b>TOTAL</b>	-	17
<b>COLLABORATIONS</b>		
WORK CAFE	-	10
OPEN OFFICE	-	55
<b>TOTAL</b>	-	65
SUPPORT	-	-
COPY/PRINT	-	-
WELLNESS/MOTHER'S ROOM	-	-
GAME AREA	-	-

For leasing information, please contact:

Zach Wooten  
zach.wooten@transwestern.com  
O: 404.842.6540 | M: 404.308.5085

Stephen Clifton  
stephen.clifton@transwestern.com  
O: 404.842.6538 | M: 803.238.0719

Leased by:

 **TRANSWESTERN**<sup>®</sup>

A strategic development of:

 **CLARION PARTNERS**  
**WESTBRIDGE**