



Anchored Medical Office RIGHT Off Interstate 540

2501 Market Trace, Suite C
Fort Smith, Arkansas

For more information, contact:

Steven P. Lane

Principal & Managing Director
+1 479 366 6000
steve.lane@ar.colliers.com

Mason Wood

Brokerage | Arkansas
+1 479 409 0409
mason.wood@ar.colliers.com

Robert Wardlaw

Brokerage Associate
+1 501 944 5213
robert.wardlaw@ar.colliers.com



2501 Market Trace, Suite C

Property Details

SIZE	2,400 SF
ASKING RENT	Upon Request
LEASE EXPIRATION DATE	01/31/2033
NEIGHBORING TENANTS	Harp's & Marco's Pizza Casey's across Jenny Lind Rd

Demographics

	1 Mile	3 Mile	5 Mile
Population (2025)	7,958	24,727	52,737
Projected Population (2030)	7,920	24,825	53,168
Average HH Income (2025)	\$88,884	\$100,344	\$106,73
Households (2025)	3,380	10,413	22,982
Projected Households (2030)	3,389	10,528	23,278

For more information, contact:

Steven P. Lane
Principal & Managing Director
+1 479 366 6000
steve.lane@ar.colliers.com

Mason Wood
Brokerage | Arkansas
+1 479 409 0409
mason.wood@ar.colliers.com



Floor Plan

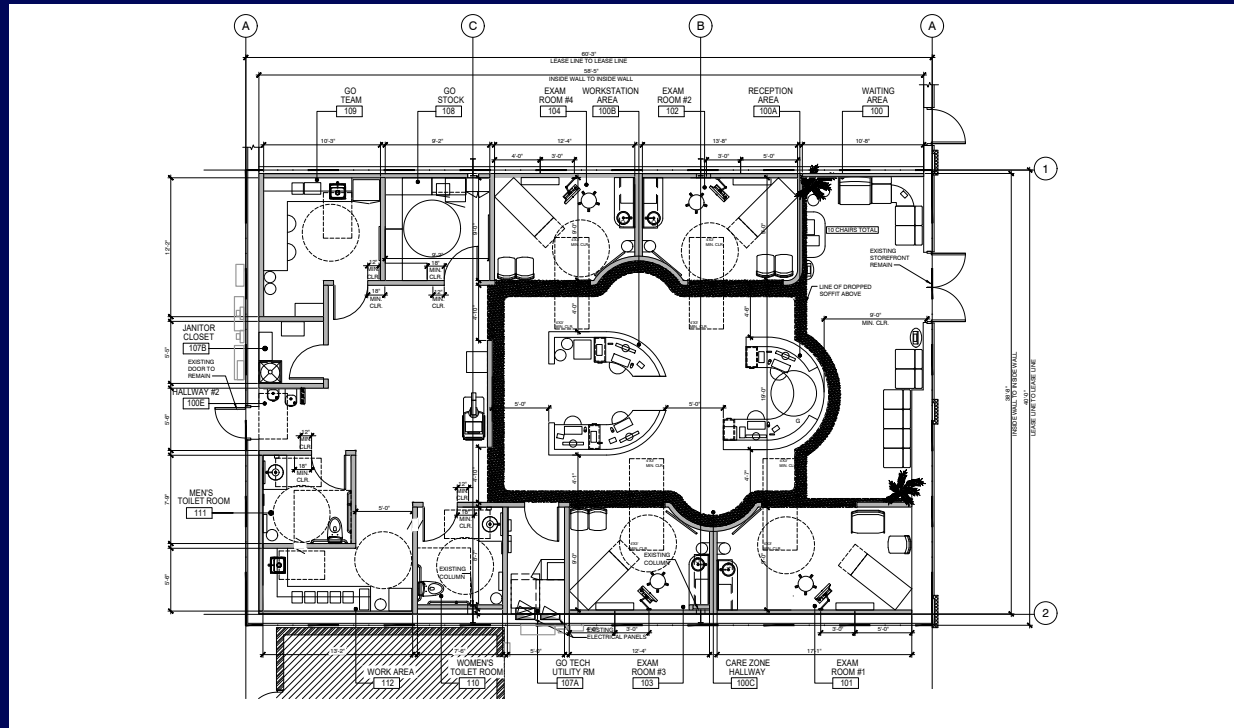

For more information, contact:

Steven P. Lane
Principal & Managing Director
+1 479 366 6000
steve.lane@ar.colliers.com

Mason Wood
Brokerage | Arkansas
+1 479 409 0409
mason.wood@ar.colliers.com

Robert Wardlaw
Brokerage Associate
+1 501 944 5213
robert.wardlaw@ar.colliers.com



Location



For more information, contact:

Steven P. Lane

Principal & Managing Director
+1 479 366 6000
steve.lane@ar.colliers.com

Mason Wood

Brokerage | Arkansas
+1 479 409 0409
mason.wood@ar.colliers.com

